

DRIVEN and STATIC TOOLING
For
HAAS LATHES

Table of Contents

Categorized Listing

SL10/20/30	1
DRIVEN	1
RADIAL DRIVEN TOOL VDI40	1
RADIAL MTSK DRIVEN TOOL VDI40	2
RADIAL REAR-SET DRIVEN TOOL VDI40	2
RADIAL GEARED-UP DRIVEN TOOL VDI40	3
AXIAL DRIVEN TOOL VDI40	3
AXIAL RE-DIRECTED BY 42mm DRIVEN TOOL VDI40	4
AXIAL GEARED-UP I=1:2 DRIVEN TOOL RE-DIRECTED BY 42mm VDI40	5
0-90 ADJUSTABLE ANGLE VDI40	5
SL40	6
DRIVEN	6
RADIAL DRIVEN TOOL VDI40	6
RADIAL MTSK DRIVEN TOOL VDI40	7
RADIAL REAR-SET DRIVEN TOOL VDI40	7
RADIAL GEARED-UP DRIVEN TOOL VDI40	8
AXIAL DRIVEN TOOL VDI40	9
AXIAL DRIVEN TOOL RE-DIRECTED BY 42mm VDI40	9
AXIAL GEARED-UP I=1:2 DRIVEN TOOL RE-DIRECTED BY 42mm VDI40	10
0-90 ADJUSTABLE ANGLE VDI40	10
ST10/20/30 - DS30 - ST40 - TL15/25	11
DRIVEN	11
RADIAL DRIVEN TOOL VDI40	11
RADIAL MTSK DRIVEN TOOL VDI40	11
RADIAL REAR-SET DRIVEN TOOL VDI40	12
RADIAL GEARED-UP DRIVEN TOOL VDI40	12
RADIAL SINGLE SIDE TWIN HEAD DRIVEN TOOL IN Y VDI40	13
AXIAL DRIVEN TOOL VDI40	14
AXIAL DRIVEN TOOL RE-DIRECTED BY 42mm VDI40	14
AXIAL GEARED-UP I=1:2 DRIVEN TOOL RE-DIRECTED BY 42mm VDI40	15
AXIAL REAR-SET OPPOSITE FACE TWIN DRIVEN TOOL	15
0-90 ADJUSTABLE ANGLE VDI40	16
ACCESSORIES	17
DRIVEN	17
MTSK-40 QUICK CHANGE CLAMPS	17

SL10/20/30

DRIVEN

RADIAL DRIVEN TOOL VDI40

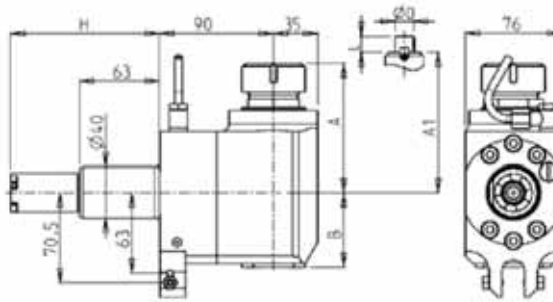

PartNumber	Description	Spindle	I	RPM	Cool Thru	Ext. Cool	A	A1	B	H	Turret
HAS0130132	Radial ER32 Standard H=104.85	ER32	1:1	4000		X	101.1		58.5	104.85	VDI Std
HAS0130232	Radial ER32 H=104.85 Cool Thru*	ER32	1:1	4000	X	X	101.1		82	104.85	VDI Std
HAS0132219	Radial Mill Head H=104.85, D=22mm, L=19mm	22x19	1:1	4000		X		78.5	58.5	104.85	VDI Std
HAS0132721	Radial Mill Head H=104.85, D=27mm, L=21mm	27x21	1:1	4000		X		78.5	58.5	104.85	VDI Std
HAS0140132	Radial ER32 Standard H=117.55	ER32	1:1	4000		X	101.1		58.5	117.55	Hybrid
HAS0140232	Radial ER32 H=117.55 Cool Thru*	ER32	1:1	4000	X	X	101.1		82	117.55	Hybrid
HAS0142219	Radial Mill Head H=117.55, D=22mm, L=19mm	22x19	1:1	4000		X		78.5	58.5	117.55	Hybrid
HAS0142721	Radial Mill Head H=117.55, D=27mm, L=21mm	27x21	1:1	4000		X		78.5	58.5	117.55	Hybrid

* Coolant Thru tools are designed for 1000 psi.
They require 5 Micron Filtration and **CANNOT** be run dry.

SL10/20/30

DRIVEN

RADIAL MTSK DRIVEN TOOL VDI40

See **ACCESSORIES** for Holders

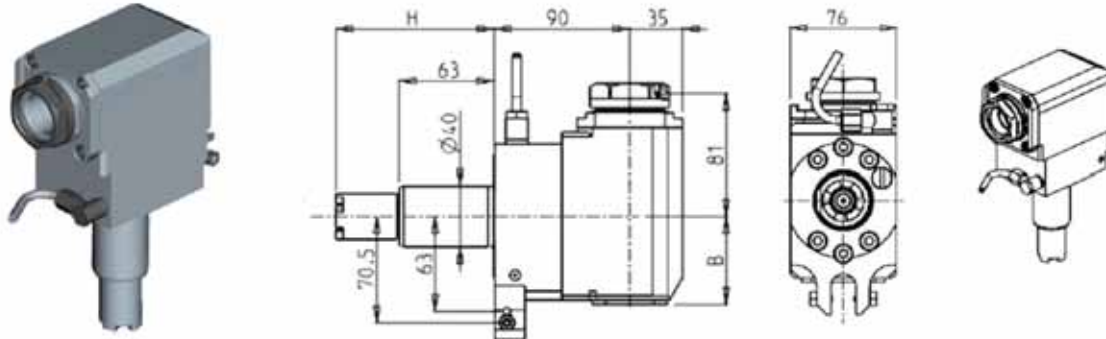

PartNumber	Description	Spindle	I	RPM	Cool Thru	Ext. Cool	B	H	Turret
HAS0270140	Radial MTSK-40 VDI40 H=104.85	MTSK-40	1:1	4000		X	58.5	104.85	VDI Std
HAS0270240	Radial MTSK-40 VDI40 H=104.85 Cool Thru*	MTSK-40	1:1	4000	X	X	69.5	104.85	VDI Std
HAS0280140	Radial MTSK-40 VDI40 H=117.55	MTSK-40	1:1	4000		X	58.5	117.55	Hybrid
HAS0280240	Radial MTSK-40 VDI40 H=117.55 Cool Thru*	MTSK-40	1:1	4000	X	X	69.5	117.55	Hybrid

* Coolant Thru tools are designed for 1000 psi.
They require 5 Micron Filtration and **CANNOT** be run dry.

RADIAL REAR-SET DRIVEN TOOL VDI40

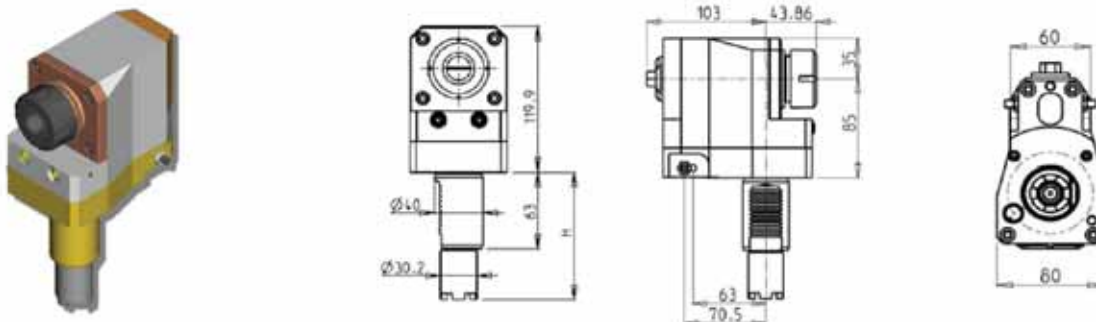

PartNumber	Description	Spindle	I	RPM	Ext. Cool	H	Turret
HAS0030232	Radial Redirected ER32 H=104.85	ER32	1:1	4000	X	104.85	VDI Std
HAS0040232	Radial Redirected ER32 H=117.55	ER32	1:1	4000	X	117.55	Hybrid

SL10/20/30

DRIVEN

RADIAL GEARED-UP DRIVEN TOOL VDI40

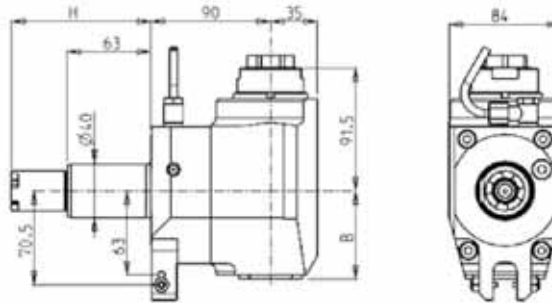

PartNumber	Description	Spindle	I	RPM	Cool Thru	Ext. Cool	B	H	Turret
HAS0150132	Radial ER32A H=104.85 Standard	ER32A	1:2	8000		X	66	104.85	VDI Std
HAS0150232	Radial ER32A H=104.85 Cool Thru*	ER32A	1:2	8000	X	X	76	104.85	VDI Std
HAS0160132	Radial ER32A Standard H=117.55	ER32A	1:2	8000		X	66	117.55	Hybrid
HAS0160232	Radial ER32A H=117.55 Cool Thru*	ER32A	1:2	8000	X	X	76	117.55	Hybrid

* Coolant Thru tools are designed for 1000 psi.
They require 5 Micron Filtration and **CANNOT** be run dry.

AXIAL DRIVEN TOOL VDI40



PartNumber	Description	Spindle	I	RPM	Cool Thru	Ext. Cool	A	H	Turret
HAS0010232	Axial ER32 Standard H=117.55	ER32	1:1	4000		X	107.26	104.85	VDI Std
HAS0010132	Axial ER32 Standard H=117.55 Cool Thru*	ER32	1:1	4000	X	X	110.46	104.85	VDI Std
HAS0020232	Axial ER32 Standard H=104.85	ER32	1:1	4000		X	107.26	117.55	Hybrid
HAS0020132	Axial ER32 Standard H=104.85 Cool Thru*	ER32	1:1	4000	X	X	110.46	117.55	Hybrid

* Coolant Thru tools are designed for 1000 psi.
They require 5 Micron Filtration and **CANNOT** be run dry.

SL10/20/30

DRIVEN

AXIAL RE-DIRECTED BY 42mm DRIVEN TOOL VDI40

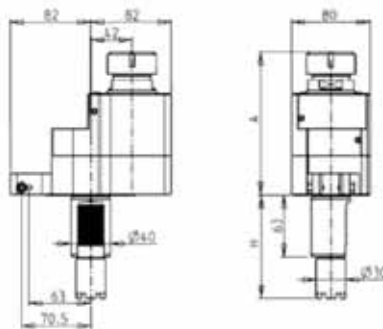

PartNumber	Description	Spindle	I	RPM	Cool Thru	Ext. Cool	A	H	Turret
HAS0070032	Axial Redirected ER32 H=104.85	ER32	1:1	4000		X	144.66	104.85	VDI Std
HAS0071132	Axial Redirected ER32 H=104.85 Cool Thru*	ER32	1:1	4000	X		164.96	104.85	VDI Std
HAS0072132	Axial Geared Down Redirected ER32 H=104.85	ER32	2:1	2000		X	144.66	104.85	VDI Std
HAS0074232	Axial Geared Down Redirected ER32 H=104.85 Cool Thru*	ER32	2:1	2000	X		164.96	104.85	VDI Std
HAS0080032	Axial Redirected ER32 H=117.55	ER32	1:1	4000		X	144.66	117.55	Hybrid
HAS0081132	Axial Redirected ER32 H=117.55 Cool Thru*	ER32	1:1	4000	X		164.96	117.55	Hybrid
HAS0082132	Axial Geared Down Redirected ER32 H=117.55	ER32	2:1	2000		X	144.66	117.55	Hybrid
HAS0084232	Axial Geared Down Redirected ER32 H=117.55 Cool Thru*	ER32	2:1	2000	X		164.96	117.55	Hybrid

* Coolant Thru tools are designed for 1000 psi.
They require 5 Micron Filtration and **CANNOT** be run dry.

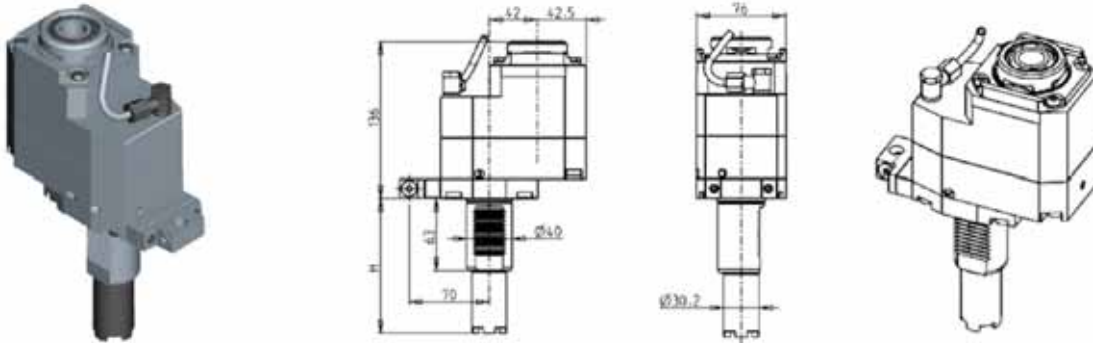
SL10/20/30**DRIVEN****AXIAL GEARED-UP I=1:2 DRIVEN TOOL RE-DIRECTED BY 42mm VDI40**

PartNumber	Description	Spindle	I	RPM	Cool Thru	Ext. Cool	H	Turret
HAS0307132	Axial Geared Up Redirected ERA32 H=104.85	ERA32	1:2	8000		X	104.85	VDI Std
HAS0307232	Axial Geared Up Redirected ERA32 H=104.85 Cool Thru*	ERA32	1:2	8000	X	X	104.85	VDI Std
HAS0317132	Axial Geared Up Redirected ERA32 H=117.55	ERA32	1:2	8000		X	117.55	Hybrid
HAS0317232	Axial Geared Up Redirected ERA32 H=117.55 Cool Thru*	ERA32	1:2	8000	X	X	117.55	Hybrid

* Coolant Thru tools are designed for 1000 psi.
They require 5 Micron Filtration and **CANNOT** be run dry.

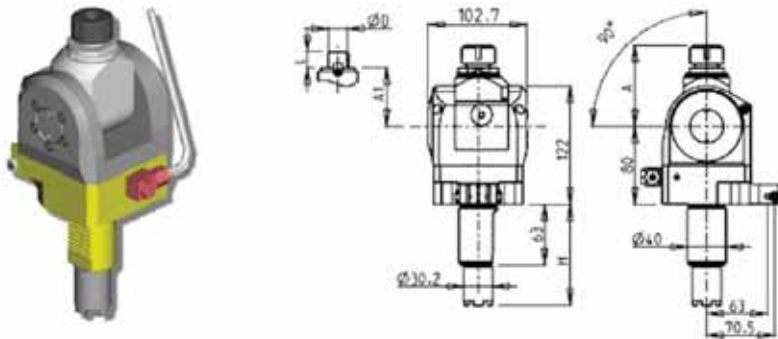
0-90 ADJUSTABLE ANGLE VDI40

PartNumber	Description	Spindle	I	RPM	Ext. Cool	A	A1	D	L	H	Turret
HAS0050020	Adj. Angle (0-90) ER20 H=104.85	ER20	1:1	4000	X	84.16				104.85	VDI Std
HAS0050025	Adj. Angle (0-90) ER25 H=104.85	ER25	1:1	4000	X	85.66				104.85	VDI Std
HAS0051617	Adj. Angle (0-90) Mill Head D=16mm, L=17mm, H=104.85	16x17	1:1	4000	X		65	16	17	104.85	VDI Std
HAS0052219	Adj. Angle (0-90) Mill Head D=22mm, L=19mm, H=104.85	22x19	1:1	4000	X		66	22	19	104.85	VDI Std
HAS0051905	Adj. Angle (0-90) Mill Head 3/4x3/4 H=104.85	3/4x3/4	1:1	4000	X		65	3/4"	3/4"	104.85	VDI Std
HAS0060020	Adj. Angle (0-90) ER20 H=117.55	ER20	1:1	4000	X	84.16				117.55	Hybrid
HAS0060025	Adj. Angle (0-90) ER25 H=117.55	ER25	1:1	4000	X	85.66				117.55	Hybrid
HAS0061617	Adj. Angle (0-90) Mill Head D=16mm, L=17mm, H=117.55	16x17	1:1	4000	X		65	16	17	117.55	Hybrid
HAS0062219	Adj. Angle (0-90) Mill Head D=22mm, L=19mm H=117.55	22x19	1:1	4000	X		66	22	19	117.55	Hybrid
HAS0061905	Adj. Angle (0-90) Mill Head 3/4x3/4 H=117.55	3/4x3/4	1:1	4000	X		65	3/4"	3/4"	117.55	Hybrid

SL10/20/30

DRIVEN

0-90 ADJUSTABLE ANGLE VDI40

Note : Wrenches are provided with the purchase of Specialty Toolholders

SL40

DRIVEN

RADIAL DRIVEN TOOL VDI40

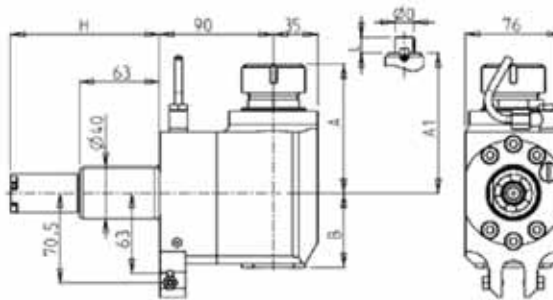

PartNumber	Description	Spindle	I	RPM	Cool Thru	Ext. Cool	A	A1	B	H	Turret
HAS0140132	Radial ER32 Standard H=117.55	ER32	1:1	4000		X	101.1		58.5	117.55	VDI Std
HAS0140232	Radial ER32 H=117.55 Cool Thru*	ER32	1:1	4000	X	X	101.1		82	117.55	VDI Std
HAS0142219	Radial Mill Head D=22mm, L=19mm, H=117.55	22x19	1:1	4000		X		78.5	58.5	117.55	VDI Std
HAS0142721	Radial Mill Head D=27mm, L=21mm, H=117.55	27x21	1:1	4000		X		78.5	58.5	117.55	VDI Std
HAS0180132	Radial ER32 Standard H=130.25	ER32	1:1	4000		X	101.1		58.5	130.25	Hybrid
HAS0180232	Radial ER32 H=130.25 Cool Thru*	ER32	1:1	4000	X	X	101.1		82	130.25	Hybrid
HAS0182219	Radial Mill Head D=22mm, L=19mm, H=130.25	22x19	1:1	4000		X		78.5	58.5	130.25	Hybrid
HAS0182721	Radial Mill Head D=27mm, L=21mm, H=130.25	27x21	1:1	4000		X		78.5	58.5	130.25	Hybrid

* Coolant Thru tools are designed for 1000 psi.
They require 5 Micron Filtration and **CANNOT** be run dry.

SL40

DRIVEN

RADIAL DRIVEN TOOL VDI40

RADIAL MTSK DRIVEN TOOL VDI40

See **ACCESSORIES** for Holders

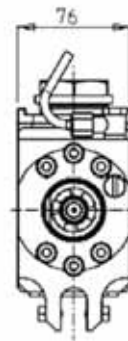
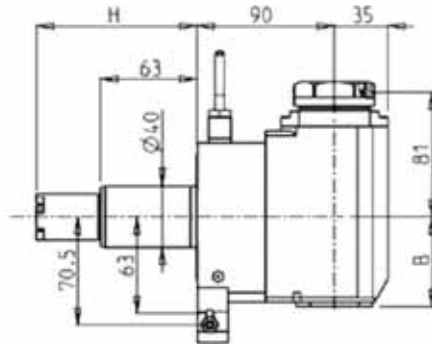

PartNumber	Description	Spindle	I	RPM	Cool Thru	Ext. Cool	B	H	Turret
HAS0280140	Radial MTSK-40 Driven VDI40 H=117.55	MTSK-40	1:1	4000		X	58.5	117.55	VDI Std
HAS0280240	Radial MTSK-40 Driven VDI40 H=117.55 Cool Thru*	MTSK-40	1:1	4000	X	X	69.5	117.55	VDI Std
HAS0260140	Radial MTSK-40 Driven VDI40 H=130.25	MTSK-40	1:1	4000		X	58.5	130.25	Hybrid
HAS0260240	Radial MTSK-40 Driven VDI40 H=130.25 Cool Thru*	MTSK-40	1:1	4000	X	X	69.5	130.25	Hybrid

* Coolant Thru tools are designed for 1000 psi.
They require 5 Micron Filtration and **CANNOT** be run dry.

RADIAL REAR-SET DRIVEN TOOL VDI40

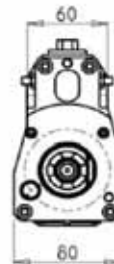
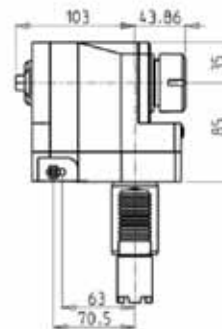
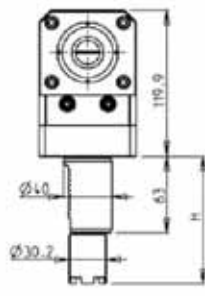
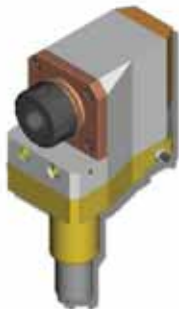

PartNumber	Description	Spindle	I	RPM	Ext. Cool	H	Turret
HAS0040232	Radial Redirected ER32 H=117.55	ER32	1:1	4000	X	117.55	VDI Std
HAS0190232	Radial Redirected ER32 H=130.25	ER32	1:1	4000	X	130.25	Hybrid

SL40

DRIVEN

RADIAL GEARED-UP DRIVEN TOOL VDI40

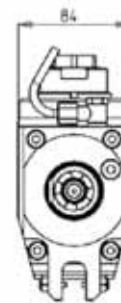
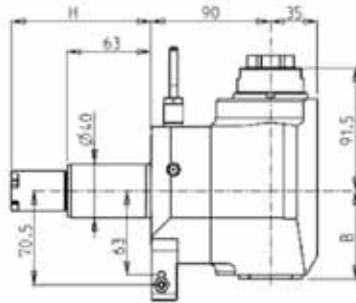

PartNumber	Description	Spindle	I	RPM	Cool Thru	Ext. Cool	B	H	Turret
HAS0160132	Radial Geared Up ER32A H=117.55 Standard	ER32A	1:2	8000		X	66	117.55	VDI Std
HAS0160232	Radial Geared Up ER32A H=117.55 Cool Thru*	ER32A	1:2	8000	X	X	76	117.55	VDI Std
HAS0210132	Radial Geared Up ER32A H=130.25 Standard	ER32A	1:2	8000		X	66	130.25	Hybrid
HAS0210232	Radial Geared Up ER32A H=130.25 Cool Thru*	ER32A	1:2	8000	X	X	76	130.25	Hybrid

* Coolant Thru tools are designed for 1000 psi.
They require 5 Micron Filtration and **CANNOT** be run dry.

SL40

DRIVEN

AXIAL DRIVEN TOOL VDI40

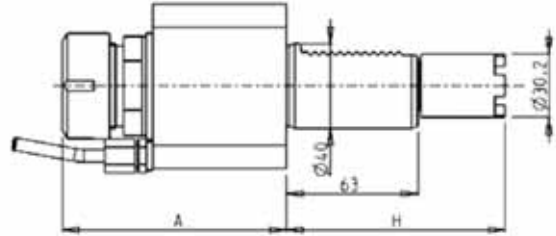
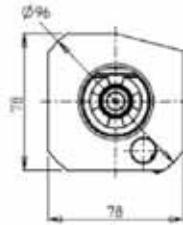

PartNumber	Description	Spindle	I	RPM	Cool Thru	Ext. Cool	A	H	Turret
HAS0020232	Axial ER32 Standard H=117.55	ER32	1:1	4000		X	107.26	117.55	VDI Std
HAS0020132	Axial ER32 Standard H=117.55 Cool Thru*	ER32	1:1	4000	X	X	110.46	117.55	VDI Std
HAS0170232	Axial ER32 Standard H=130.25	ER32	1:1	4000		X	107.26	130.25	Hybrid
HAS0170132	Axial ER32 Standard H=130.25 Cool Thru*	ER32	1:1	4000		X	110.46	130.25	Hybrid

AXIAL DRIVEN TOOL RE-DIRECTED BY 42mm VDI40

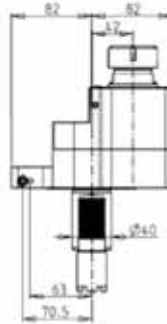

PartNumber	Description	Spindle	I	RPM	Cool Thru	Ext. Cool	A	H	Turret
HAS0080032	Axial Redirected ER32	ER32	1:1	4000		X	144.66	117.55	VDI Std
HAS0081132	Axial Redirected ER32 H=117.55 Cool Thru*	ER32	1:1	4000	X		164.96	117.55	VDI Std
HAS0082132	Axial Geared Down Redirected ER32 H=117.55	ER32	2:1	2000		X	144.66	117.55	VDI Std
HAS0084232	Axial Geared Down ER32 Redirected H=117.55 Cool Thru*	ER32	2:1	2000	X		164.96	117.55	VDI Std
HAS0200032	Axial Redirected ER32 H=130.25	ER32	1:1	4000		X	144.66	130.25	Hybrid
HAS0201132	Axial Redirected ER32 H=130.25 Cool Thru*	ER32	1:1	4000	X		164.96	130.25	Hybrid
HAS0202132	Axial Geared Down Redirected ER32 H=130.25	ER32	2:1	2000		X	144.66	130.25	Hybrid
HAS0204232	Axial Geared Down Redirected ER32 H=130.25 Cool Thru*	ER32	2:1	2000	X		164.96	130.25	Hybrid

* Coolant Thru tools are designed for 1000 psi.
They require 5 Micron Filtration and **CANNOT** be run dry.

SL40

DRIVEN

AXIAL GEARED-UP I=1:2 DRIVEN TOOL RE-DIRECTED BY 42mm VDI40

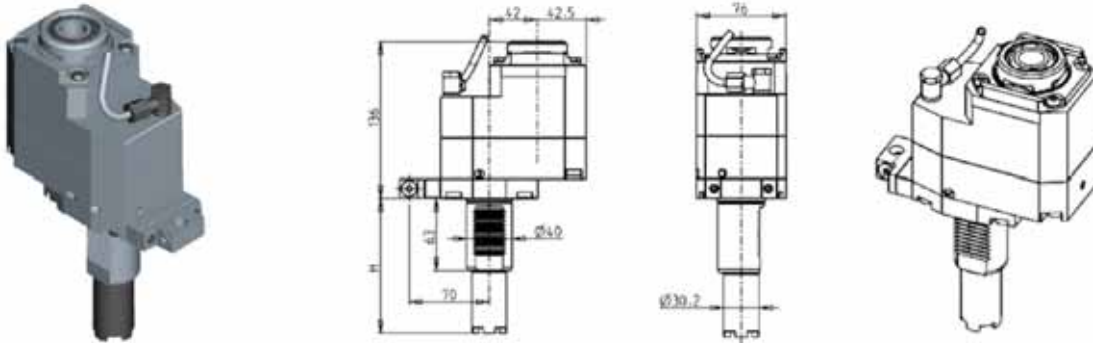

PartNumber	Description	Spindle	I	RPM	Cool Thru	Ext. Cool	H	Turret
HAS0297132	Axial Geared Up Redirected ERA32 H=130.25	ERA32	1:2	8000		X	130.25	Hybrid
HAS0317132	Axial Geared Up Redirected ERA32 H=117.55	ERA32	1:2	8000		X	117.55	Hybrid
HAS0297232	Axial Geared Up Redirected ERA32 H=130.25 Cool Thru*	ERA32	1:2	8000	X	X	130.25	Hybrid
HAS0317232	Axial Geared Up Redirected ERA32 H=117.55 Cool Thru*	ERA32	1:2	8000	X	X	117.55	Hybrid

* Coolant Thru tools are designed for 1000 psi.
They require 5 Micron Filtration and **CANNOT** be run dry.

0-90 ADJUSTABLE ANGLE VDI40

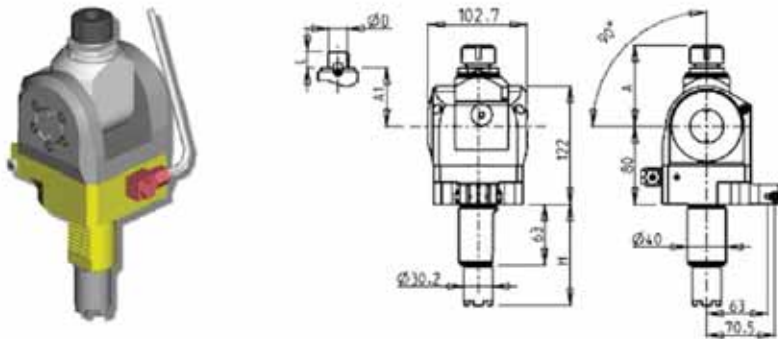

PartNumber	Description	Spindle	I	RPM	Ext. Cool	A	A1	D	L	H	Turret
HAS0060020	Adj Angle (0-90) ER20 H=117.55	ER20	1:1	4000	X	84.16				117.55	VDI Std
HAS0060025	Adj Angle (0-90) ER25 H=117.55	ER25	1:1	4000	X	85.66				117.55	VDI Std
HAS0061617	Adj Angle (0-90) Mill Head D=16mm, L=17mm, H=117.55	16x17	1:1	4000	X		65	16	17	117.55	VDI Std
HAS0062219	Adj Angle (0-90) Mill Head D=22mm, L=19mm, H=117.55	22x19	1:1	4000	X		66	22	19	117.55	VDI Std
HAS0061905	Adj Angle (0-90) Mill Head 3/4x3/4 H=117.55	3/4x3/4	1:1	4000	X		65	3/4"	3/4"	117.55	VDI Std
HAS0220020	Adj Angle (0-90) ER20 H=130.25	ER20	1:1	4000	X	84.16				130.25	Hybrid
HAS0220025	Adj Angle (0-90) ER25 H=130.25	ER25	1:1	4000	X	85.66				130.25	Hybrid
HAS0221617	Adj Angle (0-90) Mill Head D=16mm, L=17mm, H=130.25	16x17	1:1	4000	X		65	16	17	130.25	Hybrid
HAS0222219	Adj Angle (0-90) Mill Head D=22mm, L=19mm, H=130.25	22x19	1:1	4000	X		66	22	19	130.25	Hybrid
HAS0221905	Adj Angle (0-90) Mill Head 3/4x3/4 H=130.25	3/4x3/4	1:1	4000	X		65	3/4"	3/4"	130.25	Hybrid

SL40

DRIVEN

0-90 ADJUSTABLE ANGLE VDI40

Note : Wrenches are provided with the purchase of Specialty Toolholders

ST10/20/30 - DS30 - ST40 - TL15/25

DRIVEN

RADIAL DRIVEN TOOL VDI40

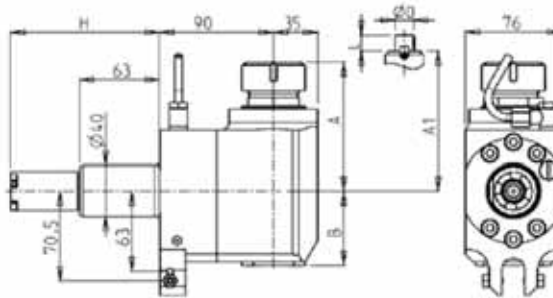

PartNumber	Description	Spindle	I	RPM	Cool Thru	Ext. Cool	A	A1	B	H	Turret
HAS0140132	Radial ER32 Standard H=117.55	ER32	1:1	4000		X	101.1		58.5	117.55	VDI Std/Hybrid
HAS0140232	Radial ER32 H=117.55 Cool Thru*	ER32	1:1	4000	X	X	101.1		82	117.55	VDI Std/Hybrid
HAS0142219	Radial Mill Head D=22mm, L=19mm, H=117.55	22x19	1:1	4000		X		78.5	58.5	117.55	VDI Std/Hybrid
HAS0142721	Radial Mill Head D=27mm, L=21mm, H=117.55	27x21	1:1	4000		X		78.5	58.5	117.55	VDI Std/Hybrid

* Coolant Thru tools are designed for 1000 psi.
They require 5 Micron Filtration and **CANNOT** be run dry.

RADIAL MTSK DRIVEN TOOL VDI40

See **ACCESSORIES** for Holders

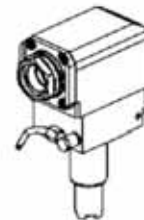
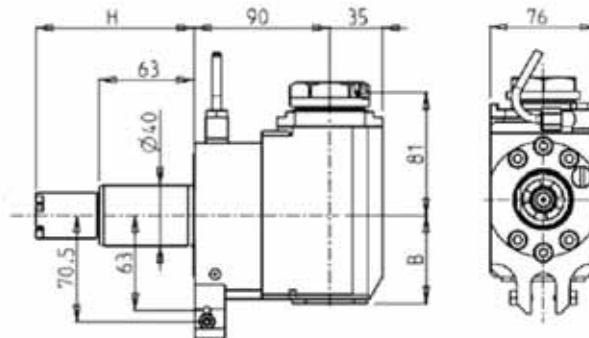

PartNumber	Description	Spindle	I	RPM	Cool Thru	Ext. Cool	B	H	Turret
HAS0280140	Radial MTSK-40 Driven VDI40	MTSK-40	1:1	4000		X	58.5	117.55	VDI Std/Hybrid
HAS0280240	Radial MTSK-40 Driven VDI40 Cool Thru*	MTSK-40	1:1	4000	X	X	69.5	117.55	VDI Std/Hybrid

ST10/20/30 - DS30 - ST40 - TL15/25

DRIVEN

RADIAL SINGLE SIDE TWIN HEAD DRIVEN TOOL IN Y VDI40

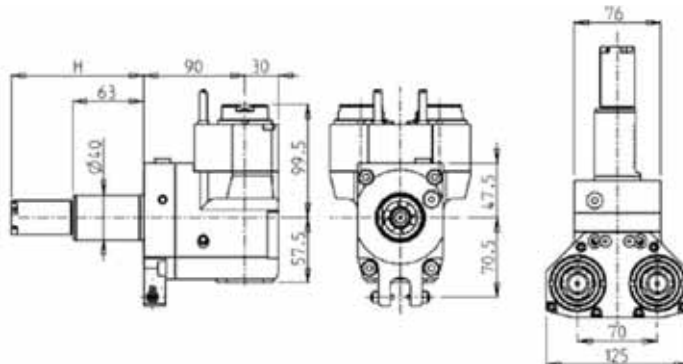

PartNumber	Description	Spindle	I	RPM	# of Tools	Cool Thru	Ext. Cool	H	Turret
HAS0240125	Radial Single Side Twin Head Driven VDI40	ER25	1:1	4000	2		X	117.55	VDI Std / Hybrid
HAS0240225	Radial Single Side Twin Head Driven VDI40 - Cool Thru*	ER25	1:1	4000	2	X		117.55	VDI Std / Hybrid

* Coolant Thru tools are designed for 1000 psi.
They require 5 Micron Filtration and **CANNOT** be run dry.

ST10/20/30 - DS30 - ST40 - TL15/25

DRIVEN

AXIAL DRIVEN TOOL VDI40

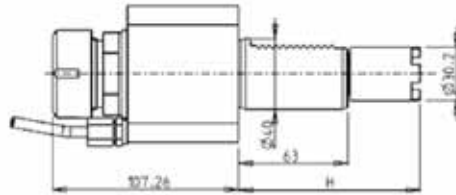
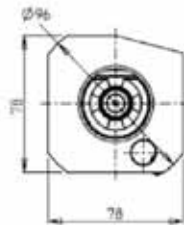

PartNumber	Description	Spindle	I	RPM	Ext. Cool	H	Turret Type
HAS0020232	Axial ER32 Standard H=117.55	ER32	1:1	4000	X	117.55	VDI Std/Hybrid

AXIAL DRIVEN TOOL RE-DIRECTED BY 42mm VDI40

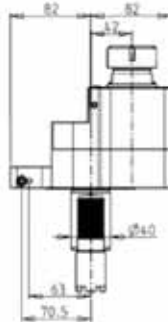

PartNumber	Description	Spindle	I	RPM	Cool Thru	Ext. Cool	A	H	Turret
HAS0080032	Axial Redirected ER32 H=117.55	ER32	1:1	4000		X	144.66	117.55	Hybrid
HAS0081132	Axial Redirected ER32 H=117.55 Cool Thru*	ER32	1:1	4000	X		164.96	117.55	Hybrid
HAS0082132	Axial Geared Down Redirected ER32 H=117.55	ER32	2:1	2000		X	144.66	117.55	Hybrid
HAS0084232	Axial Geared Down Redirected ER32 H=117.5 Cool Thru*	ER32	2:1	2000	X		164.96	117.55	Hybrid

* Coolant Thru tools are designed for 1000 psi.
They require 5 Micron Filtration and **CANNOT** be run dry.

ST10/20/30 - DS30 - ST40 - TL15/25

DRIVEN

AXIAL GEARED-UP I=1:2 DRIVEN TOOL RE-DIRECTED BY 42mm VDI40

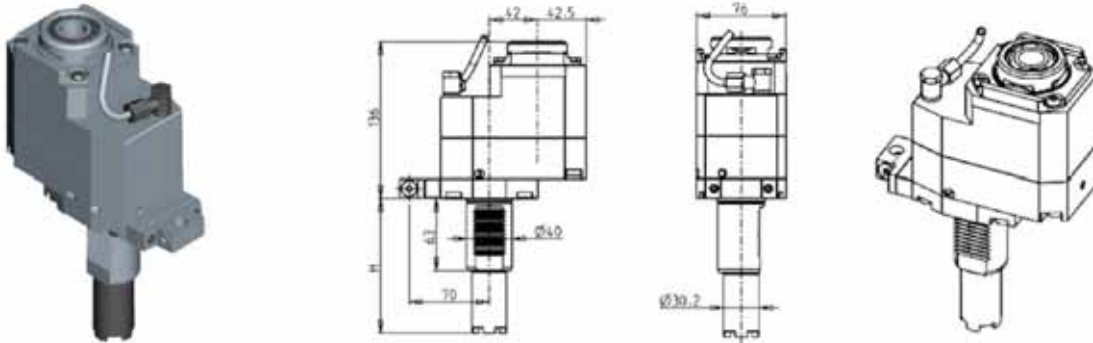

PartNumber	Description	Spindle	I	RPM	Cool Thru	Ext. Cool	H	Turret
HAS0317132	Axial Geared Up Redirected ERA32 H=117.55	ERA32	1:2	8000		X	117.55	Hybrid
HAS0317232	Axial Geared Up Redirected ERA32 H=117.55 Cool Thru*	ERA32	1:2	8000	X	X	117.55	Hybrid

* Coolant Thru tools are designed for 1000 psi.
They require 5 Micron Filtration and **CANNOT** be run dry.

AXIAL REAR-SET OPPOSITE FACE TWIN DRIVEN TOOL

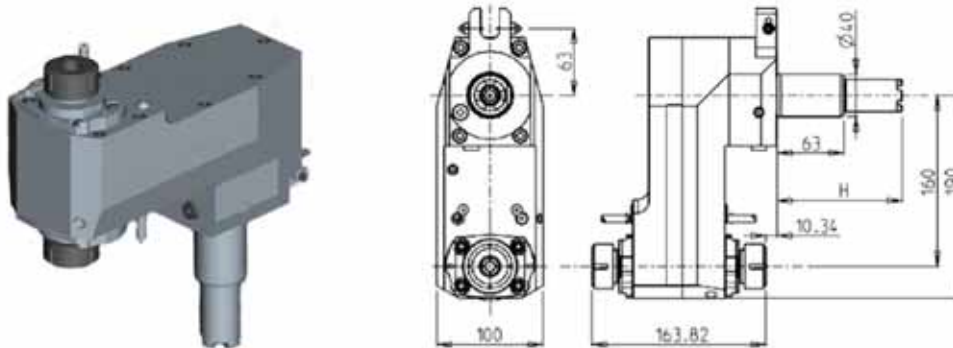

PartNumber	Description	Spindle	I	RPM	Ext. Cool	H	Turret Type
HAS0230225	Axial ER25 Standard Re-Directed by 160mm	ER25+ER25	1:1	4000	X	177.55	VDI Std/Hybrid

ST10/20/30 - DS30 - ST40 - TL15/25

DRIVEN

0-90 ADJUSTABLE ANGLE VDI40

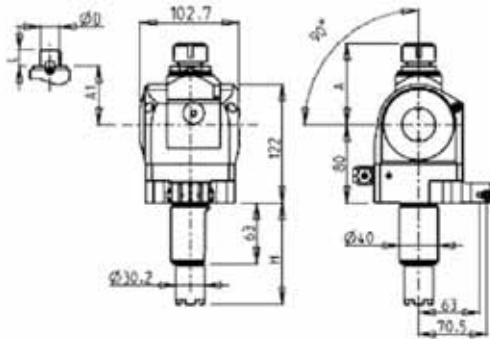

PartNumber	Description	Spindle	I	RPM	Ext. Cool	A	A1	D	L	H	Turret
HAS0060020	Adj. Angle (0-90) ER20	ER20	1:1	4000	X	84.16				117.55	VDI Std/Hybrid
HAS0060025	Adj. Angle (0-90) ER25	ER25	1:1	4000	X	85.66				117.55	VDI Std/Hybrid
HAS0061617	Adj. Angle (0-90) Mill Head D=16mm, L=17mm	16x17	1:1	4000	X		65	16	17	117.55	VDI Std/Hybrid
HAS0062219	Adj. Angle (0-90) Mill Head D=22mm, L=19mm	22x19	1:1	4000	X		66	22	19	117.55	VDI Std/Hybrid
HAS0061905	Adj. Angle (0-90) Mill Head 3/4x3/4	3/4x3/4	1:1	4000	X		65	3/4"	3/4"	117.55	VDI Std/Hybrid

Note : Wrenches are provided with the purchase of Specialty Toolholders

ACCESSORIES

DRIVEN

MTSK-40 QUICK CHANGE CLAMPS

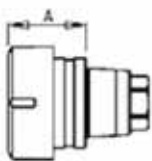

Cod. MT	Mandrin Spindle Spindel	A
MTSK40A02	ER32	35.6
MTSK40A03	ER25	32.6

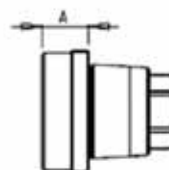

Cod. MT	Mandrin Spindle Spindel	A
MTSK40B02	ERA25	16
MTSK40B03	ERA20	14

PartNumber	Description	Spindle	Dimension	A	D	L
MTSK40A02	MTSK-40 Clamping Unit ER32	ER32		35.6		
MTSK40A03	MTSK-40 Clamping Unit ER25	ER25		32.6		
MTSK40B02	MTSK-40 Clamping Unit ERA25	ERA25		16mm		
MTSK40B03	MTSK-40 Clamping Unit ERA20	ERA20		14mm		
MTSK40C02	MTSK-40 Clamping Unit 16x17	16x17	mm	15	16	17
MTSK40C03	MTSK-40 Clamping Unit 3/4"x3/4"	3/4"x3/4"	Inch	15.5	3/4"	3/4"
MTSK40C04	MTSK-40 Clamping Unit 22x19	16x17	mm	17	22	19
MTSK40C05	MTSK-40 Clamping Unit 27x21	27x21	mm	22	27	21
MTSK40D01	MTSK-40 Clamping Unit Weldon 6	Weldon 6		8		
MTSK40D02	MTSK-40 Clamping Unit Weldon 8	Weldon 8		8		
MTSK40D03	MTSK-40 Clamping Unit Weldon 10	Weldon 10		9		
MTSK40D04	MTSK-40 Clamping Unit Weldon 12	Weldon 12		14		
MTSK40D06	MTSK-40 Clamping Unit Weldon 16	Weldon 16		39.5		
MTSK40D07	MTSK-40 Clamping Unit Weldon 20	Weldon 20		39.5		
MTSK40D011	MTSK-40 Clamping Unit Weldon 1/4"	Weldon 1/4"		8		
MTSK40D012	MTSK-40 Clamping Unit Weldon 5/16"	Weldon 5/16"		8		
MTSK40D013	MTSK-40 Clamping Unit Weldon 3/8"	Weldon 3/8"		9		
MTSK40D014	MTSK-40 Clamping Unit Weldon 1/2"	Weldon 12"		14		

Table of Contents

Alphabetized Listing

O

0-90 ADJUSTABLE ANGLE VDI40	5-6, 10-11, 16
-----------------------------	----------------

A

ACCESSORIES	17
AXIAL DRIVEN TOOL RE-DIRECTED BY 42mm VDI40	9, 14
AXIAL DRIVEN TOOL VDI40	3, 9, 14
AXIAL GEARED-UP I=1:2 DRIVEN TOOL RE-DIRECTED BY 42mm VDI40	5, 10, 15
AXIAL REAR-SET OPPOSITE FACE TWIN DRIVEN TOOL	15
AXIAL RE-DIRECTED BY 42mm DRIVEN TOOL VDI40	4

D

DRIVEN	1-17
--------	------

M

MTSK-40 QUICK CHANGE CLAMPS	17
-----------------------------	----

R

RADIAL DRIVEN TOOL VDI40	1, 6-7, 11
RADIAL GEARED-UP DRIVEN TOOL VDI40	3, 8, 12
RADIAL MTSK DRIVEN TOOL VDI40	2, 7, 11-12
RADIAL REAR-SET DRIVEN TOOL VDI40	2, 7, 12
RADIAL SINGLE SIDE TWIN HEAD DRIVEN TOOL IN Y VDI40	13

S

See ACCESSORIES for Holders	2, 7, 11-12
SL10/20/30	1-6
SL40	6-11
ST10/20/30 - DS30 - ST40 - TL15/25	11-16

Table of Contents

Part Number Index

H

H			HAS0140232	Radial ER32 H=117.55 Cool Thru*	
HAS0010132	Axial ER32 Standard H=117.55 Cool Thru*	3	HAS0142219	Radial Mill Head H=117.55, D=22mm, L=19mm	1
HAS0010232	Axial ER32 Standard H=117.55	3	HAS0142219	Radial Mill Head D=22mm, L=19mm, H=117.55	6
HAS0020132	Axial ER32 Standard H=117.55 Cool Thru*	9	HAS0142219	Radial Mill Head D=22mm, L=19mm, H=117.55	11
HAS0020132	Axial ER32 Standard H=104.85 Cool Thru*	3	HAS0142721	Radial Mill Head D=27mm, L=21mm, H=117.55	11
HAS0020232	Axial ER32 Standard H=117.55	9	HAS0142721	Radial Mill Head D=27mm, L=21mm, H=117.55	6
HAS0020232	Axial ER32 Standard H=104.85	3	HAS0142721	Radial Mill Head H=117.55, D=27mm, L=21mm	1
HAS0020232	Axial ER32 Standard H=117.55	14	HAS0150132	Radial ER32A H=104.85 Standard	3
HAS0030232	Radial Redirected ER32 H=104.85	2	HAS0150232	Radial ER32A H=104.85 Cool Thru*	3
HAS0040232	Radial Redirected ER32 H=117.55	2	HAS0160132	Radial ER32A Standard H=117.55	3
HAS0040232	Radial Redirected ER32 H=117.55	7	HAS0160132	Radial Geared Up ER32A H=117.55 Standard	8
HAS0040232	Radial Redirected ER32	12	HAS0160132	Radial ER32A Standard H=117.55	12
HAS0050020	Adj. Angle (0-90) ER20 H=104.85	5	HAS0160232	Radial ER32A H=117.55 Cool Thru*	12
HAS0050025	Adj. Angle (0-90) ER25 H=104.85	5	HAS0160232	Radial Geared Up ER32A H=117.55 Cool Thru*	8
HAS0051617	Adj. Angle (0-90) Mill Head D=16mm, L=17mm, H=104.85	5	HAS0160232	Radial ER32A H=117.55 Cool Thru*	3
HAS0051905	Adj. Angle (0-90) Mill Head 3/4x3/4 H=104.85	5	HAS0170132	Axial ER32 Standard H=130.25 Cool Thru*	9
HAS0052219	Adj. Angle (0-90) Mill Head D=22mm, L=19mm, H=104.85	5	HAS0170232	Axial ER32 Standard H=130.25	9
			HAS0180132	Radial ER32 Standard H=130.25	6
			HAS0180232	Radial ER32 H=130.25 Cool Thru*	6
HAS0060020	Adj. Angle (0-90) ER20 H=117.55	5	HAS0182219	Radial Mill Head D=22mm, L=19mm, H=130.25	6
HAS0060020	Adj Angle (0-90) ER20 H=117.55	10	HAS0182721	Radial Mill Head D=27mm, L=21mm, H=130.25	6
HAS0060020	Adj. Angle (0-90) ER20	16	HAS0190232	Radial Redirected ER32 H=130.25	7
HAS0060025	Adj. Angle (0-90) ER25	16	HAS0200032	Axial Redirected ER32 H=130.25	9
HAS0060025	Adj Angle (0-90) ER25 H=117.55	10	HAS0201132	Axial Redirected ER32 H=130.25 Cool Thru*	9
HAS0060025	Adj. Angle (0-90) ER25 H=117.55	5	HAS0202132	Axial Geared Down Redirected ER32 H=130.25	9
HAS0061617	Adj. Angle (0-90) Mill Head D=16mm, L=17mm, H=117.55	5	HAS0204232	Axial Geared Down Redirected ER32 H=130.25 Cool Thru*	9
HAS0061617	Adj Angle (0-90) Mill Head D=16mm, L=17mm, H=117.55	10	HAS0210132	Radial Geared Up ER32A H=130.25 Standard	8
HAS0061617	Adj. Angle (0-90) Mill Head D=16mm, L=17mm	16	HAS0210232	Radial Geared Up ER32A H=130.25 Cool Thru*	8
HAS0061905	Adj. Angle (0-90) Mill Head 3/4x3/4	16	HAS0220020	Adj Angle (0-90) ER20 H=130.25	10
HAS0061905	Adj Angle (0-90) Mill Head 3/4x3/4 H=117.55	10	HAS0220025	Adj Angle (0-90) ER25 H=130.25	10
HAS0061905	Adj. Angle (0-90) Mill Head 3/4x3/4 H=117.55	5	HAS0221617	Adj Angle (0-90) Mill Head D=16mm, L=17mm, H=130.25	10
HAS0062219	Adj Angle (0-90) Mill Head D=22mm, L=19mm, H=117.55	10			
HAS0062219	Adj. Angle (0-90) Mill Head D=22mm, L=19mm H=117.55	5	HAS0221905	Adj Angle (0-90) Mill Head 3/4x3/4 H=130.25	10
HAS0062219	Adj. Angle (0-90) Mill Head D=22mm, L=19mm	16	HAS0222219	Adj Angle (0-90) Mill Head D=22mm, L=19mm, H=130.25	10
HAS0070032	Axial Redirected ER32 H=104.85	4			
HAS0071132	Axial Redirected ER32 H=104.85 Cool Thru*	4	HAS0230225	Axial ER25 Standard Re-Directed by 160mm	15
HAS0072132	Axial Geared Down Redirected ER32 H=104.85	4	HAS0240125	Radial Single Side Twin Head Driven VDI40	13
HAS0074232	Axial Geared Down Redirected ER32 H=104.85 Cool Thru*	4	HAS0240225	Radial Single Side Twin Head Driven VDI40 - Cool Thru*	13
HAS0080032	Axial Redirected ER32 H=117.55	4	HAS0260140	Radial MTSK-40 Driven VDI40 H=130.25	7
HAS0080032	Axial Redirected ER32	9	HAS0260240	Radial MTSK-40 Driven VDI40 H=130.25 Cool Thru*	7
HAS0080032	Axial Redirected ER32 H=117.55	14	HAS0270140	Radial MTSK-40 VDI40 H=104.85	2
HAS0081132	Axial Redirected ER32 H=117.55 Cool Thru*	14	HAS0270240	Radial MTSK-40 VDI40 H=104.85 Cool Thru*	2
HAS0081132	Axial Redirected ER32 H=117.55 Cool Thru*	9	HAS0280140	Radial MTSK-40 VDI40 H=117.55	2
HAS0081132	Axial Redirected ER32 H=117.55 Cool Thru*	14	HAS0280140	Radial MTSK-40 Driven VDI40 H=117.55	7
HAS0081132	Axial Redirected ER32 H=117.55 Cool Thru*	9	HAS0280140	Radial MTSK-40 Driven VDI40	11
HAS0081132	Axial Redirected ER32 H=117.55 Cool Thru*	4	HAS0280240	Radial MTSK-40 Driven VDI40 Cool Thru*	11
HAS0082132	Axial Geared Down Redirected ER32 H=117.55	4	HAS0280240	Radial MTSK-40 Driven VDI40 H=117.55 Cool Thru*	7
HAS0082132	Axial Geared Down Redirected ER32 H=117.55	9	HAS0280240	Radial MTSK-40 VDI40 H=117.55 Cool Thru*	2
HAS0082132	Axial Geared Down Redirected ER32 H=117.55	14	HAS0297132	Axial Geared Up Redirected ERA32 H=130.25	10
HAS0082132	Axial Geared Down Redirected ER32 H=117.55	14	HAS0297232	Axial Geared Up Redirected ERA32 H=130.25 Cool Thru*	10
HAS0084232	Axial Geared Down Redirected ER32 H=117.5 Cool Thru*	14			
HAS0084232	Axial Geared Down ER32 Redirected H=117.55 Cool Thru*	9	HAS0307132	Axial Geared Up Redirected ERA32 H=104.85	5
HAS0084232	Axial Geared Down Redirected ER32 H=117.55 Cool Thru*	4	HAS0307232	Axial Geared Up Redirected ERA32 H=104.85 Cool Thru*	5
HAS0084232	Axial Geared Down Redirected ER32 H=117.55 Cool Thru*	11			
HAS0130132	Radial ER32 Standard H=104.85	1	HAS0317132	Axial Geared Up Redirected ERA32 H=117.55	5
HAS0130232	Radial ER32 H=104.85 Cool Thru*	1	HAS0317132	Axial Geared Up Redirected ERA32 H=117.55	10
HAS0132219	Radial Mill Head H=104.85, D=22mm, L=19mm	1	HAS0317132	Axial Geared Up Redirected ERA32 H=117.55	15
HAS0132721	Radial Mill Head H=104.85, D=27mm, L=21mm	1	HAS0317232	Axial Geared Up Redirected ERA32 H=117.55 Cool Thru*	15
HAS0140132	Radial ER32 Standard H=117.55	1			
HAS0140132	Radial ER32 Standard H=117.55	6	HAS0317232	Axial Geared Up Redirected ERA32 H=117.55 Cool Thru*	10
HAS0140132	Radial ER32 Standard H=117.55	11			
HAS0140232	Radial ER32 H=117.55 Cool Thru*	11			
HAS0140232	Radial ER32 H=117.55 Cool Thru*	6	M		
			MTSK40A02	MTSK-40 Clamping Unit ER32	17

Table of Contents

Part Number Index

MTSK40A03	MTSK-40 Clamping Unit ER25	17
MTSK40B02	MTSK-40 Clamping Unit ERA25	17
MTSK40B03	MTSK-40 Clamping Unit ERA20	17
MTSK40C02	MTSK-40 Clamping Unit 16x17	17
MTSK40C03	MTSK-40 Clamping Unit 3/4"x3/4"	17
MTSK40C04	MTSK-40 Clamping Unit 22x19	17
MTSK40C05	MTSK-40 Clamping Unit 27x21	17
MTSK40D01	MTSK-40 Clamping Unit Weldon 6	17
MTSK40D011	MTSK-40 Clamping Unit Weldon 1/4"	17
MTSK40D012	MTSK-40 Clamping Unit Weldon 5/16"	17
MTSK40D013	MTSK-40 Clamping Unit Weldon 3/8"	17
MTSK40D014	MTSK-40 Clamping Unit Weldon 1/2"	17
MTSK40D02	MTSK-40 Clamping Unit Weldon 8	17
MTSK40D03	MTSK-40 Clamping Unit Weldon 10	17
MTSK40D04	MTSK-40 Clamping Unit Weldon 12	17
MTSK40D06	MTSK-40 Clamping Unit Weldon 16	17
MTSK40D07	MTSK-40 Clamping Unit Weldon 20	17