

# MC 內藏式增壓角固虎鉗 MC HYDRAULIC ANGLE LOCK VISE (BUILT-IN TYPE)

MODEL : MHA-100、MHA-150、MHA-200

本增壓系統保固一年

★PATENT : 152071

ZL 98 2 49250.2

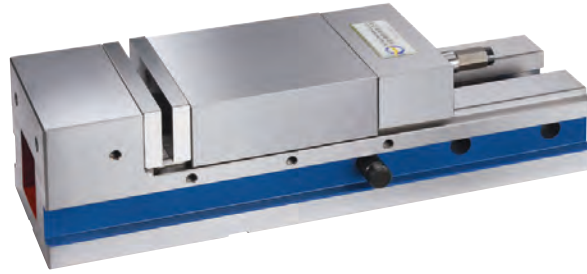

★虎鉗可側立使用  
VISE CAN SIDE-LOCK TO WORK.



角固式配合"半圓球體"下鎖之力，可防止工件上浮。  
Down thrust with "semi-sphere" to prevent work-piece lift.

## 特點：

- 1.虎鉗本台採用球狀石墨化鑄鐵FCD60材質。
- 2.角固式配合"半圓球體"下鎖之力，可防止工件上浮。
- 3.虎鉗可以側立使用。(側立垂直90° 公差=0.015/100mm)
- 4.虎鉗滑動面均經硬化熱處理 HRC45°，堅固耐用、確保精度。
- 5.虎鉗的滑動上蓋座可取出，方便清除虎鉗內部之鐵屑。
- 6.虎鉗本體的高度與導正鍵槽皆做定寸管制，可以2、3、4台一起使用。

## FEATURES :

- 1.Vise body is made of ductile iron FCD 60.
- 2.Down thrust with "semi-sphere" to prevent work-piece lift.
- 3.Vise can side-lock to work. (Perpendicular of side lock 90°=0.015/100mm)
- 4.Vise bed hardened to HRC 45° and maintain accuracy for long.
- 5.Vise slide-chunk can take out, Convenient to clean away chips and inside of vise.
- 6.Vise bed height-size and guide block side are all made with full control, can 2,3,or 4 vises to perform a job at a time.

NO.	檢查項目 Inspection Item (100mm)	容許值 Allowance		1.	4.
		JIN YEAR	JIS CLASS		
1	鉗口面對本台底面導正鍵槽之平行度 Parallelism of guide block side of body bottom face and fixed jaw clamp face.	0.01	0.015		
2	鉗口面對滑動面之垂直度 Squareness of fixed jaw clamp face and jaw slideway.	0.015	0.03		
3	雙側面對滑動面之垂直度 Vise side-lock on bottom with the slide way in vertical.	0.02	0.02		
4	本台滑動面對底面之平行度 Parallelism of body bottom face and jaw slideway.	0.01	0.015		
5	工件夾緊後之上浮量 Top face lift of test block in clamping.	0.02	0.03		
6	工件夾緊後之平行度 Parallelism of top face of clamped test block in clamping.	0.015	0.02		

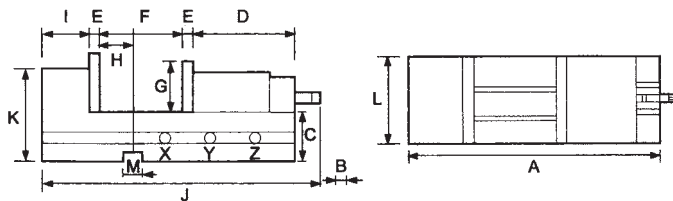

★每台虎鉗的高度與導正鍵槽皆做定寸管制。

The height and the guide block side of every vise are all made with full control.

L-尺寸公差限度0.02或少於

L- Dimension tolerance 0.02 or less.

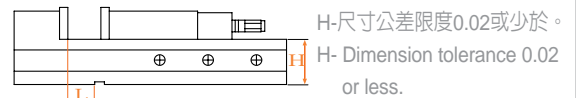

H-尺寸公差限度0.02或少於。

H- Dimension tolerance 0.02 or less.

MODEL	A	B	C	D	E	夾持範圍 Clamping range F			G	H	I	J	K	L	M	f	夾持力 (kgf)	重量 (kg)
						X	Y	Z										
MHA-100	404	14	62	208	12.5	0-85	85-170		42	45	64.5	450 540	102	105	16	50	2500	22
MHA-150	507	19	85	243	15.5	0-90	90-180	180-270	57	65	84.5	620 710	140	152	18	90	5000	50
MHA-200	606	19	95	257	18.5	0-100	100-200	200-300	62	82	89.5	655 755	162	200	18	150	7000	80