



DRIVEN and STATIC TOOLING
For
BARUFFALDI Turrets

Table of Contents

Categorized Listing

VDI30	1
DRIVEN	1
RADIAL DRIVEN TOOL VDI30 - RIGHT HAND	1
RADIAL DRIVEN TOOL VDI30 - LEFT HAND	1
RADIAL REAR-SET DRIVEN TOOL VDI30 H=75mm - RIGHT HAND	2
RADIAL REAR-SET DRIVEN TOOL VDI30 H=75mm - LEFT HAND	3
RADIAL REAR-SET DRIVEN TOOL VDI30 H=85mm - RIGHT HAND	4
RADIAL REAR-SET DRIVEN TOOL VDI30 H=85mm - LEFT HAND	5
RADIAL MTSK-32 REAR SET DRIVEN TOOL VDI30 H=75mm - RIGHT	6
RADIAL MTSK-32 REAR SET DRIVEN TOOL VDI30 H=75mm - LEFT	6
RADIAL MTSK-32 REAR SET DRIVEN TOOL VDI30 H=85mm - RIGHT	7
RADIAL MTSK-32 REAR SET DRIVEN TOOL VDI30 H=85mm - LEFT	7
AXIAL DRIVEN TOOL VDI30	8
VDI40	9
DRIVEN	9
RADIAL DRIVEN TOOL VDI40 H=100mm - RIGHT HAND	9
RADIAL DRIVEN TOOL VDI40 H=100mm - LEFT HAND	9
RADIAL REAR-SET DRIVEN TOOL VDI40 H=85mm - RIGHT HAND	10
RADIAL REAR-SET DRIVEN TOOL VDI40 H=85mm - LEFT HAND	10
RADIAL GEARED-DOWN 2:1 REAR SET DRIVEN TOOL H=85mm VDI40 - RIGHT	10
AXIAL DRIVEN TOOL VDI40	11
AXIAL MTSK-40 DRIVEN TOOL VDI40	11
AXIAL DRIVEN TOOL RE-DIRECTED BY 42mm VDI40 - RIGHT HAND	12
AXIAL GEARED-DOWN 2:1 RE-DIRECTED BY 42mm VDI40 - RIGHT	12
AXIAL GEARED-UP 1:2 DRIVEN TOOL RE-DIRECTED BY 42mm VDI40	13
(0-180) ADJUSTABLE ANGLE DRIVEN TOOL VDI40 - RIGHT HAND	14
(0-180) ADJUSTABLE ANGLE DRIVEN TOOL WITH DIGITAL DISPLAY VDI40	14
BROACHING/SLOTING DRIVEN TOOL 25mm STROKE VDI40	15
BROACHING/SLOTING DRIVEN TOOL 50mm STROKE VDI40	15
VDI50	16
DRIVEN	16
RADIAL DRIVEN TOOL VDI50	16
RADIAL DRIVEN TOOL FOR INTERNAL TOOLING VDI50	16
AXIAL DRIVEN TOOL VDI50	17
AXIAL DRIVEN TOOL RE-DIRECTED BY 60mm VDI50	17
DRIVEN GEAR HOBBER VDI50	18
ACCESSORIES	19
DRIVEN	19
MTSK-32 ER ADAPTORS	19
MTSK-32 MILL ADAPTORS	19
MTSK-40 ER ADAPTORS	20
MTSK-40 MILL ADAPTORS	20

VDI30

DRIVEN

RADIAL DRIVEN TOOL VDI30 - RIGHT HAND

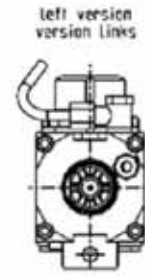
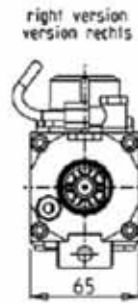
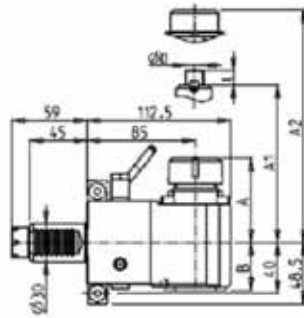

PartNumber	Description	Spindle	I	RPM	Cool Thru	Ext Cool	D	L	A	A1	A2	B
BAR0060125	Radial Driven ER25	ER25	1:1	6000		X			66.2			38
BAR0060225	Radial Driven ER25 Cool Thru*	ER25	1:1	6000	X	X			66.2			48
BAR0060416	Radial Milling Head 16x17	16x17	1:1	6000		X	16	17	45			38
BAR0060422	Radial Milling Head 22x19	22x19	1:1	6000		X	22	19	47			38
BAR0060316	Radial Driven Weldon 16	Weldon 16	1:1	6000		X					54.5	38

* Coolant Thru tools are designed for 1000 psi.
They require 5 Micron Filtration and **CANNOT** be run dry.

RADIAL DRIVEN TOOL VDI30 - LEFT HAND

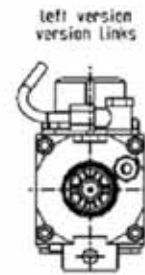
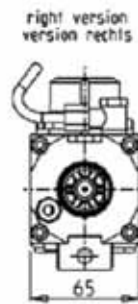
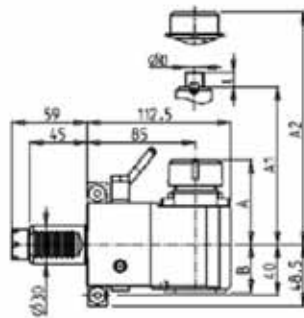

PartNumber	Description	Spindle	I	RPM	Cool Thru	Ext Cool	D	L	A	A1	A2	B
BAR0061125	Radial Driven ER25	ER25	1:1	6000		X			66.2			38
BAR0061225	Radial Driven ER25 Cool Thru*	ER25	1:1	6000	X	X			66.2			48
BAR0061416	Radial Milling Head 16x17	16x17	1:1	6000		X	16	17	45			38
BAR0061422	Radial Milling Head 22x19	22x19	1:1	6000		X	22	19	47			38
BAR0061316	Radial Driven Weldon 16	Weldon 16	1:1	6000		X					54.5	38

* Coolant Thru tools are designed for 1000 psi.
They require 5 Micron Filtration and **CANNOT** be run dry.

VDI30

DRIVEN

RADIAL REAR-SET DRIVEN TOOL VDI30 H=75mm - RIGHT HAND

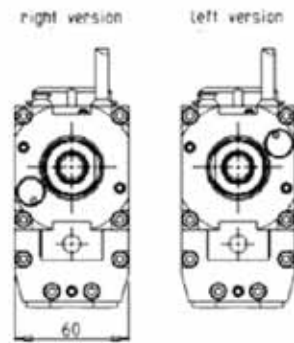
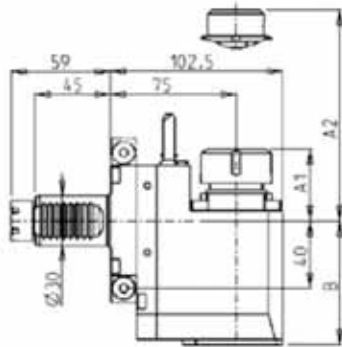

PartNumber	Description	Spindle	I	RPM	Cool Thru	Ext Cool	A1	A2	B
BAR0080120	Radial Rear-Set ER20	ER20	1:1	6000		X	41.16	73.5	
BAR0080320	Radial Rear-Set ERA20	ERA20	1:1	6000		X	24.5	73.5	
BAR0080420	Radial Rear-Set ERA20 Cool Thru*	ERA20	1:1	6000	X	X	24.5	83.5	
BAR0080125	Radial Rear-Set ER25	ER25	1:1	6000		X	42.16	73.5	
BAR0080225	Radial Rear-Set ER25 Cool Thru*	ER25	1:1	6000	X	X	42.16	83.5	
BAR0080325	Radial Rear-Set ERA25	ERA25	1:1	6000		X	28.5	73.5	
BAR0080425	Radial Rear-Set ERA25 Cool Thru*	ERA25	1:1	6000	X	X	28.5	83.5	
BAR0080516	Radial Rear-Set Weldon16	Weldon 16	1:1	6000		X		27.5	73.5

* Coolant Thru tools are designed for 1000 psi.
They require 5 Micron Filtration and **CANNOT** be run dry.

VDI30

DRIVEN

RADIAL REAR-SET DRIVEN TOOL VDI30 H=75mm - LEFT HAND

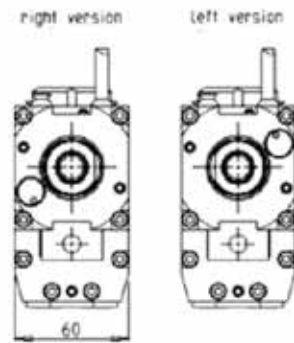
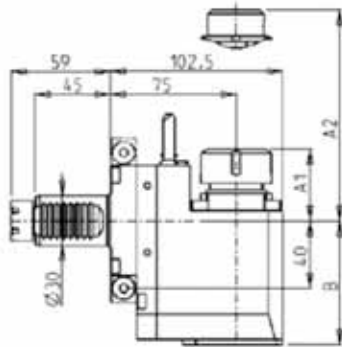

PartNumber	Description	Spindle	I	RPM	Cool Thru	Ext Cool	A1	A2	B
BAR0081120	Radial Rear-Set ER20	ER20	1:1	6000		X	41.16	73.5	
BAR0081320	Radial Rear-Set ERA20	ERA20	1:1	6000		X	24.5	73.5	
BAR0081420	Radial Rear-Set ERA20 Cool Thru*	ERA20	1:1	6000	X	X	24.5	83.5	
BAR0081125	Radial Rear-Set ER25	ER25	1:1	6000		X	42.16	73.5	
BAR0081225	Radial Rear-Set ER25 Cool Thru*	ER25	1:1	6000	X	X	42.16	83.5	
BAR0081325	Radial Rear-Set ERA25	ERA25	1:1	6000		X	28.5	73.5	
BAR0081425	Radial Rear-Set ERA25 Cool Thru*	ERA25	1:1	6000	X	X	28.5	83.5	
BAR0081516	Radial Rear-Set Weldon16	Weldon 16	1:1	6000		X		27.5	73.5

* Coolant Thru tools are designed for 1000 psi.
They require 5 Micron Filtration and **CANNOT** be run dry.

VDI30

DRIVEN

RADIAL REAR-SET DRIVEN TOOL VDI30 H=85mm - RIGHT HAND

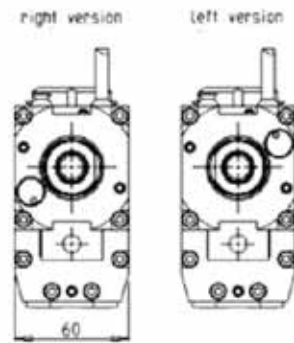
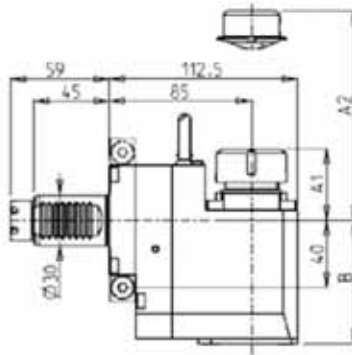

PartNumber	Description	Spindle	I	RPM	Cool Thru	Ext Cool	A1	A2	B
BAR0070120	Radial Rear-Set ER20	ER20	1:1	6000		X	41.16	73.5	
BAR0070320	Radial Rear-Set ERA20	ERA20	1:1	6000		X	24.5	73.5	
BAR0070420	Radial Rear-Set ERA20 Cool Thru*	ERA20	1:1	6000	X	X	24.5	83.5	
BAR0070125	Radial Rear-Set ER25	ER25	1:1	6000		X	42.16	73.5	
BAR0070225	Radial Rear-Set ER25 Cool Thru*	ER25	1:1	6000	X	X	42.16	83.5	
BAR0070325	Radial Rear-Set ERA25	ERA25	1:1	6000		X	28.5	73.5	
BAR0070425	Radial Rear-Set ERA25 Cool Thru*	ERA25	1:1	6000	X	X	28.5	83.5	
BAR0070516	Radial Rear-Set Weldon16	Weldon 16	1:1	6000		X		27.5	73.5

* Coolant Thru tools are designed for 1000 psi.
They require 5 Micron Filtration and **CANNOT** be run dry.

VDI30

DRIVEN

RADIAL REAR-SET DRIVEN TOOL VDI30 H=85mm - LEFT HAND

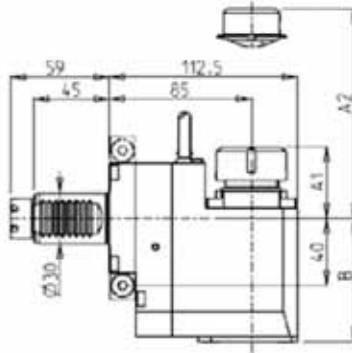

right version

left version



PartNumber	Description	Spindle	I	RPM	Cool Thru	Ext Cool	A1	A2	B
BAR0071120	Radial Rear-Set ER20	ER20	1:1	6000		X	41.16		73.5
BAR0071320	Radial Rear-Set ERA20	ERA20	1:1	6000		X	24.5		73.5
BAR0071420	Radial Rear-Set ERA20 Cool Thru*	ERA20	1:1	6000	X	X	24.5		83.5
BAR0071125	Radial Rear-Set ER25	ER25	1:1	6000		X	42.16		73.5
BAR0071225	Radial Rear-Set ER25 Cool Thru*	ER25	1:1	6000	X	X	42.16		83.5
BAR0071325	Radial Rear-Set ERA25	ERA25	1:1	6000		X	28.5		73.5
BAR0071425	Radial Rear-Set ERA25 Cool Thru*	ERA25	1:1	6000	X	X	28.5		83.5
BAR0071516	Radial Rear-Set Weldon16	Weldon 16	1:1	6000		X		27.5	73.5

* Coolant Thru tools are designed for 1000 psi.
They require 5 Micron Filtration and **CANNOT** be run dry.

VDI30

DRIVEN

RADIAL MTSK-32 REAR SET DRIVEN TOOL VDI30 H=75mm - RIGHT HAND

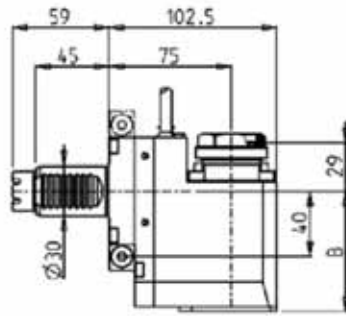

right version
version rechts



left version
version links



PartNumber	Description	Spindle	I	RPM	Cool Thru	Ext Cool	B
BAR0170132	Radial MTSK-32	MTSK-32	1:1	6000		X	73.5
BAR0170232	Radial MTSK-32 Cool Thru*	MTSK-32	1:1	6000	X	X	83.5

* Coolant Thru tools are designed for 1000 psi.
They require 5 Micron Filtration and **CANNOT** be run dry.

RADIAL MTSK-32 REAR SET DRIVEN TOOL VDI30 H=75mm - LEFT HAND

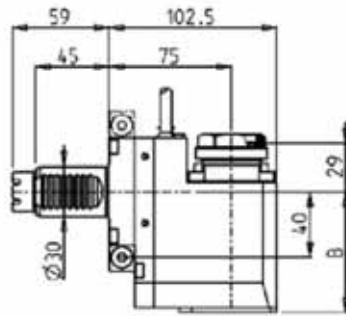

right version
version rechts



left version
version links

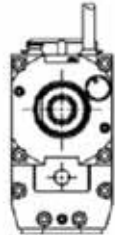

PartNumber	Description	Spindle	I	RPM	Cool Thru	Ext Cool	B
BAR0171132	Radial MTSK-32	MTSK-32	1:1	6000		X	73.5
BAR0171232	Radial MTSK-32 Cool Thru*	MTSK-32	1:1	6000	X	X	83.5

* Coolant Thru tools are designed for 1000 psi.
They require 5 Micron Filtration and **CANNOT** be run dry.

VDI30

DRIVEN

RADIAL MTSK-32 REAR SET DRIVEN TOOL VDI30 H=85mm - RIGHT HAND

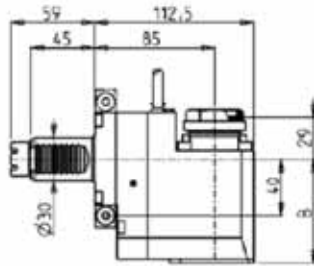

PartNumber	Description	Spindle	I	RPM	Cool Thru	Ext Cool	B
BAR0160132	Radial MTSK-32	MTSK-32	1:1	6000		X	73.5
BAR0160232	Radial MTSK-32 Cool Thru*	MTSK-32	1:1	6000	X	X	83.5

* Coolant Thru tools are designed for 1000 psi. They require 5 Micron Filtration and **CANNOT** be run dry.

RADIAL MTSK-32 REAR SET DRIVEN TOOL VDI30 H=85mm - LEFT HAND

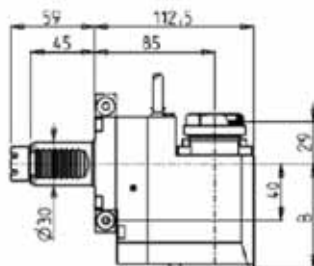

PartNumber	Description	Spindle	I	RPM	Cool Thru	Ext Cool	B
BAR0161132	Radial MTSK-32	MTSK-32	1:1	6000		X	73.5
BAR0161232	Radial MTSK-32 Cool Thru*	MTSK-32	1:1	6000	X	X	83.5

* Coolant Thru tools are designed for 1000 psi. They require 5 Micron Filtration and **CANNOT** be run dry.

VDI30

DRIVEN

AXIAL DRIVEN TOOL VDI30

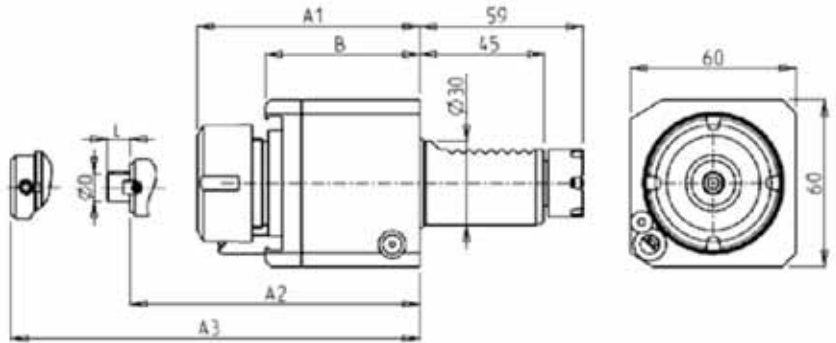

PartNumber	Description	Spindle	I	RPM	Cool Thru	Ext Cool	D	L	A1	A2	A3	B
BAR0040125	Axial Driven ER25	ER25	1:1	6000		X			80.66			56
BAR0041125	Axial Driven ER25 Cool Thru*	ER25	1:1	6000	X	X			94.66			59
BAR0040225	Axial Driven ERA25	ERA25	1:1	6000	X	X			61			56
BAR0041225	Axial Driven ERA25 Cool Thru*	ERA25	1:1	6000	X	X			84.03			59
BAR0040416	Axial VDI30 Milling Head 16x17	16x17	1:1	6000		X	16	17		59.5		56
BAR0040422	Axial VDI30 Milling Head 22x19	22x19	1:1	6000		X	22	19		61.5		56
BAR0040316	Axial Driven Weldon16	Weldon 16	1:1	6000		X					66.5	56
BAR0041316	Axial Driven Weldon16 Cool Thru*	Weldon 16	1:1	6000	X	X					80	70

* Coolant Thru tools are designed for 1000 psi.
They require 5 Micron Filtration and **CANNOT** be run dry.

VDI40

DRIVEN

RADIAL DRIVEN TOOL VDI40 H=100mm - RIGHT HAND

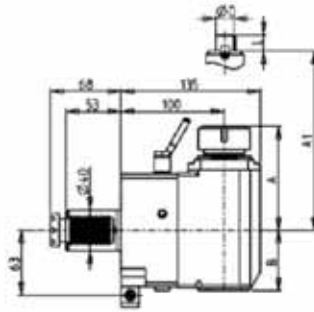

right version
version rechts



left version
version links

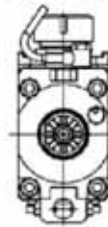

PartNumber	Description	Spindle	I	RPM	Cool Thru	Ext Cool	A	A1	B	D	L
BAR0210132	Radial ER32 VDI40	ER32	1:1	4000		X	99.7		58.5		
BAR0210232	Radial ER32 VDI40 Cool Thru*	ER32	1:1	4000	X	X	99.7		69.5		
BAR0210140	Radial ER40 VDI40	ER40	1:1	4000		X	103.7		58.5		
BAR0210240	Radial ER40 VDI40 Cool Thru*	ER40	1:1	4000	X	X	103.7		69.5		
BAR0210522	Radial Milling Head 22x19 VDI40	22x19	1:1	4000		X		78.5	58.5	22	19
BAR0210527	Radial Milling Head 27x21 VDI40	27x21	1:1	4000		X		78.5	58.5	27	21

* Coolant Thru tools are designed for 1000 psi.
They require 5 Micron Filtration and **CANNOT** be run dry.

RADIAL DRIVEN TOOL VDI40 H=100mm - LEFT HAND

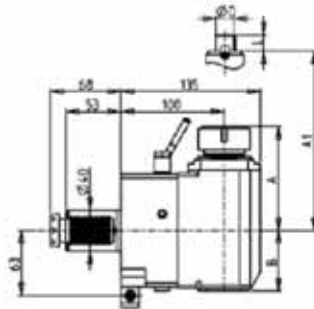

right version
version rechts



left version
version links

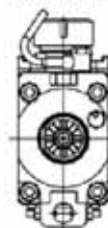

PartNumber	Description	Spindle	I	RPM	Cool Thru	Ext Cool	A	A1	B	D	L
BAR0211132	Radial ER32 VDI40	ER32	1:1	4000		X	99.7		58.5		
BAR0211232	Radial ER32 VDI40 Cool Thru*	ER32	1:1	4000	X	X	99.7		69.5		
BAR0211140	Radial ER40 VDI40	ER40	1:1	4000		X	103.7		58.5		
BAR0211240	Radial ER40 VDI40 Cool Thru*	ER40	1:1	4000	X	X	103.7		69.5		
BAR0211522	Radial Milling Head 22x19 VDI40	22x19	1:1	4000		X		78.5	58.5	22	19
BAR0211527	Radial Milling Head 27x21 VDI40	27x21	1:1	4000		X		78.5	58.5	27	21

* Coolant Thru tools are designed for 1000 psi.
They require 5 Micron Filtration and **CANNOT** be run dry.

VDI40

DRIVEN

RADIAL REAR-SET DRIVEN TOOL VDI40 H=85mm - RIGHT HAND

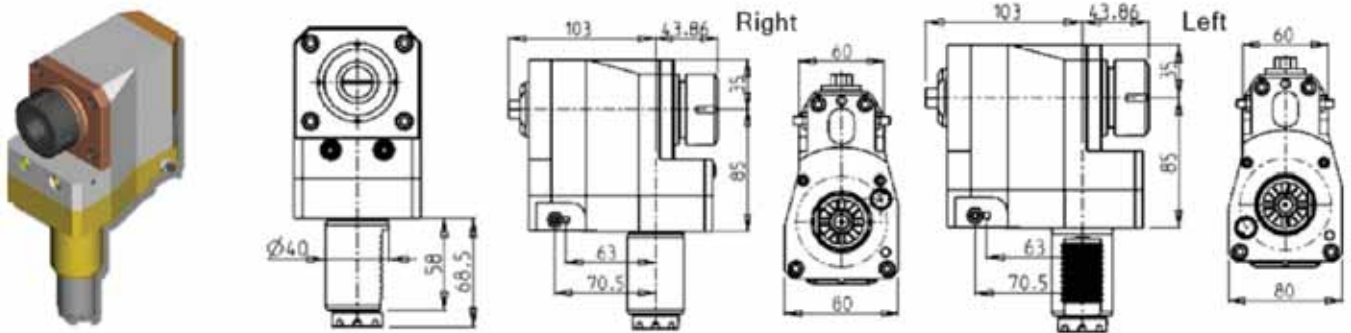

PartNumber	Description	Orientation	Spindle	I	RPM	Ext Cool
161BAR_R32_40C00	Radial Rear-Set ER32	Right Hand	ER32	1:1	4000	X

RADIAL REAR-SET DRIVEN TOOL VDI40 H=85mm - LEFT HAND

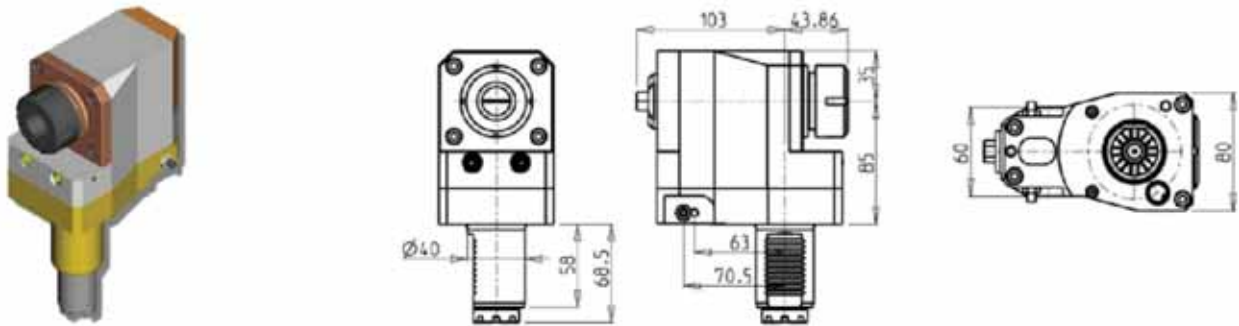

PartNumber	Description	Orientation	Spindle	I	RPM	Ext Cool
161BAR_R32_40C20	Radial Rear-Set ER32	Left Hand	ER32	1:1	4000	X

RADIAL GEARED-DOWN 2:1 REAR SET DRIVEN TOOL H=85mm VDI40 - RIGHT HAND

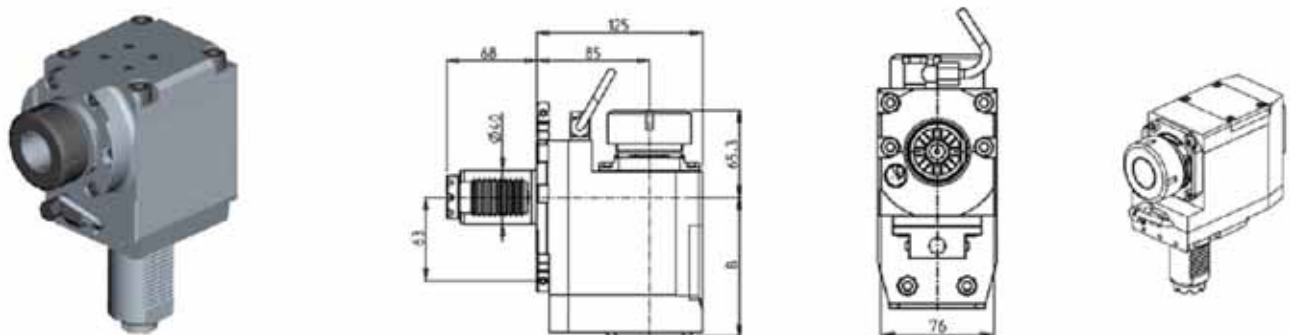

PartNumber	Description	Spindle	I	RPM	Cool Thru	Ext Cool	B
BAR0150140	Radial Geared-Down ER40	ER40	2:1	2000		X	105
BAR0150240	Radial Geared-Down ER40 Cool Thru*	ER40	2:1	2000	X	X	118.5

* Coolant Thru tools are designed for 1000 psi. They require 5 Micron Filtration and **CANNOT** be run dry.

VDI40

DRIVEN

AXIAL DRIVEN TOOL VDI40

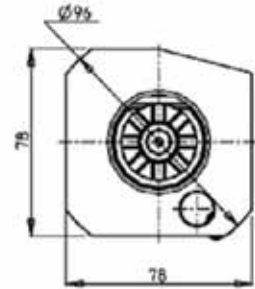
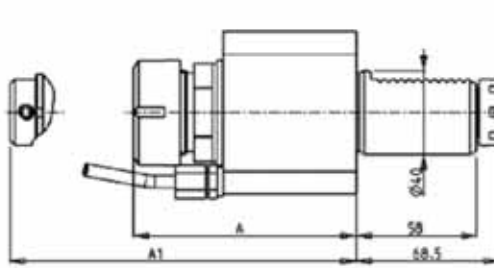

PartNumber	Description	Spindle	I	RPM	Cool Thru	Ext Cool	A	A1
162BAR_A32_40C00	Axial ER32	ER32	1:1	4000		X	107.3	
BAR0130232	Axial ER32 Cool Thru*	ER32	1:1	4000	X	X	110.5	
BAR0130420	Axial Weldon 20	Weldon 20	1:1	4000		X		97.3

* Coolant Thru tools are designed for 1000 psi.
They require 5 Micron Filtration and **CANNOT** be run dry.

AXIAL MTSK-40 DRIVEN TOOL VDI40

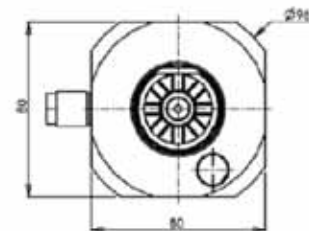
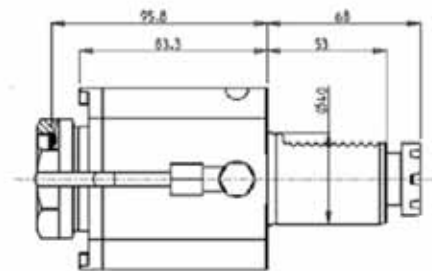

PartNumber	Description	Spindle	I	RPM	Ext Cool
BAR0220140	Axial MTSK-40	MTSK-40	1:1	4000	X

VDI40

DRIVEN

AXIAL DRIVEN TOOL RE-DIRECTED BY 42mm VDI40 - RIGHT HAND

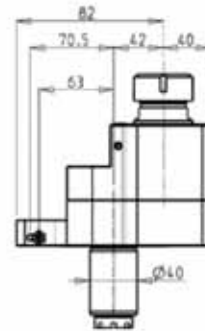
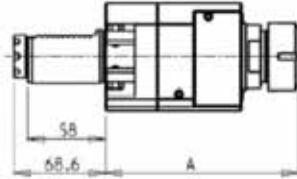

PartNumber	Description	Orientation	Spindle	I	RPM	Cool Thru	Ext Cool	A
165BAR_A32_40C00	Axial Re-Directed ER32	Right Hand	ER32	1:1	4000		X	144.46
165BAR_A32_40C10	Axial Re-Directed ER32 Cool Thru*	Right Hand	ER32	1:1	4000	X		164.96

* Coolant Thru tools are designed for 1000 psi.
They require 5 Micron Filtration and **CANNOT** be run dry.

AXIAL GEARED-DOWN 2:1 RE-DIRECTED BY 42mm VDI40 - RIGHT HAND

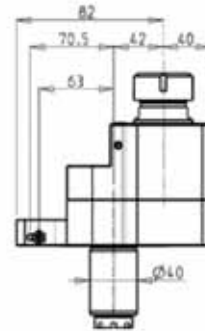

PartNumber	Description	Orientation	Spindle	I	RPM	Cool Thru	Ext Cool	A
165BAR_A32_40C20	Axial Geared-Down ER32	Right Hand	ER32	2:1	2000		X	144.46
165BAR_A32_40C30	Axial Geared-Down ER32 Cool Thru*	Right Hand	ER32	2:1	2000	X		164.96

* Coolant Thru tools are designed for 1000 psi.
They require 5 Micron Filtration and **CANNOT** be run dry.

VDI40

DRIVEN

AXIAL GEARED-UP 1:2 DRIVEN TOOL RE-DIRECTED BY 42mm VDI40

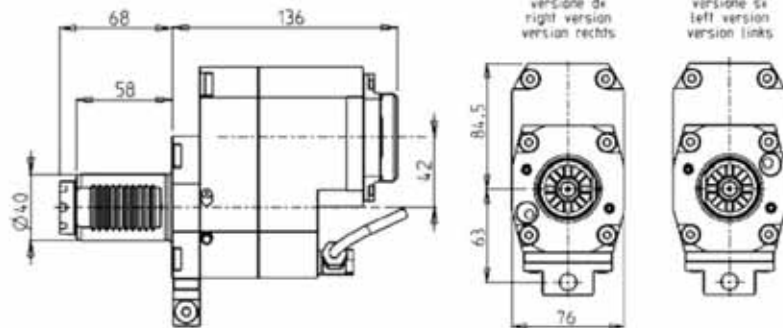

PartNumber	Description	Spindle	I	RPM	Cool Thru	Ext Cool
BAR0126132	Axial Geared-Up ERA32 Right Hand	ERA32	1:2	8000		X
BAR0126232	Axial Geared-Up ERA32 Right Hand Cool Thru*	ERA32	1:2	8000	X	X
BAR0127132	Axial Geared-Up ERA32 Left Hand	ERA32	1:2	8000		X
BAR0127232	Axial Geared-Up ERA32 Left Hand Cool Thru*	ERA32	1:2	8000	X	X

* Coolant Thru tools are designed for 1000 psi.
They require 5 Micron Filtration and **CANNOT** be run dry.

VDI40

DRIVEN

(0-180) ADJUSTABLE ANGLE DRIVEN TOOL VDI40 - RIGHT HAND

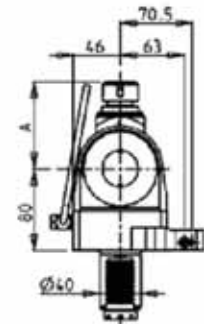
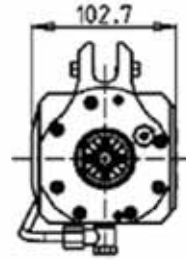
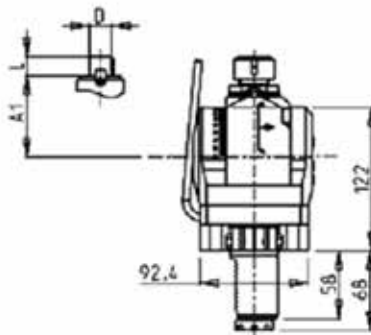

PartNumber	Description	Spindle	I	RPM	Ext Cool	A	A1	D	L
BAR0200120	(0-180) Adj. Angle ER20	ER20	1:1	4000	X	85.16			
BAR0200125	(0-180) Adj. Angle ER25	ER25	1:1	4000	X	86.16			
BAR0200519	(0-180) Adj. Angle 3/4"x3/4"	3/4"x3/4"	1:1	4000	X		65	3/4"	3/4"
BAR0200516	(0-180) Adj. Angle 16x17	16x17	1:1	4000	X		65	16	17
BAR0200522	(0-180) Adj. Angle 22x19	22x19	1:1	4000	X		66	22	19

Note : Wrenches are provided with the purchase of Specialty Toolholders

(0-180) ADJUSTABLE ANGLE DRIVEN TOOL WITH DIGITAL DISPLAY VDI40 - RIGHT HAND

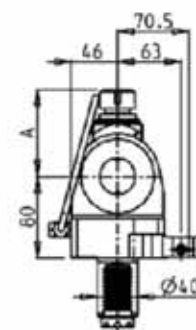
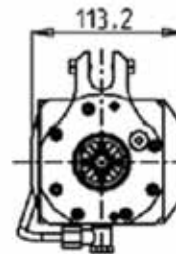
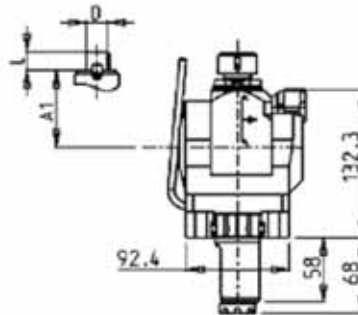

PartNumber	Description	Spindle	I	RPM	Ext Cool	A	A1	D	L
BAR0190120	(0-180) Adj. Angle ER20 with Digital Display	ER20	1:1	4000	X	85.16			
BAR0190125	(0-180) Adj. Angle ER25 with Digital Display	ER25	1:1	4000	X	86.16			
BAR0190519	(0-180) Adj. Angle 3/4"x3/4" with Digital Display	3/4"x3/4"	1:1	4000	X		65	3/4"	3/4"
BAR0190516	(0-180) Adj. Angle 16x17 with Digital Display	16x17	1:1	4000	X		65	16	17
BAR0190522	(0-180) Adj. Angle 22x19 with Digital Display	22x19	1:1	4000	X		66	22	19

Note : Wrenches are provided with the purchase of Specialty Toolholders

VDI40

DRIVEN

BROACHING/SLOTTING DRIVEN TOOL 25mm STROKE VDI40

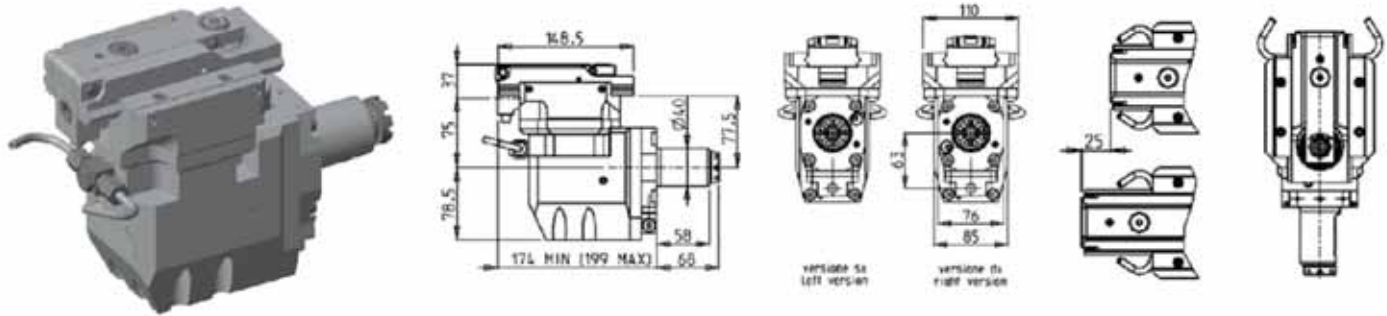

PartNumber	Description	I	MAX RPM	Ext Cool	VDI
BAR0180200	Broaching/Slotting 25mm Stroke Right Hand	4:1	2400	X	Right Hand
BAR0181200	Broaching/Slotting 25mm Stroke Left Hand	4:1	2400	X	Left Hand

Note : Wrenches are provided with the purchase of Specialty Toolholders

BROACHING/SLOTTING DRIVEN TOOL 50mm STROKE VDI40

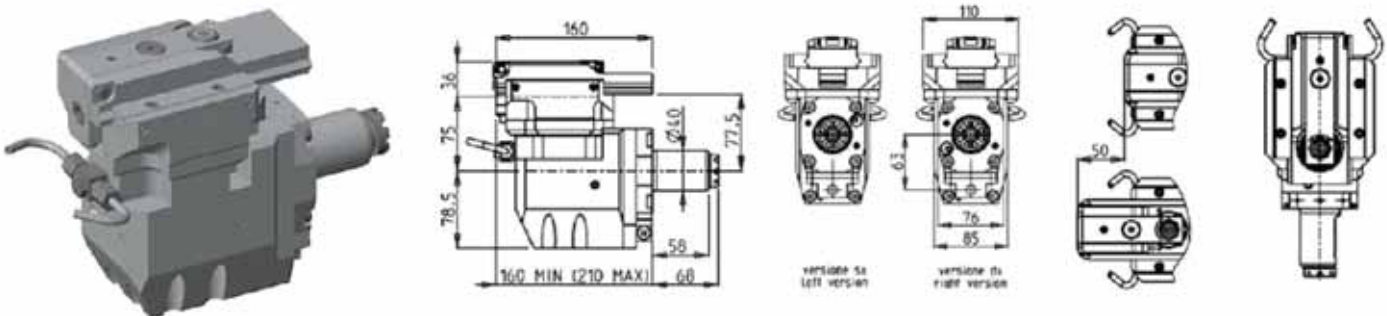

PartNumber	Description	I	MAX RPM	Ext Cool	VDI
BAR0180100	Broaching/Slotting 50mm Stroke Right Hand	4:1	2000	X	Right Hand
BAR0181100	Broaching/Slotting 50mm Stroke Left Hand	4:1	2000	X	Left Hand

Note : Wrenches are provided with the purchase of Specialty Toolholders

VDI50

DRIVEN

RADIAL DRIVEN TOOL VDI50

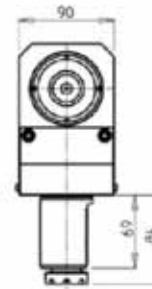
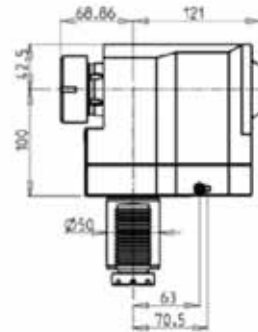

PartNumber	Description	Orientation	Spindle	I	RPM	Ext Cool
181BAR_R40_50C00	Radial VDI50 ER40 RH	Right Hand	ER40	1:1	4000	X
181BAR_R40_50C20	Radial VDI50 ER40 LH	Left Hand	ER40	1:1	4000	X

RADIAL DRIVEN TOOL FOR INTERNAL TOOLING VDI50

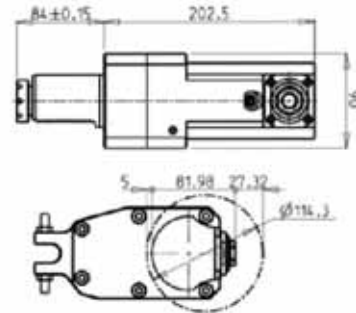
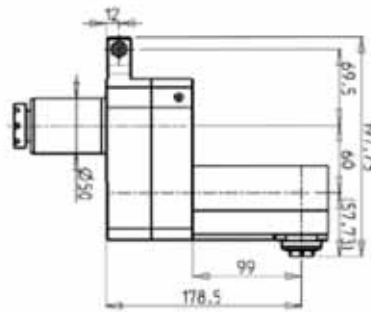

PartNumber	Description	Orientation	Spindle	I	MAX RPM	Ext Cool
BAR0010120	Radial ERA20 Right Hand	Right Hand	ERA20	1:1	4000	X

VDI50

DRIVEN

AXIAL DRIVEN TOOL VDI50

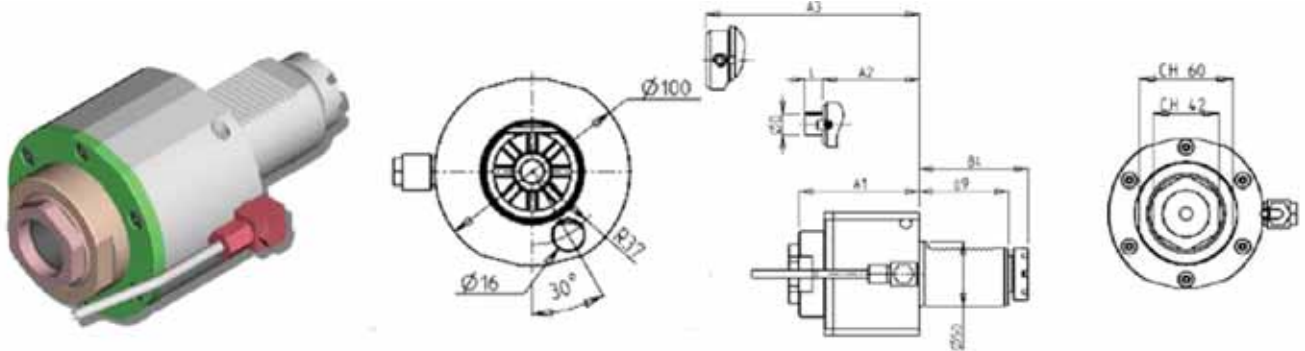

PartNumber	Description	Spindle	I	RPM	Cool Thru	Ext Cool	A1	A2	A3	D	L
BAR0020140	Axial ERA40	ERA40	1:1	4000		X	92.5				
BAR0020240	Axial ERA40 Cool Thru*	ERA40	1:1	4000	X	X	92.5				
BAR0020522	Axial Milling Head 22x19	22x19	1:1	4000		X		88.5		22	19
BAR0020725	Axial Weldon25	Weldon 25	1:1	4000	X	X			116.5		

* Coolant Thru tools are designed for 1000 psi.
They require 5 Micron Filtration and **CANNOT** be run dry.

AXIAL DRIVEN TOOL RE-DIRECTED BY 60mm VDI50

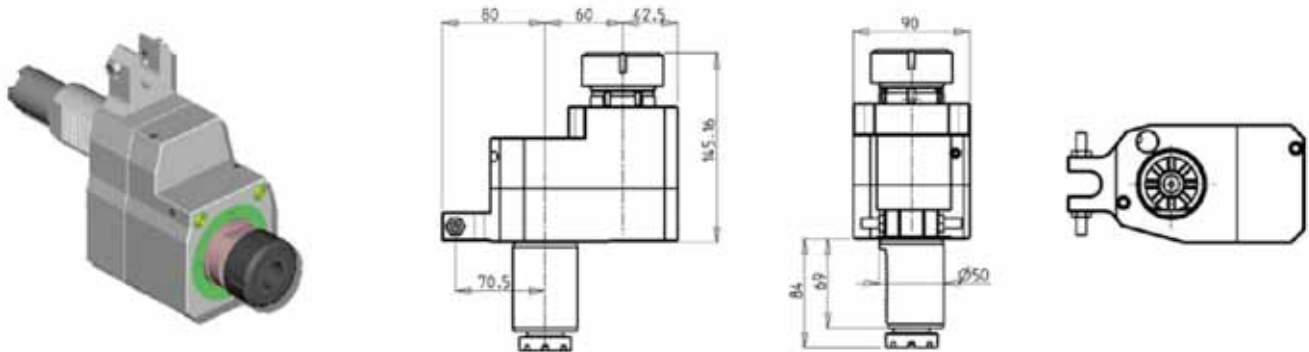

PartNumber	Description	Orientation	Spindle	I	RPM	Ext Cool
185BAR_A40_50C00	Axial ER40 Right Hand	Right Hand	ER40	1:1	4000	X

VDI50

DRIVEN

DRIVEN GEAR HOBBER VDI50

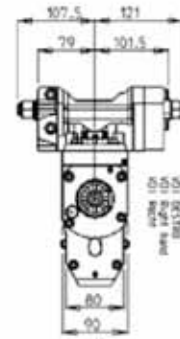
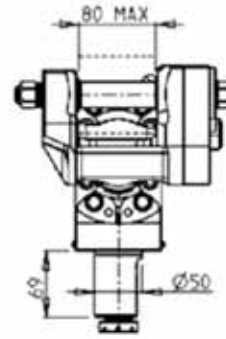
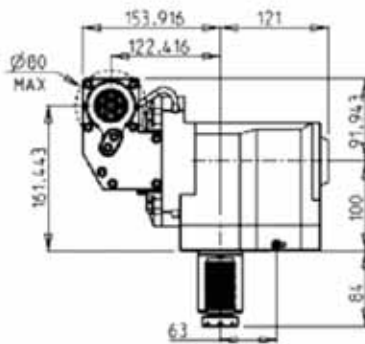

PartNumber	Description	I	RPM	Ext Cool	D (mm)	D (Inch)
BAR0051100	Gear Hobber	1:1	4000	X	16-22-27-32	3/4"-1"-1 1/4"
BAR0052100	Gear Hobber 2:1	2:1	2000	X	16-22-27-32	3/4"-1"-1 1/4"

Note : Wrenches are provided with the purchase of Specialty Toolholders

ACCESSORIES

DRIVEN

MTSK-32 ER ADAPTORS



Cod. MT	Mandrina Spindle Spindel	A
MTSK32A03	ER25	31.7

Cod. MT	Mandrina Spindle Spindel	A
MTSK32B03	ERA20	19
MTSK32B04	ERA16	13

PartNumber	Description	Spindle	A
MTSK32B04	MTSK-32 Adaptor ERA16	ERA16	13
MTSK32B03	MTSK-32 Adaptor ERA20	ERA20	19
MTSK32A03	MTSK-32 Adaptor ER25	ER25	31.7

MTSK-32 MILL ADAPTORS

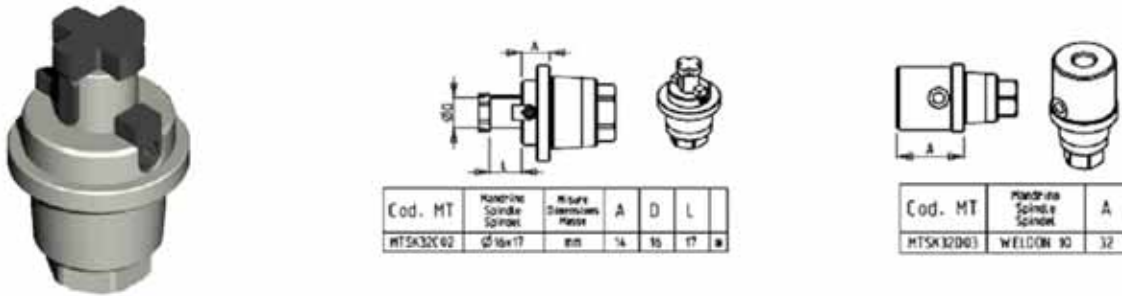

Cod. MT	Mandrina Spindle Spindel	Welding Dimensions	A	D	L
MTSK32C02	16x17	mm	14	16	17

Cod. MT	Mandrina Spindle Spindel	A
MTSK32D03	WELDON 10	32

PartNumber	Description	Spindle	Dimensions	A	D	L
MTSK32C02	MTSK-32 Adaptor Mill 16x17	16x17	mm	14	16	17
MTSK32D03	MTSK-32 Adaptor Weldon 10	Weldon 10		32		

ACCESSORIES

DRIVEN

MTSK-40 ER ADAPTORS

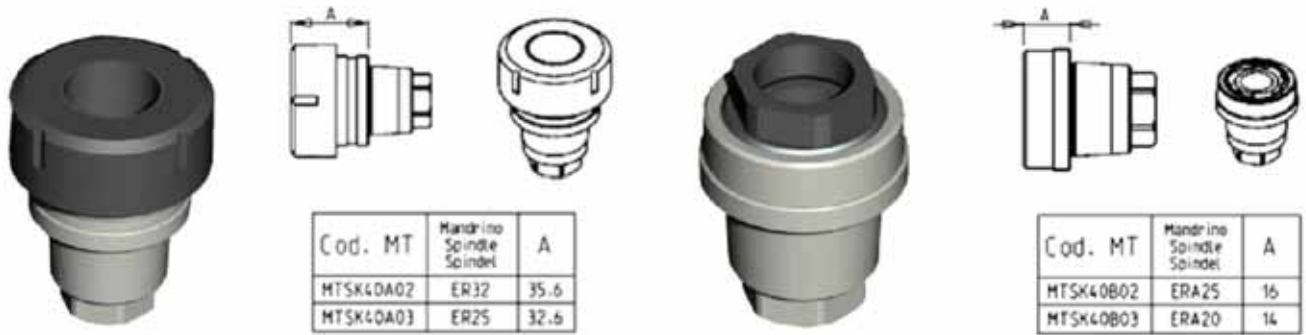

PartNumber	Description	Spindle	A
MTSK40B03	MTSK-40 Adaptor ERA20	ERA20	14
MTSK40A03	MTSK-40 Adaptor ER25	ER25	32.6
MTSK40B02	MTSK-40 Adaptor ERA25	ERA25	16
MTSK40A02	MTSK-40 Adaptor ER32	ER32	35.6

MTSK-40 MILL ADAPTORS

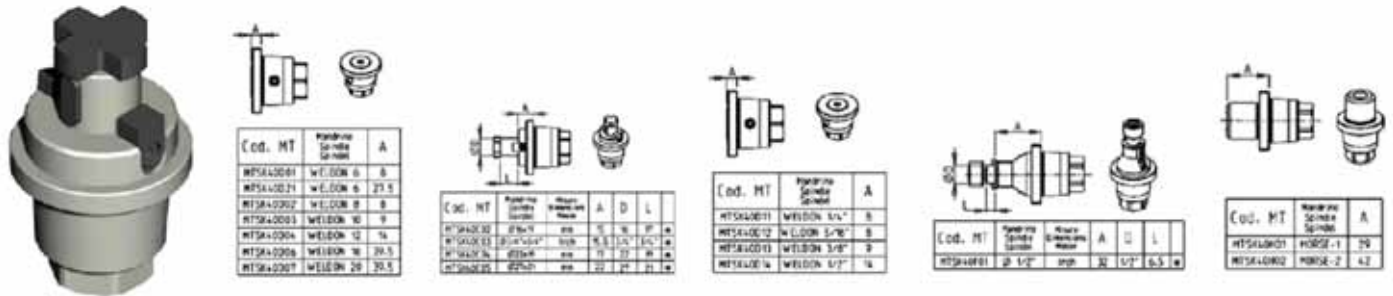

PartNumber	Description	Spindle	Dimension	A	D	L
MTSK40C03	MTSK-40 Adaptor Mill 3/4"	3/4"x3/4"	Inch	15.5	3/4"	3/4"
MTSK40C02	MTSK-40 Adaptor Mill 16x17	16x17	mm	15	16	17
MTSK40C04	MTSK-40 Adaptor Mill 22x19	22x19	mm	17	22	19
MTSK40C05	MTSK-40 Adaptor Mill 27x21	27x21	mm	22	27	21
MTSK40F01	MTSK-40 Adaptor Mill 1/2"	1/2" Arbor	Inch	32	1/2"	6.5
MTSK40D11	MTSK-40 Adaptor Weldon 1/4"	Weldon 1/4"		8		
MTSK40D12	MTSK-40 Adaptor Weldon 5/16"	Weldon 5/16"		8		
MTSK40D13	MTSK-40 Adaptor Weldon 3/8"	Weldon 3/8"		9		
MTSK40D14	MTSK-40 Adaptor Weldon 1/2"	Weldon 1/2"		14		
MTSK40D01	MTSK-40 Adaptor Weldon 6	Weldon 6		8		
MTSK40D21	MTSK-40 Adaptor Weldon 6	Weldon 6		27.5		
MTSK40D02	MTSK-40 Adaptor Weldon 8	Weldon 8		8		
MTSK40D03	MTSK-40 Adaptor Weldon 10	Weldon 10		9		
MTSK40D04	MTSK-40 Adaptor Weldon 12	Weldon 12		14		
MTSK40D06	MTSK-40 Adaptor Weldon 16	Weldon 16		39.5		
MTSK40D07	MTSK-40 Adaptor Weldon 20	Weldon 20		39.5		
MTSK40H01	MTSK-40 Adaptor Morse 1	MORSE-1		29		
MTSK40H02	MTSK-40 Adaptor Morse 2	MORSE-2		42		

ER COLLETS

ER COLLET NUMBER	DESCRIPTION	MD LIST PRICE
ER16-SET	ER16 Collet Set (11 Collets)	\$ 150.00
ERX16-SET	ER16 Sealed Collet Set (9 Collets)	\$ 220.00
ER20 SET	ER20 Collet Set (15 Collets)	\$ 220.00
ERX20-SET	ER20 Sealed Collet Set (13 Collets)	\$ 315.00
ER25-SET	ER25 Collet Set (19 Collets)	\$ 275.00
ERX25-SET	ER25 Sealed Collet Set (17 Collets)	\$ 430.00
ER32-SET	ER32 Collet Set (21 Collets)	\$ 315.00
ERX32-SET	ER32 Sealed Collet Set (21 Collets)	\$ 588.00
ER40-SET	ER40 Collet Set (29 Collets)	\$ 575.00
ERX40-SET	ER40 Sealed Collet Set (27 Collets)	\$ 800.00

LIVE TOOL WRENCHES

ER COLLET NUMBER	DESCRIPTION	
From List Above	ER Collet Wrench (Identify Holder)	
From List Above	Spindle Locking Wrench (Identify Holder)	

Table of Contents

Alphabetized Listing

(
(0-180) ADJUSTABLE ANGLE DRIVEN TOOL VDI40 - RIGHT HAND	14
(0-180) ADJUSTABLE ANGLE DRIVEN TOOL WITH DIGITAL	14
A	
ACCESSORIES	19-20
AXIAL DRIVEN TOOL RE-DIRECTED BY 42mm VDI40 - RIGHT HAND	17
AXIAL DRIVEN TOOL RE-DIRECTED BY 60mm VDI50	17
AXIAL DRIVEN TOOL VDI30	8
AXIAL DRIVEN TOOL VDI40	11
AXIAL DRIVEN TOOL VDI50	17
AXIAL GEARED-DOWN 2:1 RE-DIRECTED BY 42mm VDI40 - RIGHT HAND	17
AXIAL GEARED-UP 1:2 DRIVEN TOOL RE-DIRECTED BY 42mm VDI40	17
AXIAL MTSK-40 DRIVEN TOOL VDI40	11
B	
BROACHING/SLOTING DRIVEN TOOL 25mm STROKE VDI40	15
BROACHING/SLOTING DRIVEN TOOL 50mm STROKE VDI40	15
D	
DRIVEN	1-20
DRIVEN GEAR HOBBER VDI50	18
M	
MTSK-32 ER ADAPTORS	19
MTSK-32 MILL ADAPTORS	19
MTSK-40 ER ADAPTORS	20
MTSK-40 MILL ADAPTORS	20
R	
RADIAL DRIVEN TOOL FOR INTERNAL TOOLING VDI50	16
RADIAL DRIVEN TOOL VDI30 - LEFT HAND	1
RADIAL DRIVEN TOOL VDI30 - RIGHT HAND	1
RADIAL DRIVEN TOOL VDI40 H=100mm - LEFT HAND	9
RADIAL DRIVEN TOOL VDI40 H=100mm - RIGHT HAND	9
RADIAL DRIVEN TOOL VDI50	16
RADIAL GEARED-DOWN 2:1 REAR SET DRIVEN TOOL H=85mm	10
RADIAL MTSK-32 REAR SET DRIVEN TOOL VDI30 H=75mm - LEFT HAND	6
RADIAL MTSK-32 REAR SET DRIVEN TOOL VDI30 H=75mm - RIGHT HAND	6
RADIAL MTSK-32 REAR SET DRIVEN TOOL VDI30 H=85mm - LEFT HAND	7
RADIAL MTSK-32 REAR SET DRIVEN TOOL VDI30 H=85mm - RIGHT HAND	7
RADIAL REAR-SET DRIVEN TOOL VDI30 H=75mm - LEFT HAND	3
RADIAL REAR-SET DRIVEN TOOL VDI30 H=75mm - RIGHT HAND	2
RADIAL REAR-SET DRIVEN TOOL VDI30 H=85mm - LEFT HAND	5
RADIAL REAR-SET DRIVEN TOOL VDI30 H=85mm - RIGHT HAND	4
RADIAL REAR-SET DRIVEN TOOL VDI40 H=85mm - LEFT HAND	10
RADIAL REAR-SET DRIVEN TOOL VDI40 H=85mm - RIGHT HAND	10
V	
VDI30	1-8
VDI40	9-15
VDI50	16-18

Table of Contents

Part Number Index

1							
161BAR_R32_40C00	Radial Rear-Set ER32	10	BAR0126232	Axial Geared-Up ERA32 Right Hand Cool Thru*	13		
161BAR_R32_40C20	Radial Rear-Set ER32	10	BAR0127132	Axial Geared-Up ERA32 Left Hand	13		
162BAR_A32_40C00	Axial ER32	11	BAR0127232	Axial Geared-Up ERA32 Left Hand Cool Thru*	13		
165BAR_A32_40C00	Axial Re-Directed ER32	12	BAR0130232	Axial ER32 Cool Thru*	11		
165BAR_A32_40C10	Axial Re-Directed ER32 Cool Thru*	12	BAR0130420	Axial Weldon 20	11		
165BAR_A32_40C20	Axial Geared-Down ER32	12	BAR0150140	Radial Geared-Down ER40	10		
165BAR_A32_40C30	Axial Geared-Down ER32 Cool Thru*	12	BAR0150240	Radial Geared-Down ER40 Cool Thru*	10		
181BAR_R40_50C00	Radial VDI50 ER40 RH	16	BAR0160132	Radial MTSK-32	7		
181BAR_R40_50C20	Radial VDI50 ER40 LH	16	BAR0160232	Radial MTSK-32 Cool Thru*	7		
185BAR_A40_50C00	Axial ER40 Right Hand	17	BAR0161132	Radial MTSK-32	7		
			BAR0161232	Radial MTSK-32 Cool Thru*	7		
			BAR0170132	Radial MTSK-32	6		
			BAR0170232	Radial MTSK-32 Cool Thru*	6		
			BAR0171132	Radial MTSK-32	6		
			BAR0171232	Radial MTSK-32 Cool Thru*	6		
			BAR0180100	Broaching/Slotting 50mm Stroke Right Hand	15		
B			BAR0180200	Broaching/Slotting 25mm Stroke Right Hand	15		
BAR0010120	Radial ERA20 Right Hand	16	BAR0181100	Broaching/Slotting 50mm Stroke Left Hand	15		
BAR0020140	Axial ERA40	17	BAR0181200	Broaching/Slotting 25mm Stroke Left Hand	15		
BAR0020240	Axial ERA40 Cool Thru*	17	BAR0190120	(0-180) Adj. Angle ER20 with Digital Display	14		
BAR0020522	Axial Milling Head 22x19	17	BAR0190125	(0-180) Adj. Angle ER25 with Digital Display	14		
BAR0020725	Axial Weldon25	17	BAR0190516	(0-180) Adj. Angle 16x17 with Digital Display	14		
BAR0040125	Axial Driven ER25	8	BAR0190519	(0-180) Adj. Angle 3/4"x3/4" with Digital Display	14		
BAR0040225	Axial Driven ERA25	8	BAR0190522	(0-180) Adj. Angle 22x19 with Digital Display	14		
BAR0040316	Axial Driven Weldon16	8	BAR0200120	(0-180) Adj. Angle ER20	14		
BAR0040416	Axial VDI30 Milling Head 16x17	8	BAR0200125	(0-180) Adj. Angle ER25	14		
BAR0040422	Axial VDI30 Milling Head 22x19	8	BAR0200516	(0-180) Adj. Angle 16x17	14		
BAR0041125	Axial Driven ER25 Cool Thru*	8	BAR0200519	(0-180) Adj. Angle 3/4"x3/4"	14		
BAR0041225	Axial Driven ERA25 Cool Thru*	8	BAR0200522	(0-180) Adj. Angle 22x19	14		
BAR0041316	Axial Driven Weldon16 Cool Thru*	8	BAR0210132	Radial ER32 VDI40	9		
BAR0051100	Gear Hobber	18	BAR0210140	Radial ER40 VDI40	9		
BAR0052100	Gear Hobber 2:1	18	BAR0210232	Radial ER32 VDI40 Cool Thru*	9		
BAR0060125	Radial Driven ER25	1	BAR0210240	Radial ER40 VDI40 Cool Thru*	9		
BAR0060225	Radial Driven ER25 Cool Thru*	1	BAR0210522	Radial Milling Head 22x19 VDI40	9		
BAR0060316	Radial Driven Weldon 16	1	BAR0210527	Radial Milling Head 27x21 VDI40	9		
BAR0060416	Radial Milling Head 16x17	1	BAR0211132	Radial ER32 VDI40	9		
BAR0060422	Radial Milling Head 22x19	1	BAR0211140	Radial ER40 VDI40	9		
BAR0061125	Radial Driven ER25	1	BAR0211232	Radial ER32 VDI40 Cool Thru*	9		
BAR0061225	Radial Driven ER25 Cool Thru*	1	BAR0211240	Radial ER40 VDI40 Cool Thru*	9		
BAR0061316	Radial Driven Weldon 16	1	BAR0211522	Radial Milling Head 22x19 VDI40	9		
BAR0061416	Radial Milling Head 16x17	1	BAR0211527	Radial Milling Head 27x21 VDI40	9		
BAR0061422	Radial Milling Head 22x19	1	BAR0220140	Axial MTSK-40	11		
BAR0070120	Radial Rear-Set ER20	4					
BAR0070125	Radial Rear-Set ER25	4	M				
BAR0070225	Radial Rear-Set ER25 Cool Thru*	4	MTSK32A03	MTSK-32 Adaptor ER25	19		
BAR0070320	Radial Rear-Set ERA20	4	MTSK32B03	MTSK-32 Adaptor ERA20	19		
BAR0070325	Radial Rear-Set ERA25	4	MTSK32B04	MTSK-32 Adaptor ERA16	19		
BAR0070420	Radial Rear-Set ERA20 Cool Thru*	4	MTSK32C02	MTSK-32 Adaptor Mill 16x17	19		
BAR0070425	Radial Rear-Set ERA25 Cool Thru*	4	MTSK32D03	MTSK-32 Adaptor Weldon 10	19		
BAR0070516	Radial Rear-Set Weldon16	4	MTSK40A02	MTSK-40 Adaptor ER32	20		
BAR0071120	Radial Rear-Set ER20	5	MTSK40A03	MTSK-40 Adaptor ER25	20		
BAR0071125	Radial Rear-Set ER25	5	MTSK40B02	MTSK-40 Adaptor ERA25	20		
BAR0071225	Radial Rear-Set ER25 Cool Thru*	5	MTSK40B03	MTSK-40 Adaptor ERA20	20		
BAR0071320	Radial Rear-Set ERA20	5	MTSK40C02	MTSK-40 Adaptor Mill 16x17	20		
BAR0071325	Radial Rear-Set ERA25	5	MTSK40C03	MTSK-40 Adaptor Mill 3/4"	20		
BAR0071420	Radial Rear-Set ERA20 Cool Thru*	5	MTSK40C04	MTSK-40 Adaptor Mill 22x19	20		
BAR0071425	Radial Rear-Set ERA25 Cool Thru*	5	MTSK40C05	MTSK-40 Adaptor Mill 27x21	20		
BAR0071516	Radial Rear-Set Weldon16	5	MTSK40D01	MTSK-40 Adaptor Weldon 6	20		
BAR0080120	Radial Rear-Set ER20	2	MTSK40D02	MTSK-40 Adaptor Weldon 8	20		
BAR0080125	Radial Rear-Set ER25	2	MTSK40D03	MTSK-40 Adaptor Weldon 10	20		
BAR0080225	Radial Rear-Set ER25 Cool Thru*	2	MTSK40D04	MTSK-40 Adaptor Weldon 12	20		
BAR0080320	Radial Rear-Set ERA20	2	MTSK40D06	MTSK-40 Adaptor Weldon 16	20		
BAR0080325	Radial Rear-Set ERA25	2					
BAR0080420	Radial Rear-Set ERA20 Cool Thru*	2					
BAR0080425	Radial Rear-Set ERA25 Cool Thru*	2					
BAR0080516	Radial Rear-Set Weldon16	2					
BAR0081120	Radial Rear-Set ER20	3					
BAR0081125	Radial Rear-Set ER25	3					
BAR0081225	Radial Rear-Set ER25 Cool Thru*	3					
BAR0081320	Radial Rear-Set ERA20	3					
BAR0081325	Radial Rear-Set ERA25	3					
BAR0081420	Radial Rear-Set ERA20 Cool Thru*	3					
BAR0081425	Radial Rear-Set ERA25 Cool Thru*	3					
BAR0081516	Radial Rear-Set Weldon16	3					
BAR0126132	Axial Geared-Up ERA32 Right Hand	13					

Table of Contents

Part Number Index

MTSK40D07	MTSK-40 Adaptor Weldon 20	20
MTSK40D11	MTSK-40 Adaptor Weldon 1/4"	20
MTSK40D12	MTSK-40 Adaptor Weldon 5/16"	20
MTSK40D13	MTSK-40 Adaptor Weldon 3/8"	20
MTSK40D14	MTSK-40 Adaptor Weldon 1/2"	20
MTSK40D21	MTSK-40 Adaptor Weldon 6	20
MTSK40F01	MTSK-40 Adaptor Mill 1/2"	20
MTSK40H01	MTSK-40 Adaptor Morse 1	20
MTSK40H02	MTSK-40 Adaptor Morse 2	20