

.....DRIVEN TOOLING
For
MAZAK

SQT 15-18M/MS/MY/MSY - SQT200-250M/MS/MY/MSY 12 STATION - QT NEXUS 200-250M/MS/MSY 12 STATION - QT NEXUS 20011-25011 M/MS/MY/MSY 12 STATION - SUPER QUADREX 200-250M

DRIVEN

RADIAL DRIVEN TOOL

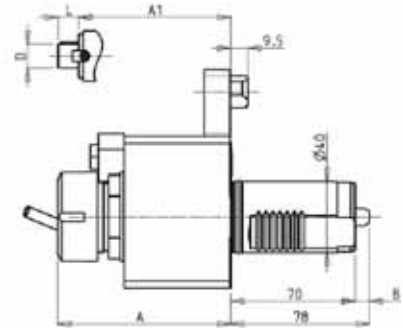
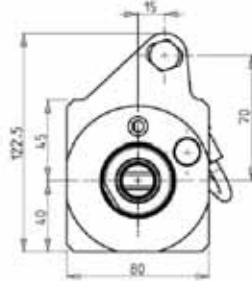

PartNumber	Description	Spindle	I	RPM	Coolant Thru	Ext Coolant	A	A1	D	L
MZK0090225	ERA25 Standard	ERA25	1:1	6000		X	83.33			
MZK0090232	ER32 Standard	ER32	1:1	6000		X	97.46			
MZK0091232	ER32 Coolant Thru*	ER32	1:1	6000	X	X	110.46			
MZK0092219	Milling Head D=22mm, L=19mm	22x19	1:1	6000		X		98.8	22	19

* Coolant Thru tools are designed for 1000 psi. They require 5 Micron Filtration and **CANNOT** be run dry.

RADIAL RE-DIRECTED DRIVEN TOOL 50mm

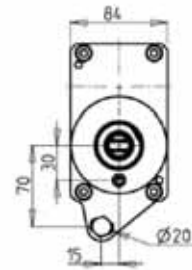
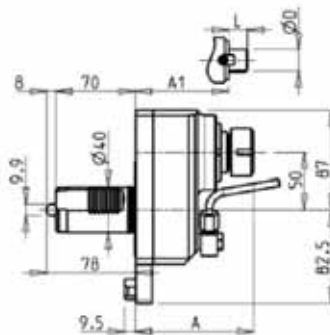
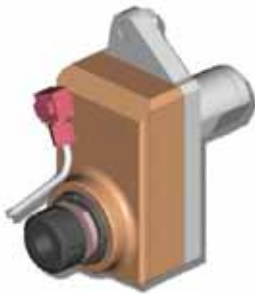

PartNumber	Description	Spindle	I	RPM	Ext Coolant	A	A1	D	L
MZK0010025	ER25 Redirected	ER25	1:1	6000	X	106.1			
MZK0010032	ER32 Redirected	ER32	1:1	6000	X	118.1			
MZK0010017	Milling Head D=16mm, L=17mm Redirected	16x17	1:1	6000	X		86	16	17
MZK0010019	Milling Head D=22mm, L=19mm Redirected	22x19	1:1	6000	X		88	22	19
MZK0010027	Milling Head D=27mm, L=21mm Redirected	27x21	1:1	6000	X		90	27	21

SQT 15-18M/MS/MY/MSY - SQT200-250M/MS/MY/MSY 12 STATION - QT NEXUS 200-250M/MS/MSY 12 STATION - QT NEXUS 20011-25011 M/MS/MY/MSY 12 STATION - SUPER QUADREX 200-250M

DRIVEN

GEARED DOWN RADIAL REDIRECTED TOOL IN Z BY 50mm

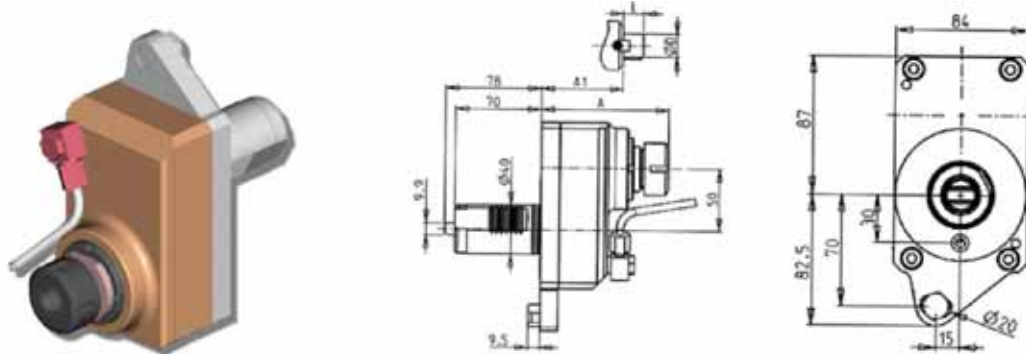

PartNumber	Description	Spindle	I	RPM	Ext Coolant	A	A1	D	L
MZK0011232	Geared Down 2:1 ER32 Redirected	ER32	2:1	3000	X	118.1			
MZK0011227	Geared Down 2:1 Mill Head D=27mm, L=21mm Redirected	27x21	2:1	3000	X		90	27	21

GEARED UP RADIAL REDIRECTED TOOL IN Z BY 50mm

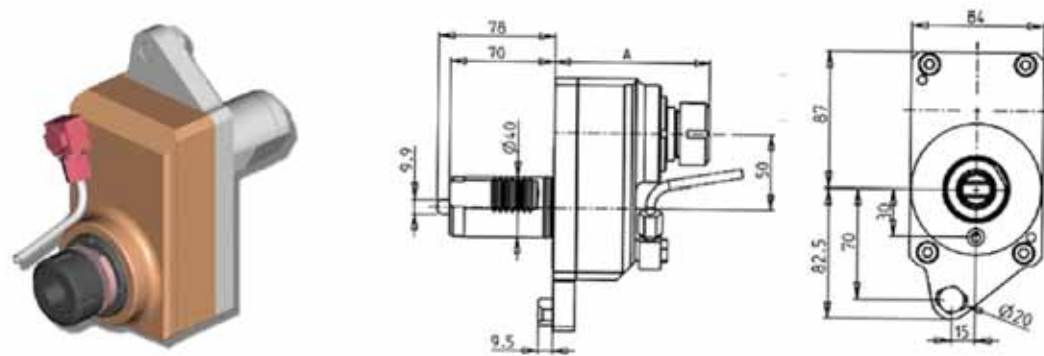

PartNumber	Description	Spindle	I	RPM	Ext Coolant	A
MZK0012125	Geared Up 1:2 ER25 Redirected	ER25	1:2	12000	X	106.2
MZK0012132	Geared Up 1:2 ER32 Redirected	ER32	1:2	12000	X	118.7

SQT 15-18M/MS/MY/MSY - SQT200-250M/MS/MY/MSY 12 STATION - QT NEXUS 200-250M/MS/MSY 12 STATION - QT NEXUS 20011-25011 M/MS/MY/MSY 12 STATION - SUPER QUADREX 200-250M

DRIVEN

RADIAL REINFORCED REDIRECTED IN Z BY 50mm

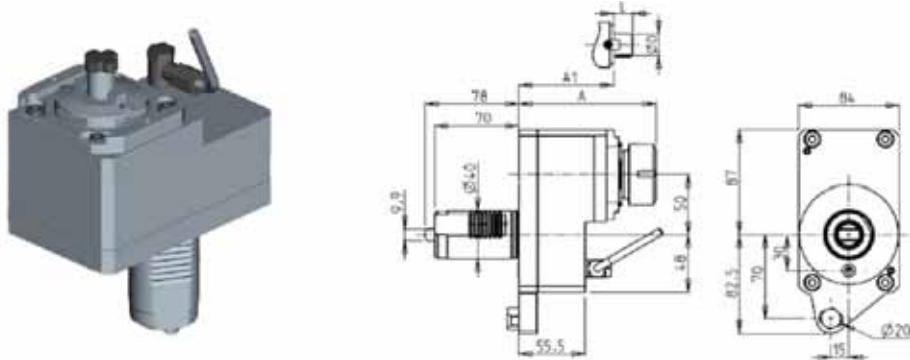

PartNumber	Description	Spindle	I	RPM	Ext. Coolant	A	A1	D	L
MZK0241125	Reinforced ER25 Re-Directed in Z by 50mm	ER25	1:1	6000	X	111.6			
MZK0241132	Reinforced ER32 Re-Directed in Z by 50mm	ER32	1:1	6000	X	114.6			
MZK0241116	Milling Head D=16mm, L=17mm, Reinforced Redirected	16x17	1:1	6000	X		88	16	17
MZK0241122	Milling Head D=22mm, L=19mm, Reinforced Redirected	22x19	1:1	6000	X		90	22	19
MZK0241127	Milling Head D=27mm, L=21mm, Reinforced Redirected	27x21	1:1	6000	X		92	27	21

RADIAL REINFORCED GEARED-DOWN REDIRECTED IN Z BY 50mm

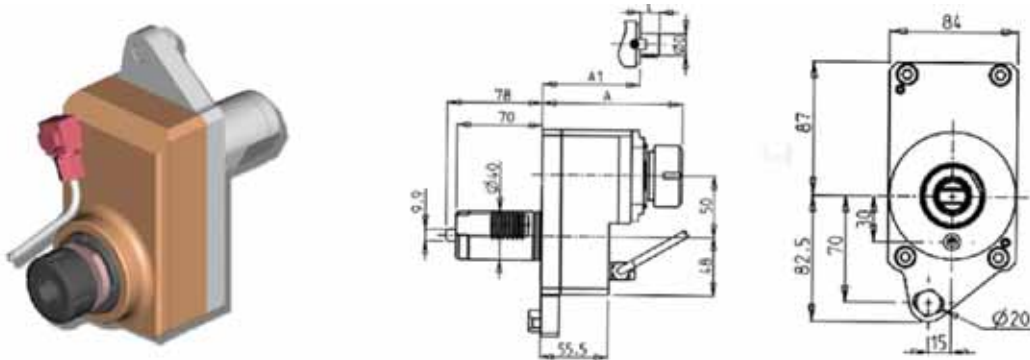

PartNumber	Description	Spindle	I	RPM	Ext. Coolant	A	A1	D	L
MZK0241225	Reinforced Geared-Down Redirected in Z by 50mm ER25	ER25	2:1	3000	X	111.6			
MZK0241232	Reinforced Geared-Down Redirected in Z by 50mm ER32	ER32	2:1	3000	X	114.6			
MZK0241216	Milling Head D=16mm, L=17mm Reinforced Geared-Down Redirected	16x17	2:1	3000	X		88	16	17
MZK0241222	Milling Head D=22mm, L=19mm Reinforced Geared-Down Redirected	22x19	2:1	3000	X		90	22	19
MZK0241227	Milling Head D=27mm, L=21mm Reinforced Geared-Down Redirected	27x21	2:1	3000	X		92	27	21

SQT 15-18M/MS/MY/MSY - SQT200-250M/MS/MY/MSY 12 STATION - QT NEXUS 200-250M/MS/MSY 12 STATION - QT NEXUS 20011-25011 M/MS/MY/MSY 12 STATION - SUPER QUADREX 200-250M

DRIVEN

RADIAL GEARED-UP REINFORCED REDIRECTED IN Z BY 50mm

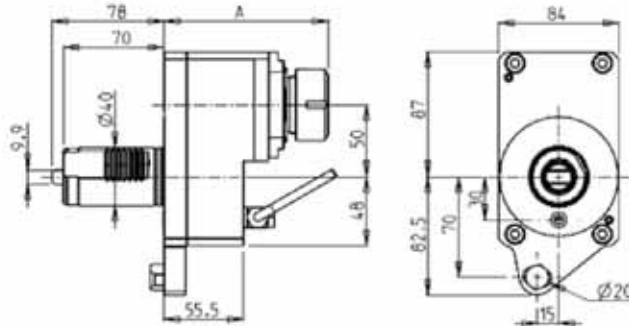

PartNumber	Description	Spindle	I	RPM	Ext. Coolant	A
MZK0242125	Geared-Up Reinforced ER25 Redirected in Z by 50mm	ER25	1:2	12000	X	111.6
MZK0242132	Geared-Up Reinforced ER32 Redirected in Z by 50mm	ER32	1:2	12000	X	114.6

AXIAL DRIVEN TOOL

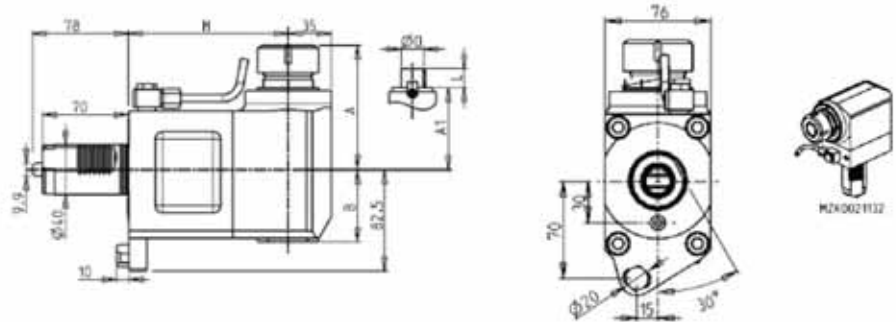

PartNumber	Description	Spindle	I	RPM	Coolant Thru	Ext Coolant	A	A1	B	D	L	H
MZK0020132	ER32 Standard	ER32	1:1	6000		X	101.1		58.5			130
MZK0021132	ER32 Standard H=80	ER32	1:1	6000		X	101.1		58.5			80
MZK0021032	ER32 Coolant Thru*	ER32	1:1	6000	X	X	101.1		82			130
MZK0020022	Milling Head D=22mm, L=19mm	22x19	1:1	6000		X		78.5	58.5	22	19	130
MZK0020027	Milling Head D=27mm, L=21mm	27x21	1:1	6000		X		78.5	58.5	27	21	130

* Coolant Thru tools are designed for 1000 psi. They require 5 Micron Filtration and **CANNOT** be run dry.

SQT 15-18M/MS/MY/MSY - SQT200-250M/MS/MY/MSY 12 STATION - QT NEXUS 200-250M/MS/MSY 12 STATION - QT NEXUS 20011-25011 M/MS/MY/MSY 12 STATION - SUPER QUADREX 200-250M

DRIVEN

AXIAL MTSK DRIVEN TOOL

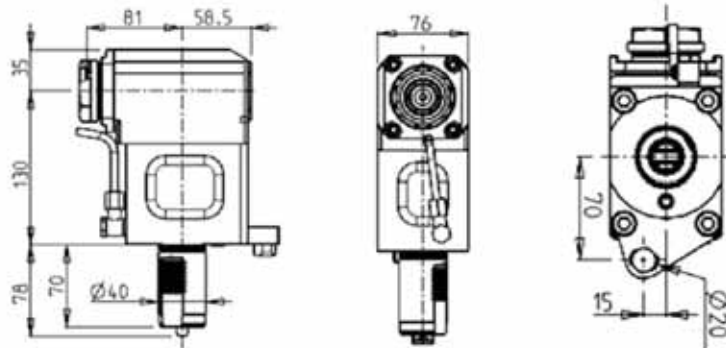

PartNumber	Description	Spindle	I	RPM	Ext. Coolant
MZK0280140	Axial MTSK-40	MTSK-40	1:1	6000	X

AXIAL DRIVEN OPPOSITE FACE TOOL

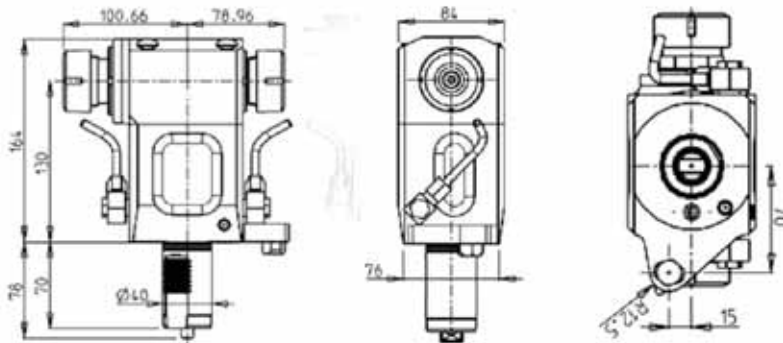

PartNumber	Description	Spindle	I	RPM	Ext. Coolant
MZK0160232	Opposite Face Double Outler ER32/ER32	ER32+ER32	1:1	6000	X

AXIAL OPPOSITE FACE REAR-SET DRIVEN TOOL

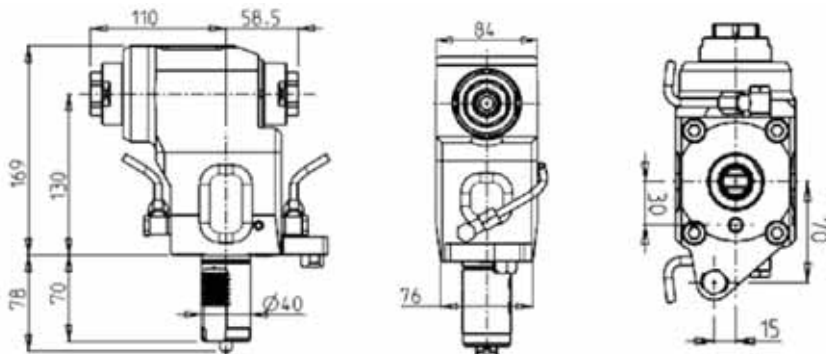
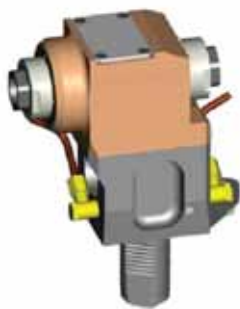

PartNumber	Description	Spindle	I	RPM	Ext. Coolant
MZK0210232	Opposite Face Rear-Set ERA32+ERA32	ERA32+ERA32	1:1	6000	X

SQT 15-18M/MS/MY/MSY - SQT200-250M/MS/MY/MSY 12 STATION - QT NEXUS 200-250M/MS/MSY 12 STATION - QT NEXUS 20011-25011 M/MS/MY/MSY 12 STATION - SUPER QUADREX 200-250M

DRIVEN

0-90 ADJUSTABLE ANGLE DRIVEN TOOL

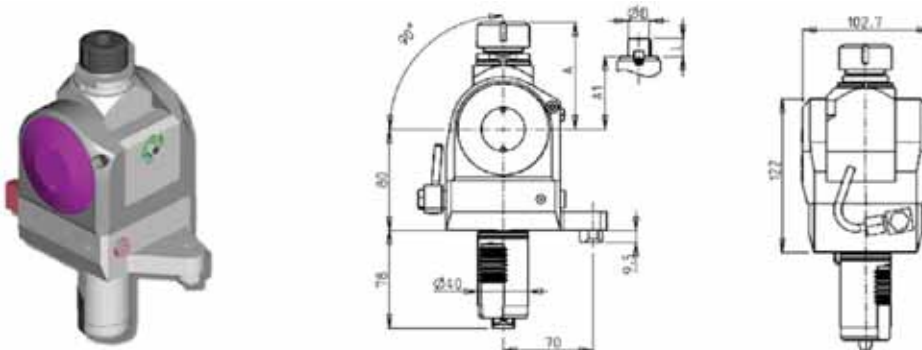

PartNumber	Description	Spindle	I	RPM	Ext Coolant	A	A1	D	L
MZK0100020	Adjustable Angle (0-90) ER20	ER20	1:1	6000	X	84.16			
MZK0100025	Adjustable Angle (0-90) ER25	ER25	1:1	6000	X	85.66			
MZK0101905	Adjustable Angle (0-90) Mill Head D=3/4, L=3/4	3/4"x3/4"	1:1	6000	X		65	3/4"	3/4"
MZK0101617	Adj. Angle (0-90) Milling Head D=16mm, L=17mm	16x17	1:1	6000	X		65	16	17
MZK0102219	Adj. Angle (0-90) Milling Head D=22mm, L=19mm	22x19	1:1	6000	X		66	22	19

Note : Wrenches are provided with the purchase of Specialty Toolholders

0-180 ADJUSTABLE ANGEL DRIVEN TOOL

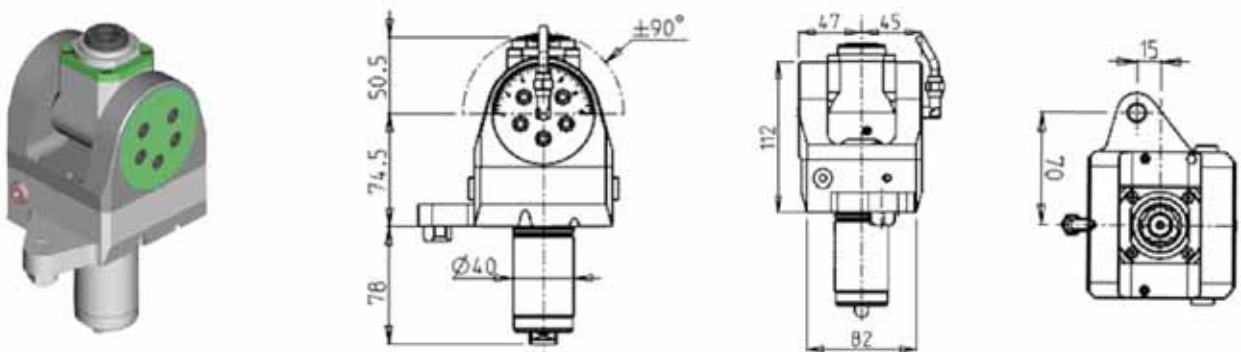

PartNumber	Description	Spindle	I	RPM	Coolant Thru	Ext. Coolant
MZK0250120	Adjustable Angle (0-180) ERA20	ERA20	1:1	6000		X
MZK0250220	Adjustable Angle (0-180) ERA20 Coolant Thru*	ERA20	1:1	6000	X	X

* Coolant Thru tools are designed for 1000 psi. They require 5 Micron Filtration and **CANNOT** be run dry.

Note : Wrenches are provided with the purchase of Specialty Toolholders

SQT 15-18M/MS/MY/MSY - SQT200-250M/MS/MY/MSY 12 STATION - QT NEXUS 200-250M/MS/MSY 12 STATION - QT NEXUS 20011-25011 M/MS/MY/MSY 12 STATION - SUPER QUADREX 200-250M

DRIVEN

0-180 GEARED UP ADJUSTABLE ANGLE DRIVEN TOOL

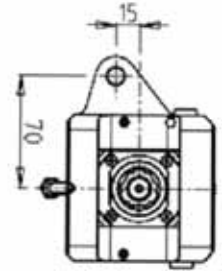
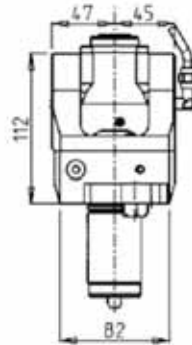
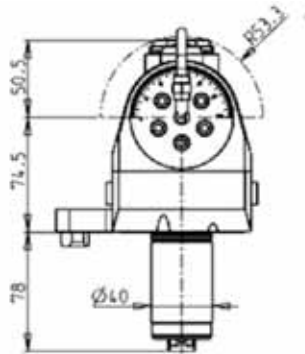

PartNumber	Description	Spindle	I	RPM	Coolant Thru	Ext. Coolant
MZK0250316	Geared Up Adj. Angle ERA16	ERA16	1:2	12000		X
MZK0250416	Geared Up Adj. Angle ERA16 Coolant Thru*	ERA16	1:2	12000	X	X

* Coolant Thru tools are designed for 1000 psi.
They require 5 Micron Filtration and **CANNOT** be run dry.

Note :

Wrenches are provided with the purchase of Specialty Toolholders

QT NEXUS 100M/MS - QT NEXUS 1011 M/MS - SQT 100M/MS/MY/MSY - SQT 10M/M6 -
 SQT200-250M/MS/MY/MSY 16 STATION - QT NEXUS 200-250M/MS/MY/MSY 16 STATION -
 QT NEXUS 20011-25011 M/MS/MY/MSY 16 STATION

DRIVEN

0-180 ADJUSTABLE ANGLE DRIVEN TOOL

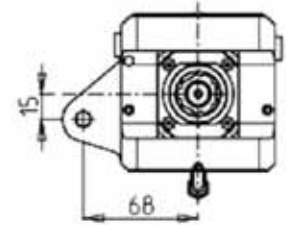
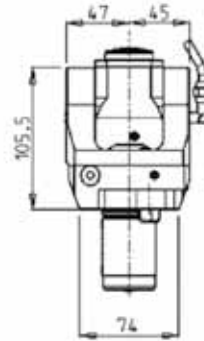
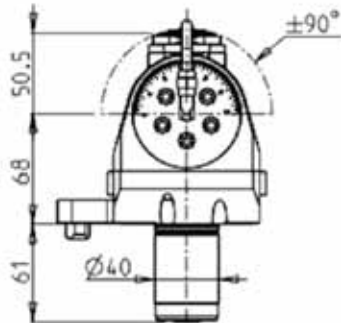

PartNumber	Description	Spindle	I	RPM	Coolant Thru	Ext Coolant
MZK0260120	Adjustable Angle (0-180) ERA20	ERA20	1:1	6000		X
MZK0260220	Adjustable Angle (0-180) ERA20 Coolant Thru*	ERA20	1:1	6000	X	X

Note : Wrenches are provided with the purchase of Specialty Toolholders

0-180 GEARED UP ADJUSTABLE ANGLE DRIVEN TOOL ERA16

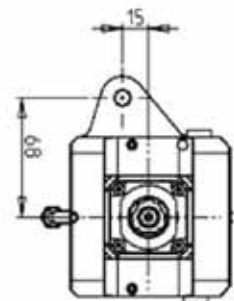
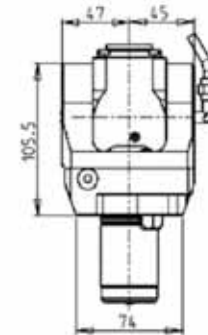
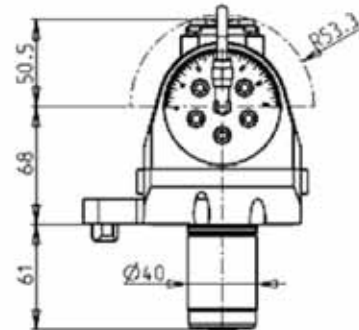

PartNumber	Description	Spindle	I	RPM	Coolant Thru	Ext. Coolant
MZK0260316	Geared Up Adj. Angle ERA16	ERA16	1:2	12000		X
MZK0260416	Geared Up Adj. Angle ERA16 Coolant Thru*	ERA16	1:2	12000	X	X

* Coolant Thru tools are designed for 1000 psi.
 They require 5 Micron Filtration and **CANNOT** be run dry.

Note : Wrenches are provided with the purchase of Specialty Toolholders

MULTIPLEX 620-625-6200-6250 12 STATION / HYPER QUADREX 200MSY 12 STATION MULTIPLEX 8200 (TURRET SUP. 12 STATION)

DRIVEN

RADIAL REDIRECTED DRIVEN TOOL

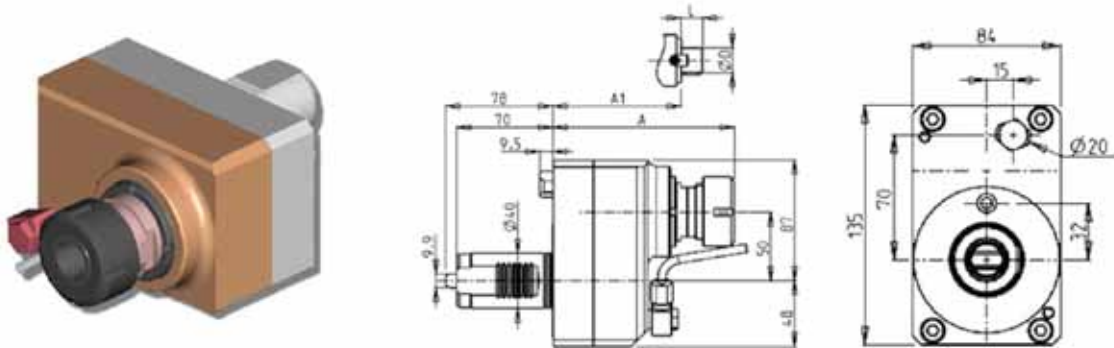

PartNumber	Description	Spindle	I	RPM	Coolant Thru	Ext Coolant	A	A1	D	L
MZK0121125	ER25 Redirected	ER25	1:1	6000		X	120.1			
MZK0121132	ER32 Redirected	ER32	1:1	6000		X	132.1			
MZK0121032	ER32 Redirected Coolant Thru*	ER32	1:1	6000	X	X	132.1			
MZK0121116	Milling Head D=16mm, L=17mm Redirected	16x17	1:1	6000		X		100	16	17
MZK0121122	Milling Head D=22mm, L=19mm Redirected	22x19	1:1	6000		X		102	22	19
MZK0121127	Milling Head D=21mm, L=27mm Redirected	27x21	1:1	6000		X		104	27	21

* Coolant Thru tools are designed for 1000 psi. They require 5 Micron Filtration and **CANNOT** be run dry.

RADIAL GEARED UP REDIRECTED DRIVEN TOOL

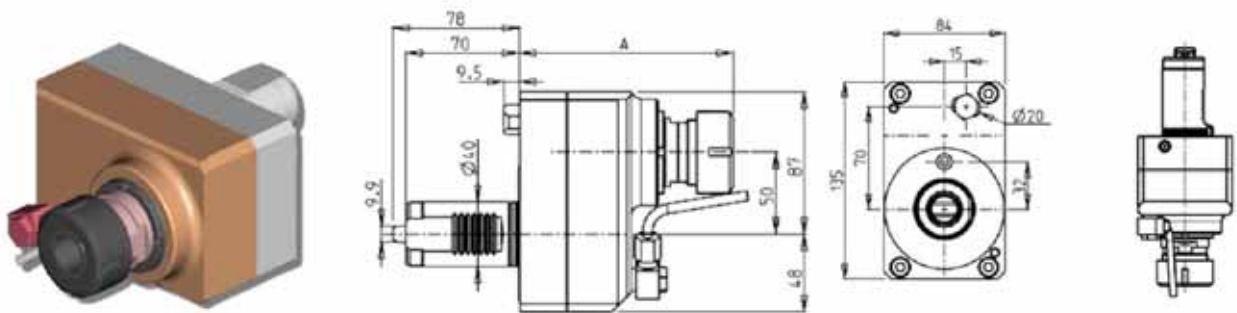

PartNumber	Description	Spindle	I	RPM	Ext Coolant	A
MZK0122125	Geared-Up 1:2 ER25	ER25	1:2	12000	X	120.2
MZK0122132	Geared-Up 1:2 ER32	ER32	1:2	12000	X	132.7

MULTIPLEX 620-625-6200-6250 12 STATION / HYPER QUADREX 200MSY 12 STATION MULTIPLEX 8200 (TURRET SUP. 12 STATION)

DRIVEN

RADIAL GEARED DOWN REDIRECTED DRIVEN TOOL

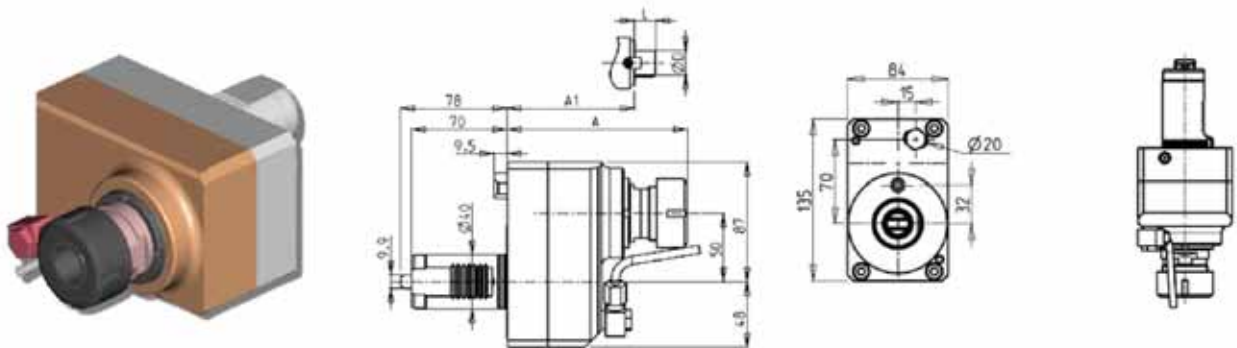

PartNumber	Description	Spindle	I	RPM	Coolant Thru	Ext Coolant	A	A1	D	L
MZK0121232	Geared-Down 2:1 ER32 Redirected	ER32	2:1	3000		X	132.1			
MZK0122432	Geared-Down 2:1 ER32 Redirected Coolant Thru*	ER32	2:1	3000	X	X	132.1			
MZK0121227	Milling Head D=27mm, L=21mm Redirected	27x21	2:1	3000		X		104	27	21

* Coolant Thru tools are designed for 1000 psi. They require 5 Micron Filtration and **CANNOT** be run dry.

MULTIPLEX 620-625-6200-6250 12 STATION / HYPER QUADREX 200MSY 12 STATION MULTIPLEX 8200 (TURRET SUP. 12 STATION)

DRIVEN

RADIAL REINFORCED REDIRECTED IN Z BY 50mm

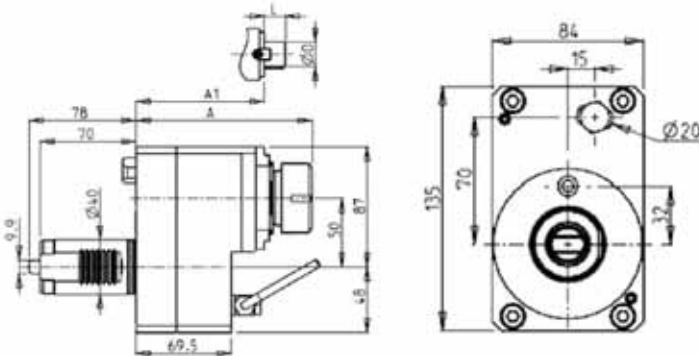

PartNumber	Description	Spindle	I	RPM	Coolant Thru	Ext. Coolant	A	A1	D	L
MZK0231125	Reinforced ER25 Re-Directed in Z by 50mm	ER25	1:1	6000		X	125.6			
MZK0231132	Reinforced ER32 Re-Directed in Z by 50mm	ER32	1:1	6000		X	128.6			
MZK0231025	Reinforced ER25 Re-Directed in Z by 50mm Coolant Thru*	ER25	1:1	6000	X	X	125.6			
MZK0231032	Reinforced ER32 Re-Directed in Z by 50mm Coolant Thru*	ER32	1:1	6000	X	X	128.6			
MZK0231116	Milling Head D=16mm, L=17mm, Reinforced Redirected	16x17	1:1	6000		X		102	16	17
MZK0231122	Milling Head D=22mm, L=19mm, Reinforced Redirected	22x19	1:1	6000		X		104	22	19
MZK0231127	Milling Head D=27mm, L=21mm, Reinforced Redirected	27x21	1:1	6000		X		106	27	21

* Coolant Thru tools are designed for 1000 psi. They require 5 Micron Filtration and **CANNOT** be run dry.

MULTIPLEX 620-625-6200-6250 12 STATION / HYPER QUADREX 200MSY 12 STATION MULTIPLEX 8200 (TURRET SUP. 12 STATION)

DRIVEN

RADIAL REINFORCED GEARED-DOWN REDIRECTED IN Z BY 50mm

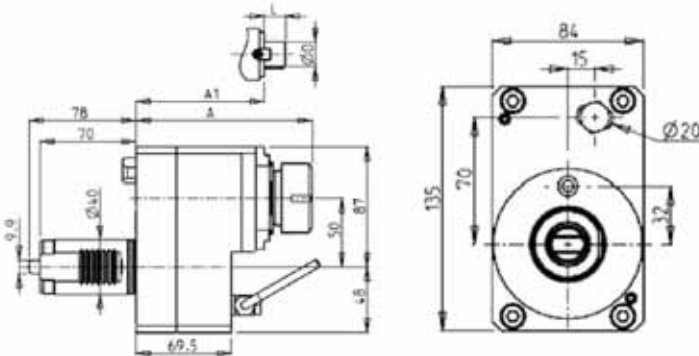

PartNumber	Description	Spindle	I	RPM	Coolant Thru	Ext. Coolant	A	A1	D	L
MZK0231225	Reinforced Geared-Down ER25 Re-Directed in Z by 50mm	ER25	2:1	3000		X	125.6			
MZK0231232	Reinforced Geared-Down ER32 Re-Directed in Z by 50mm	ER32	2:1	3000		X	128.6			
MZK0232425	Reinforced Geared Down ER25 Re-Directed in Z by 50mm Coolant Thru*	ER25	2:1	3000	X	X	125.6			
MZK0232432	Reinforced Geared-Down ER32 Re-Directed in Z by 50mm Coolant Thru*	ER32	2:1	3000	X	X	128.6			
MZK0231216	Milling Head D=16mm, L=17mm, Reinforced Geared-Down Redirected	16x17	2:1	3000		X		102	16	17
MZK0231222	Milling Head D=22mm, L=19mm, Reinforced Geared-Down Redirected	22x19	2:1	3000		X		104	22	19
MZK0231227	Milling Head D=27mm, L=21mm, Reinforced Geared-Down Redirected	27x21	2:1	3000		X		106	27	21

* Coolant Thru tools are designed for 1000 psi. They require 5 Micron Filtration and **CANNOT** be run dry.

MULTIPLEX 620-625-6200-6250 12 STATION / HYPER QUADREX 200MSY 12 STATION MULTIPLEX 8200 (TURRET SUP. 12 STATION)

DRIVEN

RADIAL GEARED UP REDIRECTED DRIVEN TOOL IN Z BY 50mm

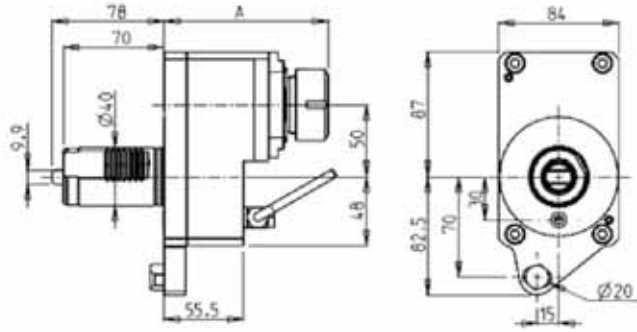

PartNumber	Description	Spindle	RPM	Ext. Coolant	A
MZK0232125	Reinforced Geared-Up Redirected in Z by 50mm ER25	ER25	12000	X	125.6
MZK0232132	Reinforced Geared-Up Redirected in Z by 50mm ER32	ER32	12000	X	128.6

MULTIPLEX 620-625-6200-6250 12 STATION / HYPER QUADREX 200MSY 12 STATION MULTIPLEX 8200 (TURRET SUP. 12 STATION)

DRIVEN

AXIAL DRIVEN TOOL

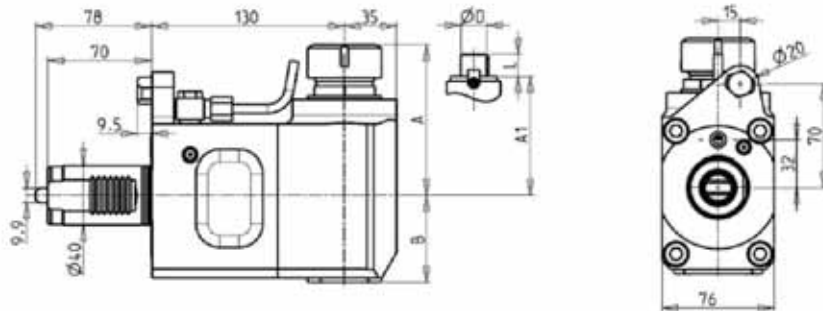

PartNumber	Description	Spindle	I	RPM	Coolant Thru	Ext Coolant	A	A1	B	D	L
MZK0130132	ER32 Standard H=130mm	ER32	1:1	6000		X	101.1		58.5		
MZK0131032	ER32 Coolant Thru* H=130mm	ER32	1:1	6000	X	X	101.1		72		
MZK0132219	Milling Head D=22mm,L=19mm H=130mm	22x19	1:1	6000		X		78.5	58.5	22	19
MZK0132721	Milling Head D=27mm,L=21mm H=130mm	27x21	1:1	6000		X		78.5	58.5	27	21

* Coolant Thru tools are designed for 1000 psi. They require 5 Micron Filtration and **CANNOT** be run dry.

AXIAL MTSK DRIVEN TOOL

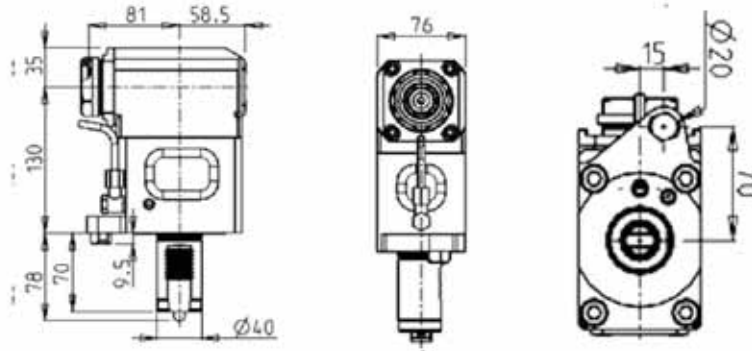

PartNumber	Description	Spindle	I	RPM	Ext. Coolant
MZK0290140	Axial MTSK-40	MTSK40	1:1	6000	X

MULTIPLEX 620-625-6200-6250 12 STATION / HYPER QUADREX 200MSY 12 STATION MULTIPLEX 8200 (TURRET SUP. 12 STATION)

DRIVEN

0-90 ADJUSTABLE ANGLE DRIVEN TOOL

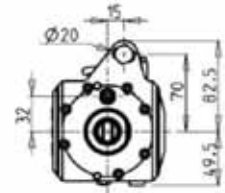
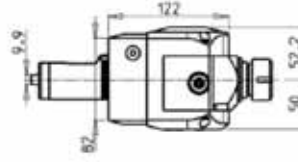
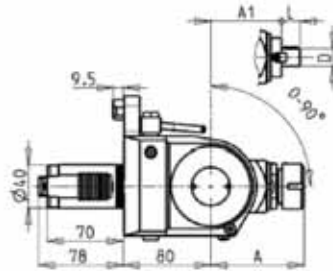

PartNumber	Description	Spindle	I	RPM	Ext Coolant	A	A1	D	L
MZK0150120	Adjustable Angle (0-90) ER20	ER20	1:1	6000	X	84.66			
MZK0150125	Adjustable Angle (0-90) ER25	ER25	1:1	6000	X	85.66			
MZK0151905	Adjustable Angle (0-90) Mill Head D=3/4, L=3/4	3/4x3/4	1:1	6000	X		65	3/4"	3/4"
MZK0151617	Adj. Angle (0-90) Milling Head D=16mm, L=17mm	16x17	1:1	6000	X		65	16	17
MZK0152219	Adj. Angle (0-90) Milling Head D=22mm, L=19mm	22x19	1:1	6000	X		66	22	19

Note : Wrenches are provided with the purchase of Specialty Toolholders

MULTIPLEX 620-625-6200-6250 12 STATION / HYPER QUADREX 200MSY 12 STATION MULTIPLEX 8200 (TURRET SUP. 12 STATION)

DRIVEN

0-180 ADJUSTABLE ANGLE DRIVEN TOOL ER20A

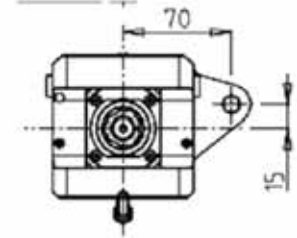
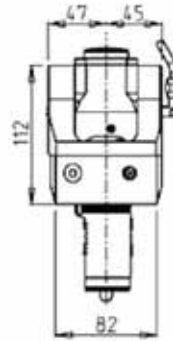
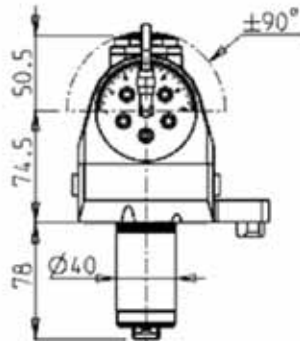
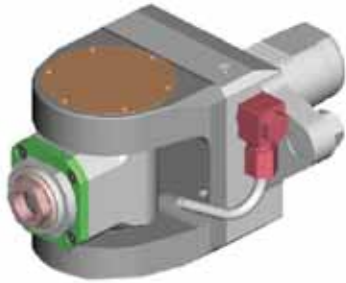

PartNumber	Description	Spindle	I	RPM	Coolant Thru	Ext. Coolant
MZK0270120	Adjustable Angle (0-180) ER20A	ER20A	1:1	6000		X
MZK0270220	Adjustable Angle (0-180) ER20A Coolant Thru*	ER20A	1:1	6000	X	X

Note : Wrenches are provided with the purchase of Specialty Toolholders

0-180 GEARED UP ADJUSTABLE ANGLE DRIVEN TOOL ERA16

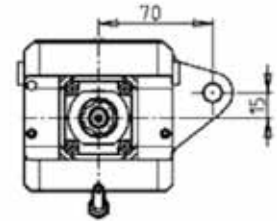
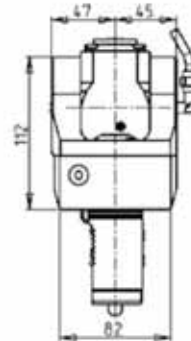
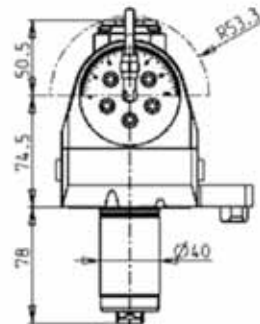

PartNumber	Description	Spindle	I	RPM	Coolant Thru	Ext. Coolant
MZK0270316	Geared Up Adj. Angle ERA16	ERA16	1:2	12000		X
MZK0270416	Geared Up Adj. Angle ERA16 Coolant Thru*	ERA16	1:2	12000	X	X

* Coolant Thru tools are designed for 1000 psi. They require 5 Micron Filtration and **CANNOT** be run dry.

Note : Wrenches are provided with the purchase of Specialty Toolholders

MULTIPLEX 610/6100 12 STATION - MULTIPLEX 620/6200 16 STATION - HYPER QUADREX 100/150MSX/MSY

DRIVEN

RADIAL DRIVEN REDIRECTED IN Z BY 50mm

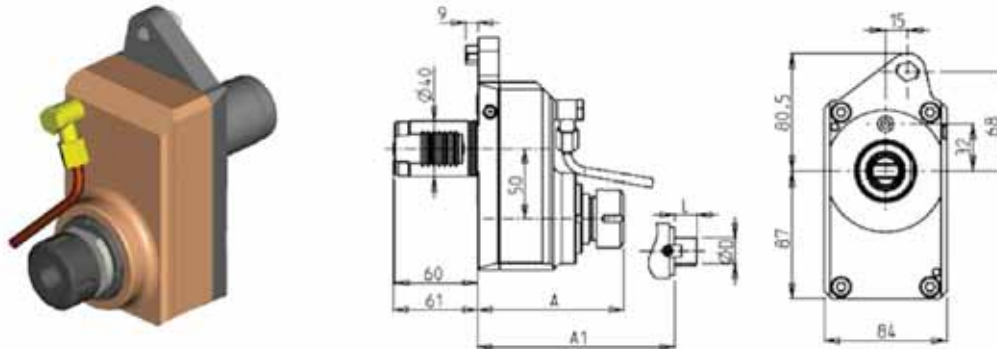

PartNumber	Description	Spindle	RPM	Ext. Coolant	A	A1	D	L
MZK0201125	ER25 Redirected	ER25	6000	X	106.1			
MZK0201132	ER32 Redirected	ER32	6000	X	118.1			
MZK0201116	Milling Head D=16mm, L=17mm	16x17	6000	X		86	16	17
MZK0201122	Milling Head D=22mm, L=19mm	22x19	6000	X		88	22	19
MZK0201127	Milling Head D=27mm, L=21mm	27x21	6000	X		90	27	21

RADIAL GEARED UP REDIRECTED IN Z BY 50mm

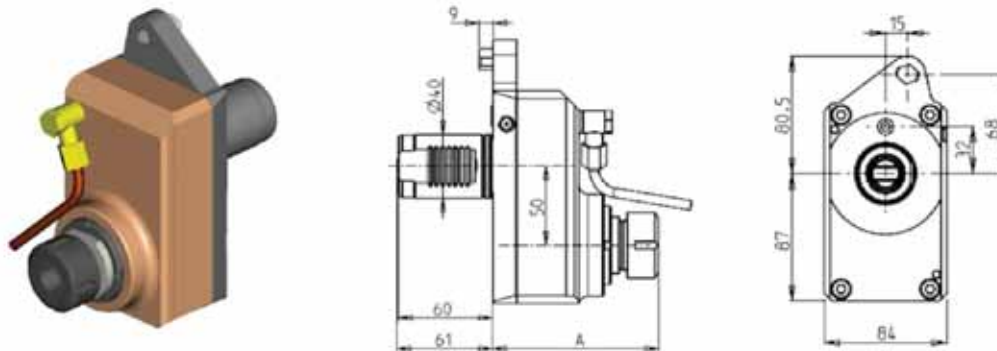

PartNumber	Description	Spindle	I	RPM	Ext. Coolant	A
MZK0202125	Geared-Up Redirected ER25	ER25	1:2	12000	X	106.2
MZK0202132	Geared-Up Redirected ER32	ER32	1:2	12000	X	118.7

MULTIPLEX 610/6100 12 STATION - MULTIPLEX 620/6200 16 STATION - HYPER QUADREX 100/150MSX/MSY

DRIVEN

DRIVEN GEAR HOBBER

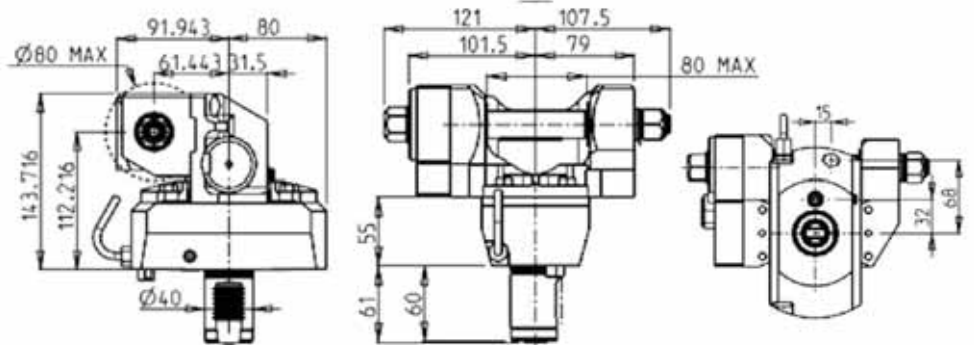
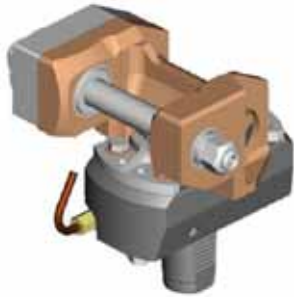

PartNumber	Description	I	RPM	Ext. Coolant	D (mm)	D (inch)
MZK0191100	Gear Hobber	1:1	6000	X	16-22-27-32	3/4"-1"-1 1/4"
MZK0192100	Gear Hobber I=2:1	2:1	6000	X	16-22-27-32	3/4"-1"-1 1/4"

QT NEXUX 300/350/400/450M/MY QT NEXUS 30011/35011/40011/45011 M/MY SQT 28/30 MEGATURN NEXUS 900M

DRIVEN

DRIVEN GEAR HOBBER

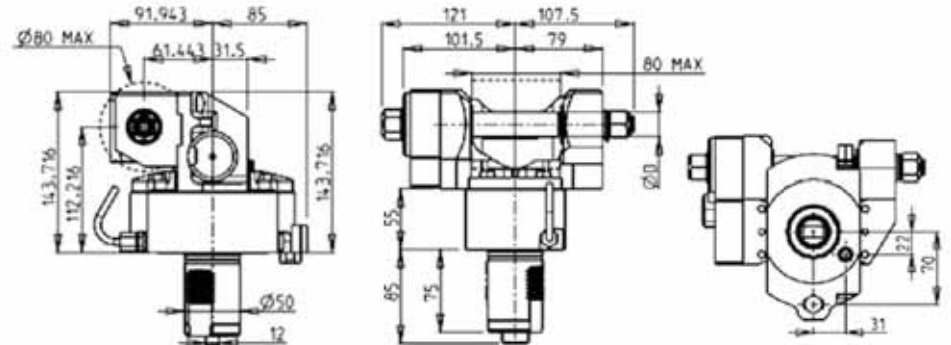

PartNumber	Description	I	RPM	Ext. Coolant	D (mm)	D (inch)
MZK0171100	Gear Hobber	1:1	6000	X	16-22-27-32	3/4"-1"-1 1/4"
MZK0172100	Gear Hobber I=2:1	2:1	6000	X	16-22-27-32	3/4"-1"-1 1/4"

QUICK TURN SMART 100M-200M-250M

DRIVEN

RADIAL DRIVEN TOOL

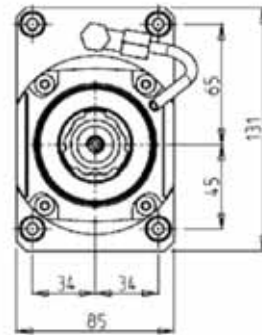
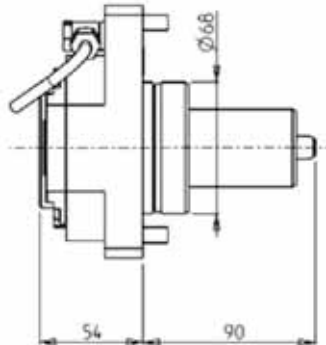

PartNumber	Description	Spindle	I	RPM	Ext. Coolant
MZK0320332	ERA32 Standard	ERA32	1:1	6000	X

AXIAL DRIVEN TOOL

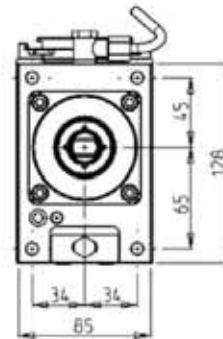
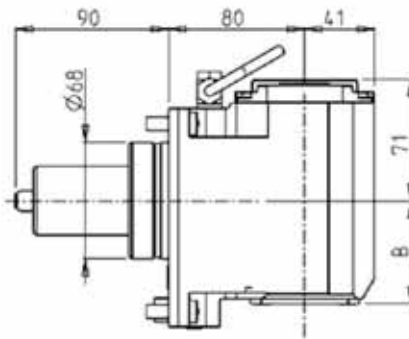

PartNumber	Description	Spindle	I	RPM	Coolant Thru	Ext. Coolant	B
MZK0310332	Axial ERA32 Standard	ERA32	1:1	6000		X	60.4
MZK0310432	Axial ERA32 Standard Coolant Thru*	ERA32	1:1	6000	X	X	74

* Coolant Thru tools are designed for 1000 psi. They require 5 Micron Filtration and **CANNOT** be run dry.