

.....DRIVEN TOOLING T) @
For
OKUMA

LB200-LT200-GENOS L200M-LT10M

DRIVEN

AXIAL DRIVEN TOOL VDI30

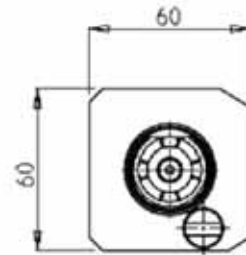
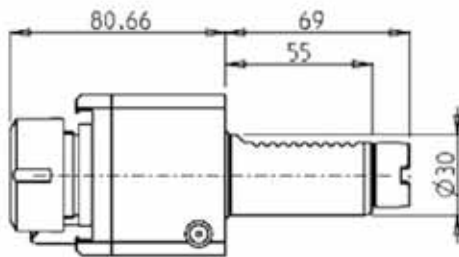

| PartNumber | Description | Spindle | I | RPM | Cool Thru | Ext Cool |
|------------|-----------------------------|---------|-----|------|-----------|----------|
| OKU1130125 | Axial ER25 VDI30 | ER25 | 1:1 | 6000 | | X |
| OKU1131125 | Axial ER25 VDI30 Cool Thru* | ER25 | 1:1 | 6000 | X | X |

RADIAL REAR-SET TOOL VDI30

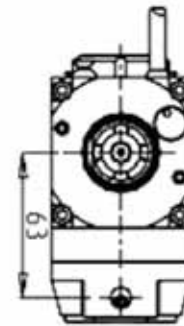
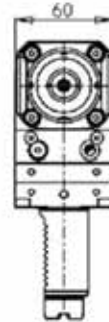
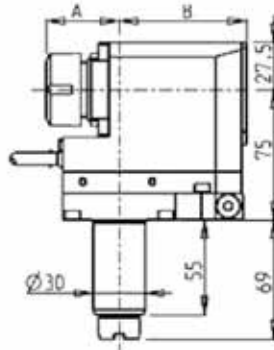

| PartNumber | Description | Spindle | I | RPM | Cool Thru | Ext Cool | A | B |
|------------|--|---------|-----|------|-----------|----------|-------|------|
| OKU1120120 | Radial ER20 Rear-Set VDI30 | ER25 | 1:1 | 6000 | | X | 41.16 | 73.5 |
| OKU1120320 | Radial ERA20 Rear-Set VDI30 | ERA20 | 1:1 | 6000 | | X | 24.5 | 73.5 |
| OKU1120420 | Radial ERA20 Rear-Set VDI30 Cool Thru* | ERA20 | 1:1 | 6000 | X | X | 24.5 | 83.5 |
| OKU1120125 | Radial ER25 Rear-Set VDI30 | ER25 | 1:1 | 6000 | | X | 42.16 | 73.5 |
| OKU1120225 | Radial ER25 Rear-Set VDI30 Cool Thru* | ER25 | 1:1 | 6000 | X | X | 42.16 | 83.5 |
| OKU1120325 | Radial ERA25 Rear-Set VDI30 | ERA25 | 1:1 | 6000 | | X | 28.5 | 73.5 |
| OKU1120425 | Radial ERA25 Rear-Set VDI30 Cool Thru* | ERA25 | 1:1 | 6000 | X | X | 28.5 | 83.5 |

* Coolant Thru tools are designed for 1000 psi.
They require 5 Micron Filtration and **CANNOT** be run dry.

LB200-LT200-GENOS L200M-LT10M

DRIVEN

GEAR HOBBER VDI30

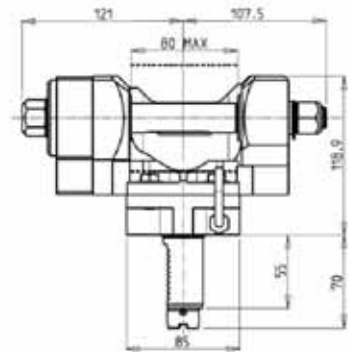
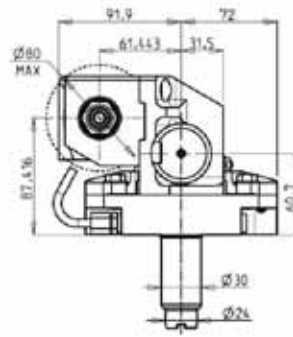

| PartNumber | Description | Reversible | I | RPM | Ext Cool | B | D mm | D Inch |
|------------|-------------------|------------|-----|------|----------|-----|-------------|----------------|
| OKU0031100 | Gear Hobber VDI30 | X | 1:1 | 4000 | X | 93 | 16-22-27-31 | 3/4"-1"-1 1/4" |
| OKU0032100 | Gear Hobber VDI30 | X | 2:1 | 2000 | X | 101 | 16-22-27-31 | 3/4"-1"-1 1/4" |

Note : Wrenches are provided with the purchase of Specialty Toolholders

LB15/300, LT15/300, LR15, LU15M, LU300M

DRIVEN

RADIAL DRIVEN TOOL 75mm INTERAXIS VDI40

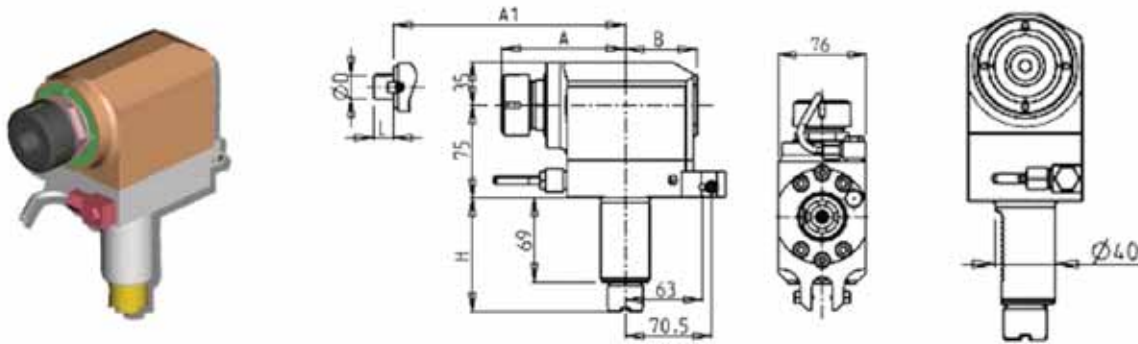

| PartNumber | Description | Spindle | I | RPM | Cool Thru | Ext Cool | A | A1 | B | H |
|------------|---------------------------------------|---------|-----|------|-----------|----------|-------|------|------|----|
| OKU0040132 | Radial ER32 75mm H-93 | ER32 | 1:1 | 4000 | | X | 101.1 | | 58.5 | 93 |
| OKU0040232 | Radial ER32 75mm H-93 Cool Thru* | ER32 | 1:1 | 4000 | X | X | 101.1 | | 82 | 93 |
| OKU0042219 | Radial Mill Head H-93, D=22mm, L=19mm | 22x19 | 1:1 | 4000 | | X | | 78.5 | 58.5 | 93 |
| OKU0042721 | Radial Mill Head H-93, D=27mm, L=21mm | 27x21 | 1:1 | 4000 | | X | | 78.5 | 58.5 | 93 |

* Coolant Thru tools are designed for 1000 psi.
They require 5 Micron Filtration and **CANNOT** be run dry.

RADIAL MTSK DRIVEN TOOL 75mm INTERAXIS VDI40

See Accessories for MTSK Clamping Units

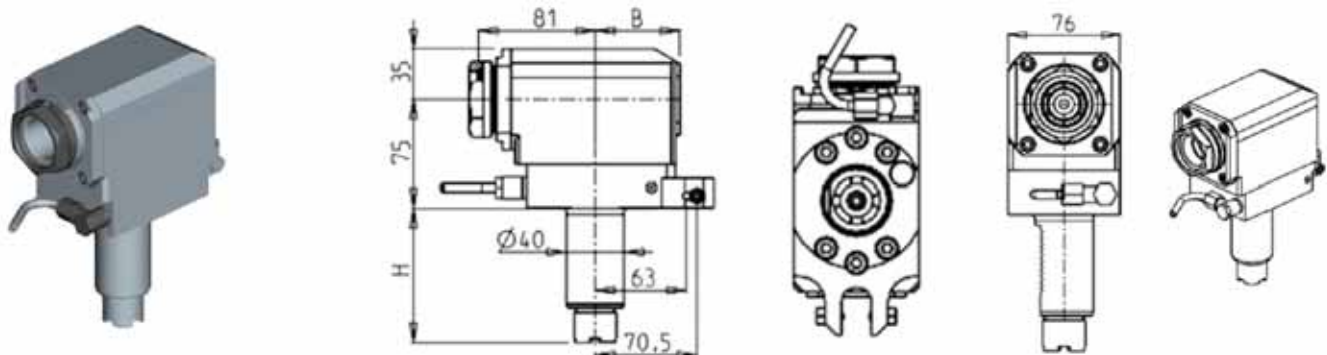

| PartNumber | Description | Spindle | I | RPM | Cool Thru | Ext Cool | B | H |
|------------|--|---------|-----|------|-----------|----------|------|----|
| OKU0840140 | Radial MTSK-40 Driven Tool H=75 | MTSK-40 | 1:1 | 4000 | | X | 58.5 | 93 |
| OKU0840240 | Radial MTSK-40 Driven Tool H=75 Cool Thru* | MTSK-40 | 1:1 | 4000 | X | X | 69.5 | 93 |

LB15/300, LT15/300, LR15, LU15M, LU300M

DRIVEN

RADIAL DRIVEN TOOL 90mm INTERAXIS VDI40

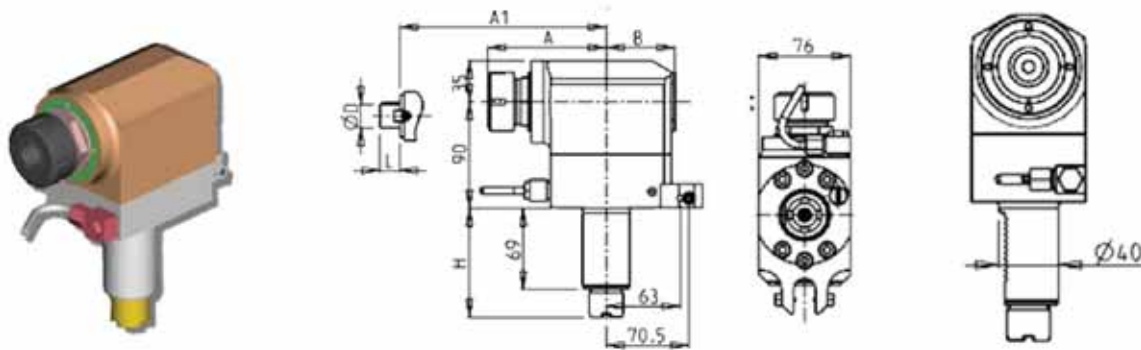

| PartNumber | Description | Spindle | I | RPM | Cool Thru | Ext Cool | A | A1 | B | H |
|------------|--------------------------------------|---------|-----|------|-----------|----------|-------|------|------|----|
| OKU0050132 | Radial ER32 90mm H=93 | ER32 | 1:1 | 4000 | | X | 101.1 | | 58.5 | 93 |
| OKU0050232 | Radial ER32 90mm H=93 Cool Thru* | ER32 | 1:1 | 4000 | X | X | 101.1 | | 82 | 93 |
| OKU0052219 | Radial Mill Head D=22mm, L=19mm H=93 | 22x19 | 1:1 | 4000 | | X | | 78.5 | 58.5 | 93 |
| OKU0052721 | Radial Mill Head D=27mm, L=21mm H=93 | 27x21 | 1:1 | 4000 | | X | | 78.5 | 58.5 | 93 |

* Coolant Thru tools are designed for 1000 psi.
They require 5 Micron Filtration and **CANNOT** be run dry.

RADIAL MTSK DRIVEN TOOL 90mm INTERAXIS VDI40

See Accessories for MTSK Clamping Units

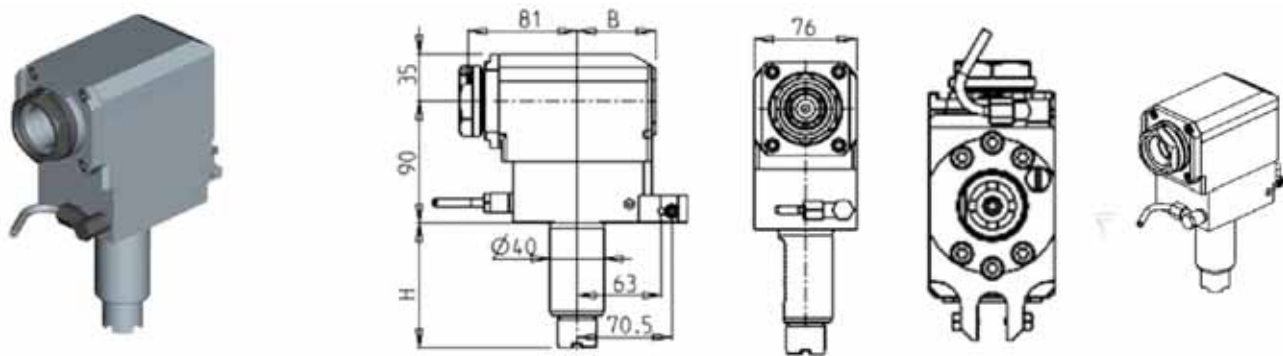

| PartNumber | Description | Size | I | RPM | Cool Thru | Ext Cool | B | H |
|------------|---------------------------------------|---------|-----|------|-----------|----------|------|----|
| OKU0850140 | Radial Driven MTSK-40 H=93 | MTSK-40 | 1:1 | 4000 | | X | 58.5 | 93 |
| OKU0850240 | Radial Driven MTSK-40 H=93 Cool Thru* | MTSK-40 | 1:1 | 4000 | X | X | 69.5 | 93 |

LB15/300, LT15/300, LR15, LU15M, LU300M

DRIVEN

RADIAL REAR SET DRIVEN TOOL 85mm INTERAXIS VDI40

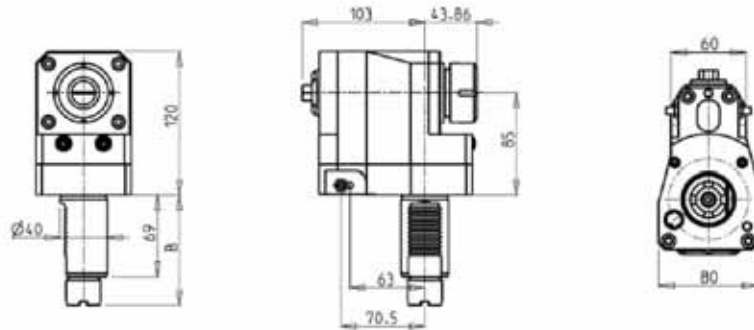
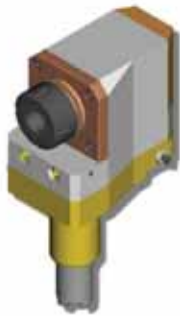

| PartNumber | Description | Spindle | I | RPM | Ext Cool | B |
|------------------|---------------------------------|---------|-----|------|----------|----|
| 1210KU_R32_40B00 | Radial Rear-Set ER32 VDI40 B=93 | ER32 | 1:1 | 4000 | X | 93 |

RADIAL DRIVEN TOOL 150mm INTERAXIS VDI40

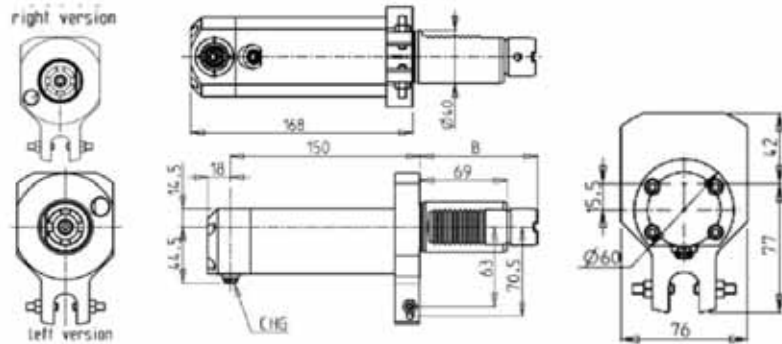
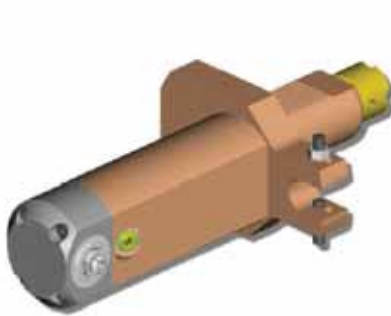

| PartNumber | Description | Spindle | I | RPM | Ext Cool | B |
|------------------|--|---------|-----|------|----------|----|
| 1270KU_R10_40B00 | Radial 150mm Interaxis Internal Holes LH | CHG | 1:1 | 4000 | X | 93 |
| 1270KU_R10_40B10 | Radial 150mm Interaxis Internal Holes RH | CHG | 1:1 | 4000 | X | 93 |

LB15/300, LT15/300, LR15, LU15M, LU300M

DRIVEN

0-90 ADJUSTABLE ANGLE DRIVEN TOOL VDI40

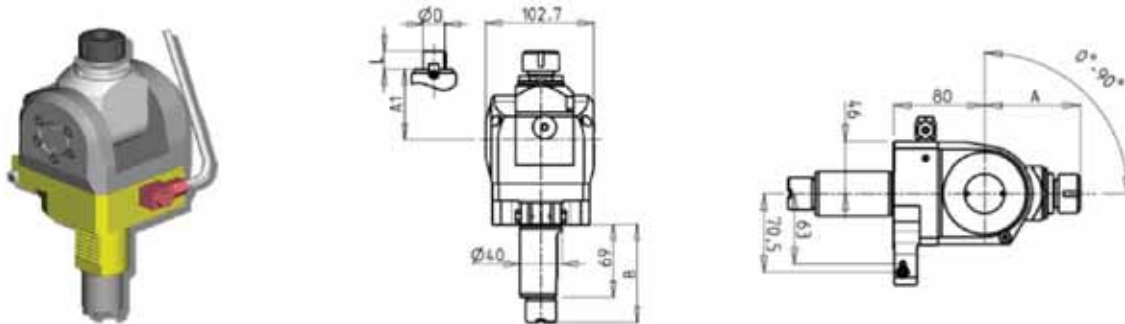

| PartNumber | Description | Spindle | I | RPM | Ext Cool | A | A1 | B | D | L |
|-------------|---|-----------|-----|------|----------|-------|----|----|----|-----------|
| 0210020_OKU | Adj. Angle (0-90) ER20 VDI40 | ER20 | 1:1 | 4000 | X | 84.16 | | 93 | | |
| 0210025_OKU | Adj. Angle (0-90) ER25 VDI40 | ER25 | 1:1 | 4000 | X | 85.66 | | 93 | | |
| 0211617_OKU | Adj. Angle (0-90) Mill Head 16x17 VDI40 | 16x17 | 1:1 | 4000 | X | | | 65 | 93 | 16 17 |
| 0212219_OKU | Adj. Angle (0-90) Mill Head 22x19 VDI40 | 22x19 | 1:1 | 4000 | X | | | 66 | 93 | 22 19 |
| 0211905_OKU | Adj. Angle (0-90) Mill Head 3/4"x3/4" VDI40 | 3/4"x3/4" | 1:1 | 4000 | X | | | 65 | 93 | 3/4" 3/4" |

Note : Wrenches are provided with the purchase of Specialty Toolholders

GEAR HOBBER VDI40

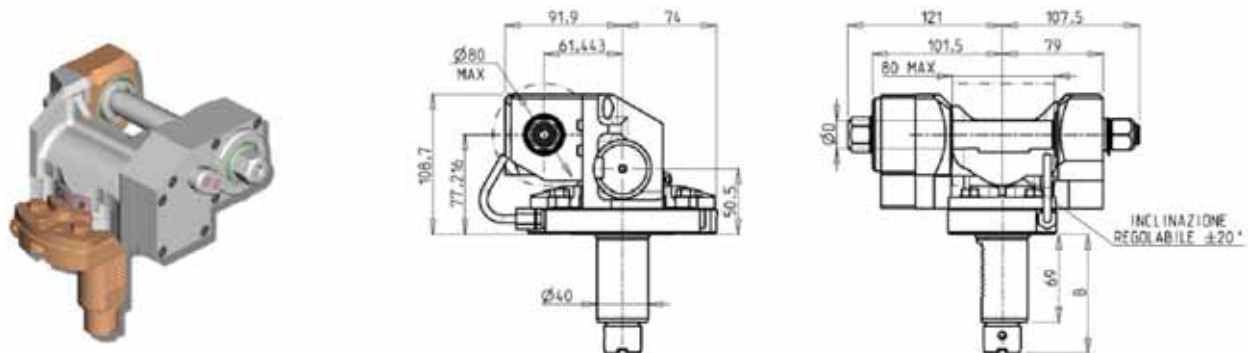

| PartNumber | Description | Reversible | I | RPM | Ext Cool | B | D mm | D Inch |
|------------------|--------------------------------|------------|-----|------|----------|----|-------------|----------------|
| 126OKU_PCR_40B00 | Gear Hob Tool 1:1 VDI40 | X | 1:1 | 4000 | X | 93 | 16-22-27-32 | 3/4"-1"-1 1/4" |
| 126OKU_PCR_40B10 | Gear Hob Geared Down 2:1 VDI40 | X | 2:1 | 2000 | X | 93 | 16-22-27-32 | 3/4"-1"-1 1/4" |

Note : Wrenches are provided with the purchase of Specialty Toolholders

LB25/400, LR25, LU25M, LU400M

DRIVEN

RADIAL DRIVEN TOOL 75mm INTERAXIS VDI40

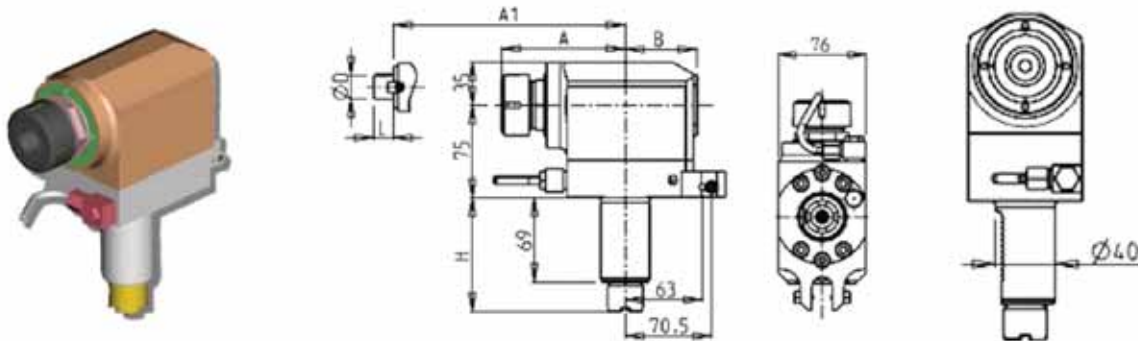

| PartNumber | Description | Spindle | I | RPM | Cool Thru | Ext Cool | A | A1 | B | H |
|------------|--|---------|-----|------|-----------|----------|-------|------|------|-----|
| OKU0040332 | Radial ER32 75mm H-101 | ER32 | 1:1 | 4000 | | X | 101.1 | | 58.5 | 101 |
| OKU0040432 | Radial ER32 75mm H-101 Cool Thru* | ER32 | 1:1 | 4000 | X | X | 101.1 | | 82 | 101 |
| OKU0041022 | Radial Mill Head H-101, D=22mm, L=19mm | 22x19 | 1:1 | 4000 | | X | | 78.5 | 58.5 | 101 |
| OKU0041027 | Radial Mill Head H-101, D=27mm, L=21mm | 27x21 | 1:1 | 4000 | | X | | 78.5 | 58.5 | 101 |

* Coolant Thru tools are designed for 1000 psi.
They require 5 Micron Filtration and **CANNOT** be run dry.

RADIAL MTSK DRIVEN TOOL 75mm INTERAXIS VDI40

See Accessories for MTSK Clamping Units

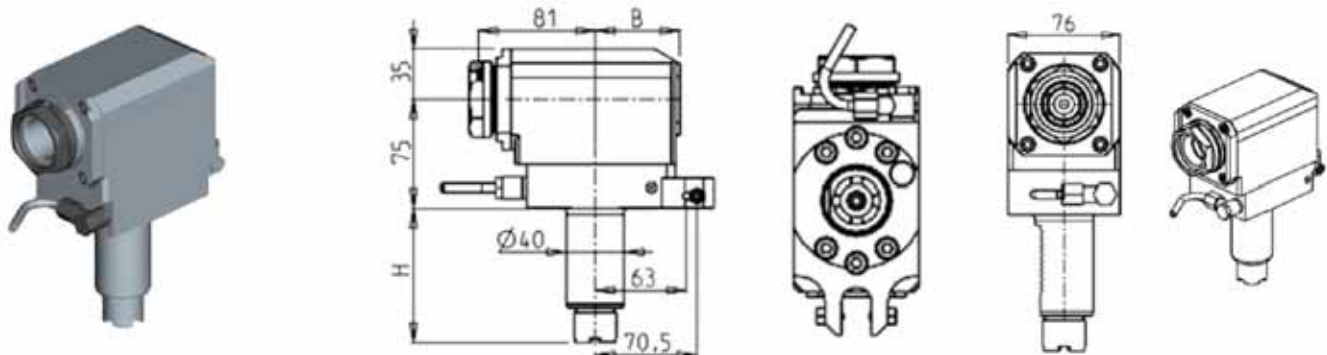

| PartNumber | Description | Spindle | I | RPM | Cool Thru | Ext Cool | B | H |
|------------|--|---------|-----|------|-----------|----------|------|-----|
| OKU0841140 | Radial MTSK-40 Driven Tool H=75 | MTSK-40 | 1:1 | 4000 | | X | 58.5 | 101 |
| OKU0841240 | Radial MTSK-40 Driven Tool H=75 Cool Thru* | MTSK-40 | 1:1 | 4000 | X | X | 69.5 | 101 |

LB25/400, LR25, LU25M, LU400M

DRIVEN

RADIAL DRIVEN TOOL 90mm INTERAXIS VDI40

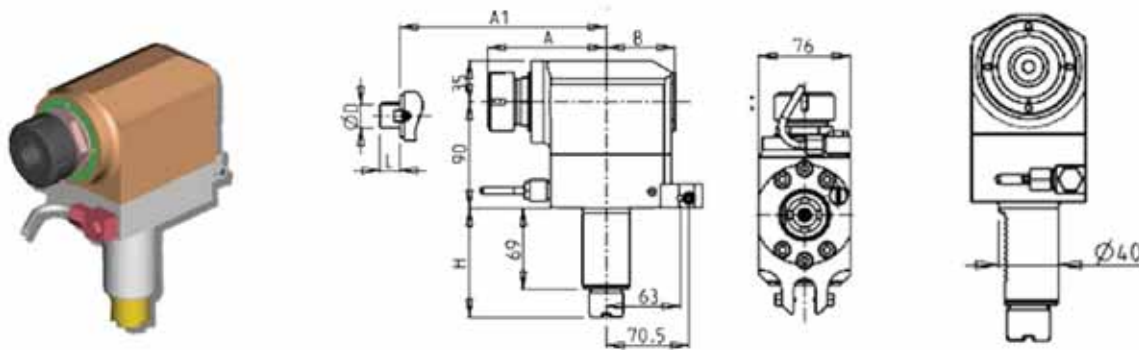

| PartNumber | Description | Spindle | I | RPM | Ext Cool | A | A1 | B | H |
|------------|---------------------------------------|---------|-----|------|----------|-------|------|------|-----|
| OKU0050332 | Radial ER32 90mm H=101 | ER32 | 1:1 | 4000 | X | 101.1 | | 58.5 | 101 |
| OKU0050432 | Radial ER32 90mm H=101 Cool Thru* | ER32 | 1:1 | 4000 | X | 101.1 | | 58.5 | 101 |
| OKU0051022 | Radial Mill Head D=22mm, L=19mm H=101 | 22x19 | 1:1 | 4000 | X | | 78.5 | 58.5 | 101 |
| OKU0051027 | Radial Mill Head D=27mm, L=21mm H=101 | 27x21 | 1:1 | 4000 | X | | 78.5 | 58.5 | 101 |

* Coolant Thru tools are designed for 1000 psi.
They require 5 Micron Filtration and **CANNOT** be run dry.

RADIAL MTSK DRIVEN TOOL 90mm INTERAXIS VDI40

See Accessories for MTSK Clamping Units

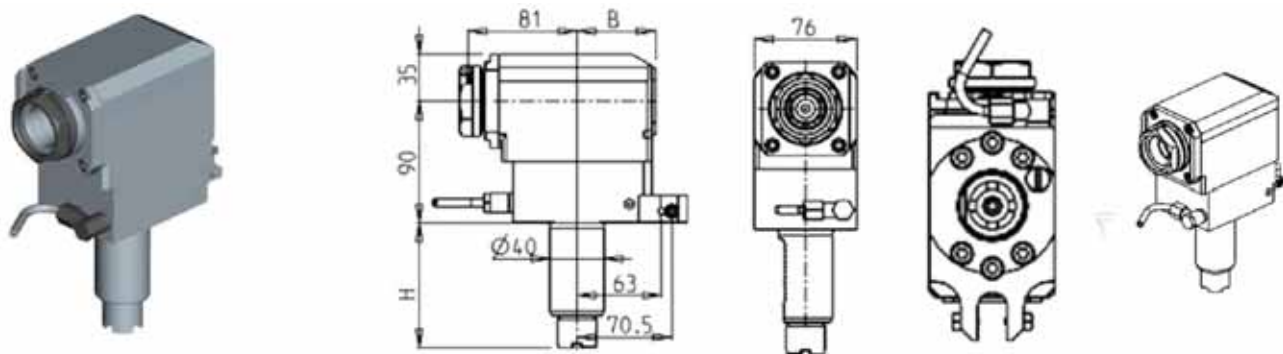

| PartNumber | Description | Size | I | RPM | Cool Thru | Ext Cool | B | H |
|------------|--|---------|-----|------|-----------|----------|------|-----|
| OKU0851140 | Radial Driven MTSK-40 H=101 | MTSK-40 | 1:1 | 4000 | | X | 58.5 | 101 |
| OKU0851240 | Radial Driven MTSK-40 H=101 Cool Thru* | MTSK-40 | 1:1 | 4000 | X | X | 69.5 | 101 |

LB25/400, LR25, LU25M, LU400M

DRIVEN

AXIAL REDIRECTED DRIVEN TOOL VDI40

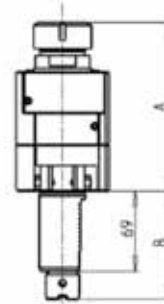
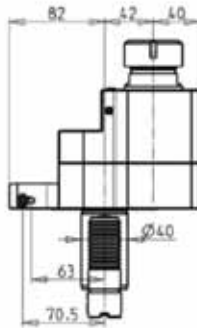

| PartNumber | Description | Spindle | I | RPM | Cool Thru | Ext Cool | A | B |
|------------------|--|---------|-----|------|-----------|----------|--------|-----|
| 125OKU_A32_40B01 | Axial Redirected ER32 VDI40 B=101 | ER32 | 1:1 | 4000 | | X | 144.46 | 101 |
| 125OKU_A32_40B31 | Axial Redirected ER32 VDI40 B=101 Cool Thru* | ER32 | 1:1 | 4000 | X | | 164.96 | 101 |

* Coolant Thru tools are designed for 1000 psi.
They require 5 Micron Filtration and **CANNOT** be run dry.

AXIAL GEARED DOWN REDIRECTED DRIVEN TOOL VDI40

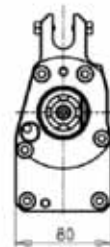
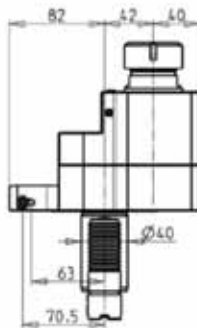

| PartNumber | Description | Spindle | I | RPM | Cool Thru | Ext Cool | A | B |
|------------------|---|---------|-----|------|-----------|----------|--------|-----|
| 125OKU_A32_40B11 | Axial Geared Down 2:1 Redirected ER32 VDI 40 | ER32 | 2:1 | 2000 | | X | 144.46 | 101 |
| 125OKU_A32_40B21 | Axial Geared Down 2:1 Redirected ER32 VDI 40 Cool Thru* | ER32 | 2:1 | 2000 | X | | 164.96 | 101 |

* Coolant Thru tools are designed for 1000 psi.
They require 5 Micron Filtration and **CANNOT** be run dry.

LB25/400, LR25, LU25M, LU400M

DRIVEN

AXIAL GEARED UP 1:2 DRIVEN TOOL RE-DIRECTED BY 42mm VDI40

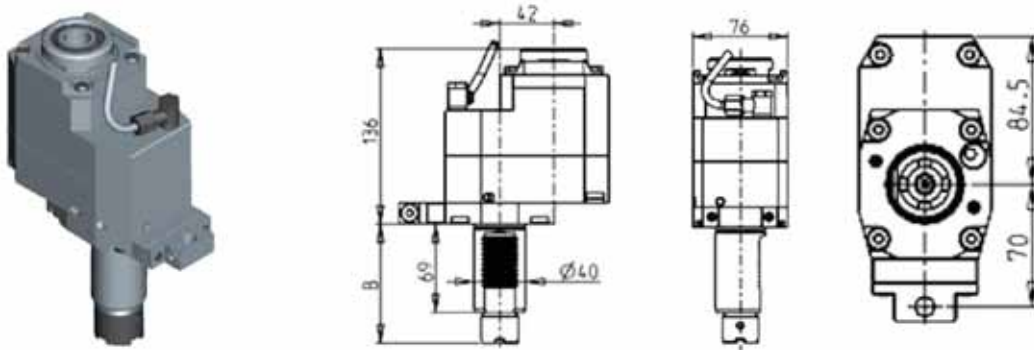

| PartNumber | Description | Spindle | I | RPM | Cool Thru | Ext Cool | B |
|------------|---|---------|-----|------|-----------|----------|-----|
| OKU1207132 | Axial Geared Up 1:2 Redirected ERA32 B=101 | ERA32 | 1:2 | 8000 | | X | 101 |
| OKU1207232 | Axial Geared Up 1:2 Redirected ERA32 B=101 Cool Thru* | ERA32 | 1:2 | 8000 | X | X | 101 |

* Coolant Thru tools are designed for 1000 psi.
They require 5 Micron Filtration and **CANNOT** be run dry.

0-90 ADJUSTABLE ANGLE DRIVEN TOOL VDI40

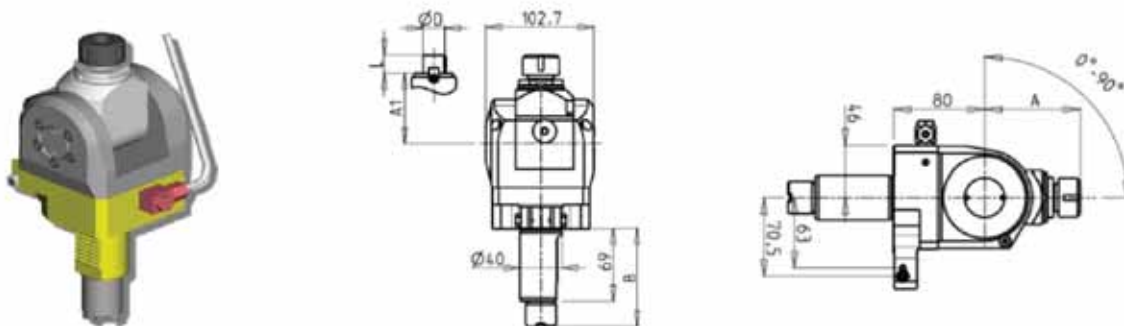

| PartNumber | Description | Spindle | I | RPM | Ext Cool | A | A1 | B | D | L |
|-------------|---|-----------|-----|------|----------|-------|----|-----|------|------|
| 0190020_OKU | Adj. Angle (0-90) ER20 VDI40 | ER20 | 1:1 | 4000 | X | 84.16 | | 101 | | |
| 0190025_OKU | Adj. Angle (0-90) ER25 VDI40 | ER25 | 1:1 | 4000 | X | 85.66 | | 101 | | |
| 0191905_OKU | Adj. Angle (0-90) Mill Head 3/4"x3/4" VDI40 | 3/4"x3/4" | 1:1 | 4000 | X | | 65 | 101 | 3/4" | 3/4" |
| 0191617_OKU | Adj. Angle (0-90) Mill Head 16x17 VDI40 | 16x17 | 1:1 | 4000 | X | | 65 | 101 | 16 | 17 |
| 0192219_OKU | Adj. Angle (0-90) Mill Head 22x19 VDI40 | 22x19 | 1:1 | 4000 | X | | 66 | 101 | 22 | 19 |

Note : Wrenches are provided with the purchase of Specialty Toolholders

LB25/400, LR25, LU25M, LU400M

DRIVEN

GEAR HOBBER VDI40

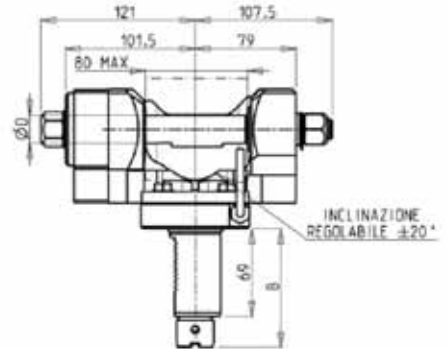
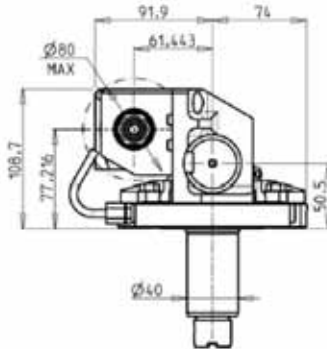

| PartNumber | Description | Reversible | I | RPM | Ext Cool | B | D mm | D Inch |
|------------------|--------------------------------|------------|-----|------|----------|-----|-------------|----------------|
| 1260KU_PCR_40B01 | Gear Hob Tool 1:1 VDI40 | X | 1:1 | 4000 | X | 101 | 16-22-27-32 | 3/4"-1"-1 1/4" |
| 1260KU_PCR_40B11 | Gear Hob Geared Down 2:1 VDI40 | X | 2:1 | 2000 | X | 101 | 16-22-27-32 | 3/4"-1"-1 1/4" |

Note :

Wrenches are provided with the purchase of Specialty Toolholders

LB15/300, LT15/300, LR15, LU15M, LU300M, GENOS L300M, MAC TURN 250/350/550

DRIVEN

AXIAL DRIVEN TOOL VDI40 B=93

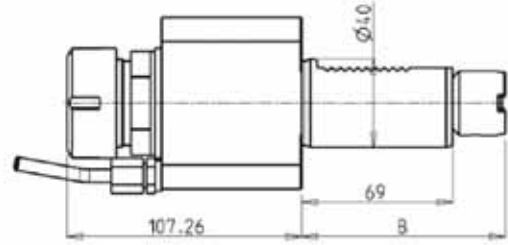

| PartNumber | Description | Spindle | I | RPM | Cool Thru | Ext Cool | B |
|------------------|----------------------------------|-----------|-----|------|-----------|----------|----|
| 122OKU_A32_40B00 | Axial ER32 VDI40 B=93 | ER32 | 1:1 | 4000 | | X | 93 |
| OKU1210232 | Axial ER32 VDI40 B=93 Cool Thru* | ER32 | 1:1 | 4000 | X | X | 93 |
| 122OKU_A32_40B10 | Axial Weldon 8 B=93 | Weldon 8 | 1:1 | 4000 | | X | 93 |
| 122OKU_A32_40B12 | Axial Weldon 12 B=93 | Weldon 12 | 1:1 | 4000 | | X | 93 |
| 122OKU_A32_40B14 | Axial Weldon 16 B=93 | Weldon 16 | 1:1 | 4000 | | X | 93 |

* Coolant Thru tools are designed for 1000 psi.
They require 5 Micron Filtration and **CANNOT** be run dry.

AXIAL DRIVEN TOOL 90mm INTERAXIS VDI40

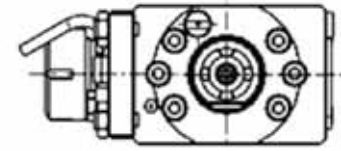
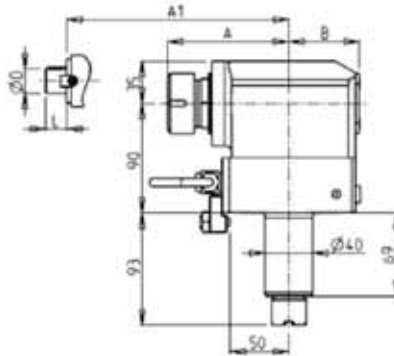

| PartNumber | Description | Spindle | I | RPM | Cool Thru | Ext Cool | A | A1 | B |
|------------|--|---------|-----|------|-----------|----------|-------|------|------|
| OKU0020132 | Axial ER32 90mm VDI40 | ER32 | 1:1 | 4000 | | X | 101.1 | | 58.5 |
| OKU0020232 | Axial ER32 90mm VDI40 Cool Thru* | ER32 | 1:1 | 4000 | X | X | 101.1 | | 82 |
| OKU0022219 | Axial Mill Head D=22mm,L=19mm 90mm Interaxis | 22x19 | 1:1 | 4000 | | X | | 78.5 | 58.5 |
| OKU0022721 | Axial Mill Head D=27mm,L=21mm 90mm Interaxis | 27x21 | 1:1 | 4000 | | X | | 78.5 | 58.5 |

* Coolant Thru tools are designed for 1000 psi.
They require 5 Micron Filtration and **CANNOT** be run dry.

LB15/300, LT15/300, LR15, LU15M, LU300M, GENOS L300M, MAC TURN 250/350/550

DRIVEN

AXIAL MTSK DRIVEN TOOL 90mm INTERAXIS VDI40

See Accessories for MTSK Clamping Units

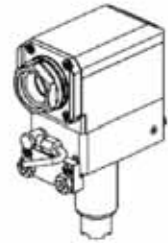
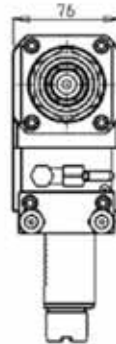
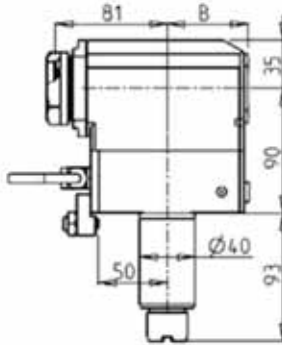

| PartNumber | Description | Size | I | RPM | Cool Thru | Ext Cool | B |
|------------|--------------------------------|---------|-----|------|-----------|----------|------|
| OKU0650140 | Axial MTSK-40 VDI40 | MTSK-40 | 1:1 | 4000 | | X | 58.5 |
| OKU0650240 | Axial MTSK-40 VDI40 Cool Thru* | MTSK-40 | 1:1 | 4000 | X | X | 69.5 |

AXIAL DRIVEN TOOL SUBSPINDLE SIDE 90mm INTERAXIS VDI40

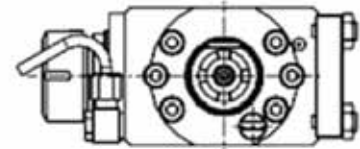
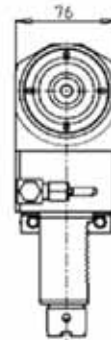
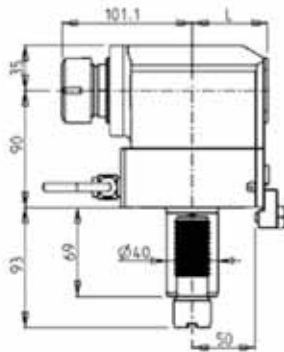

| PartNumber | Description | Spindle | I | RPM | Cool Thru | Ext Cool | L |
|------------|--|---------|-----|------|-----------|----------|------|
| OKU0120132 | Axial ER32 Sub-Spindle VDI40 90mm | ER32 | 1:1 | 4000 | | X | 58.5 |
| OKU0120232 | Axial ER32 Sub-Spindle VDI40 90mm Cool Thru* | ER32 | 1:1 | 4000 | X | X | 82 |

* Coolant Thru tools are designed for 1000 psi.
They require 5 Micron Filtration and **CANNOT** be run dry.

LB15/300, LT15/300, LR15, LU15M, LU300M, GENOS L300M, MAC TURN 250/350/550

DRIVEN

AXIAL MTSK DRIVEN FOR SUB SPINDLE 90mm INTERAXIS VDI40

See Accessories for MTSK Clamping Units

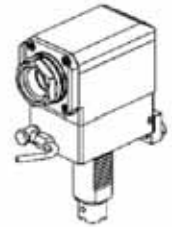
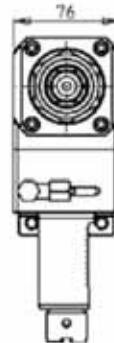
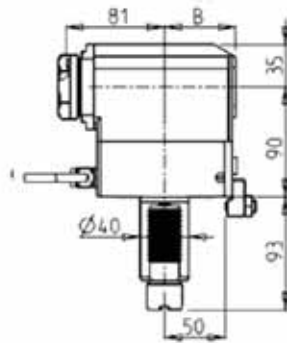

| PartNumber | Description | Spindle | I | RPM | Cool Thru | Ext Cool | B |
|------------|--|---------|-----|------|-----------|----------|------|
| OKU0660140 | Axial MTSK-40 for Sub-Spindle VDI40 | MTSK-40 | 1:1 | 4000 | | X | 58.5 |
| OKU0660240 | Axial MTSK-40 for Sub-Spindle VDI40 Cool Thru* | MTSK-40 | 1:1 | 4000 | X | X | 69.5 |

AXIAL REDIRECTED DRIVEN TOOL VDI40

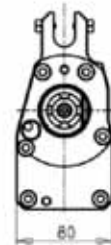
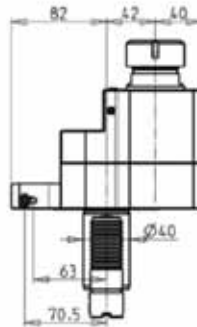

| PartNumber | Description | Spindle | I | RPM | Cool Thru | Ext Cool | A | B |
|------------------|---|---------|-----|------|-----------|----------|--------|----|
| 125OKU_A32_40B00 | Axial Redirected ER32 VDI40 B=93 | ER32 | 1:1 | 4000 | | X | 144.46 | 93 |
| 125OKU_A32_40B30 | Axial Redirected ER32 VDI40 B=93 Cool Thru* | ER32 | 1:1 | 4000 | X | | 164.96 | 93 |

* Coolant Thru tools are designed for 1000 psi.
They require 5 Micron Filtration and **CANNOT** be run dry.

LB15/300, LT15/300, LR15, LU15M, LU300M, GENOS L300M, MAC TURN 250/350/550

DRIVEN

AXIAL GEARED DOWN REDIRECTED DRIVEN TOOL VDI40

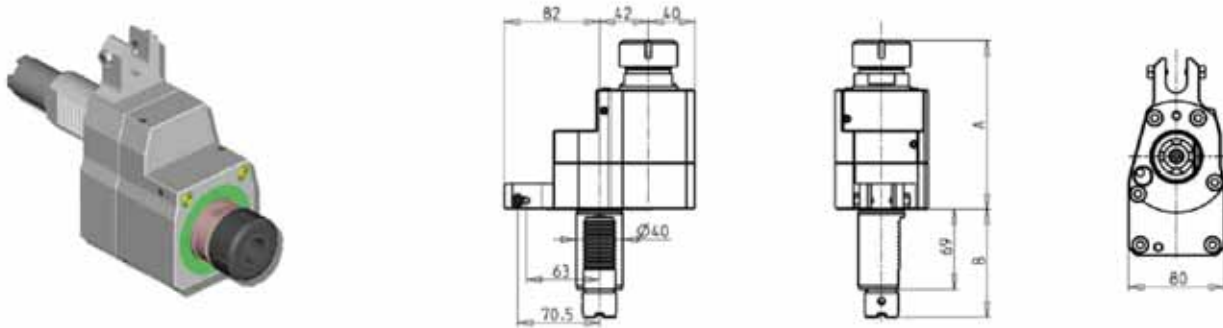

| PartNumber | Description | Spindle | I | RPM | Cool Thru | Ext Cool | A | B |
|------------------|---|---------|-----|------|-----------|----------|--------|----|
| 1250KU_A32_40B10 | Axial Geared Down 2:1 Redirected ER32 VDI 40 | ER32 | 2:1 | 2000 | | X | 144.46 | 93 |
| 1250KU_A32_40B20 | Axial Geared Down 2:1 Redirected ER32 VDI 40 Cool Thru* | ER32 | 2:1 | 2000 | X | | 164.96 | 93 |

* Coolant Thru tools are designed for 1000 psi.
They require 5 Micron Filtration and **CANNOT** be run dry.

AXIAL GEARED UP 1:2 DRIVEN TOOL RE-DIRECTED BY 42mm VDI40

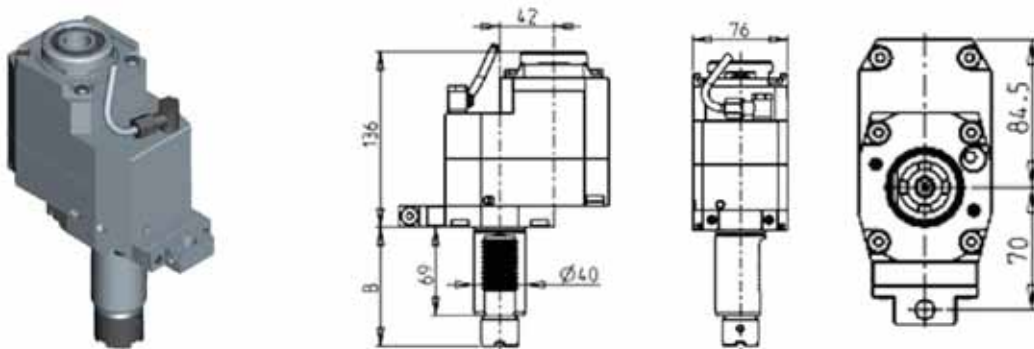

| PartNumber | Description | Spindle | I | RPM | Cool Thru | Ext Cool | B |
|------------|--|---------|-----|------|-----------|----------|----|
| OKU1197132 | Axial Geared Up 1:2 Redirected ERA32 B=93 | ERA32 | 1:2 | 8000 | | X | 93 |
| OKU1197232 | Axial Geared Up 1:2 Redirected ERA32 B=93 Cool Thru* | ERA32 | 1:2 | 8000 | X | X | 93 |

* Coolant Thru tools are designed for 1000 psi.
They require 5 Micron Filtration and **CANNOT** be run dry.

LB15/300, LT15/300, LR15, LU15M, LU300M, GENOS L300M, MAC TURN 250/350/550

DRIVEN

AXIAL OPPOSITE FACE DRIVEN TOOL 90mm INTERAXIS VDI40

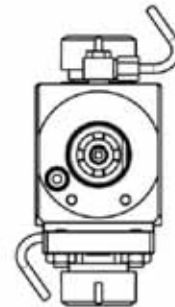
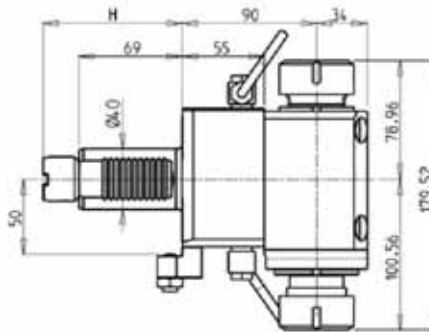
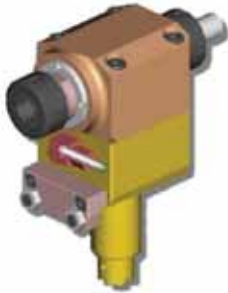

| PartNumber | Description | Spindle | I | RPM | Ext Cool | H |
|------------|---|-----------|-----|------|----------|----|
| OKU0013232 | Axial Opp. Face Double Outlet ER32/ER32 | ER32+ER32 | 1:1 | 4000 | X | 93 |