

DRIVEN TOOLING
For
NAKAMURA-TOME

WT100 - WY100 - NTY3 - NTJ100

DRIVEN

RADIAL DRIVEN TOOL

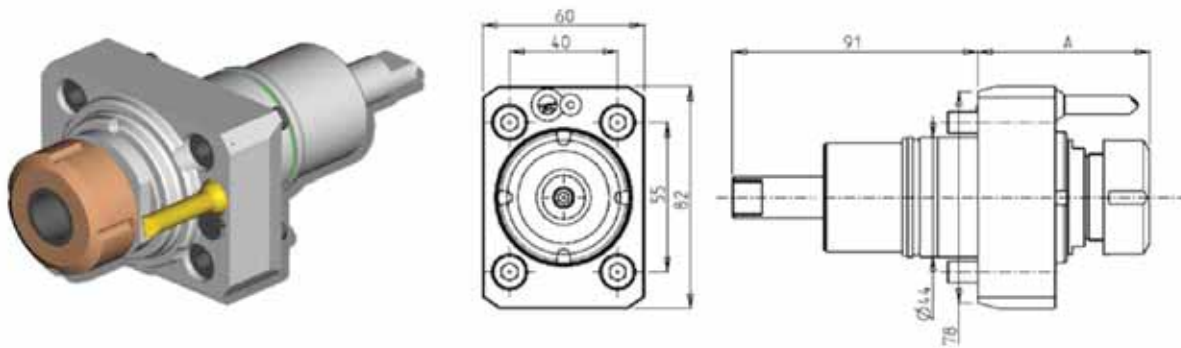

PartNumber	Description	Spindle	I	RPM	Coolant Thru	Ext. Coolant	A
NKM0690520	ERA20 - Reinforced Bearings	ERA20	1:1	6000		X	46
NKM0690125	ER25 - Reinforced Bearings	ER25	1:1	6000		X	63.66
NKM0690620	ERA20 - Reinforced Bearings, Coolant Thru*	ERA20	1:1	6000	X	X	52
NKM0690225	ER25 - Reinforced Bearings, Coolant Thru*	ER25	1:1	6000	X	X	69.66

* Coolant Through tools are designed for 1000 psi.
They require 5 Micron Filtration and **CANNOT** be run dry.

RADIAL SINGLE-SIDE TWIN HEAD DRIVEN TOOL

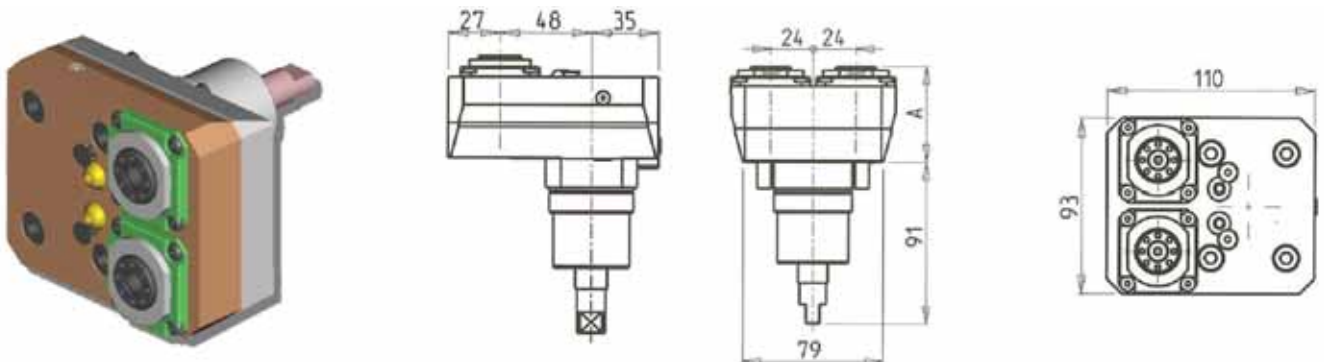

PartNumber	Description	Spindle	I	RPM	Ext Coolant
NKM0190216	ERA16 Single-Side Twin Head	ERA16	1:1	6000	X

WT100 - WY100 - NTY3 - NTJ100

DRIVEN

AXIAL DRIVEN TOOL

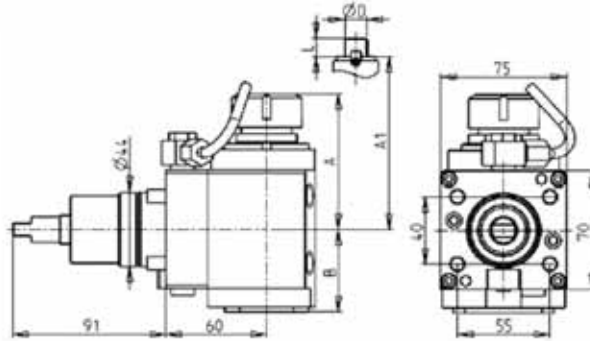

PartNumber	Description	Spindle	Reversible	I	RPM	Coolant Thru	Ext. Coolant	A	A1	B	D	L
NKM0240125	ER25 Standard Axial	ER25	X	1:1	6000		X	80.16		49		
NKM0240520	ERA20 Axial	ERA20	X	1:1	6000		X	69.23		49		
NKM0240225	ER25 Axial Coolant Thru*	ER25	X	1:1	6000	X	X	80.16		59		
NKM0240620	ERA20 Axial Coolant Thru*	ERA20	X	1:1	6000	X	X	69.23		59		
NKM0241617	16x17 Axial Milling Head	16x17	X	1:1	6000		X		63	49	16	17
NKM0242219	22x19 Axial Milling Head	22x19	X	1:1	6000		X		63	49	22	19

* Coolant Through tools are designed for 1000 psi.
They require 5 Micron Filtration and **CANNOT** be run dry.

AXIAL GEARED-UP 1:2 DRIVEN TOOL

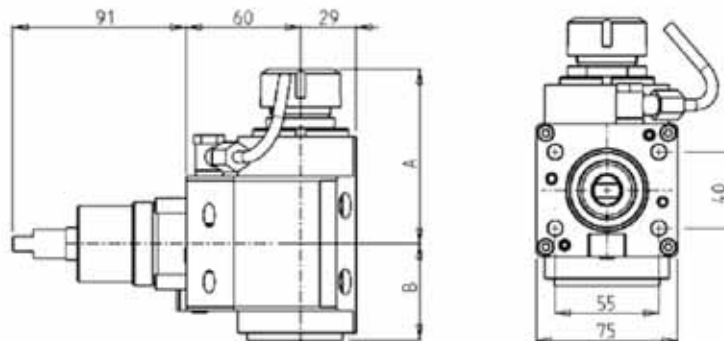

PartNumber	Description	Spindle	Reversible	I	RPM	Coolant Thru	Ext Coolant	A	B
NKM0710125	Axial Geared-Up 1:2 ER25	ER25	X	1:2	12000		X	91.16	50.5
NKM0710320	Axial Geared-Up 1:2 ERA20	ERA20	X	1:2	12000		X	72.50	50.5
NKM0710225	Axial Geared-Up 1:2 ER25 Coolant Thru*	ER25	X	1:2	12000	X	X	91.16	58.5
NKM0710420	Axial Geared-Up 1:2 ERA20 Coolant Thru*	ERA20	X	1:2	12000	X	X	72.5	58.5

* Coolant Through tools are designed for 1000 psi.
They require 5 Micron Filtration and **CANNOT** be run dry.

WT100 - WY100 - NTY3 - NTJ100

DRIVEN

OPPOSITE FACE AXIAL DRIVEN TOOL WITH 60mm INTERAXIS

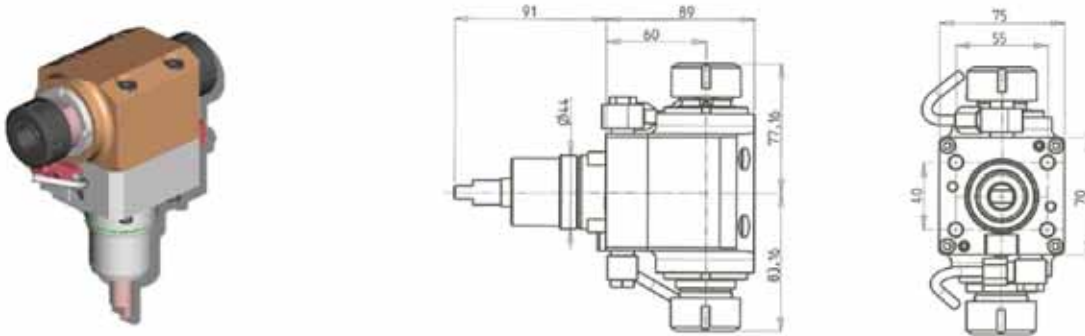

PartNumber	Description	Spindle	Reversible	I	RPM	Ext Coolant
NKM0640225	Opposite Face Axial 60mm Interaxis	ER25 + ER25	X	1:1	6000	X

AXIAL SINGLE SIDE TWIN HEAD DRIVEN TOOL IN Y

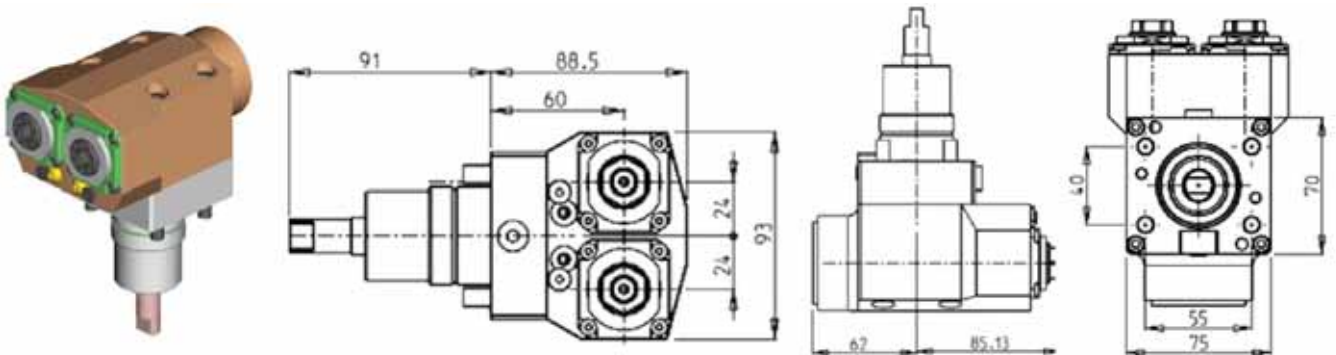

PartNumber	Description	Spindle	Reversible	I	Ext. Coolant
NKM0200216	Axial Single Side Twin Head Driven Tool in Y	ERA16	X	1:1	X

ADJUSTABLE ANGLE DRIVEN TOOL +/-90 DEGREE

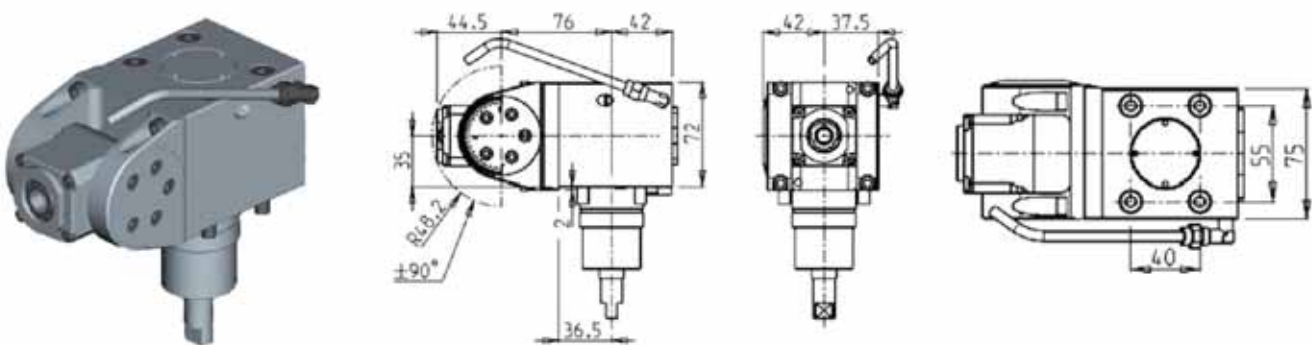

PartNumber	Description	Spindle	Reversible	I	RPM	Ext. Coolant
NKM0670316	Adj. Angle Driven Tool +/-90 Degree	ERA16	X	1:1	6000	X

WT150/250 - WT15011/25011 - WTW150 - WTS150 -SUPER NTM3 - SUPER NTJ - SUPER NTJX - SC200/250 NTY3 250 - TW10M/MY/MM/MMY/MYY - TW20M/MY/MM/MMY/MYY 16 ST.

DRIVEN

RADIAL DRIVEN TOOL

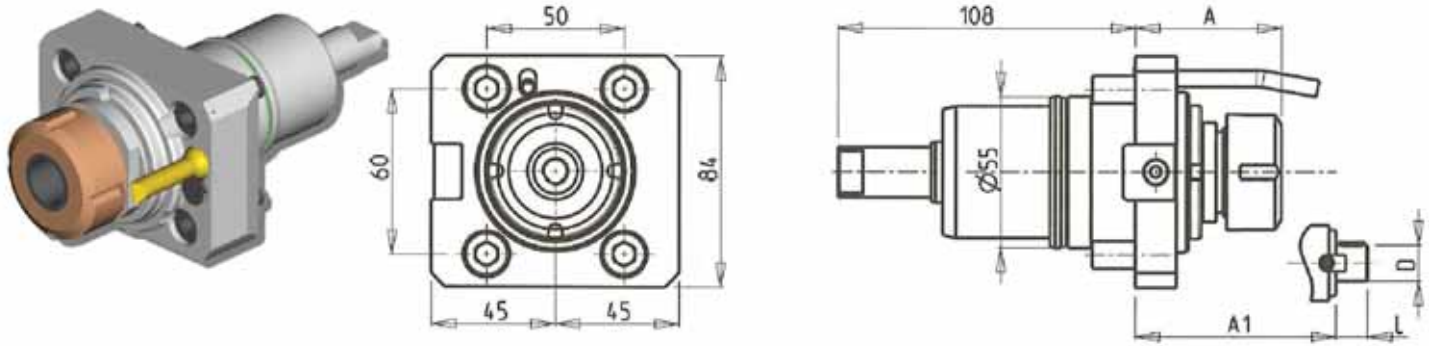

PartNumber	Description	Spindle	RPM	I	Coolant Thru	Ext. Coolant	A	A1	D	L
NKM0700325	ER25A - Reinforced Bearings	ERA25	6000	1:1			51			
NKM0700125	ER25 - Reinforced Bearings	ER25	6000	1:1		X	57.16			
NKM0700132	ER32 - Reinforced Bearings	ER32	6000	1:1		X	61.66			
NKM0700225	ER25 - Reinforced Bearings, Coolant Thru*	ER25	6000	1:1	X	X	68.16			
NKM0700232	ER32 - Reinforced Bearings Coolant Thru*	ER32	6000	1:1	X	X	73.16			
NKM0702219	Milling Head D=22mm, L=19mm	22x19	6000	1:1		X		39	22	19
NKM0702519	Milling Head D=1", L=21mm	1"x19	6000	1:1		X		42	1"	21

* Coolant Through tools are designed for 1000 psi. They require 5 Micron Filtration and **CANNOT** be run dry.

GEARED-UP RADIAL DRIVEN TOOL

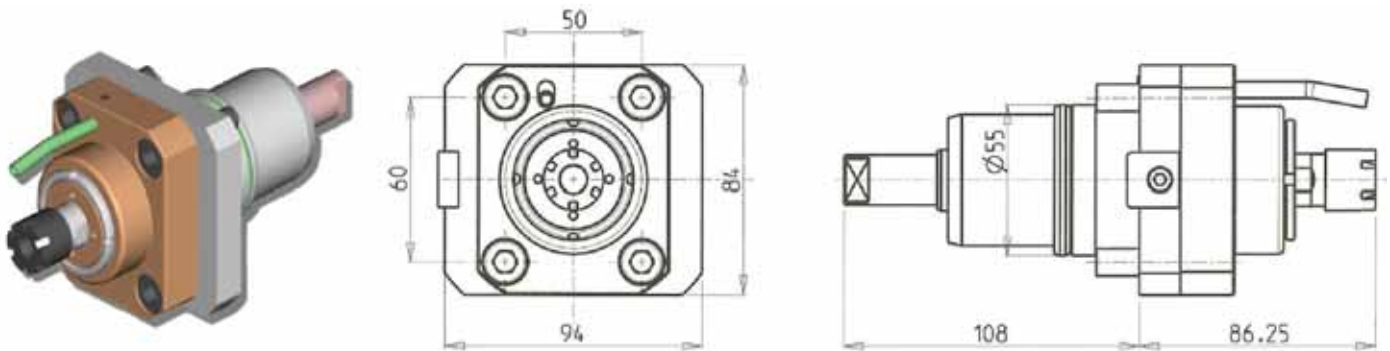

PartNumber	Description	Spindle	I	RPM	Ext Coolant
NKM0040016	Geared-Up 1:3 ER16	ER16	1:3	18000	X

WT150/250 - WT15011/25011 - WTW150 - WTS150 - SUPER NTM3 - SUPER NTJ - SUPER NTJX - SC200/250 NTY3 250 - TW10M/MY/MM/MMY/MMYY - TW20M/MY/MM/MMY/MMYY 16 ST.

DRIVEN

RADIAL SINGLE-SIDE TWIN HEAD DRIVEN TOOL

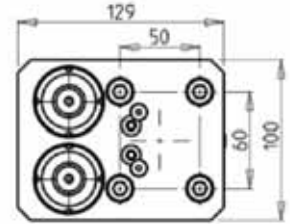
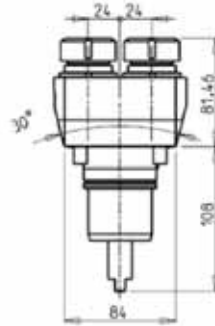
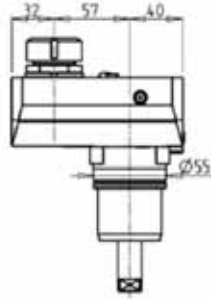
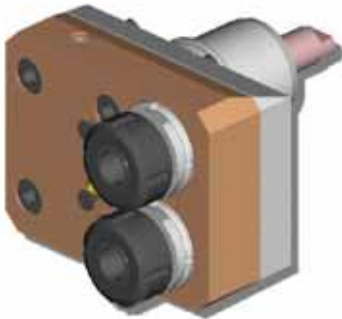

PartNumber	Description	Spindle	Reversible	I	RPM	Ext. Coolant
NKM0320225	Singe-Side Twin Head ER25	ER25	X	1:1	6000	X

+/- 30 RADIAL REDIRECTED ADJUSTABLE ANGLE TOOL

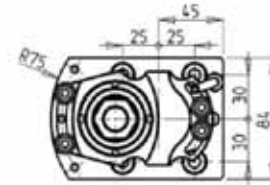
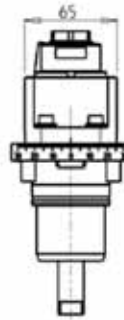
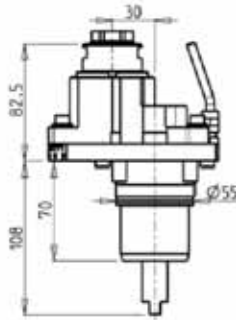

PartNumber	Description	Spindle	I	RPM	Ext Coolant
NKM0621025	Radial Re-Directed +/- 30 Adj. Angle Tool	ERA25	1:1	6000	X

Note : Wrenches are provided with the purchase of Specialty Toolholders

WT150/250 - WT15011/25011 - WTW150 - WTS150 - SUPER NTM3 - SUPER NTJ - SUPER NTJX - SC200/250 NTY3 250 - TW10M/MY/MM/MMY/MYY - TW20M/MY/MM/MMY/MYY 16 ST.

DRIVEN

AXIAL DRIVEN TOOL WITH 55mm INTERAXIS

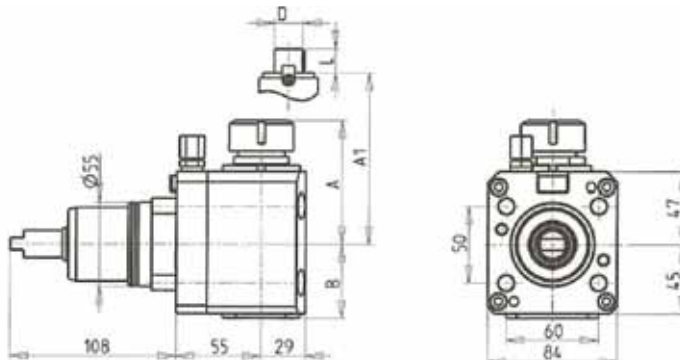

PartNumber	Description	Spindle	Reversible	I	RPM	Coolant Thru	Ext Coolant	A	A1	B	D	L
NKM0021620	ER20 Standard	ER20	X	1:1	6000		X	80.16		48		
NKM0021420	ERA20 Standard	ERA20	X	1:1	6000		X	69.23		48		
NKM0021425	ER25 Standard	ER25	X	1:1	6000		X	80.16		48		
NKM0022432	ER32 Standard	ER32	X	1:1	6000		X	97.66		48		
NKM0021820	ER20 Coolant Thru*	ER20	X	1:1	6000	X	X	80.16		58		
NKM0021625	ER25 Coolant Thru*	ER25	X	1:1	6000	X	X	80.16		58		
NKM0022532	ER32 Coolant Thru*	ER32	X	1:1	6000	X	X	97.66		57.5		
NKM0021617	Milling Head D=16mm, L=17mm	16x17	X	1:1	6000		X		63	48	16	17
NKM0022219	Milling Head D=22mm, L=19mm	22x19	X	1:1	6000		X		63	48	22	19
NKM0022721	Milling Head D=27mm, L=21mm	27x21	X	1:1	6000		X		65.5	48	27	21
NKM0022737	Milling Head D=27mm, L=37mm	27x37	X	1:1	6000		X		65.5	48	27	37

* Coolant Through tools are designed for 1000 psi.
They require 5 Micron Filtration and **CANNOT** be run dry.

WT250 - WT1500/25011 - WTW150 - WTS150 - SC200 - SC250 - SUPER NTJX - NTY3 250

DRIVEN

AXIAL DRIVEN TOOL WITH 75mm INTERAXIS

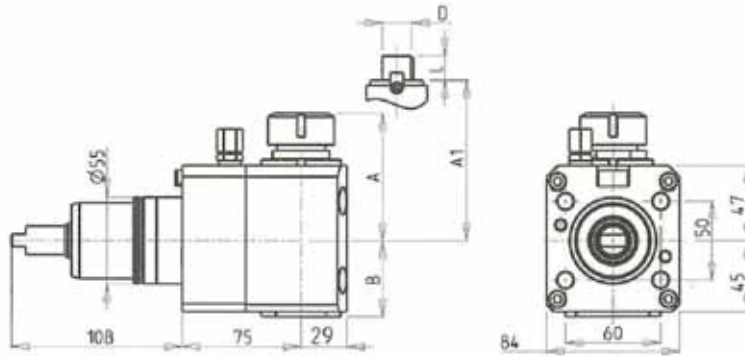

PartNumber	Description	Spindle	Reversible	I	RPM	Coolant Thru	Ext Coolant	A	A1	B	D	L
NKM0061620	ER20 Standard	ER20	X	1:1	6000		X	80.16		48		
NKM0061420	ERA20 Standard	ERA20	X	1:1	6000		X	69.23		48		
NKM0061425	ER25 Standard	ER25	X	1:1	6000		X	80.16		48		
NKM0062432	ER32 Standard	ER32	X	1:1	6000		X	97.66		48		
NKM0061820	ER20 Coolant Thru*	ER20	X	1:1	6000	X	X	80.16		57.5		
NKM0061625	ER25 Coolant Thru*	ER25	X	1:1	6000	X	X	80.16		57.5		
NKM0062532	ER32 Coolant Thru*	ER32	X	1:1	6000	X	X	92.16		57.5		
NKM0061617	Milling Head D=16mm, L=17mm	16x17	X	1:1	6000		X		63	48	16	17
NKM0062219	Milling Head D=22mm, L=19mm	22x19	X	1:1	6000		X		63	48	22	19
NKM0062721	Milling Head D=27mm, L=21mm	27x21	X	1:1	6000		X		65.5	48	27	21

* Coolant Through tools are designed for 1000 psi.
They require 5 Micron Filtration and **CANNOT** be run dry.

WT150/250 - WT15011/25011 - WTW150 - WTS150 - SUPER NTM3 - SUPER NTJ - SUPER NTJX - SC200/250 NTY3 250 - TW10M/MY/MM/MMY/MMYY - TW20M/MY/MM/MMY/MMYY 16 ST.

DRIVEN

AXIAL HEAVY DUTY DRIVEN TOOL WITH 55mm INTERAXIS

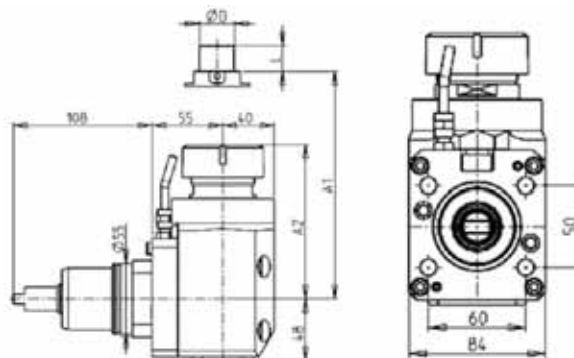

PartNumber	Description	Spindle	Reversible	I	RPM	Ext Coolant	A	A1	D	L
NKM0070140	Heavy Duty Axial ER40	ER40	X	1:1	6000	X	119.16			
NKM0072519	Heavy Duty Milling Head 1"x19	1"x19	X	1:1	6000	X		91.5	1"	19
NKM0072721	Heavy Duty Milling Head 27x21	27x21	X	1:1	6000	X		91.5	27	20

WT150/250 - WT15011/25011 - WTW150 - WTS150 -SUPER NTM3 - SUPER NTJ - SUPER NTJX - SC200/250 NTY3 250 - TW10M/MY/MM/MMY/MMYY - TW20M/MY/MM/MMY/MMYY 16 ST.

DRIVEN

AXIAL MTSK REINFORCED DRIVEN TOOL H=55mm

See Accessories for Clamping Units

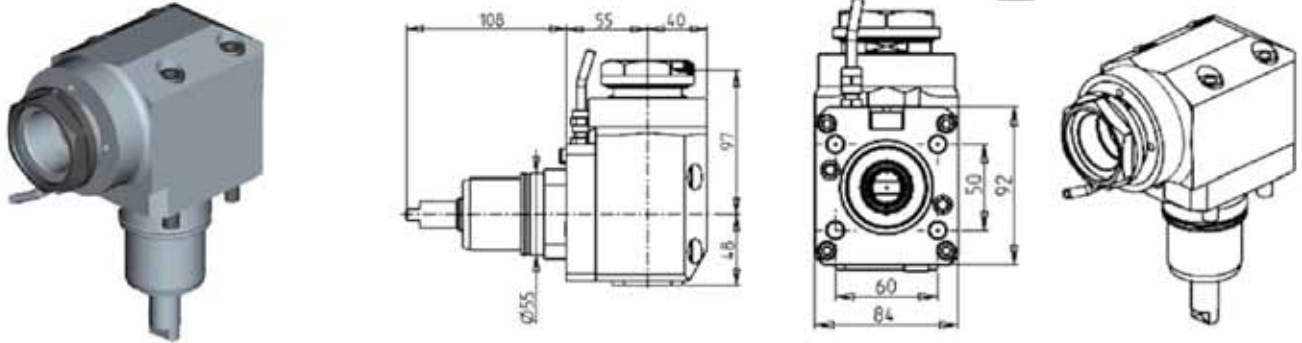

PartNumber	Description	Spindle	Reversible	I	RPM	Ext. Coolant
NKM1000150	Axial MTSK-50 Reinforced H=55	MTSK-50	X	1:1	6000	X

WT250 - WT1500/25011 - WTW150 - WTS150 - SC200 - SC250 - SUPER NTJX - NTY3 250

DRIVEN

AXIAL REINFORCED DRIVEN TOOL H=75mm

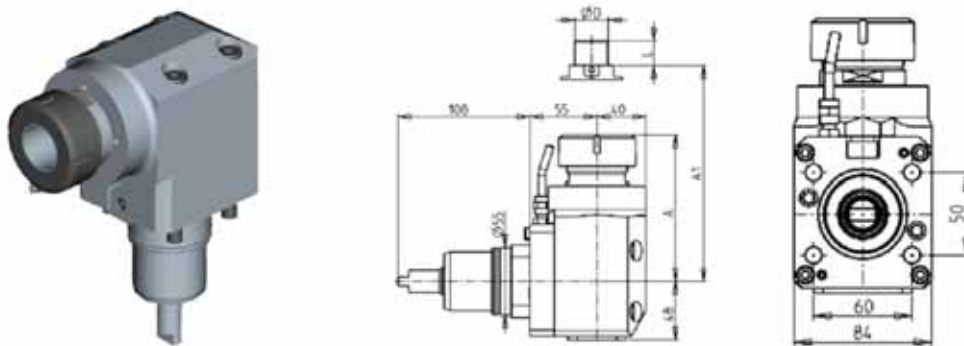

PartNumber	Description	Spindle	Reversible	I	RPM	Ext. Coolant	A	A1	D	L
NKM0990140	Axial Reinforced H=75 ER40	ER40	X	1:1	6000	X	119.16			
NKM0992519	Axial Reinforced H=75, 1"x19mm	1"x19	X	1:1	6000	X		91.5	1"	19
NKM0992721	Axial Reinforced H=75, 27mmx21mm	27x21	X	1:1	6000	X		91.5	27	21

WT250 - WT1500/25011 - WTW150 - WTS150 - SC200 - SC250 - SUPER NTJX - NTY3 250

DRIVEN

AXIAL MTSK REINFORCED DRIVEN TOOL H=75mm

See Accessories for Clamping Units

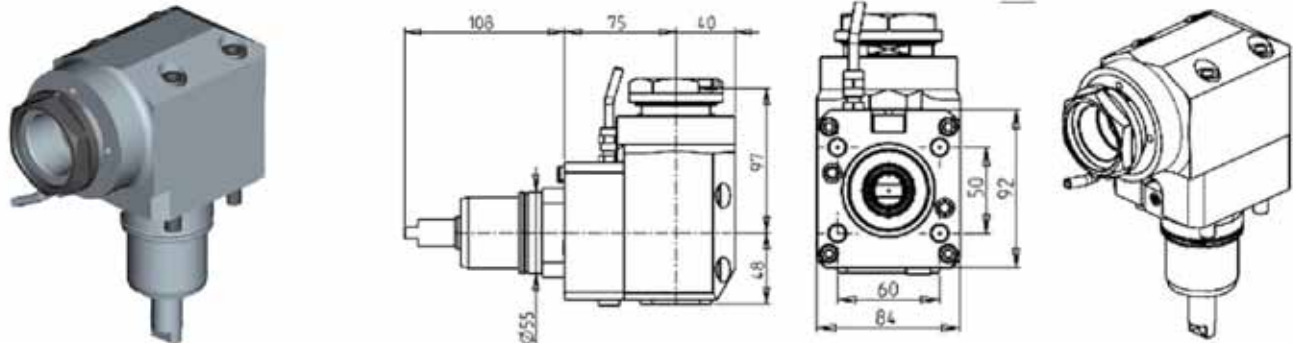

PartNumber	Description	Spindle	Reversible	I	RPM	Ext. Coolant
NKM1010150	Axial MTSK-50 Reinforced H=75	MTSK-50	X	1:1	6000	X

GEARED-UP AXIAL DRIVEN TOOL WITH 75mm INTERAXIS

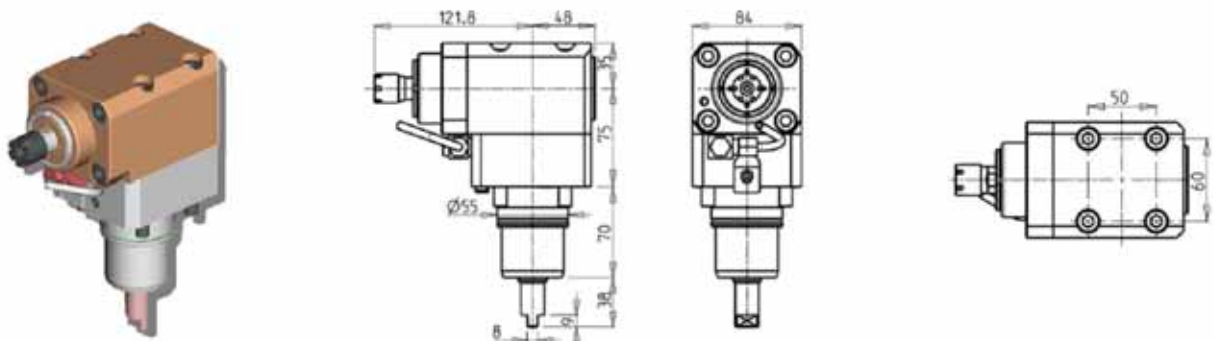

PartNumber	Description	Spindle	Reversible	I	RPM	Ext. Coolant
NKM0050216	Geared-Up 1:3 ER16 75mm Interaxis	ER16	X	1:3	18000	X

WT150/250 - WT15011/25011 - WTW150 - WTS150 - SUPER NTM3 - SUPER NTJ - SUPER NTJX - SC200/250 NTY3 250 - TW10M/MY/MM/MMY/MMYY - TW20M/MY/MM/MMY/MMYY 16 ST.

DRIVEN

GEARED-UP AXIAL DRIVEN TOOL WITH 55mm INTERAXIS

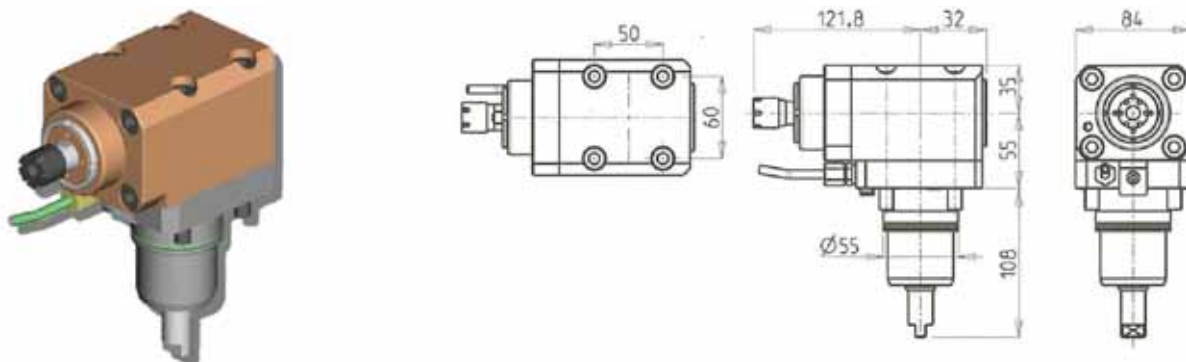

PartNumber	Description	Spindle	Reversible	I	RPM	Ext. Coolant
NKM0050016	Geared-Up 1:3 ER16	ER16	X	1:3	18000	X

WT150/250 - WT15011/25011 - WTW150 - WTS150 -SUPER NTM3 - SUPER NTJ - SUPER NTJX - SC200/250 NTY3 250 - TW10M/MY/MM/MMY/MMYY - TW20M/MY/MM/MMY/MMYY 16 ST.

DRIVEN

AXIAL DRIVEN TOOL FOR INTERNAL POLYGON MAKING WITH 55mm INTERAXIS

See Accessories for Mill Heads

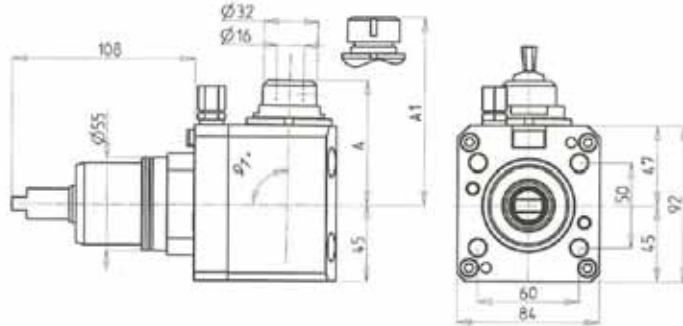

PartNumber	Description	Spindle	Reversible	I	RPM	Ext Coolant	A	A1
NKM0039125	ER25 Internal Polygon Making	ER25	X	1:1	6000	X		80.44
NKM0039108	Weldon 8 Internal Polygon	Weldon 8	X	1:1	6000	X	76.5	
NKM0039110	Weldon 10 Internal Polygon	Weldon 10	X	1:1	6000	X	76.5	
NKM0039112	Weldon 12 Internal Polygon	Weldon 12	X	1:1	6000	X	76.5	
NKM0039116	Weldon 16 Internal Polygon	Weldon 16	X	1:1	6000	X	73.7	

WT250 - WT1500/25011 - WTW150 - WTS150 - SC200 - SC250 - SUPER NTJX - NTY3 250

DRIVEN

AXIAL DRIVEN TOOL FOR INTERNAL POLYGON MAKING WITH 75mm INTERAXIS

See Accessories for Mill Heads

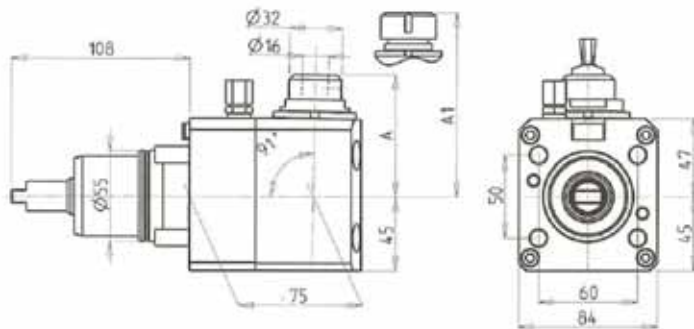

PartNumber	Description	Spindle	Reversible	I	RPM	Ext Coolant	A	A1
NKM0069125	ER25 Internal Polygon Making	ER25	X	1:1	6000	X		80.44
NKM0069108	Weldon 8 Internal Polygon	Weldon 8	X	1:1	6000	X	76.5	
NKM0069110	Weldon 10 Internal Polygon	Weldon 10	X	1:1	6000	X	76.5	
NKM0069112	Weldon 12 Internal Polygon	Weldon 12	X	1:1	6000	X	76.5	
NKM0069116	Weldon 16 Internal Polygon	Weldon 16	X	1:1	6000	X	73.7	

WT150/250 - WT15011/25011 - WTW150 - WTS150 - SUPER NTM3 - SUPER NTJ - SUPER NTJX - SC200/250 NTY3 250 - TW10M/MY/MM/MMY/MYY - TW20M/MY/MM/MMY/MYY 16 ST.

DRIVEN

OPPOSITE FACE AXIAL DRIVEN TOOL WITH 55mm INTERAXIS

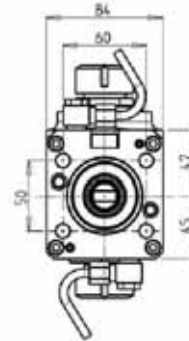
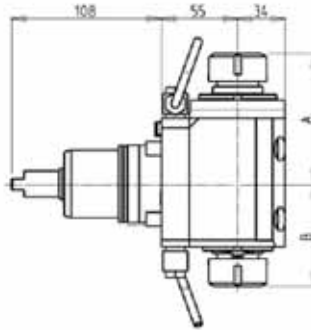

PartNumber	Description	Spindle	Reversible	I	RPM	Ext. Coolant	A	B
NKM0492525	Opposite Face Axial ER25+ER25, H=55	ER25+ER25	X	1:1	6000	X	93.36	73.46
NKM0493232	Opposite Face Axial ER32+ER32, H=55	ER32+ER32	X	1:1	6000	X	100.56	78.96

WT250 - WT1500/25011 - WTW150 - WTS150 - SC200 - SC250 - SUPER NTJX - NTY3 250

DRIVEN

OPPOSITE FACE AXIAL DRIVEN TOOL WITH 75mm INTERAXIS

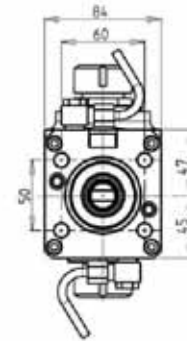
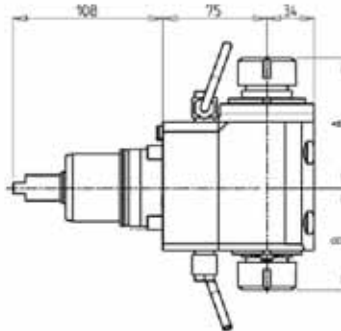

PartNumber	Description	Spindle	Reversible	I	RPM	Ext Coolant	A	B
NKM0502525	Opposite Face Axial ER25+ER25, H=75	ER25+ER25	X	1:1	6000	X	93.36	73.46
NKM0503232	Opposite Face Axial ER32+ER32, H=75	ER32+ER32	X	1:1	6000	X	100.56	78.96

WT150/250 - WT15011/25011 - WTW150 - WTS150 - SUPER NTM3 - SUPER NTJ - SUPER NTJX - SC200/250 NTY3 250 - TW10M/MY/MM/MMY/MYY - TW20M/MY/MM/MMY/MYY 16 ST.

DRIVEN

AXIAL SINGLE-SIDE TWIN HEAD DRIVEN TOOL WITH 55mm INTERAXIS

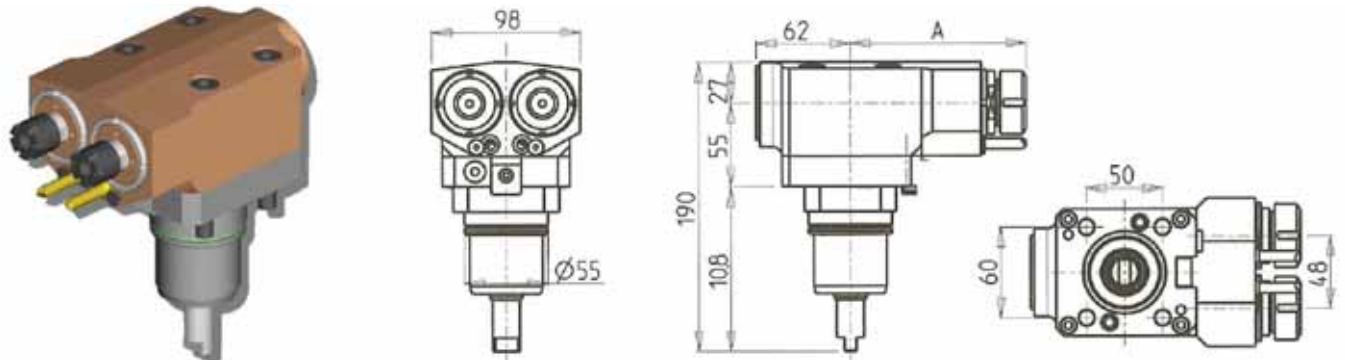

PartNumber	Description	Spindle	Reversible	I	RPM	Ext Coolant	A
NKM0130216	Single-Side Twin Head ER16 H=55	ER16	X	1:1	6000	X	115.15
NKM0130225	Single-Side Twin Head ER25 H=55	ER25	X	1:1	6000	X	115.61

WT250 - WT1500/25011 - WTW150 - WTS150 - SC200 - SC250 - SUPER NTJX - NTY3 250

DRIVEN

AXIAL SINGLE-SIDE TWIN HEAD DRIVEN TOOL WITH 75mm INTERAXIS

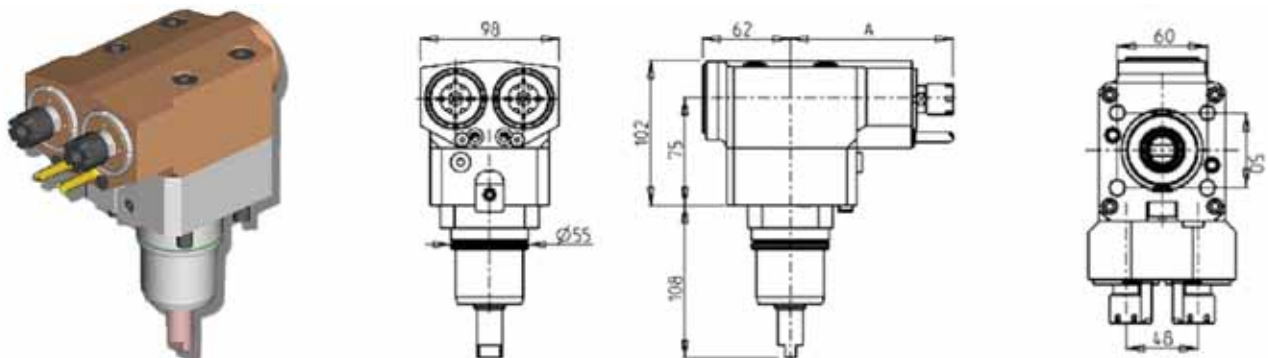

PartNumber	Description	Spindle	Reversible	I	RPM	Ext Coolant	A
NKM0131216	Single-Side Twin Head ER16	ER16	X	1:1	6000	X	115.15
NKM0131225	Single-Side Twin Head ER25	ER25	X	1:1	6000	X	115.61

WT150/250 - WT15011/25011 - WTW150 - WTS150 - SUPER NTM3 - SUPER NTJ - SUPER NTJX - SC200/250 NTY3 250 - TW10M/MY/MM/MMY/MYY - TW20M/MY/MM/MMY/MYY 16 ST.

DRIVEN

0-90 ADJUSTABLE ANGLE DRIVEN TOOL WITH 55mm INTERAXIS

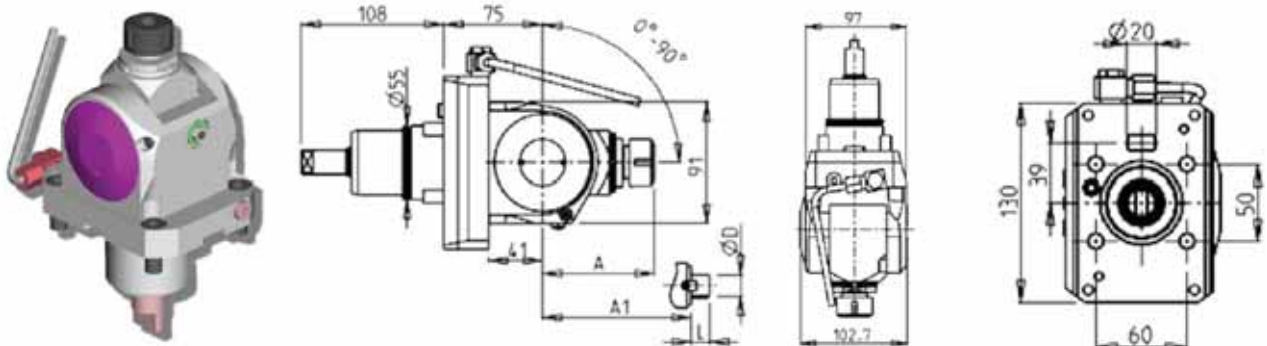

PartNumber	Description	Spindle	Reversible	I	RPM	Ext Coolant	A	A1	D	L
NKM0090020	Adj. Angle (0-90) ER20	ER20	X	1:1	6000	X	84.16			
NKM0090025	Adj. Angle (0-90) ER25	ER25	X	1:1	6000	X	85.66			
NKM0091905	Adj. Angle (0-90) Milling Head 3/4"x3/4"	3/4" x 3/4"	X	1:1	6000	X		65	3/4"	3/4"
NKM0091617	Adj. Angle (0-90) Milling Head 16x17	16x17	X	1:1	6000	X		65	16	17
NKM0092219	Adj. Angle (0-90) Milling Head 22x19	22x19	X	1:1	6000	X		66	22	19

Note : Wrenches are provided with the purchase of Specialty Toolholders

0-180 ADJUSTABLE ANGLE DRIVEN TOOL

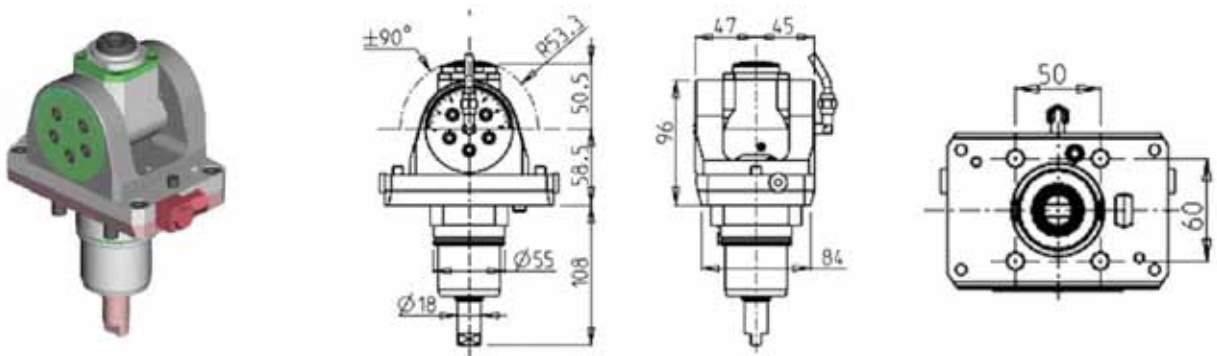

PartNumber	Description	Spindle	I	RPM	Coolant Thru	Ext. Coolant
NKM0790120	Adj. Angle (0-180) ERA20	ERA20	1:1	6000		X
NKM0790220	Adj. Angle (0-180) ERA20 Coolant Thru*	ERA20	1:1	6000	X	X

* Coolant Thru tools are designed for 1000 psi. They require 5 Micron Filtration and **CANNOT** be run dry.

Note : Wrenches are provided with the purchase of Specialty Toolholders

WT150/250 - WT15011/25011 - WTW150 - WTS150 - SUPER NTM3 - SUPER NTJ - SUPER NTJX - SC200/250 NTY3 250 - TW10M/MY/MM/MMY/MMYY - TW20M/MY/MM/MMY/MMYY 16 ST.

DRIVEN

0-180 ADJUSTABLE ANGLE DRIVEN TOOL GEARED UP

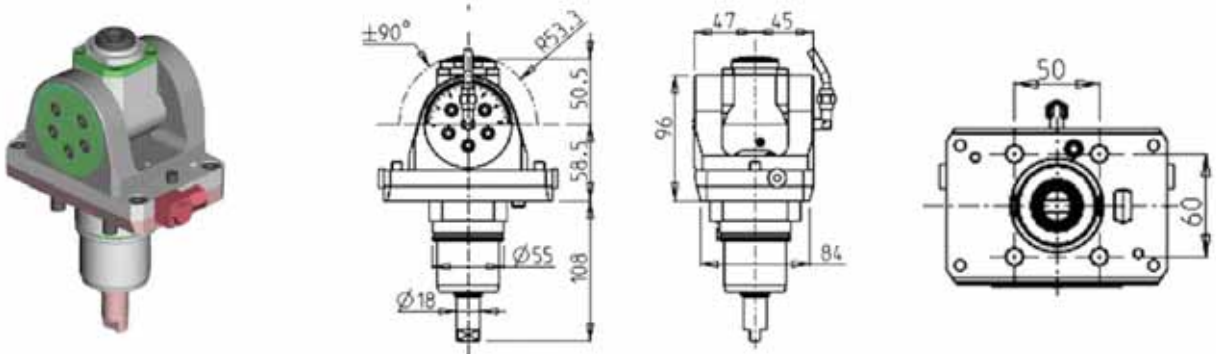

PartNumber	Description	Spindle	I	RPM	Coolant Thru	Ext. Coolant
NKM0790316	Adj. Angle (0-180) Geared-Up 1:2 ERA16	ERA16	1:2	12000		X
NKM0790416	Adj. Angle (0-180) Geared-Up 1:2 ERA16 Coolant Thru*	ERA16	1:2	12000	X	X

* Coolant Thru tools are designed for 1000 psi. They require 5 Micron Filtration and **CANNOT** be run dry.

Note : Wrenches are provided with the purchase of Specialty Toolholders

GEAR HOBBER DRIVEN TOOL

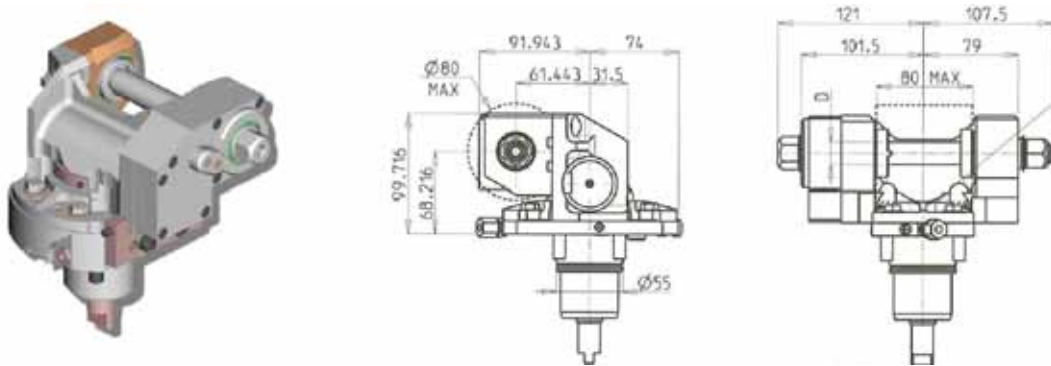

PartNumber	Description	I	RPM	Ext Coolant	D mm	D Inch
NKM0081100	Gear Hobbing Tool 1:1	1:1	6000	X	16-22-27-32	3/4"-1"-1 1/4"
NKM0082100	Gear Hobbing Tool 2:1 Geared Down	2:1	3000	X	16-22-27-32	3/4"-1"-1 1/4"

Note : Wrenches are provided with the purchase of Specialty Toolholders

WT250 - WT1500/25011 - WTW150 - WTS150 - SC200 - SC250 - SUPER NTJX - NTY3 250

DRIVEN

BROACHING/SLOTING DRIVEN TOOL H=66mm

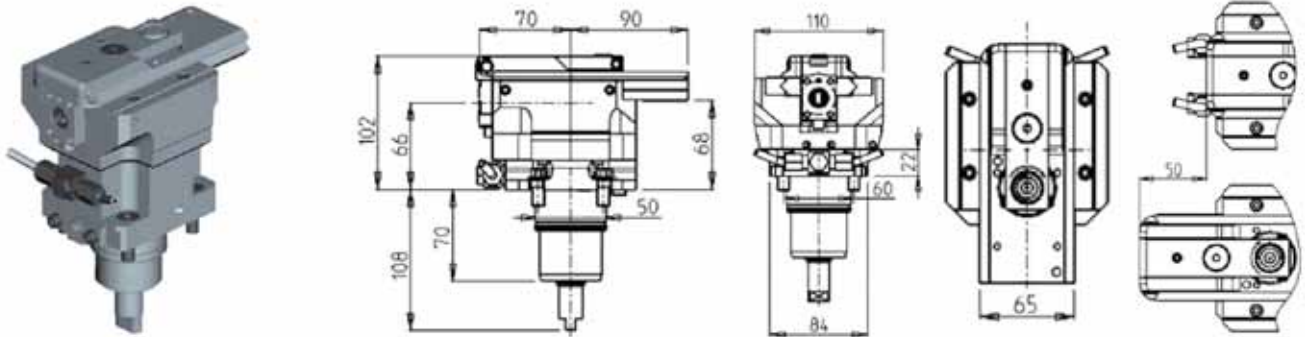

PartNumber	Description	Reversible	I	RPM	Ext. Coolant
NKM0910100	Broaching/Slotting Driven Tool H=66mm	X	4:1	2000	X

BROACHING/SLOTING DRIVEN TOOL H=76mm

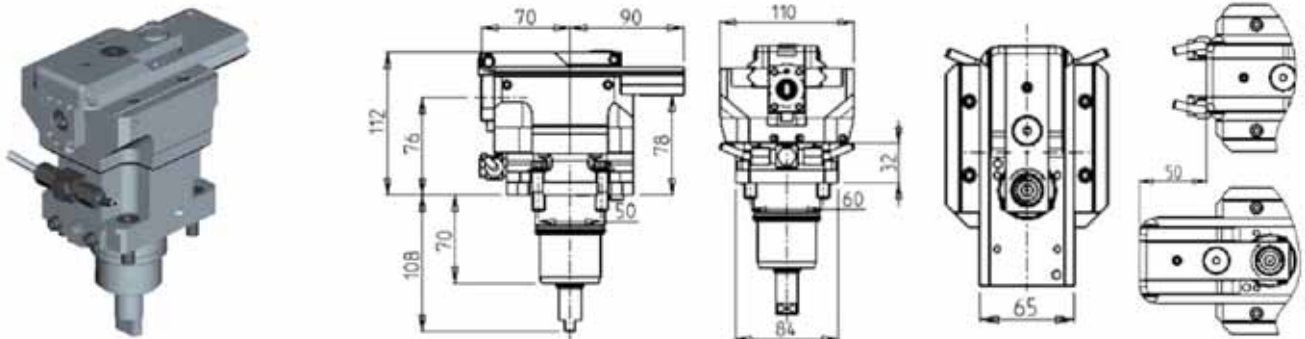

PartNumber	Description	Reversible	I	RPM	Ext. Coolant
NKM0920100	Broaching/Slotting Driven Tool H=76mm	X	4:1	2000	X

WT250 - WT1500/25011 - WTW150 - WTS150 - SUPER NTM3 - SUPER NTJ - SUPER NTJX - NTY3 250

DRIVEN

DRIVEN TOOL HOLDER FOR SLIDING STEADY REST

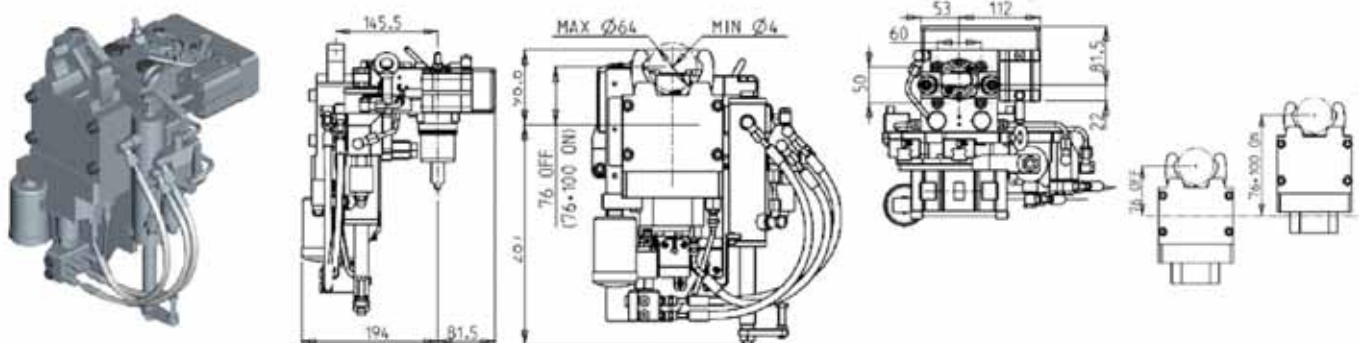

PartNumber	Description	I	RPM	Ext. Coolant	Electronics
NKM0760300	Driven Toolholder for Sliding Steady Rest (Size 1)	1:1	6000	X	
NKM0760300A	Driven Toolholder for Sliding Steady Rest (Size 1) with Electronics	1:1	6000	X	X

WT300-SC300-SUPER NTX-SUPER NTXL - TW20M/MY/MM/MMY/MMYY 12 ST. - TW30M/MY/MMY/MMYY 16 ST.

DRIVEN

RADIAL DRIVEN TOOL

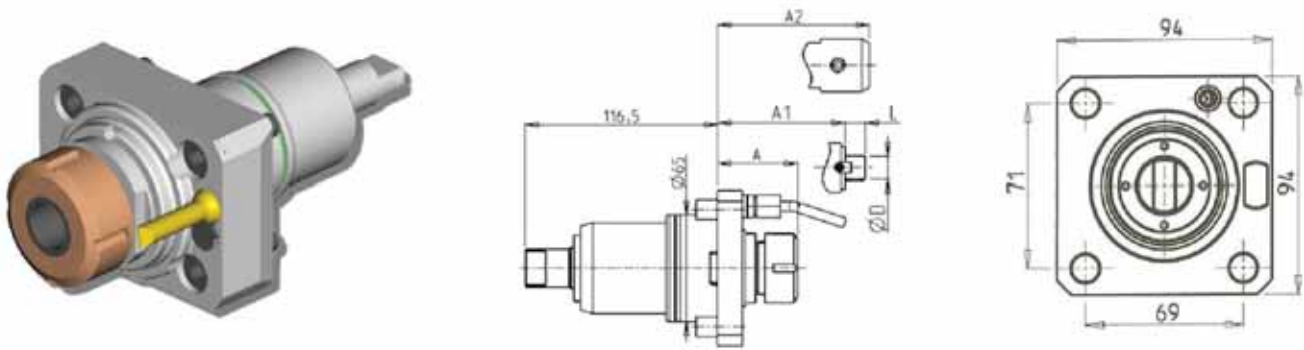

PartNumber	Description	Spindle	I	RPM	Coolant Thru	Ext Coolant	A	A1	D	L
NKM0270125	ER25 Standard	ER25	1:1	6000		X	48.66			
NKM0270132	ER32 Standard	ER32	1:1	6000		X	52.16			
NKM0270225	ERA25 Coolant Thru*	ERA25	1:1	6000	X	X	60.03			
NKM0270232	ERA32 Coolant Thru*	ERA32	1:1	6000	X	X	67.53			
NKM0270422	Milling Head 22x19	22x19	1:1	6000		X		35	22	19
NKM0270325	Milling Head Weldon 25	WELDON 25	1:1	6000	X	X		65		

* Coolant Through tools are designed for 1000 psi.
They require 5 Micron Filtration and **CANNOT** be run dry.

RADIAL DRIVEN TOOL GEARED UP 1:2 DRIVEN TOOL RE-DIRECTED IN Z BY 45MM

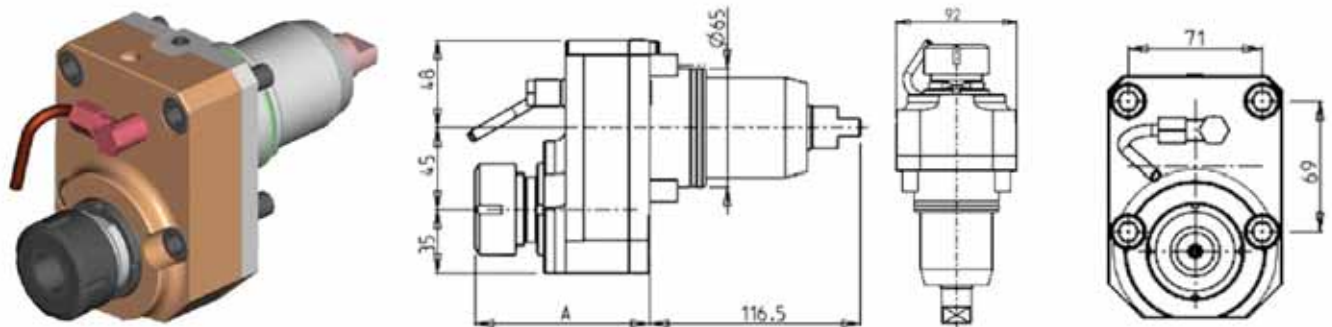

PartNumber	Description	Spindle	Reversible	I	Ext. Coolant	A
NKM0660132	Radial Geared Up 1:2 Driven Re-Directed in Z by 45mm	ER32	X	1:2	X	96.6

WT300-SC300-SUPER NTX-SUPER NTXL - TW20M/MY/MM/MMY/MMYY 12 ST. - TW30M/MY/MMY/MMYY 16 ST.

DRIVEN

RADIAL GEARED-UP 1:3 DRIVEN TOOL

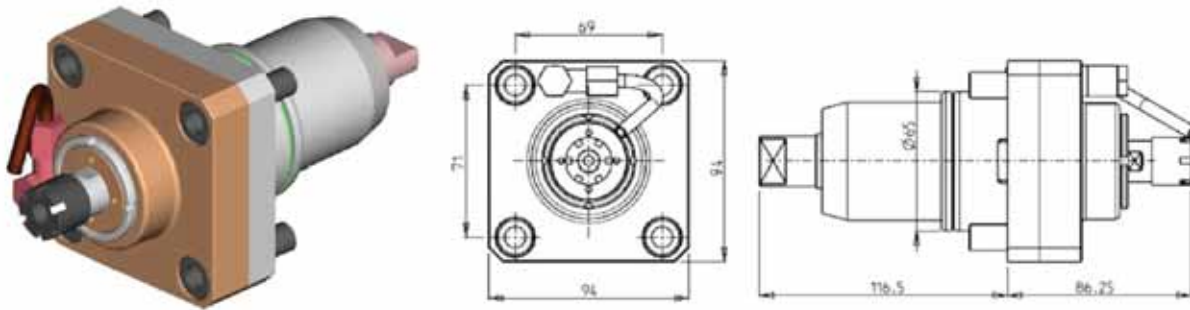

PartNumber	Description	Spindle	I	RPM	Ext. Coolant
NKM0680116	Radial Geared-Up 1:3 Driven Tool	ER16	1:3	18000	X

AXIAL DRIVEN TOOL H=65

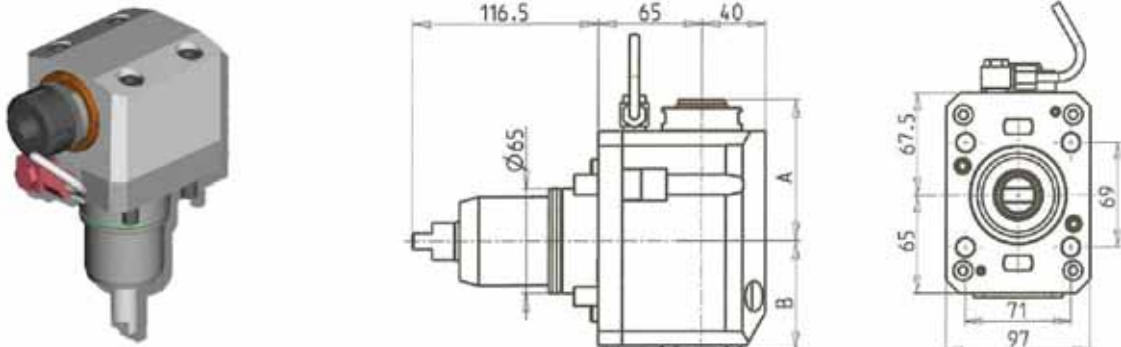

PartNumber	Description	Spindle	Reversible	I	RPM	Coolant Thru	Ext Coolant	A	A1	B	D	L
NKM0260125	ERA25 Standard	ERA25	X	1:1	6000		X	91.03		68		
NKM0260132	ERA32 Standard	ERA32	X	1:1	6000		X	94.53		68		
NKM0260225	ERA25 Coolant Thru*	ERA25	X	1:1	6000	X	X	91.03		91.5		
NKM0260232	ER32A Coolant Thru*	ERA32	X	1:1	6000	X	X	94.53		91.5		
NKM0262219	22x19 Axial Milling Head	22x19	X	1:1	6000	X	X		80	68	22	19

* Coolant Through tools are designed for 1000 psi.
They require 5 Micron Filtration and **CANNOT** be run dry.

WT300-SC300-SUPER NTX-SUPER NTXL - TW20M/MY/MM/MMY/MMYY 12 ST. - TW30M/MY/MMY/MMYY 16 ST.

DRIVEN

AXIAL OPPOSITE FACE TWIN DRIVEN TOOL H=65

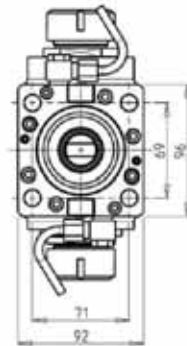
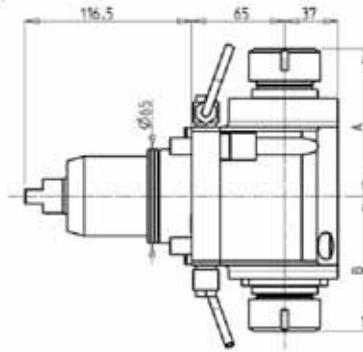

PartNumber	Description	Spindle	Reversible	I	Ext. Coolant	A	B
NKM0590232	Opposite Face Axial ER32+ER32, H=65mm	ER32+ER32	X	1:1	X	102.66	94.26

0-90 ADJUSTABLE ANGLE DRIVEN TOOL

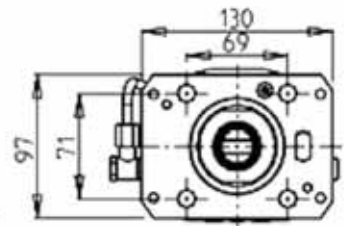
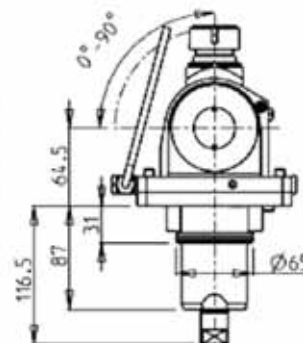
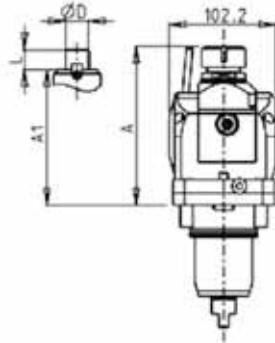

PartNumber	Description	Spindle	I	RPM	Ext. Coolant	A	A1	D	L
NKM0900020	0-90 Adj. Angle ER20	ER20	1:1	6000	X	149.66			
NKM0900025	0-90 Adj. Angle ER25	ER25	1:1	6000	X	150.66			
NKM0901905	0-90 Adj. Angle 3/4"x3/4"	3/4"x3/4"	1:1	6000	X		129.5	3/4"	3/4"
NKM0901617	0-90 Adj. Angle 16x17	16x17	1:1	6000	X		129.5	16	17
NKM0902219	0-90 Adj. Angle 22x19	22x19	1:1	6000	X		130.5	22	19

WT300-SC300-SUPER NTX-SUPER NTXL - TW20M/MY/MM/MMY/MMYY 12 ST. - TW30M/MY/MMY/MMYY 16 ST.

DRIVEN

0-180 ADJUSTABLE ANGLE DRIVEN TOOL

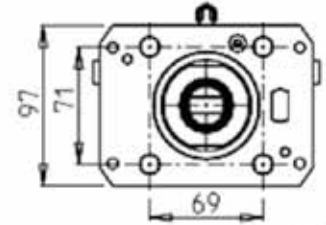
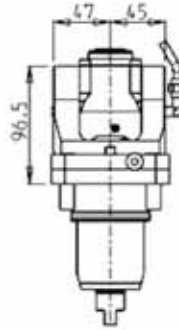
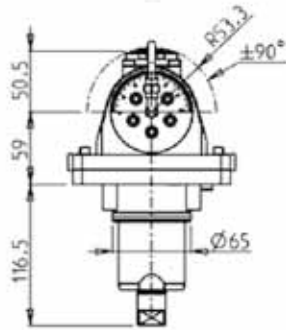

PartNumber	Description	Spindle	I	RPM	Coolant Thru	Ext. Coolant
NKM0800120	Adj. Angle (0-180) ERA20	ERA20	1:1	6000		X
NKM0800220	Adj. Angle (0-180) ERA20 Coolant Thru*	ERA20	1:1	6000	X	X

* Coolant Thru tools are designed for 1000 psi.
They require 5 Micron Filtration and **CANNOT** be run dry.

Note :

Wrenches are provided with the purchase of Specialty Toolholders

0-180 ADJUSTABLE ANGLE DRIVEN TOOL GEARED UP

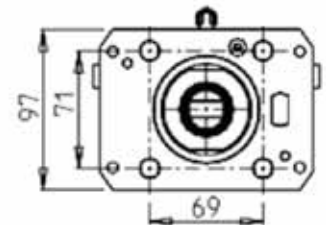
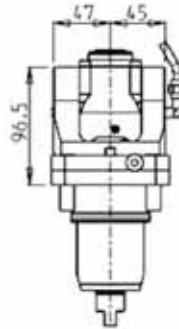
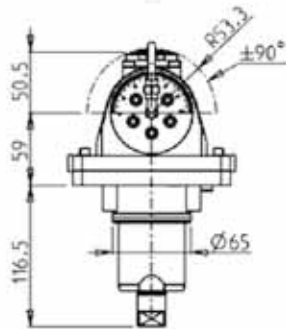

PartNumber	Description	Spindle	I	RPM	Coolant Thru	Ext Coolant
NKM0800316	Adj. Angle (0-180) Geared-Up 1:2 ERA16	ERA16	1:2	12000		X
NKM0800416	Adj. Angle (0-180) Geared-Up 1:2 ERA16 Coolant Thru*	ERA16	1:2	12000	X	X

* Coolant Thru tools are designed for 1000 psi.
They require 5 Micron Filtration and **CANNOT** be run dry.

Note :

Wrenches are provided with the purchase of Specialty Toolholders

WT300-SC300-SUPER NTX-SUPER NTXL - TW20M/MY/MM/MMY/MMYY 12 ST. - TW30M/MY/MMY/MMYY 16 ST.

DRIVEN

GEAR HOBBER DRIVEN TOOL

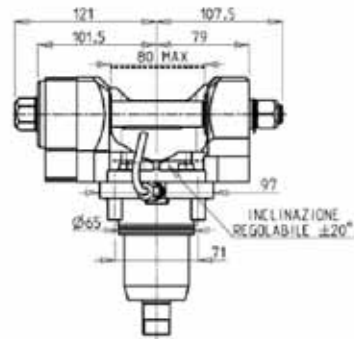
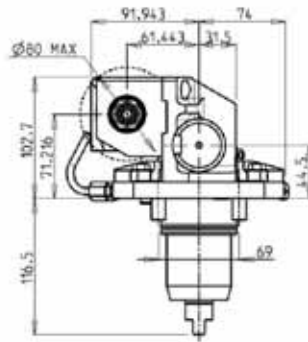

PartNumber	Description	Reversible	I	RPM	Ext Coolant	D mm	D Inch
NKM0311100	Gear Hobbing Tool 1:1	X	1:1	6000	X	16-22-27-32	3/4"-1"-1 1/4"
NKM0312100	Gear Hobbing Tool 2:1	X	2:1	3000	X	16-22-27-32	3/4"-1"-1 1/4"

Note : Wrenches are provided with the purchase of Specialty Toolholders

BROACHING/SLOTING DRIVEN TOOL

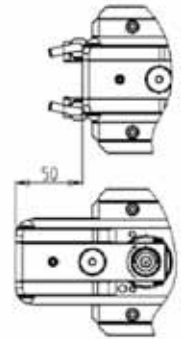
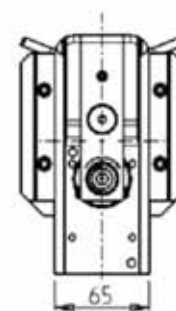
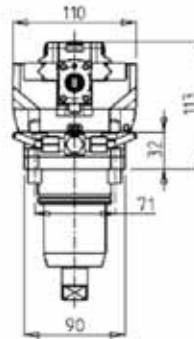
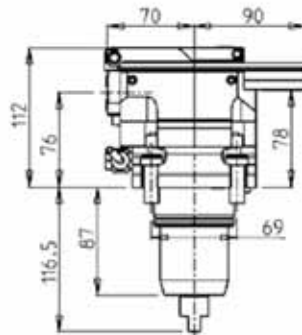

PartNumber	Description	Reversible	I	RPM	Ext. Coolant
NKM0930100	Broaching/Slotting Driven Tool	X	4:1	2000	X

SUPERMILL WT150/WT15011 / WY250/SC200L - SUPER NTY3 JUMBO

DRIVEN

RADIAL DRIVEN TOOL

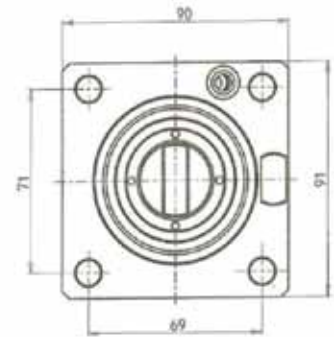
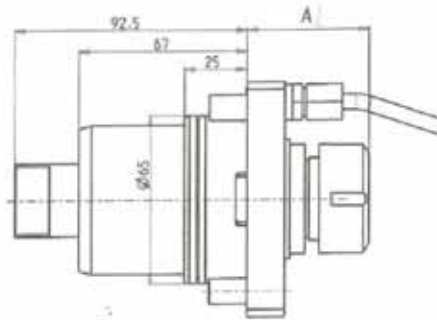
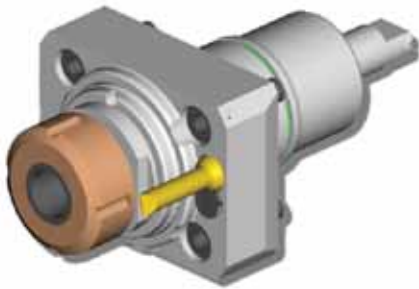

PartNumber	Description	Spindle	I	RPM	Coolant Thru	Ext Coolant	A	A1	B	D	L
NKM0280125	ER25 Standard	ER25	1:1	6000		X	48.66		15		
NKM0280132	ER32 Standard	ER32	1:1	6000		X	52.16		15		
NKM0280225	ERA25 Coolant Thru*	ERA25	1:1	6000	X	X	59.03		35		
NKM0280232	ERA32 Coolant Thru*	ERA32	1:1	6000	X	X	67.53		35		
NKM0280332	ER32 Standard Coolant Thru*	ER32	1:1	6000	X	X	71.66		35		
NKM0281919	Milling Head D=3/4", L=3/4"	3/4" x 3/4"	1:1	6000		X		25	15	3/4"	3/4"
NKM0282519	Milling Head D=1", L=19mm	1" x 19	1:1	6000		X		29	15	1"	19
NKM0281617	Milling Head D=16mm, L=17mm	16x17	1:1	6000		X		25	15	16	17
NKM0282219	Milling Head D=22mm, L=19mm	22x19	1:1	6000		X		27	15	22	19
NKM0282721	Milling Head D=27mm, L=21mm	27x21	1:1	6000		X		28	15	27	21

* Coolant Through tools are designed for 1000 psi.
They require 5 Micron Filtration and **CANNOT** be run dry.

RADIAL GEARED DOWN DRIVEN RE-DIRECTED IN Z BY 68mm TOOL

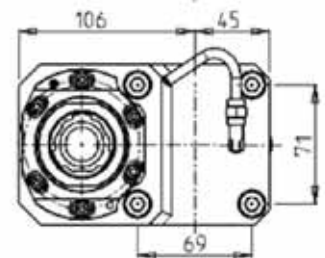
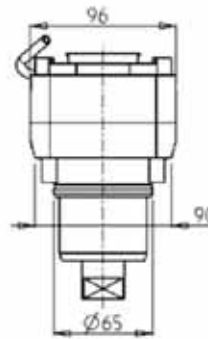
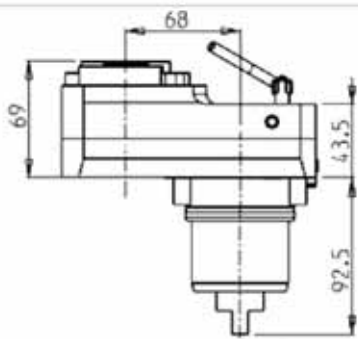

PartNumber	Description	Spindle	Reversible	I	Ext. Coolant
NKM0752132	Radial Geared Down 2:1 Driven Re-Directed in Z	ERA32	X	2:1	X

SUPERMILL WT150/WT15011 / WY250/SC200L - SUPER NTY3 JUMBO

DRIVEN

RADIAL GEARED UP RE-DIRECTED IN Z BY 68mm TOOL

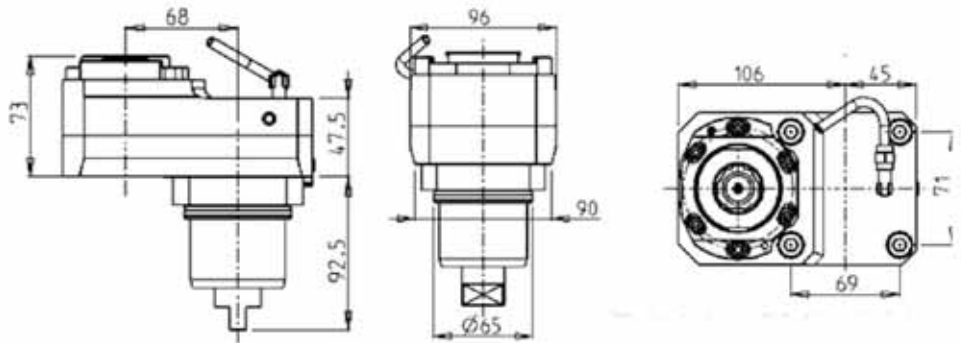

PartNumber	Description	Spindle	Reversible	I	RPM	Coolant Thru	Ext. Coolant
NKM0852132	Radial Geared Up Re-Directed in Z by 68mm	ERA25	X	1:2	12000		X
NKM0854225	Radial Geared Up Re-Directed in Z by 68mm, Coolant Thru*	ERA25	X	1:2	12000	X	X

AXIAL DRIVEN TOOL H=55

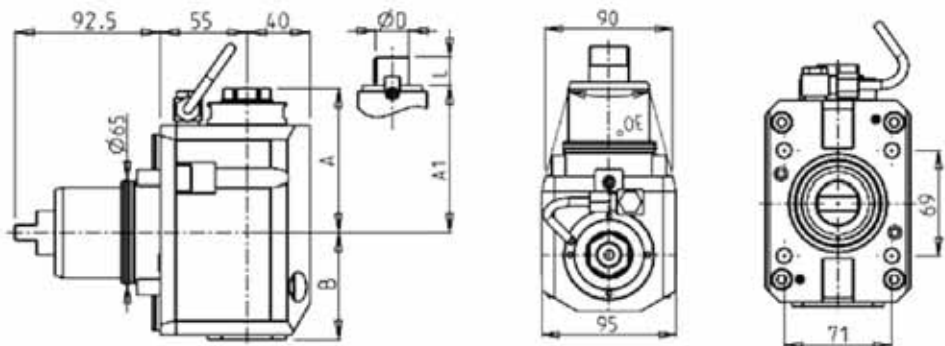

PartNumber	Description	Spindle	I	RPM	Coolant Thru	Ext Coolant	A	A1	B	D	L
NKM0290125	ERA25 Standard	ERA25	1:1	6000		X	91.03		68		
NKM0290132	ERA32 Standard	ERA32	1:1	6000		X	94.53		68		
NKM0290225	ERA25 Coolant Thru*	ERA25	1:1	6000	X	X	91.03		91.5		
NKM0290232	ERA32 Coolant Thru*	ERA32	1:1	6000	X	X	94.53		91.5		
NKM0292219	Axial Milling Head 22x19	22x19	1:1	6000		X		80	68	22	19

* Coolant Through tools are designed for 1000 psi. They require 5 Micron Filtration and **CANNOT** be run dry.

SUPERMILL WT150/WT15011 / WY250/SC200L - SUPER NTY3 JUMBO

DRIVEN

AXIAL DRIVEN TOOL H=65

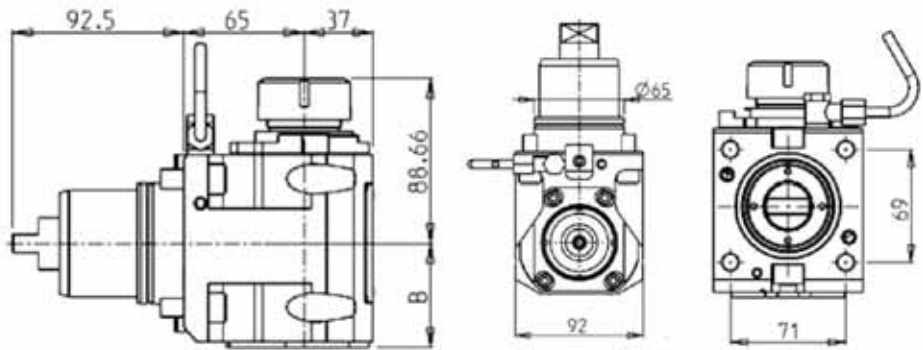

PartNumber	Description	Spindle	Reversible	I	RPM	Coolant Thru	Ext Coolant	B
NKM0740132	ER32 Standard H=65	ER32	X	1:1	6000		X	56
NKM0740232	ER32, H=65 Coolant Thru*	ER32	X	1:1	6000	X	X	67

* Coolant Through tools are designed for 1000 psi.
They require 5 Micron Filtration and **CANNOT** be run dry.

AXIAL GEARED-UP 1:2 DRIVEN TOOL

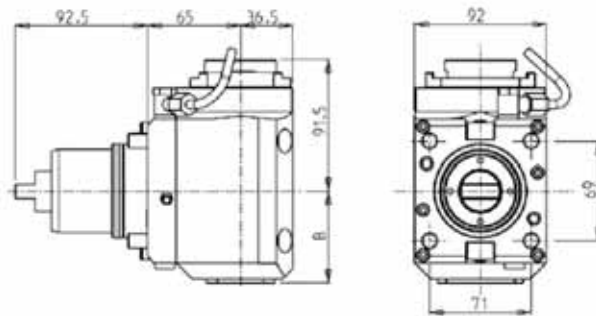

PartNumber	Description	Spindle	Reversible	I	RPM	Coolant Thru	Ext. Coolant	B
NKM0860325	ERA25 Axial Geared Up 1:2 Driven Tool	ERA25	X	1:2	12000		X	64
NKM0860425	ERA25 Axial Geared Up 1:2 Driven Coolant Thru*	ERA25	X	1:2	12000	X	X	64

SUPERMILL WT150/WT15011 / WY250/SC200L - SUPER NTY3 JUMBO

DRIVEN

OPPOSITE FACE AXIAL DRIVEN TOOL WITH 65mm INTERAXIS

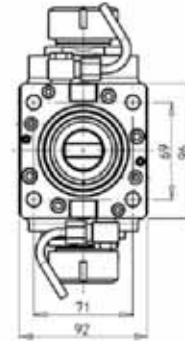
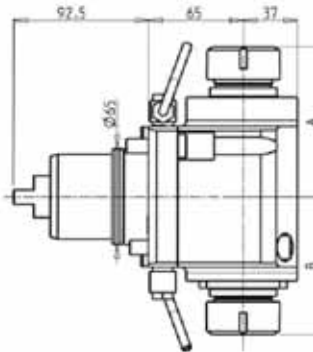

PartNumber	Description	Spindle	Reversible	I	RPM	Ext. Coolant	A	B
NKM0600232	Opposite Face Axial ER32+ER32, H=65mm	ER32+ER32	X	1:1	6000	X	102.66	94.26

0-180 ADJUSTABLE ANGLE DRIVEN TOOL

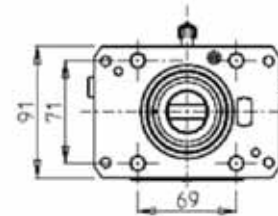
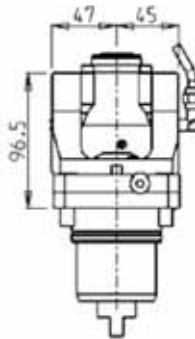
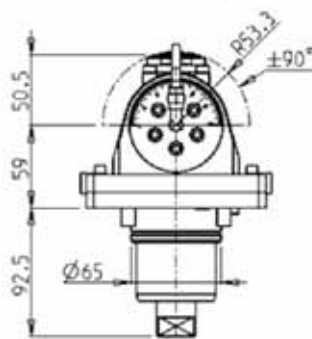

PartNumber	Description	Spindle	Reversible	I	RPM	Coolant Thru	Ext. Coolant
NKM0810120	Adj. Angle (0-180) ERA20	ERA20	X	1:1	6000		X
NKM0810220	Adj. Angle (0-180) ERA20 Coolant Thru*	ERA20	X	1:1	6000	X	X

* Coolant Thru tools are designed for 1000 psi.
They require 5 Micron Filtration and **CANNOT** be run dry.

Note :

Wrenches are provided with the purchase of Specialty Toolholders

SUPERMILL WT150/WT15011 / WY250/SC200L - SUPER NTY3 JUMBO

DRIVEN

0-180 ADJUSTABLE ANGLE DRIVEN TOOL GEARED UP

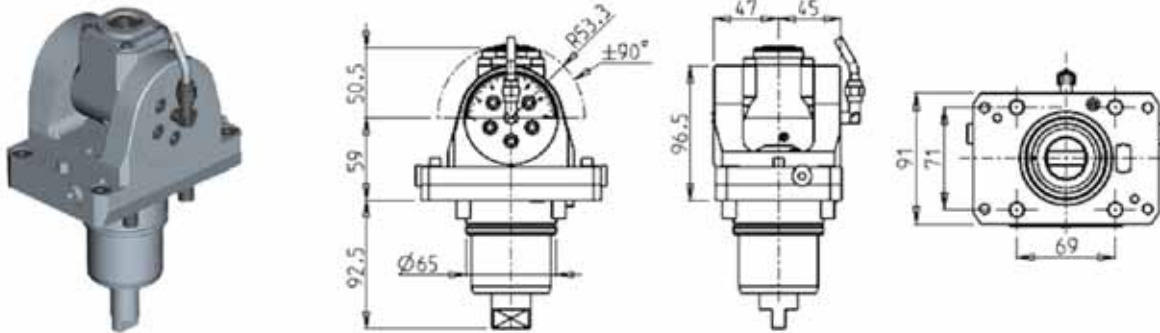

PartNumber	Description	Spindle	Reversible	I	RPM	Coolant Thru	Ext Coolant
NKM0810316	Adj. Angle (0-180) Geared-Up 1:2 ERA16	ERA16	X	1:2	12000		X
NKM0810416	Adj. Angle (0-180) Geared-Up 1:2 ERA16 Coolant Thru*	ERA16	X	1:2	12000	X	X

* Coolant Thru tools are designed for 1000 psi.
They require 5 Micron Filtration and **CANNOT** be run dry.

Note : Wrenches are provided with the purchase of Specialty Toolholders

GEAR HOBBER DRIVEN TOOL

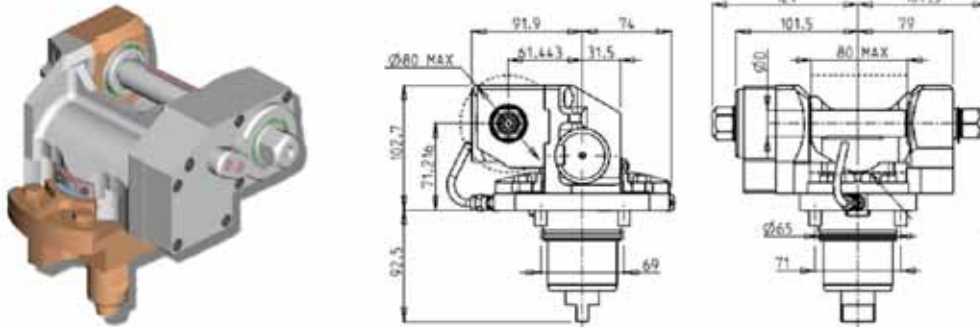

PartNumber	Description	I	Reversible	RPM	Ext Coolant	D mm	D Inch
NKM0331100	Gear Hobbing Tool 1:1	1:1	X	6000	X	16-22-27-32	3/4"-1"-1 1/4"
NKM0332100	Gear Hobbing Tool 2:1, Geared Down	2:1	X	3000	X	16-22-27-32	3/4"-1"-1 1/4"

Note : Wrenches are provided with the purchase of Specialty Toolholders

SUPERMILL WT150/WT15011 / WY250/SC200L - SUPER NTY3 JUMBO

DRIVEN

BROACHING/SLOTING DRIVEN TOOL

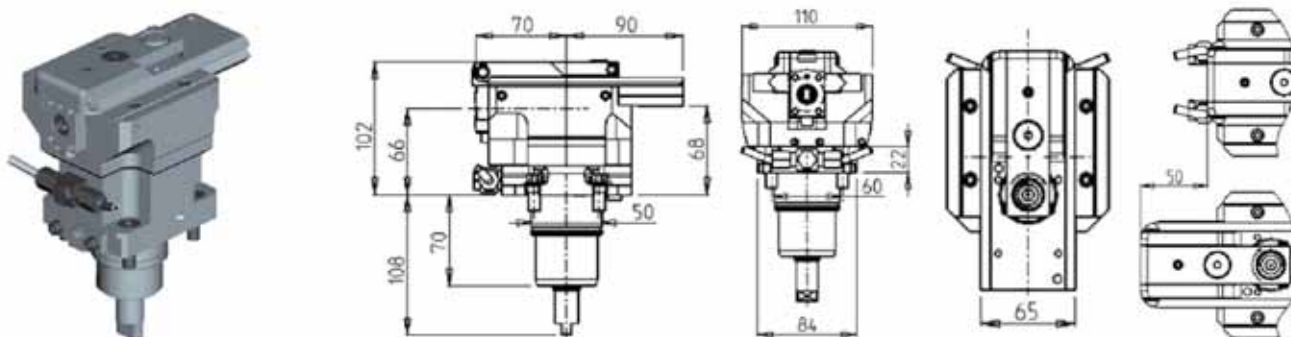

PartNumber	Description	Reversible	I	RPM	Ext. Coolant
NKM0940100	Broaching/Slotting Driven Tool	X	4:1	2000	X

DRIVEN TOOL HOLDER FOR SLIDING STEADY REST (SIZE 1)

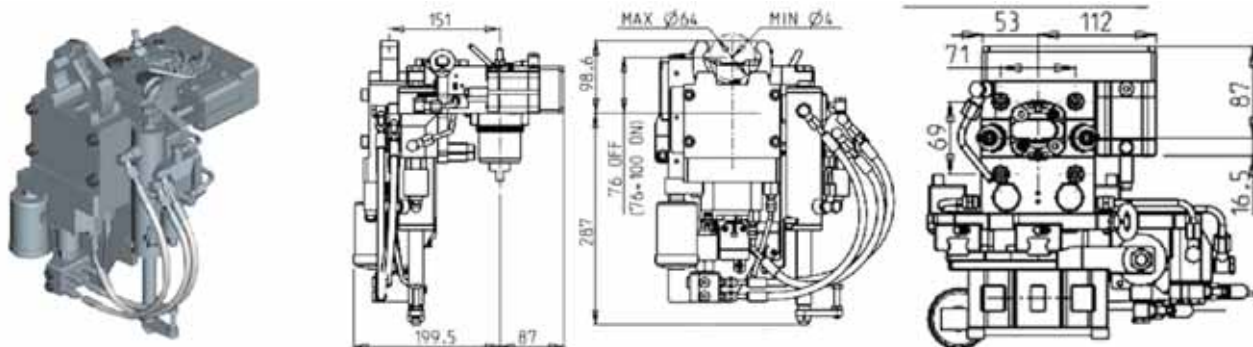

PartNumber	Description	I	RPM	Ext. Coolant	Electronics
NKM0820300	Driven Toolholder for Sliding Steady Rest (Size 1)	1:1	6000	X	
NKM0820300A	Driven Toolholder for Sliding Steady Rest (Size 1) with Electronics	1:1	6000	X	X