

DRIVEN TOOLING  
For  
**HWACHEON**

## CUTEX 160

### DRIVEN

#### RADIAL DRIVEN TOOL

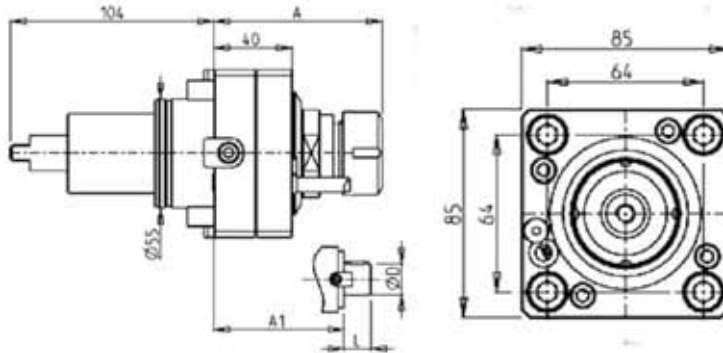

Part Number	Description	Spindle	I	RPM	Cool Thru	Ext. Cool	A	A1	D	L
0271325	Radial ER25	ER25	1:1	6000		X	86.06			
DWO 0900325	Radial ERA25	ERA25	1:1	6000		X	63.03			
DWO 0900425	Radial ERA25 Cool Thru*	ERA25	1:1	6000	X	X	63.03			

\* Coolant Thru tools are designed for 1000 psi.  
They require 5 Micron Filtration and **CANNOT** be run dry.

#### RADIAL DRIVEN TOOL

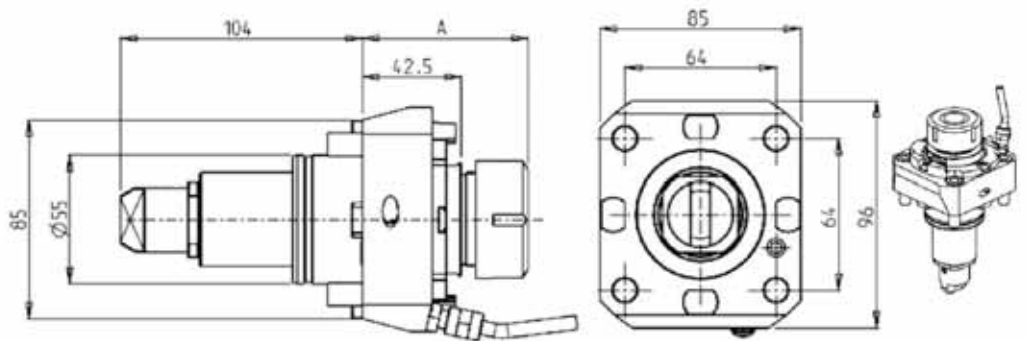

Part Number	Description	Spindle	I	RPM	Ext. Cool	A
DWO 0900132	Radial ER32	ER32	1:1	6000	X	71.16
DWO 0900332	Radial ERA32	ERA32	1:1	6000	X	54.5

## CUTEX 160

### DRIVEN

### RADIAL MTSK DRIVEN TOOL

See Accessories for MTSK Clamping Units

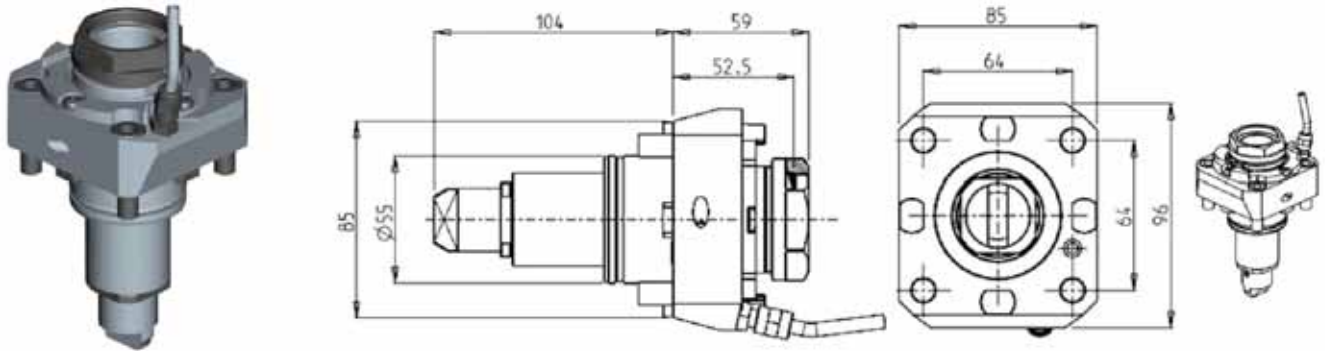

Part Number	Description	Spindle	I	RPM	Ext. Cool
DWO 0800140	Axial MTSK-40 H=70mm	MTSK-40	1:1	6000	X

### RADIAL RE-DIRECTED DRIVEN TOOL IN Z BY 36mm

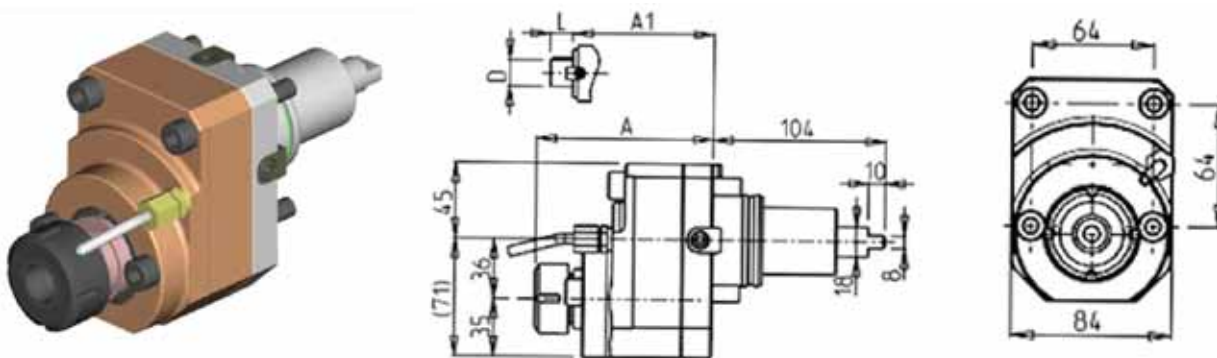

Part Number	Description	Spindle	Reversible	I	RPM	Ext. Cool	A	A1	D	L
0720025	Radial ER25 Redirected	ER25	X	1:1	6000	X	106.86			
0720032	Radial ER32 Redirected	ER32	X	1:1	6000	X	120.56			
0720016	Radial Mill Head D=16mm, L=17mm Redirected	16x17	X	1:1	6000	X		88.5	16	17
0720022	Radial Mill Head D=22mm, L=19mm Redirected	22x19	X	1:1	6000	X		90.5	22	19
0720027	Radial Mill Head D=27mm, L=21mm Redirected	27x21	X	1:1	6000	X		92.5	27	21



## CUTEX 160

### DRIVEN

#### RADIAL GEARED-UP I=1:2 DRIVEN TOOL RE-DIRECTED IN Z BY 36mm

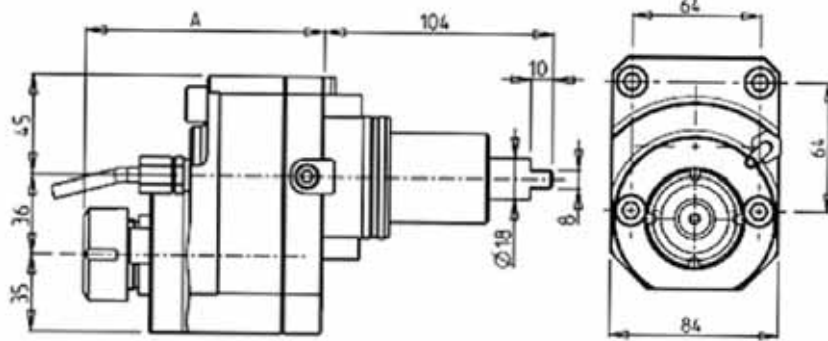

Part Number	Description	Spindle	Reversible	I	RPM	Ext. Cool	A
0721225	Radial Geared-Up 1:2 Redirected ER25	ER25	X	1:2	12000	X	108.56

#### RADIAL GEARED-UP DRIVEN TOOL I=1:5.625

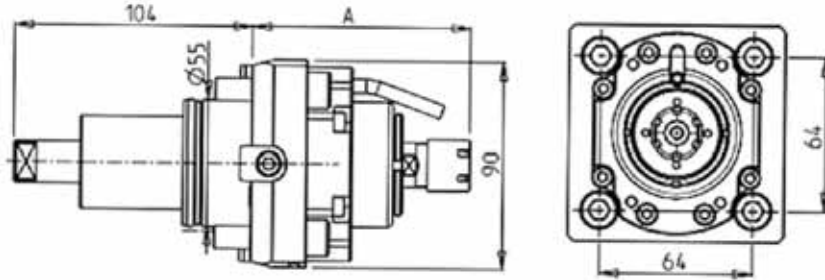

Part Number	Description	Spindle	I	RPM	Cool Thru	Ext. Cool	A
DWO 0600116	Radial Geared-Up 1:5.625 ER16	ER16	1:5.625	22500		X	95.25
DWO 0600111	Radial Geared-Up 1:5.625 ER11	ER11	1:5.625	22500	X	X	107.45

\* Coolant Thru tools are designed for 1000 psi.  
They require 5 Micron Filtration and **CANNOT** be run dry.

## CUTEX 160

### DRIVEN

#### AXIAL DRIVEN TOOL H=60mm

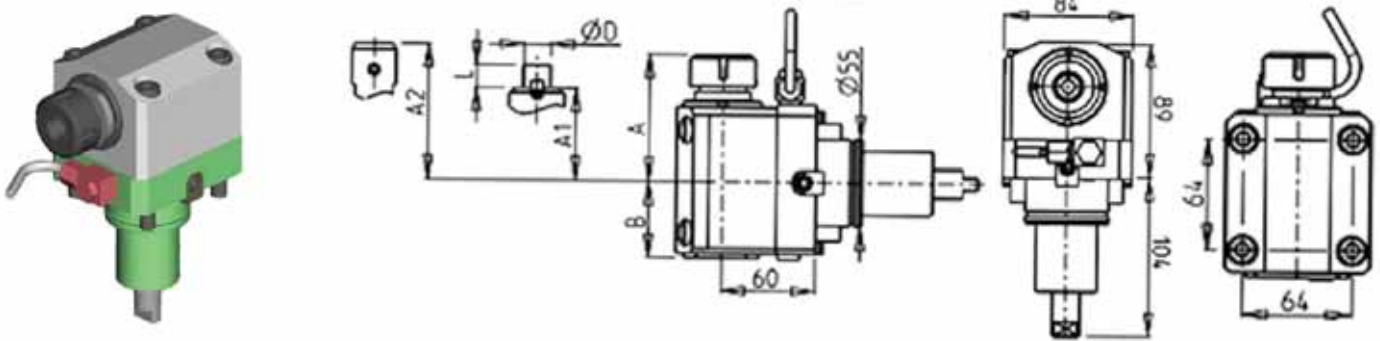

Part Number	Description	Spindle	Reversible	Cool Thru	Ext. Cool	A	A1	A2	B	D	L
DWO 0870125	Axial ER25 H=60mm	ER25	X		X	80.16			48		
DWO 0870225	Axial ER25 H=60mm Cool Thru*	ER25	X	X	X	80.66			71.5		
DWO 0870516	Axial Mill Head D=16mm, L=17mm H=60mm	16x17	X		X		61		48	16	17
DWO 0870522	Axial Mill Head D=22mm, L=19mm H=60mm	22x19	X		X		62		48	22	19
DWO 0870527	Axial Mill Head D=27mm, L=21mm H=60mm	27x21	X		X		64		48	27	21

\* Coolant Thru tools are designed for 1000 psi.  
They require 5 Micron Filtration and **CANNOT** be run dry.

#### AXIAL DRIVEN TOOL H=60mm

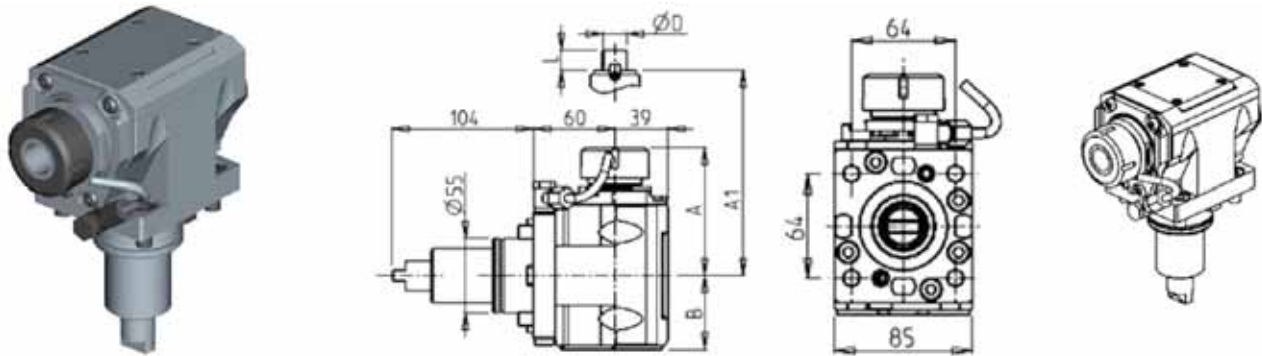

Part Number	Description	Spindle	Reversible	I	RPM	Cool Thru	Ext. Cool	A	A1	B	D	L
DWO 0870132	Axial ER32 H=60mm	ER32	X	1:1	6000		X	93.66		54.4		
DWO 0870232	Axial ER32 H=60mm Cool Thru*	ER32	X	1:1	6000	X	X	93.66		65.5		
DWO 0870140	Axial ER40 H=60mm	ER40	X	1:1	6000		X	98.16		54.4		
DWO 0870240	Axial ER40 H=60mm Cool Thru*	ER40	X	1:1	6000	X	X	98.16		65.5		

\* Coolant Thru tools are designed for 1000 psi.  
They require 5 Micron Filtration and **CANNOT** be run dry.

## CUTEX 160

### DRIVEN

#### AXIAL MTSK DRIVEN TOOL H=60mm

See Accessories for MTSK Clamping Units

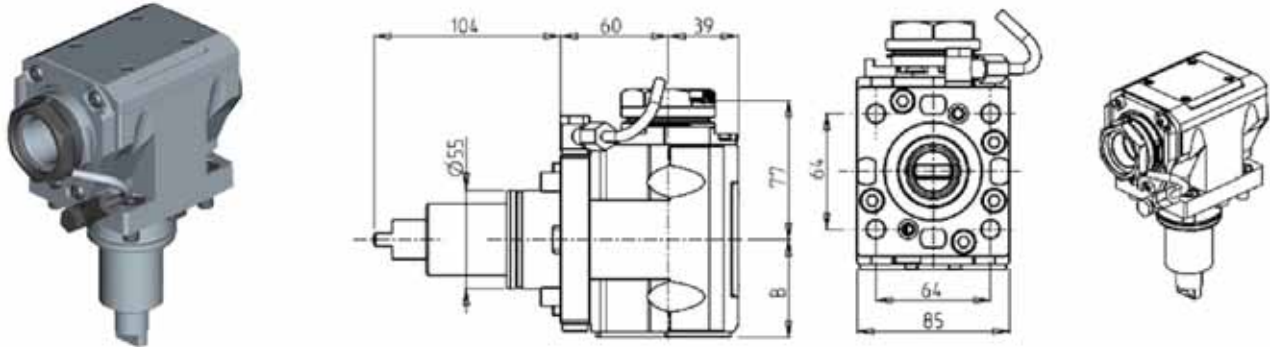

Part Number	Description	Spindle	Reversible	I	RPM	Cool Thru	Ext. Cool	B
DWO 0770140	Axial MTSK-40 H=60mm	MTSK-40	X	1:1	6000		X	54.5
DWO 0770240	Axial MTSK-40 H=60mm Cool Thru*	MTSK-40	X	1:1	6000	X	X	65.5

\* Coolant Thru tools are designed for 1000 psi.  
They require 5 Micron Filtration and **CANNOT** be run dry.

#### AXIAL DRIVEN TOOL H=70mm

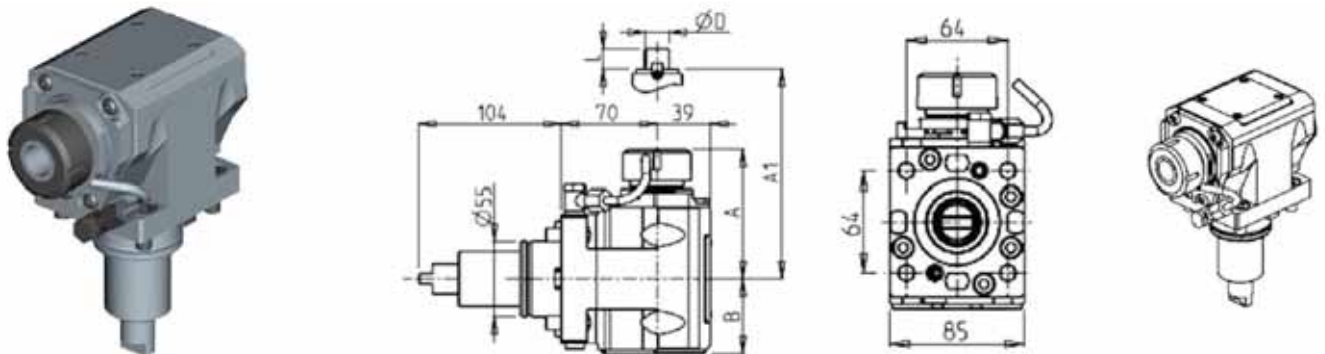

Part Number	Description	Spindle	Reversible	I	RPM	Cool Thru	Ext. Cool	A	A1	B	D	L
DWO 0880125	Axial ER25 H=70mm	ER25	X	1:1	6000		X	91.16		54.4		
DWO 0880225	Axial ER25 H=70mm Cool Thru*	ER25	X	1:1	6000	X	X	91.16		65.5		
DWO 0880132	Axial ER32 H=70mm	ER32	X	1:1	6000		X	93.66		54.4		
DWO 0880232	Axial ER32 H=70mm Cool Thru*	ER32	X	1:1	6000	X	X	93.66		65.5		
DWO 0880140	Axial ER40 H=70mm	ER40	X	1:1	6000		X	98.16		54.4		
DWO 0880240	Axial ER40 H=70mm Cool Thru*	ER40	X	1:1	6000	X	X	98.16		65.5		
DWO 0880516	Axial Mill Head D=16mm, L=17mm H=70mm	16x17	X	1:1	6000		X		67.5	54.4	16	17
DWO 0880522	Axial Mill Head D=22mm, L=19mm H=70mm	22x19	X	1:1	6000		X		67.5	54.4	22	19
DWO 0880527	Axial Mill Head D=27mm, L=21mm H=70mm	27x21	X	1:1	6000		X		70	54.4	27	21

\* Coolant Thru tools are designed for 1000 psi.  
They require 5 Micron Filtration and **CANNOT** be run dry.

## CUTEX 160

### DRIVEN

#### AXIAL MTSK DRIVEN TOOL H=70mm

See Accessories for MTSK Clamping Units

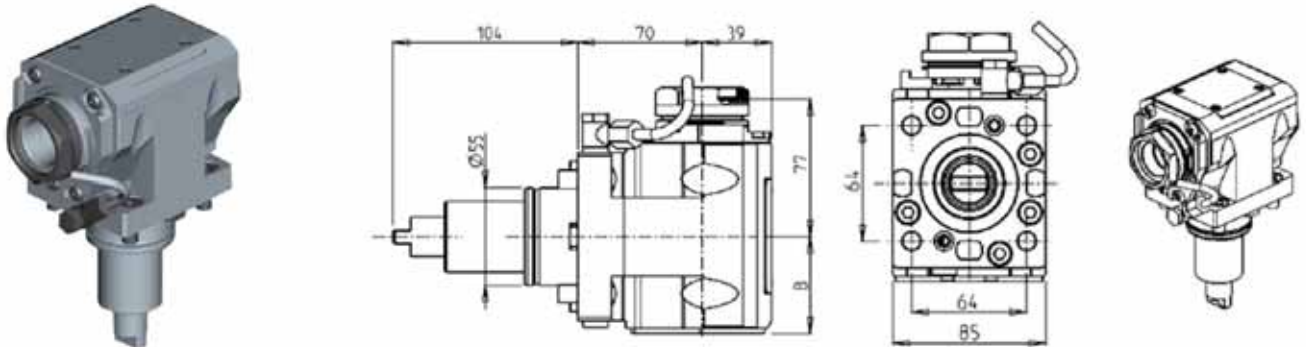

Part Number	Description	Spindle	Reversible	I	RPM	Cool Thru	Ext. Cool	B
DWO 0780140	Axial MTSK-40 H=70mm	MTSK-40	X	1:1	6000		X	54.5
DWO 0780240	Axial MTSK-40 H=70mm Cool Thru*	MTSK-40	X	1:1	6000	X	X	65.5

\* Coolant Thru tools are designed for 1000 psi.  
They require 5 Micron Filtration and **CANNOT** be run dry.

#### AXIAL DRIVEN TOOL H=85mm

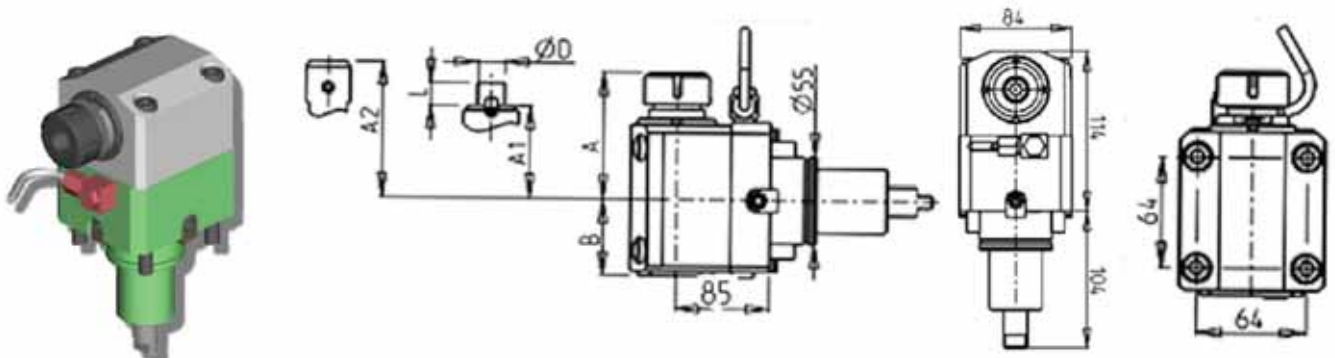

Part Number	Description	Spindle	Reversible	Cool Thru	Ext. Cool	A	A1	A2	B	D	L
DWO 0890125	Axial ER25 H=85mm	ER25	X		X	82.36			48		
DWO 0890225	Axial ER25 H=85mm Cool Thru*	ER25	X	X	X	81.76			71.5		
DWO 0890132	Axial ER32 H=85mm	ER32	X		X	98.16			48		
DWO 0890232	Axial ER32 H=85mm Cool Thru*	ER32	X	X	X	97.56			71.5		
DWO 0890516	Axial Mill Head D=16mm, L=17mm H=85mm	16x17	X		X		61		48	16	17
DWO 0890522	Axial Mill Head D=22mm, L=19mm H=85mm	22X19	X		X		62		48	22	19
DWO 0890527	Axial Mill Head D=27mm, L=21mm H=85mm	27X21	X		X		64		48	27	21

\* Coolant Thru tools are designed for 1000 psi.  
They require 5 Micron Filtration and **CANNOT** be run dry.

## CUTEX 160

### DRIVEN

#### AXIAL REAR-SET DRIVEN TOOL

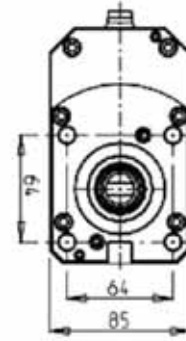
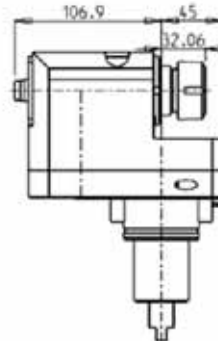
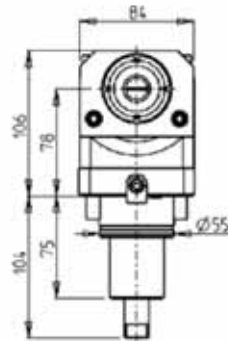

Part Number	Description	Spindle	Reversible	I	RPM	Ext. Cool
0630025	Axial ER25 Rear-Set H=78mm	ER25	X	1:1	6000	X

#### AXIAL GEARED-UP DRIVEN TOOL I=1:2

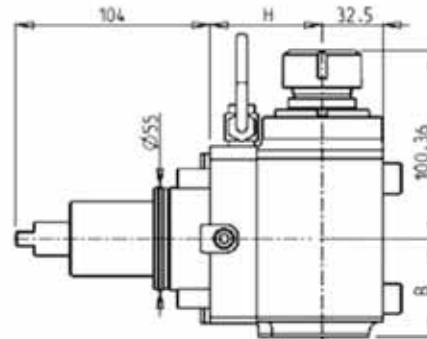

Part Number	Description	Spindle	Reversible	I	RPM	Cool Thru	Ext. Cool	H
0891225	Axial Geared-Up 1:2 ER25 H=60mm	ER25	X	1:2	12000		X	60
0891325	Axial Geared-Up 1:2 ER25 H=60mm Cool Thru*	ER25	X	1:2	12000	X	X	60
0893625	Axial Geared-Up 1:2 ER25 H=70mm	ER25	X	1:2	12000		X	70
0893725	Axial Geared-Up 1:2 ER25 H=70mm Cool Thru*	ER25	X	1:2	12000	X	X	70
0892425	Axial Geared-Up 1:2 ER25 H=85mm	ER25	X	1:2	12000		X	85
0892525	Axial Geared-Up 1:2 ER25 H=85mm Cool Thru*	ER25	X	1:2	12000	X	X	85

\* Coolant Thru tools are designed for 1000 psi.  
They require 5 Micron Filtration and **CANNOT** be run dry.

## CUTEX 160

### DRIVEN

#### AXIAL GEARED-UP DRIVEN TOOL I=1:5.625

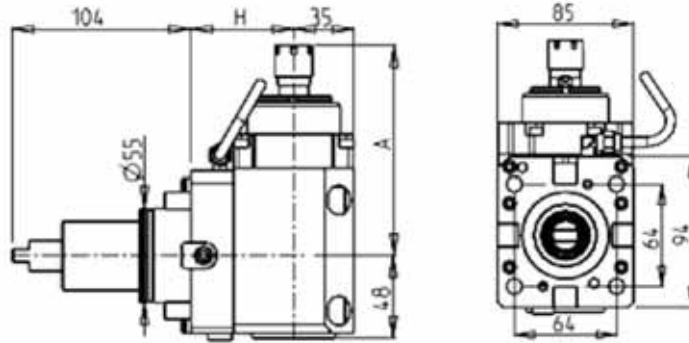

Part Number	Description	Spindle	Reversible	I	RPM	Cool Thru	Ext. Cool	A	H
DWO 0190116	Axial Geared-Up 1:5.625 ER16 H=60mm	ER16	X	1:5.625	22500		X	121.8	60
DWO 0190111	Axial Geared-Up 1:5.625 ER11 H=60mm Cool Thru*	ER11	X	1:5.625	22500	X		134	60
DWO 0190316	Axial Geared-Up 1:5.625 ER16 H=70mm	ER16	X	1:5.625	22500		X	121.8	70
DWO 0190311	Axial Geared-Up 1:5.625 ER11 H=70mm Cool Thru*	ER11	X	1:5.625	22500	X		134	70
DWO 0190216	Axial Geared-Up 1:5.625 ER16 H=85mm	ER16	X	1:5.625	22500		X	121.8	85
DWO 0190211	Axial Geared-Up 1:5.625 ER11 H=85mm Cool Thru*	ER11	X	1:5.625	22500	X		134	85

\* Coolant Thru tools are designed for 1000 psi.  
They require 5 Micron Filtration and **CANNOT** be run dry.

## CUTEX 160

### DRIVEN

### AXIAL DRIVEN TOOL FOR INTERNAL POLYGON MAKING

*See Accessories for Mill Heads*

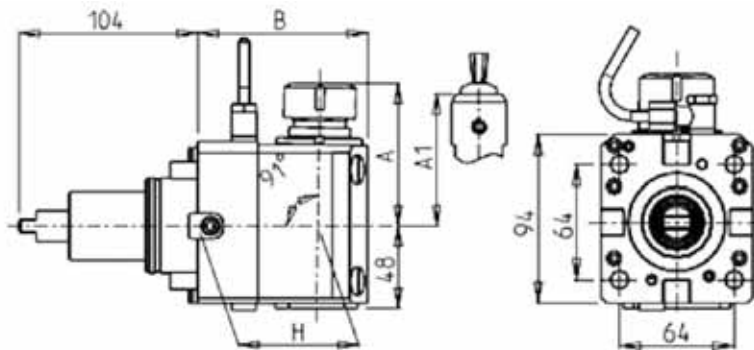

Part Number	Description	Spindle	Reversible	I	RPM	Ext. Cool	A	A1	B	H
0319125	Internal Polygon-Making ER25 H=60mm	ER25	X	1:1	6000	X	82.35		89	60
0319108	Internal Polygon-Making Weldon 8 H=60mm	Weldon 8	X	1:1	6000	X		76.5	89	60
0319110	Internal Polygon-Making Weldon 10 H=60mm	Weldon 10	X	1:1	6000	X		76.5	89	60
0319112	Internal Polygon-Making Weldon 12 H=60mm	Weldon 12	X	1:1	6000	X		76.5	89	60
0319116	Internal Polygon-Making Weldon 16 H=60mm	Weldon 16	X	1:1	6000	X		73.5	89	60
DWO 0249125	Internal Polygon-Making ER25 H=70mm	ER25	X	1:1	6000	X	82.35		99	70
DWO 0249108	Internal Polygon-Making Weldon 8 H=70mm	Weldon 8	X	1:1	6000	X		76.5	99	70
DWO 0249110	Internal Polygon-Making Weldon 10 H=70mm	Weldon 10	X	1:1	6000	X		76.5	99	70
DWO 0249112	Internal Polygon-Making Weldon 12 H=70mm	Weldon 12	X	1:1	6000	X		76.5	99	70
DWO 0249116	Internal Polygon-Making Weldon 16 H=70mm	Weldon 16	X	1:1	6000	X		76.5	99	70
DWO 0029125	Internal Polygon-Making ER25 H=85mm	ER25	X	1:1	6000	X	82.35		114	85
DWO 0029108	Internal Polygon-Making Weldon 8 H=85mm	Weldon 8	X	1:1	6000	X		76.5	114	85
DWO 0029110	Internal Polygon-Making Weldon 10 H=85mm	Weldon 10	X	1:1	6000	X		76.5	114	85
DWO 0029112	Internal Polygon-Making Weldon 12 H=85mm	Weldon 12	X	1:1	6000	X		76.5	114	85
DWO 0029116	Internal Polygon-Making Weldon 16 H=85mm	Weldon 16	X	1:1	6000	X		73.5	114	85

## CUTEX 160

### DRIVEN

#### AXIAL OPPOSITE FACE DRIVEN TOOL

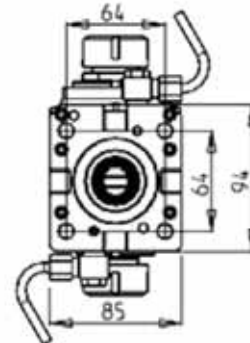
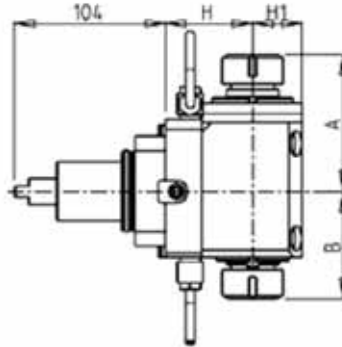

Part Number	Description	Spindle	Reversible	I	RPM	Ext. Cool	A	B	H	H1
DWO 0080132	Axial Double Outlet ER32/ER32 H=60mm	ER32+ER32	X	1:1	6000	X	100.56	78.96	60	34
DWO 0080332	Axial Double Outlet ER32/ER32 H=70mm	ER32+ER32	X	1:1	6000	X	100.56	78.96	70	34
DWO 0080232	Axial Double Outlet ER32/ER32 H=85mm	ER32+ER32	X	1:1	6000	X	100.56	78.96	85	34
DWO 0080325	Axial Double Outlet ER25/ER25 H=70mm	ER25+ER25	X	1:1	6000	X	93.36	73.46	70	34
DWO 0080225	Axial Double Outlet ER25/ER25 H=85mm	ER25+ER25	X	1:1	6000	X	93.36	73.46	85	34
0311625	Axial Double Outlet ER25/ER16 H=60mm	ER25+ER16	X	1:1	6000	X	81.86	66	60	29
DWO 0242516	Axial Double Outlet ER25/ER16 H=70mm	ER25+ER16	X	1:1	6000	X	81.86	66	70	29
DWO 0022516	Axial Double Outlet ER25/ER16 H=85mm	ER25+ER16	X	1:1	6000	X	81.86	66	85	29
0311616	Axial Double Outlet ER16/ER16 H=60mm	ER16+ER16	X	1:1	6000	X	81.2	66	60	29
DWO 0241616	Axial Double Outlet ER16/ER16 H=70mm	ER16+ER16	X	1:1	6000	X	81.2	66	70	29
DWO 0021616	Axial Double Outlet ER16/ER16 H=85mm	ER16+ER16	X	1:1	6000	X	81.2	66	85	29

#### AXIAL OPPOSITE FACE DRIVEN TOOL REAR SET

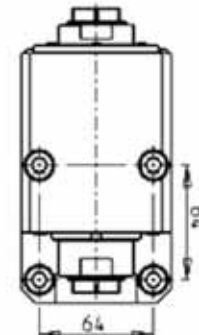
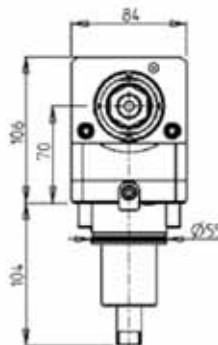
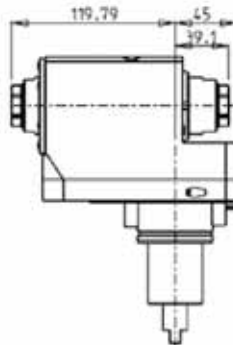
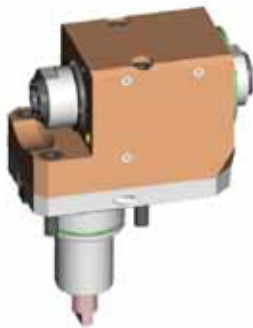

Part Number	Description	Spindle	Reversible	I	RPM	Ext. Cool
0632525	Axial Off-Set Double Outlet ER25A/ER25A H=70mm	ER25A+ER25A	X	1:1	6000	X

## CUTEX 160

### DRIVEN

#### 0-90 ADJUSTABLE ANGLE DRIVEN TOOL

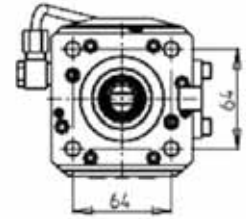
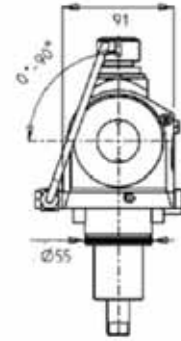
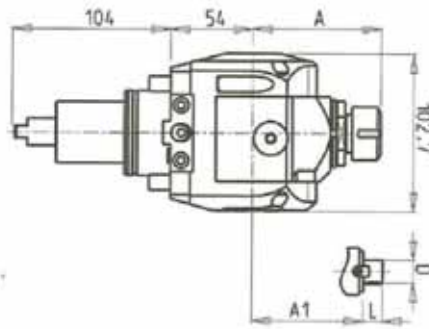

Part Number	Description	Spindle	Reversible	I	RPM	Ext. Cool	A	A1	D	L
0360020	0-90 Adj.Angle ER20 Driven Tool	ER20	X	1:1	6000	X	84.16			
0360025	0-90 Adj.Angle ER25 Driven Tool	ER25	X	1:1	6000	X	85.66			
0361905	0-90 Adj.Angle Mill head D=3/4" L=3/4" Driven Tool	3/4"x3/4"	X	1:1	6000	X		65	3/4"	3/4"
0361617	0-90 Adj.Angle Mill head D=16mm L=17mm	16x17	X	1:1	6000	X		65	16	17
0362219	0-90 Adj.Angle Mill head D=22mm L=19mm Driven Tool	22x19	X	1:1	6000	X		66	22	19

**Note :** Wrenches are provided with the purchase of Specialty Toolholders

#### 0-180 ADJUSTABLE ANGLE DRIVEN TOOL H=47.5mm

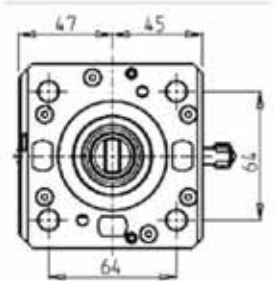
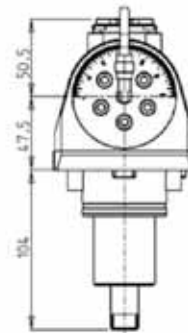
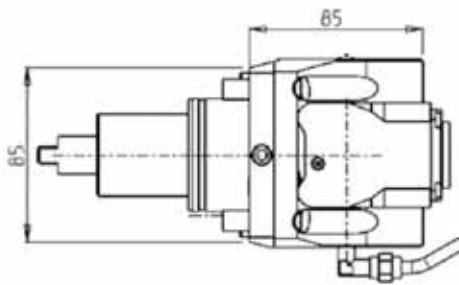

Part Number	Description	Spindle	Reversible	I	RPM	Cool Thru	Ext. Cool
DWO 0660120	0-180 Adj.Angle ERA20 H=47.5mm	ERA20	X	1:1	6000		X
DWO 0660220	0-180 Adj.Angle ER20A H=47.5mm Cool Thru*	ERA20	X	1:1	6000	X	X

**Note :** Wrenches are provided with the purchase of Specialty Toolholders

## CUTEX 160

### DRIVEN

#### 0-180 ADJUSTABLE ANGLE DRIVEN TOOL H=83mm

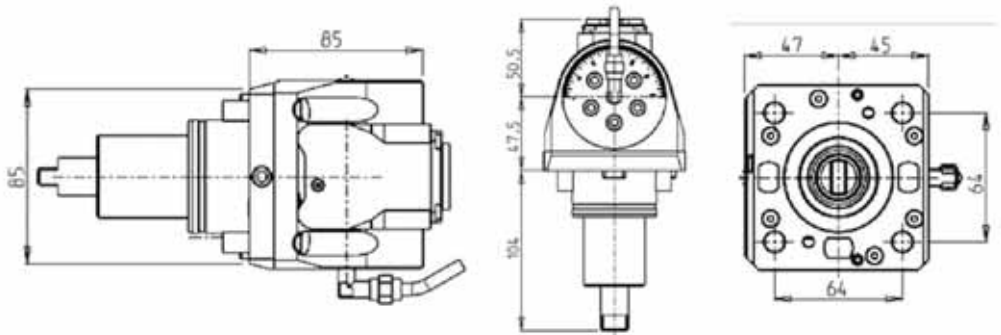

Part Number	Description	Spindle	RPM	Cool Thru	Ext. Cool
DWO 0661120	0-180 Adj.Angle ERA20 H=83mm	ERA20	6000		X
DWO 0661220	0-180 Adj.Angle ERA20 H=83mm Cool Thru*	ERA20	6000	X	X

\* Coolant Thru tools are designed for 1000 psi.  
They require 5 Micron Filtration and **CANNOT** be run dry.

#### 0-180 ADJUSTABLE ANGLE GEARED-UP DRIVEN TOOL H=47.5mm

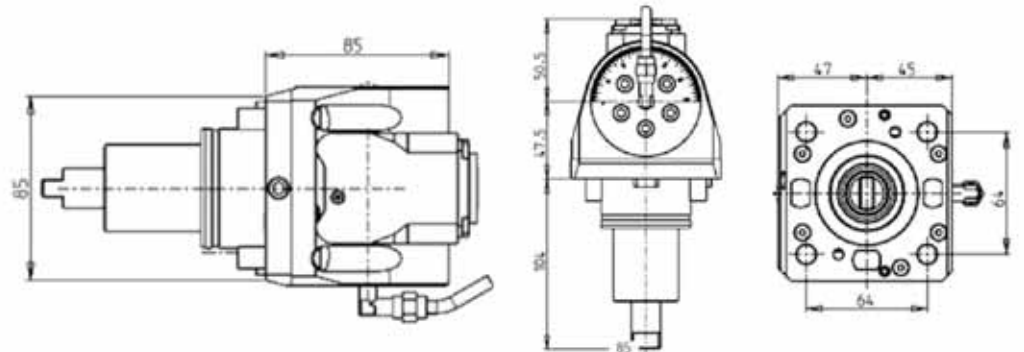

Part Number	Description	Spindle	I	RPM	Cool Thru	Ext. Cool
DWO 0660316	0-180 Adj.Angle ERA16 Geared-Up H=47.5mm	ERA16	1:2	12000		X
DWO 0660416	0-180 Adj.Angle ERA16 Geared-Up H=47.5mm, Cool Thru*	ERA16	1:2	12000	X	X

\* Coolant Thru tools are designed for 1000 psi.  
They require 5 Micron Filtration and **CANNOT** be run dry.

**Note :**

Wrenches are provided with the purchase of Specialty Toolholders

## CUTEX 160

### DRIVEN

#### 0-180 ADJUSTABLE ANGLE GEARED-UP DRIVEN TOOL H=83mm

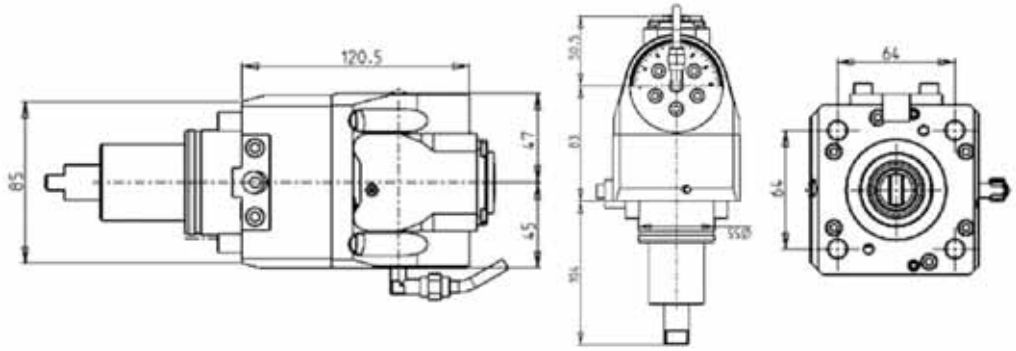

Part Number	Description	Spindle	I	RPM	Ext. Cool
DWO 0661316	0-180 Adj.Angle ERA16 Geared-Up H=83mm	ERA16	1:2	12000	X
DWO 0661416	0-180 Adj.Angle ERA16 Geared-Up H=83mm, Cool Thru*	ERA16	1:2	12000	X

\* Coolant Thru tools are designed for 1000 psi.  
They require 5 Micron Filtration and **CANNOT** be run dry.

**Note :**

Wrenches are provided with the purchase of Specialty Toolholders

## GEAR HOBBER

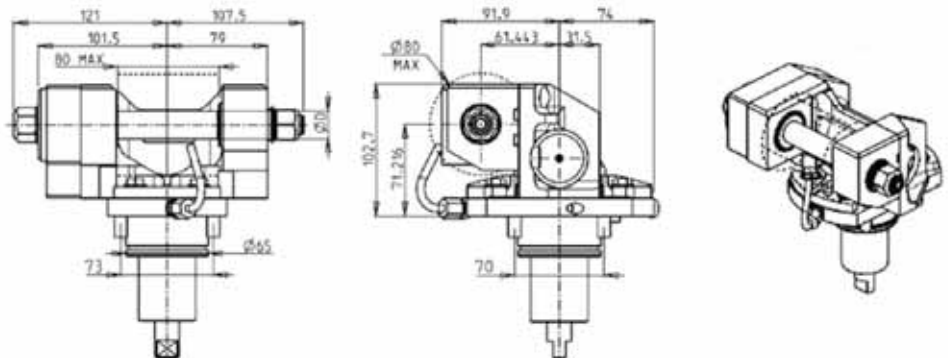

Part Number	Description	I	RPM	Ext. Cool	D mm	D Inch
0621100	Gear Hobber 1:1	1:1	6000	X	16-22-27-32	3/4"-1"-1 1/4"
0622100	Gear Hobber Geared-Down 2:1	2:1	3000	X	16-22-27-32	3/4"-1"-1 1/4"

**Note :**

Wrenches are provided with the purchase of Specialty Toolholders

## CUTEX 160

### DRIVEN

#### GEAR HOBBER - RADIAL DRIVEN

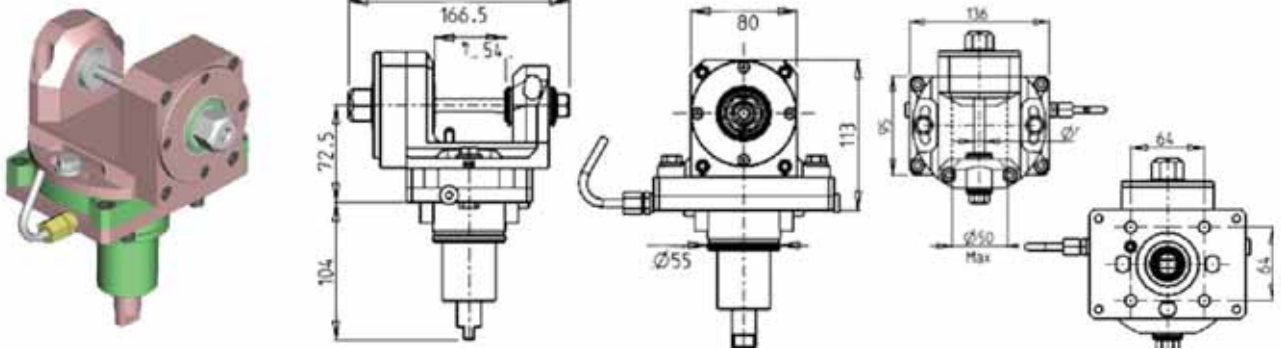

Part Number	Description	I	RPM	Ext. Cool	D mm
DWO 0051108	Radial Gear Hobber 1:1 D=8mm	1:1	6000	X	8
DWO 0051110	Radial Gear Hobber 1:1 D=10mm	1:1	6000	X	10
DWO 0051113	Radial Gear Hobber 1:1 D=13mm	1:1	6000	X	13
DWO 0051116	Radial Gear Hobber 1:1 D=16mm	1:1	6000	X	16

**Note :** Wrenches are provided with the purchase of Specialty Toolholders

#### BROACHING / SLOTTING DRIVEN TOOL

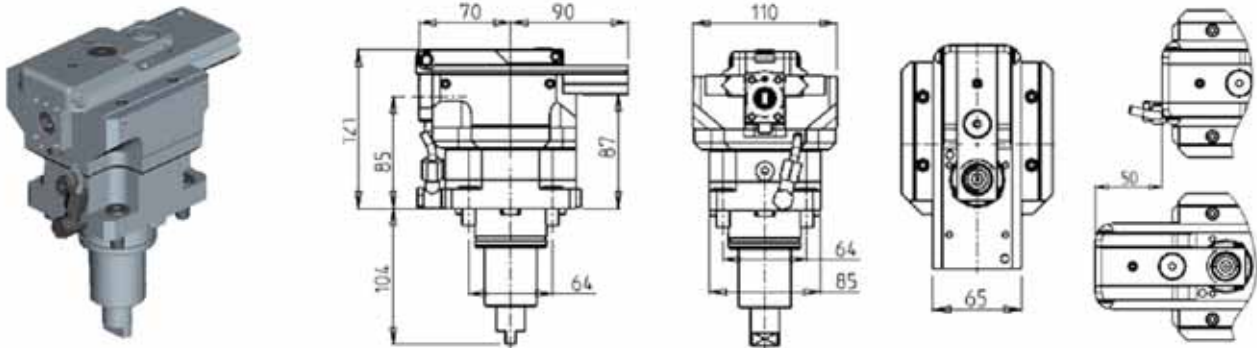

Part Number	Description	Reversible	I	Ext. Cool
DWO 1030100	Broaching / Slotting Driven Tool	X	4:1	X

## HI-TECH 200 - HI-TECH 300/400 - HI-TECH 450 - VT450 - T2 - CUTEX 240

### DRIVEN

#### RADIAL REINFORCED DRIVEN TOOL

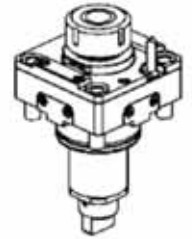
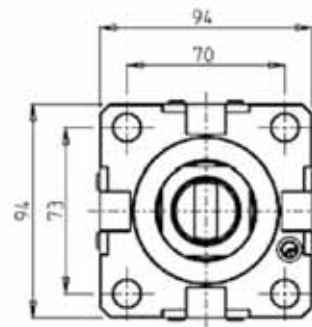
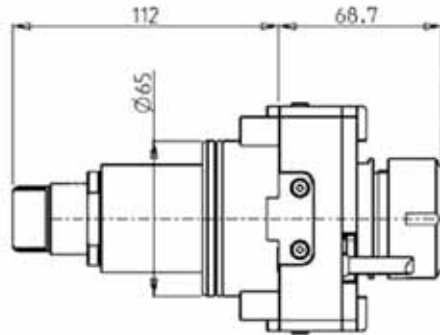

Part Number	Description	Spindle	I	RPM	Ext. Cool
DWO 0910132	Radial Reinforced ER32	ER32	1:1	6000	X

#### RADIAL MTSK REINFORCED DRIVEN TOOL

*See Accessories for MTSK Clamping Units*

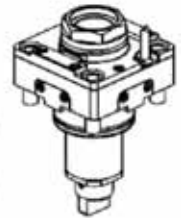
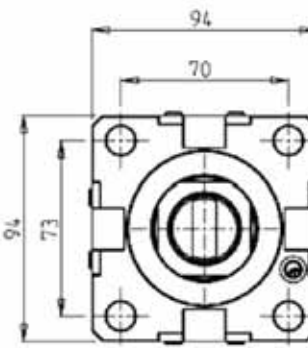
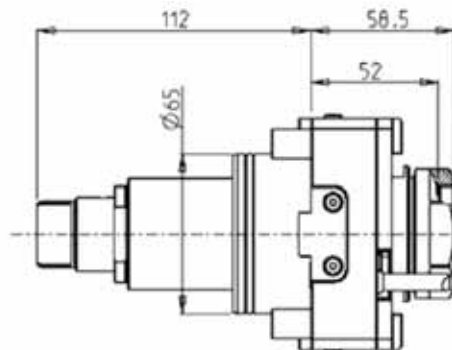

Part Number	Description	Spindle	I	RPM	Ext. Cool
DWO 0860140	Radial MTSK-40 Reinforced	MTSK-40	1:1	6000	X
DWO 0860150	Radial MTSK-50 Reinforced	MTSK-50	1:1	6000	X

#### RADIAL GEARD-UP I=1:2 DRIVEN TOOL RE-DIRECTED IN Z BY 36mm

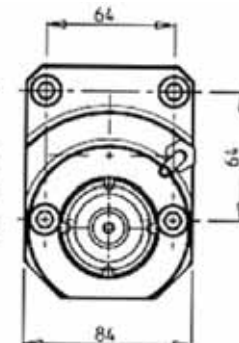
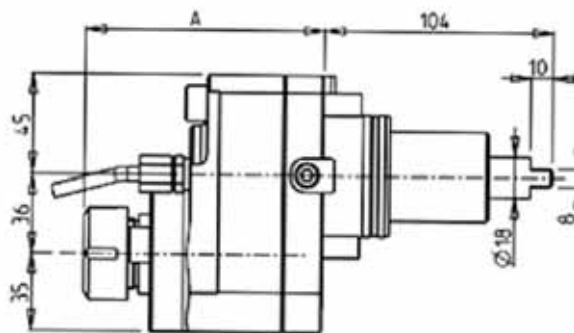
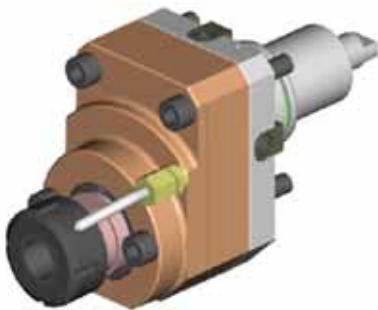

Part Number	Description	Spindle	Reversible	I	RPM	Ext. Cool	A
DWO 0140125	Radial Geared-Up 1:2 Redirected 36mm ER25	ER25	X	1:2	12000	X	108.56

## HI-TECH 200 - HI-TECH 300/400 - HI-TECH 450 - VT450 - T2 - CUTEX 240

### DRIVEN

#### RADIAL SINGLE-SIDE TWIN HEAD DRIVEN TOOL IN Y-AXIS

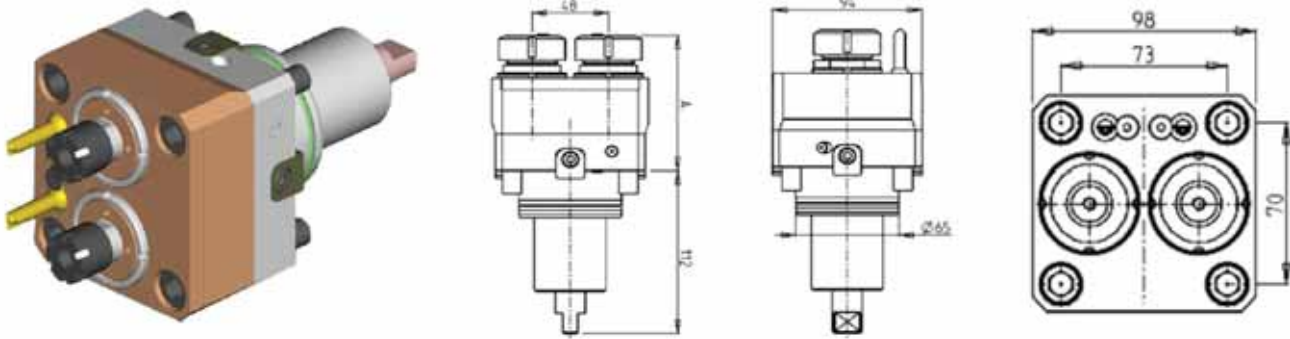

Part Number	Description	Spindle	I	RPM	Ext. Cool	A
DWO 0540216	Radial Y-Axis Double Outlet ER16	ER16	1:1	6000	X	84.5
DWO 0540225	Radial Y-Axis Double Outlet ER25	ER25	1:1	6000	X	85

#### RADIAL INVERTED DRIVEN TOOL 250mm INTERAXIS

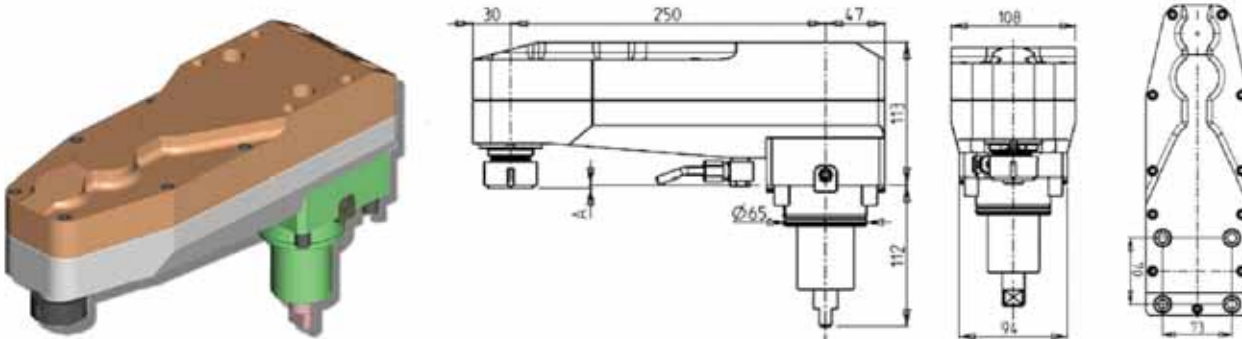

Part Number	Description	Spindle	Reversible	I	RPM	Ext. Cool
0700025	Radial Inverted 250mm Interaxis ER25	ER25	X	1:2	12000	X
0700032	Radial Inverted 250mm Interaxis ER32	ER32	X	1:2	12000	X

## HI-TECH 200 - HI-TECH 300/400 - HI-TECH 450 - VT450 - T2 - CUTEX 240

### DRIVEN

#### AXIAL DRIVEN TOOL H=72mm

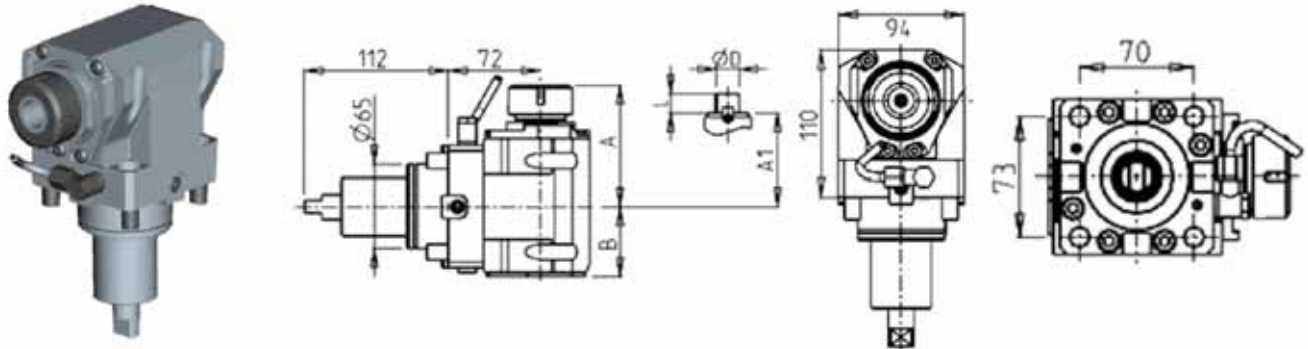

Part Number	Description	Spindle	Reversible	RPM	Cool Thru	Ext. Cool	A	A1	B	D	L
DWO 0700125	Axial ER25 H=72mm	ER25	X	6000		X	91.16		54		
DWO 0700225	Axial ER25 H=72mm Cool Thru*	ER25	X	6000	X	X	91.16		65		
DWO 0700132	Axial ER32 H=72mm	ER32	X	6000		X	93.66		54		
DWO 0700232	Axial ER32 H=72mm Cool Thru*	ER32	X	6000	X	X	98.16		79		
DWO 0700140	Axial ER40 H=72mm	ER40	X	6000		X	98.16		54		
DWO 0700240	Axial ER40 H=72mm Cool Thru*	ER40	X	6000	X	X	98.16		54		
DWO 0700516	Axial Mill Head D=16mm, L=17mm	16x17	X	6000		X		61	47	16	17
DWO 0700522	Axial Mill Head D=22mm, L=19mm	22x19	X	6000		X		67.5	54	22	19
DWO 0700527	Axial Mill Head D=27mm, L=21mm	27x21	X	6000		X		70	54	27	21

\* Coolant Thru tools are designed for 1000 psi.  
They require 5 Micron Filtration and **CANNOT** be run dry.

#### AXIAL MTSK DRIVEN TOOL H=72mm

See Accessories for MTSK Clamping Units

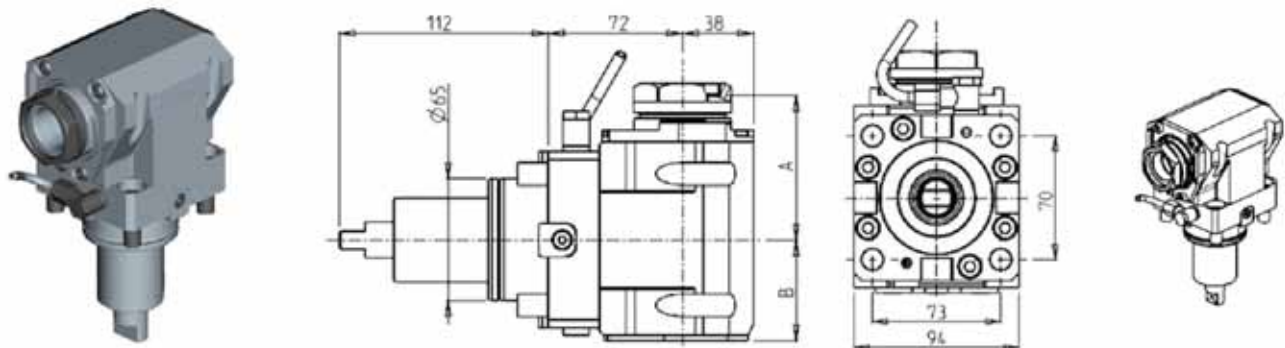

Part Number	Description	Spindle	Reversible	RPM	Cool Thru	Ext. Cool	A	B
DWO 1170140	Axial MTSK-40 H=72mm	MTSK-40	X	6000		X	77	54
DWO 1170240	Axial MTSK-40 H=72mm Cool Thru*	MTSK-40	X	6000	X	X	77	65
DWO 1170150	Axial MTSK-50 H=72mm	MTSK-50	X	6000		X	79	54
DWO 1170250	Axial MTSK-50 H=72mm Cool Thru*	MTSK-50	X	6000	X	X	79	65

\* Coolant Thru tools are designed for 1000 psi.  
They require 5 Micron Filtration and **CANNOT** be run dry.

## HI-TECH 200 - HI-TECH 300/400 - HI-TECH 450 - VT450 - T2 - CUTEX 240

### DRIVEN

#### AXIAL DRIVEN TOOL H=85mm

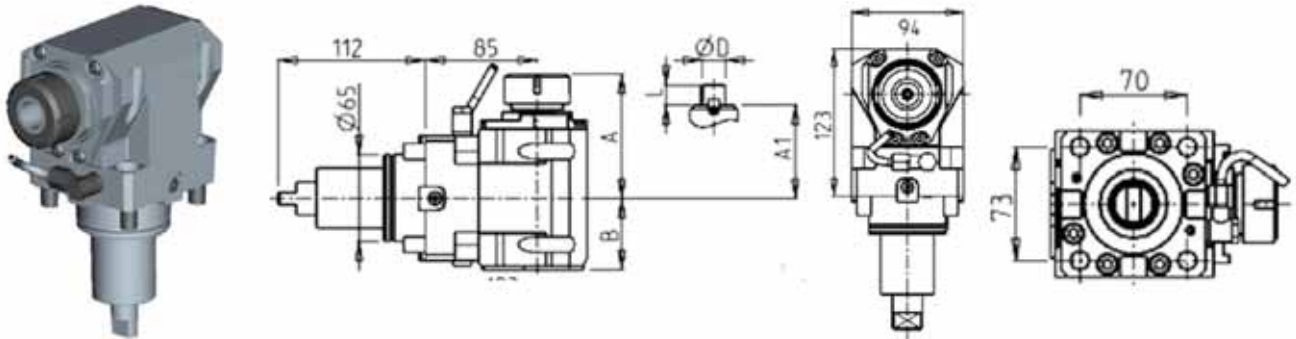

Part Number	Description	Spindle	Reversible	I	RPM	Cool Thru	Ext. Cool	A	A1	B	D	L
DWO 1130125	Axial ER25 H=85mm	ER25	X	1:1	6000		X	91.16		54		
DWO 1130225	Axial ER25 H=85mm Cool Thru*	ER25	X	1:1	6000	X	X	91.16		65		
DWO 1130132	Axial ER32 H=85mm	ER32	X	1:1	6000		X	91.16		65		
DWO 1130232	Axial ER32 H=85mm Cool Thru*	ER32	X	1:1	6000	X	X	93.66		65		
DWO 1130140	Axial ER40 H=85mm	ER40	X	1:1	6000		X	98.16		54		
DWO 1130240	Axial ER40 H=85mm Cool Thru*	ER40	X	1:1	6000	X	X	98.16		65		
DWO 1130516	Axial Mill Head D=16mm, L=17mm	16x17	X	1:1	6000		X		67.5	54	16	17
DWO 1130522	Axial Mill Head D=22mm, L=19mm	22x19	X	1:1	6000		X		67.5	54	22	19
DWO 1130527	Axial Mill Head D=27mm, L=21mm	27x21	X	1:1	6000		X		70	54	27	21

\* Coolant Thru tools are designed for 1000 psi.  
They require 5 Micron Filtration and **CANNOT** be run dry.

#### AXIAL MTSK DRIVEN TOOL H=85mm

See Accessories for MTSK Clamping Units

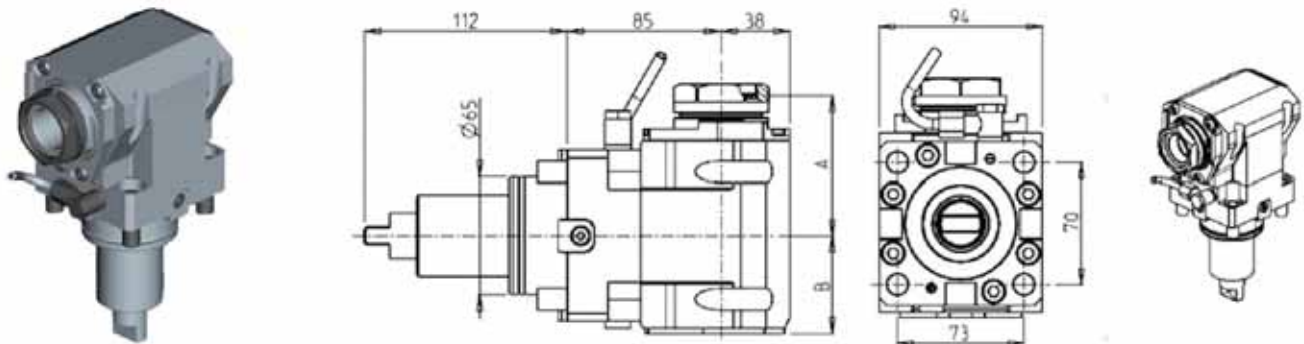

Part Number	Description	Spindle	Reversible	RPM	Cool Thru	Ext. Cool	A	B
DWO 1180140	Axial MTSK-40 H=85mm	MTSK-40	X	6000		X	77	54
DWO 1180240	Axial MTSK-40 H=85mm Cool Thru*	MTSK-40	X	6000	X	X	77	65
DWO 1180150	Axial MTSK-50 H=85mm	MTSK-50	X	6000		X	79	54
DWO 1180250	Axial MTSK-50 H=85mm Cool Thru*	MTSK-50	X	6000	X	X	79	65

\* Coolant Thru tools are designed for 1000 psi.  
They require 5 Micron Filtration and **CANNOT** be run dry.

## HI-TECH 200 - HI-TECH 300/400 - HI-TECH 450 - VT450 - T2 - CUTEX 240

### DRIVEN

#### AXIAL DRIVEN TOOL H=100mm

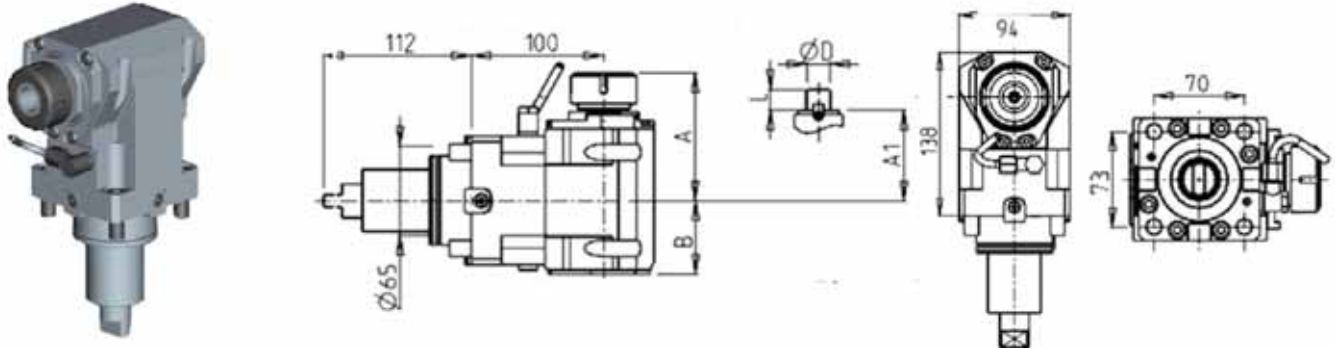

Part Number	Description	Spindle	Reversible	I	RPM	Cool Thru	Ext. Cool	A	A1	B	D	L
DWO 1140125	Axial ER25 H=100mm	ER25	X	1:1	6000		X	91.16		54		
DWO 1140225	Axial ER25 H=100mm, Cool Thru*	ER25	X	1:1	6000	X	X	91.16		65		
DWO 1140132	Axial ER32 H=100mm	ER32	X	1:1	6000		X	93.66		54		
DWO 1140232	Axial ER32 H=100mm, Cool Thru*	ER32	X	1:1	6000	X	X	93.66		65		
DWO 1140140	Axial ER40 H=100mm,	ER40	X	1:1	6000		X	98.16		54		
DWO 1140240	Axial ER40 H=100mm, Cool Thru*	ER40	X	1:1	6000	X	X	98.16		65		
DWO 1140516	Axial Mill Head D=16mm, L=17mm H=100mm	16x17	X	1:1	6000		X		67.5	54	16	17
DWO 1140522	Axial Mill Head D=22mm, L=19mm H=100mm	22x19	X	1:1	6000		X		67.5	54	22	19
DWO 1140527	Axial Mill Head D=27mm, L=21mm H=100mm	27x21	X	1:1	6000		X		70	54	27	21

\* Coolant Thru tools are designed for 1000 psi.  
They require 5 Micron Filtration and **CANNOT** be run dry.

## HI-TECH 200 - HI-TECH 300/400 - HI-TECH 450 - VT450 - T2 - CUTEX 240

### DRIVEN

#### AXIAL MTSK DRIVEN TOOL H=100mm

See Accessories for MTSK Clamping Units

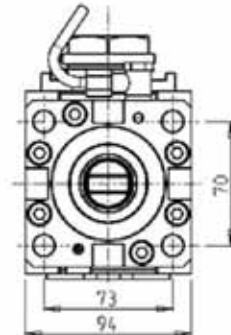
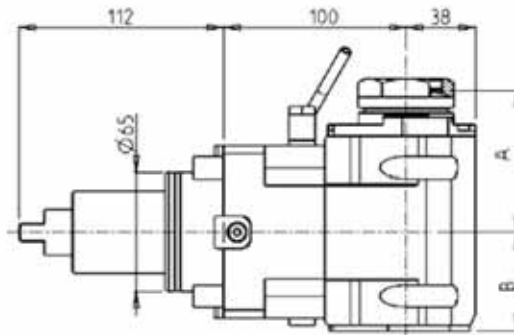

Part Number	Description	Spindle	Reversible	RPM	Cool Thru	Ext. Cool	A	B
DWO 1190140	Axial MTSK-40 H=100mm	MTSK-40	X	6000		X	77	54
DWO 1190240	Axial MTSK-40 H=100mm Cool Thru*	MTSK-40	X	6000	X	X	77	65
DWO 1190150	Axial MTSK-50 H=100mm	MTSK-50	X	6000		X	79	54
DWO 1190250	Axial MTSK-50 H=100mm Cool Thru*	MTSK-50	X	6000	X	X	79	65

\* Coolant Thru tools are designed for 1000 psi.  
They require 5 Micron Filtration and **CANNOT** be run dry.

#### AXIAL GEARED-UP 1:2 DRIVEN TOOL

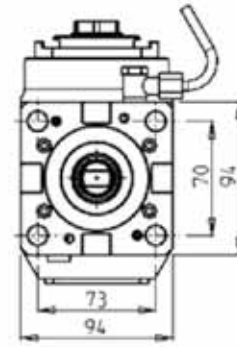
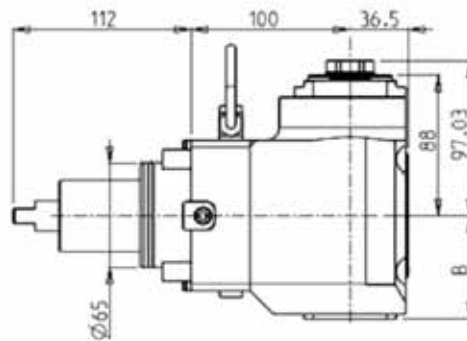

Part Number	Description	Spindle	Reversible	I	RPM	Cool Thru	Ext. Cool	B
DWO 0710125	Axial Geared-Up 1:2 ERA25	ERA25	X	1:2	12000		X	64.7
DWO 0710225	Axial Geared-Up 1:2 ERA25 Cool Thru*	ERA25	X	1:2	12000	X	X	73.2

\* Coolant Thru tools are designed for 1000 psi.  
They require 5 Micron Filtration and **CANNOT** be run dry.

## HI-TECH 200 - HI-TECH 300/400 - HI-TECH 450 - VT450 - T2 - CUTEX 240

### DRIVEN

#### AXIAL OPPOSITE FACE DRIVEN TOOL H=72mm

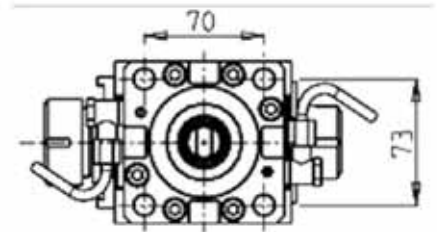
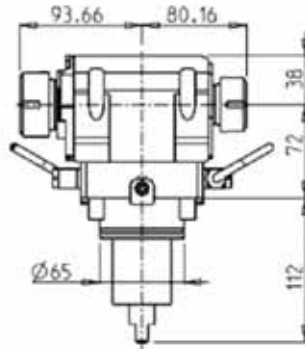

Part Number	Description	Spindle	Reversible	I	RPM	Ext. Cool
DWO 0720132	Axial Opposite Face ER32/ER25 H=72mm	ER32+ER25	X	1:1	6000	X

#### AXIAL OPPOSITE FACE DRIVEN TOOL H=85mm

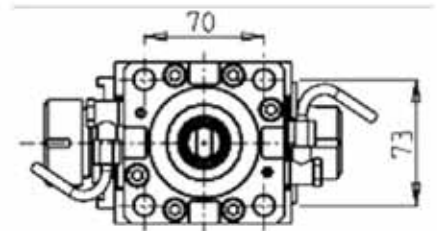
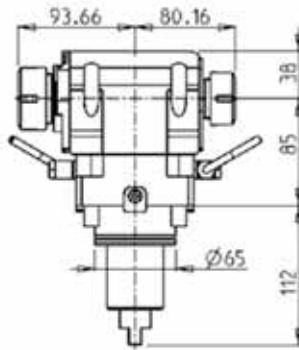

Part Number	Description	Spindle	Reversible	I	RPM	Ext. Cool
DWO 1150132	Axial Opposite Face ER32/ER25 H=85mm	ER32+ER25	X	1:1	6000	X

#### AXIAL OPPOSITE FACE DRIVEN TOOL H=100mm

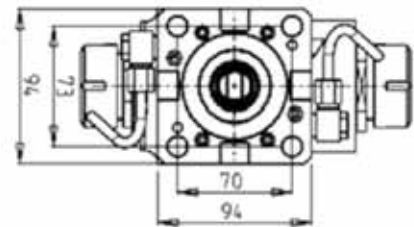
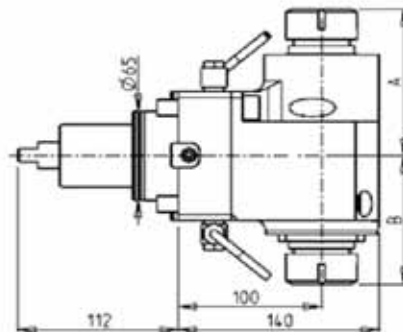

Part Number	Description	Spindle	Reversible	RPM	Ext. Cool	A	B
DWO 0070232	Double Outlet ER32/ER32 Opposite Face	ER32+ER32	X	6000	X	107.66	94.26
DWO 0073225	Double Outlet ERA25/ERA32 Opposite Face	ERA25+ERA32	X	6000	X	106.03	81.13

## HI-TECH 200 - HI-TECH 300/400 - HI-TECH 450 - VT450 - T2 - CUTEX 240

### DRIVEN

#### AXIAL OPPOSITE FACE DRIVEN TOOL H=100 mm Version 2

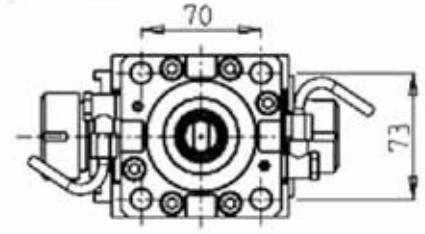
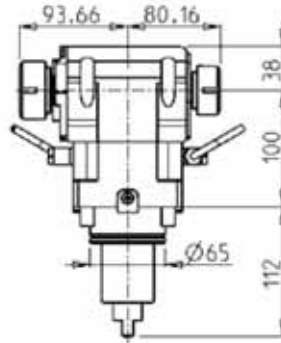

Part Number	Description	Spindle	Reversible	RPM	Ext. Cool
DWO 1160132	Double Outlet ER32/ER25 Opposite Face, vers 2	ER32+ER25	X	6000	X

## HI-TECH 450 - T2

### DRIVEN

#### AXIAL SINGLE SIDE TWIN HEAD DRIVEN TOOL IN Y

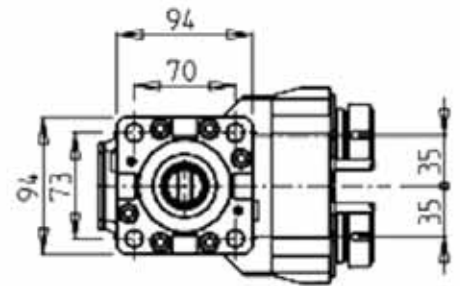
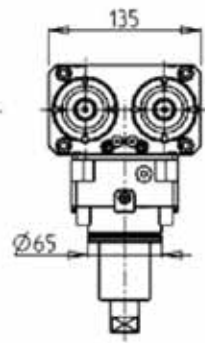
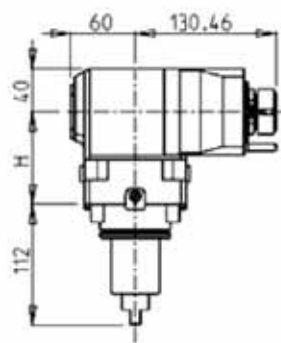

Part Number	Description	Spindle	Reversible	I	Ext. Cool	H	Machine
DWO 1120225	Single Side Twin Head in Y H=72mm	ER25	X	1:1	X	72	Hi-Tech 450 YMC (BMT65)
DWO 1230225	Single Side Twin Head in Y H=100mm	ER25	X	1:1	X	100	T2

## HI-TECH 200 - HI-TECH 300/400 - HI-TECH 450 - VT450 - T2 - CUTEX 240

### DRIVEN

### 0-90 ADJUSTABLE ANGLE DRIVEN TOOL

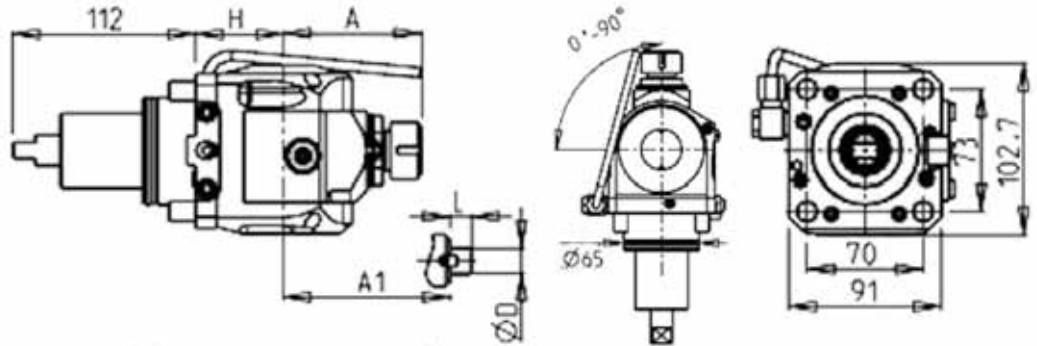

Part Number	Description	Spindle	Reversible	RPM	Ext. Cool	A	A1	D	H	L
0370020	Adj. Angle (0-90) ER20	ER20	X	6000	X	84.66			54	
0370120	Adj. Angle (0-90) ER20 H=100mm	ER20	X	6000	X	84.66			100	
0370025	Adj. Angle (0-90) ER25	ER25	X	6000	X	85.66			54	
0370125	Adj. Angle (0-90) ER25 H=100mm	ER25	X	6000	X	85.66			100	
0371617	Adj. Angle (0-90) Mill Head D=16mm L=17mm	16x17	X	6000	X		65	16	54	17
0372617	Adj. Angle (0-90) Mill Head D=16mm L=17mm H=100mm	16x17	X	6000	X		65	16	100	17
0372219	Adj. Angle (0-90) Mill Head D=22mm L=19mm	22x19	X	6000	X		65	22	54	19
0373219	Adj. Angle (0-90) Mill Head D=22mm L=19mm H=100mm	22x19	X	6000	X		65	22	100	19
0371905	Adj. Angle (0-90) Mill Head D=3/4" L=3/4"	3/4"x3/4"	X	6000	X		65	3/4"	54	3/4"
0372905	Adj. Angle (0-90) Mill Head D=3/4" L=3/4" H=100mm	3/4"x3/4"	X	6000	X		65	3/4"	100	3/4"

**Note :**

Wrenches are provided with the purchase of Specialty Toolholders

## HI-TECH 200 - HI-TECH 300/400 - HI-TECH 450 - VT450 - T2 - CUTEX 240

### DRIVEN

#### GEAR HOBBER

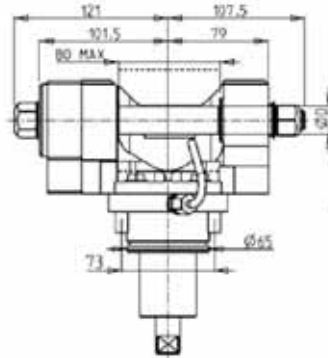
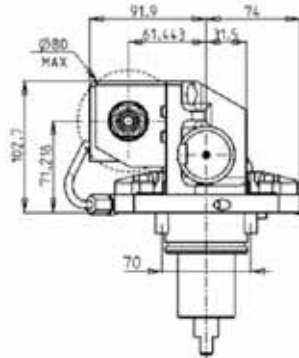

Part Number	Description	Reversible	I	RPM	Ext. Cool	D mm	D Inch
0321100	Gear Hobbing Tool 1:1	X	1:1	6000	X	16-22-27-32	3/4"-1"-1 1/4"
0322100	Gear Hobbing Tool 2:1 Geared Down	X	2:1	3000	X	16-22-27-32	3/4"-1"-1 1/4"

**Note :** Wrenches are provided with the purchase of Specialty Toolholders

#### GEAR HOBBER - HEAVY DUTY

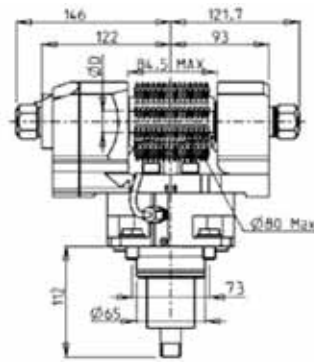
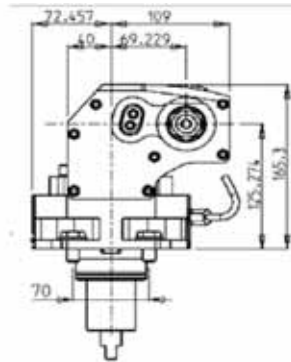

Part Number	Description	Reversible	I	RPM	Ext. Cool	D mm	D Inch
DWO 0031100	Heavy Duty Gear Hobbing Tool 1:1	X	1:1	6000	X	22-27-32	1"-1 1/4"
DWO 0032100	Heavy Duty Gear Hobbing Tool 2:1 Geared Down	X	2:1	3000	X	22-27-32	1"-1 1/4"

**Note :** Wrenches are provided with the purchase of Specialty Toolholders

## T2

### DRIVEN

#### DRIVEN TOOL HOLDER FOR SLIDING STEADY REST- SIZE 2

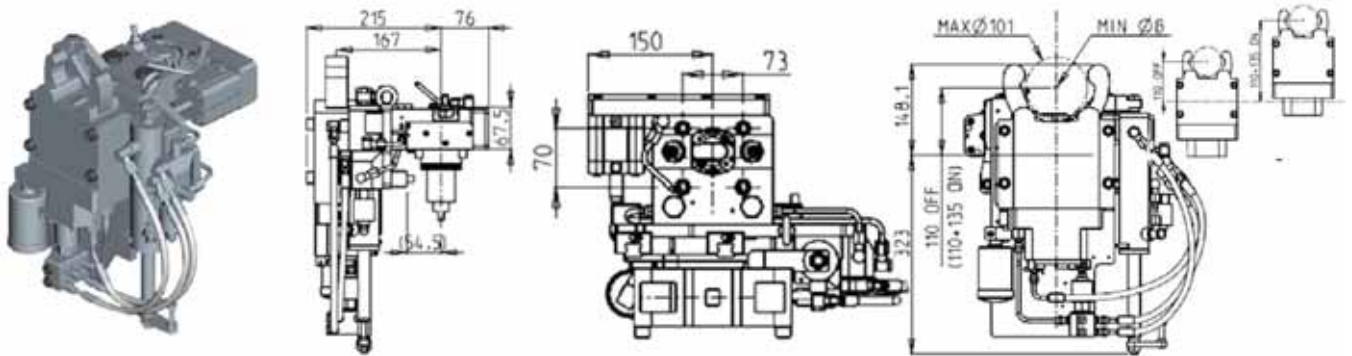

Part Number	Description	I	RPM	Ext. Cool	Electronics
DWO 0940300	Tool Holder for Size 2 Sliding Steady Rest	1:1	6000	X	
DWO 0940300A	Tool Holder for Size 2 Sliding Steady Rest with Electronics	1:1	6000	X	X

## HI-TECH 550

### DRIVEN

#### RADIAL DRIVEN TOOL

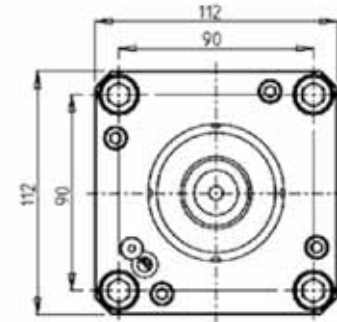
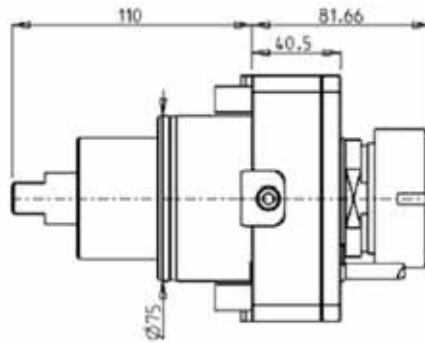

Part Number	Description	Spindle	RPM	Cool Thru	Ext. Cool
0291540	Radial ER40	ER40	6000		X
0291040	Radial ER40 Cool Thru*	ER40	6000	X	

\* Coolant Thru tools are designed for 1000 psi.  
They require 5 Micron Filtration and **CANNOT** be run dry.

#### RADIAL DRIVEN TOOL RE-DIRECTED IN Z BY 47.5mm

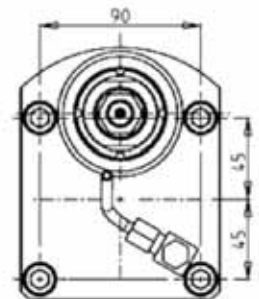
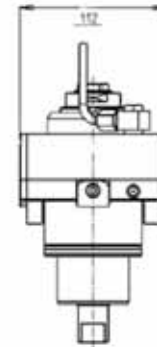
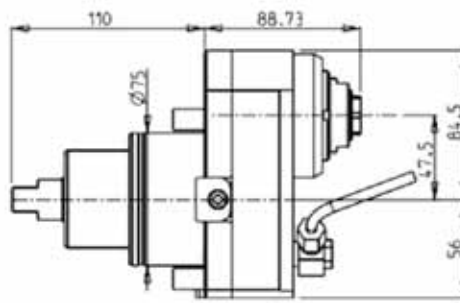
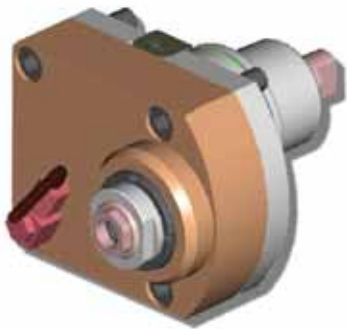

Part Number	Description	Spindle	Reversible	I	RPM	Ext. Cool
DWO 0430120	Radial ERA20 Re-Directed in Z by 47.5mm	ERA20	X	1:1	6000	X

#### RADIAL GEARED-UP I=1:2 DRIVEN TOOL RE-DIRECTED IN Z BY 47.5mm

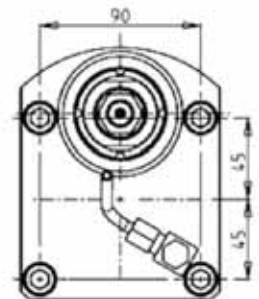
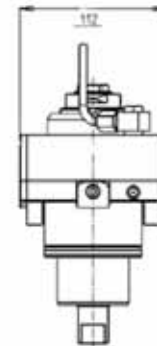
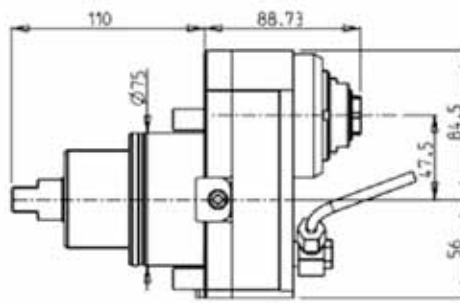

Part Number	Description	Spindle	Reversible	I	RPM	Ext. Cool
DWO 0430220	Radial ERA20 Geared Up Redirected in Z by 47.5mm	ERA20	X	1:2	12000	X

## HI-TECH 550

### DRIVEN

#### RADIAL GEARED-UP I=1:4 DRIVEN TOOL

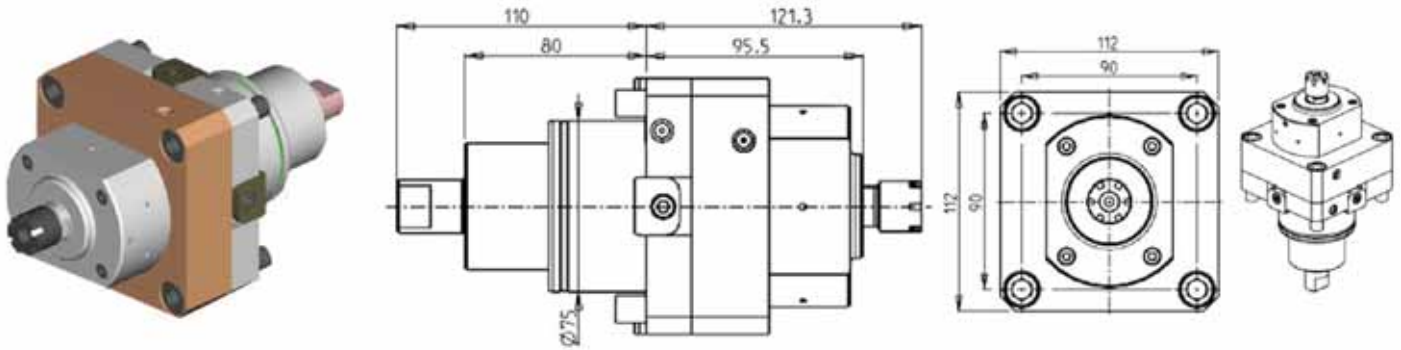

Part Number	Description	Spindle	I	RPM	Cool Thru
DWO 0450116	Radial Geared-Up 1:4 ER16 Cool Thru*	ER16	1:4	12000	X

#### RADIAL INVERTED DRIVEN TOOL RE-DIRECTED IN Z BY 187.5mm

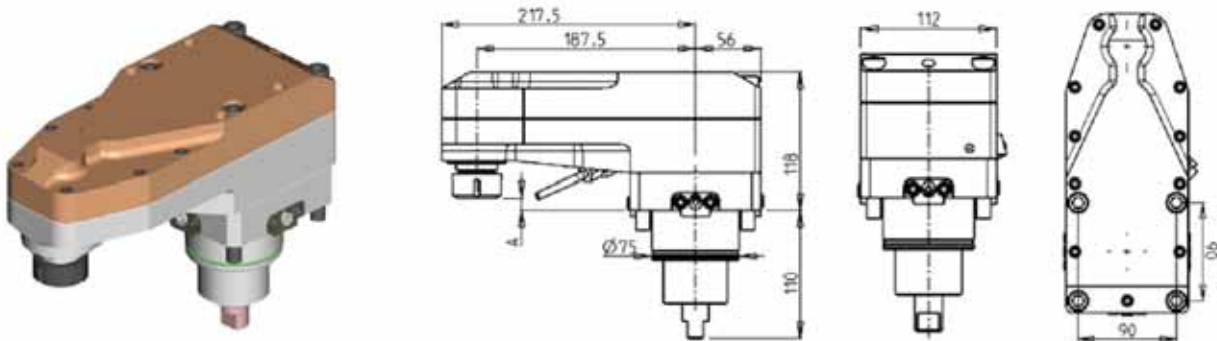

Part Number	Description	Spindle	I	RPM	Ext. Cool	A
0841225	Radial Inverted Driven Tool ER25	ER25	1:2	8000	X	8.84
0841232	Radial Inverted Driven Tool ER32	ER32	1:2	8000	X	3.66

## HI-TECH 550

### DRIVEN

#### AXIAL REINFORCED DRIVEN TOOL H=90mm

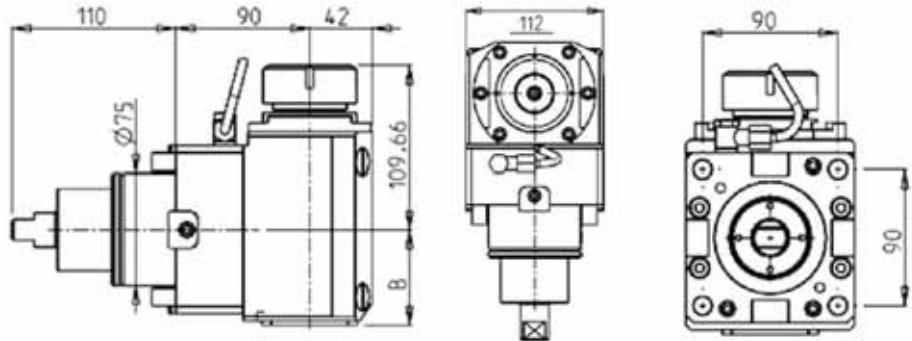

Part Number	Description	Spindle	I	RPM	Cool Thru	Ext. Cool	B
DWO 0650140	Axial ER40 Reinforced H=90mm	ER40	1:1	6000		X	64
DWO 0650240	Axial ER40 Reinforced H=90mm Cool Thru*	ER40	1:1	6000	X	X	77.5

\* Coolant Thru tools are designed for 1000 psi.  
They require 5 Micron Filtration and **CANNOT** be run dry.

#### AXIAL REINFORCED DRIVEN TOOL H=110mm

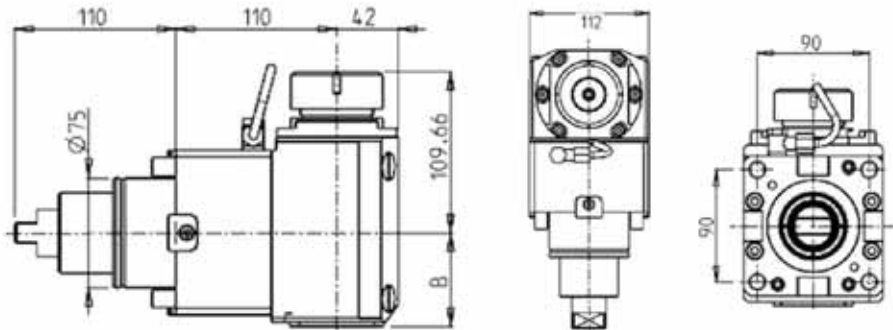

Part Number	Description	Spindle	I	RPM	Cool Thru	Ext. Cool	B
DWO 1340140	Axial Reinforced ER40 H=110mm	ER40	1:1	6000		X	64
DWO 1340240	Axial Reinforced ER40 H=110mm Cool Thru*	ER40	1:1	6000	X	X	77.5

\* Coolant Thru tools are designed for 1000 psi.  
They require 5 Micron Filtration and **CANNOT** be run dry.

## HI-TECH 550

### DRIVEN

#### AXIAL GEARED-DOWN I=2:1 DRIVEN TOOL H=90mm

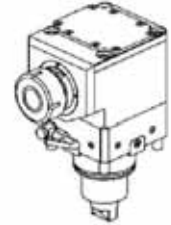
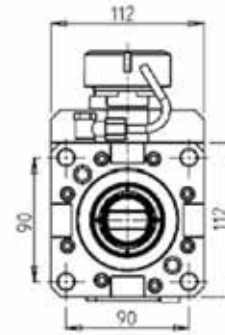
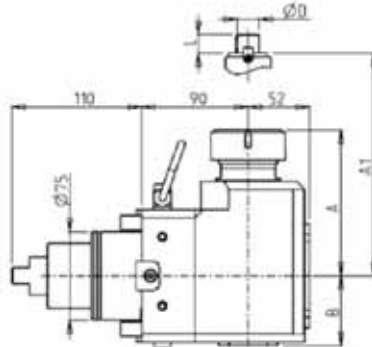

Part Number	Description	Spindle	Reversible	I	RPM	Cool Thru	Ext. Cool	A	A1	B	D	L
DWO 1370140	Axial Geared-Down ER40 H=90mm	ER40	X	2:1	3000		X	122.66		59		
DWO 1370240	Axial Geared-Down ER40 H=90mm Cool Thru*	ER40	X	2:1	3000	X	X	122.66		72.5		
DWO 1372733	Axial Geared-Down H=90mm Mill Head D=27, L=33	27x33	X	2:1	3000		X		92.5	59	27	33

\* Coolant Thru tools are designed for 1000 psi. They require 5 Micron Filtration and **CANNOT** be run dry.

#### 0-180 ADJUSTABLE ANGLE DRIVEN TOOL

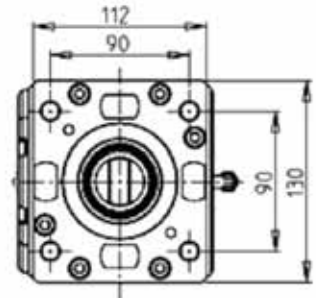
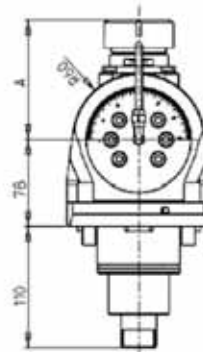
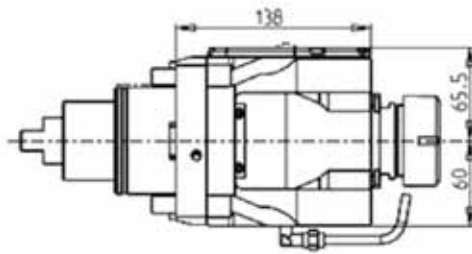

Part Number	Description	Spindle	I	RPM	Cool Thru	Ext. Cool	A
DWO 0820332	0-180 Adj. Angle ERA32	ERA32	1:1	6000		X	81
DWO 0820432	0-180 Adj. Angle ERA32 Cool Thru*	ERA32	1:1	6000	X	X	81
DWO 0820140	0-180 Adj. Angle ER40	ER40	1:1	6000		X	108.66
DWO 0820240	0-180 Adj. Angle ER40 Cool Thru*	ER40	1:1	6000	X	X	108.66

\* Coolant Thru tools are designed for 1000 psi. They require 5 Micron Filtration and **CANNOT** be run dry.

**Note :**

Wrenches are provided with the purchase of Specialty Toolholders

## HI-TECH 550

### DRIVEN

#### REINFORCED DRIVEN GEAR HOBBER

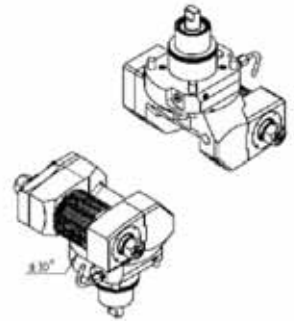
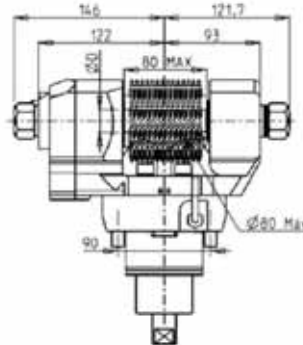
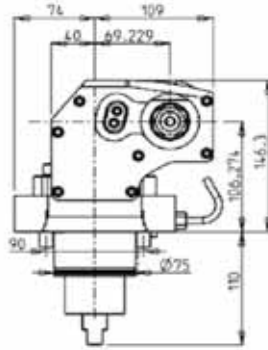

Part Number	Description	Reversible	RPM	Ext. Cool	D mm	D Inch
DWO 0251100	Gear Hobbing Tool 1:1	X	6000	X	16-22-27-32	3/4"-1"-1 1/4"
DWO 0252100	Gear Hobbing Tool 2:1 Geared Down	X	3000	X	16-22-27-32	3/4"-1"-1 1/4"

**Note :** Wrenches are provided with the purchase of Specialty Toolholders

#### LARGE DRIVEN GEAR HOBBER

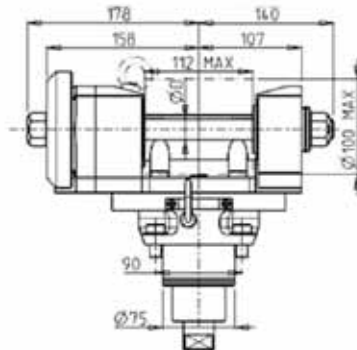
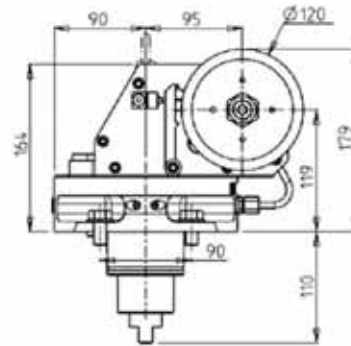

Part Number	Description	I	RPM	Ext. Cool	D (mm)
DWO 0811100	Large Driven Gear Hobber 1:1	1:1	6000	X	22-27-32
DWO 0812100	Large Driven Gear Hobber 2:1	2:1	3000	X	22-27-32

## VT950/1150

### DRIVEN

#### RADIAL DRIVEN TOOL

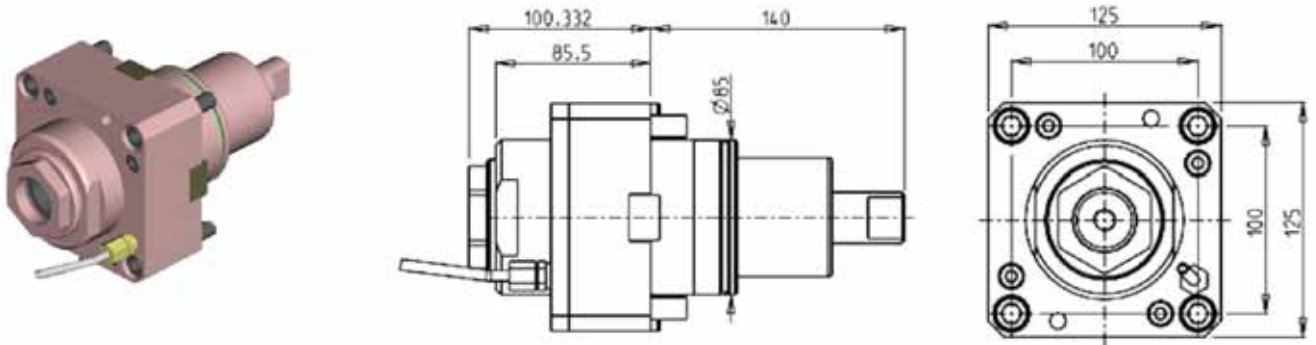

Part Number	Description	Spindle	I	RPM	Cool Thru	Ext. Cool
DWO 0160150	Radial ERA50 BMT85	ERA50	1:1	3000		X
DWO 0160250	Radial ERA50 BMT85 Cool Thru*	ERA50	1:1	3000	X	X

\* Coolant Thru tools are designed for 1000 psi.  
They require 5 Micron Filtration and **CANNOT** be run dry.

#### AXIAL DRIVEN TOOL H=110mm

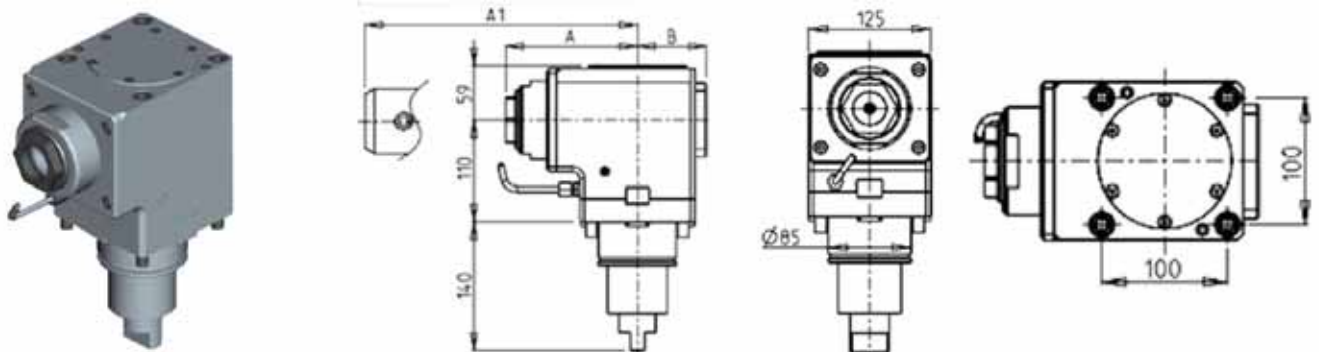

Part Number	Description	Spindle	Reversible	I	RPM	Cool Thru	Ext. Cool	A	A1	B
DWO 1290150	Axial ERA50 H=110mm	ERA50	X	1:1	3000		X	143.33		75
DWO 1291250	Axial ERA50 H=110mm Cool Thru*	ERA50	X	1:1	3000	X	X	143.33		86
DWO 1290240	Axial Weldon 40 H=110mm	Weldon 40	X	1:1	3000		X		175.5	75
DWO 1290140	Axial Weldon 40 H=110mm Cool Thru*	Weldon 40	X	1:1	3000	X	X		175.5	86

\* Coolant Thru tools are designed for 1000 psi.  
They require 5 Micron Filtration and **CANNOT** be run dry.

## VT950/1150

### DRIVEN

#### GEARED-DOWN AXIAL 2:1 DRIVEN TOOL H=110mm

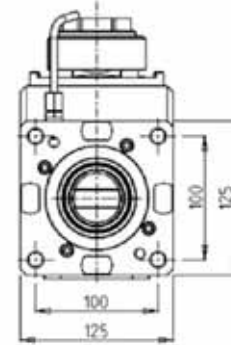
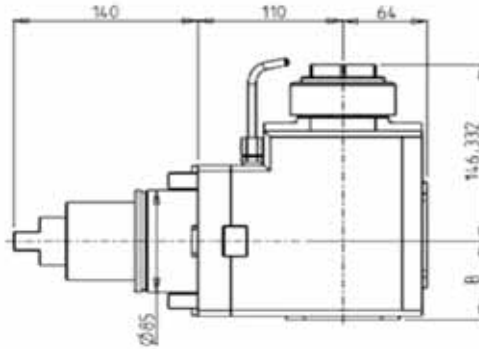

Part Number	Description	Spindle	Reversible	I	RPM	Cool Thru	Ext. Cool	B
DWO 1210150	Axial ERA50 Geared-Down 2:1 H=110mm	ERA50	X	2:1	1500		X	65.5
DWO 1210250	Axial ERA50 Geared-Down 2:1 H=110mm Cool Thru*	ERA50	X	2:1	1500	X	X	82

\* Coolant Thru tools are designed for 1000 psi. They require 5 Micron Filtration and **CANNOT** be run dry.

#### AXIAL MTSK GEARED-DOWN 2:1 DRIVEN TOOL H=110mm

*See Accessories for MTSK Clamping Units*

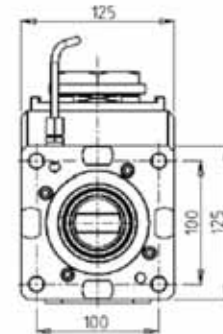
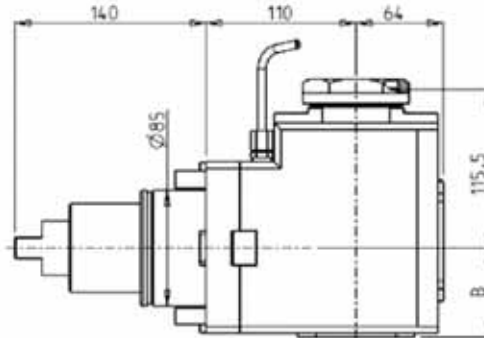

Part Number	Description	Spindle	Reversible	I	RPM	Cool Thru	Ext. Cool	B
DWO 1200163	Axial MTSK-63 Geared-Down 2:1 H=110mm	MTSK-63	X	2:1	1500		X	65.5
DWO 1200263	Axial MTSK-63 Geared-Down 2:1 H=110mm Cool Thru*	MTSK-63	X	2:1	1500	X	X	82

\* Coolant Thru tools are designed for 1000 psi. They require 5 Micron Filtration and **CANNOT** be run dry.

## VT950/1150

### DRIVEN

#### 0-180 ADJUSTABLE ANGLE DRIVEN TOOL

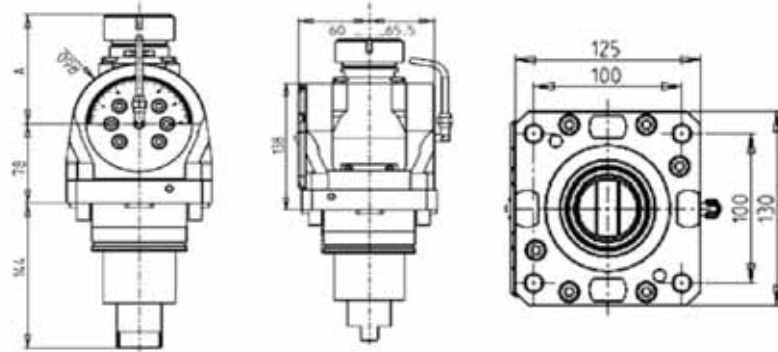

Part Number	Description	Spindle	I	RPM	Cool Thru	Ext. Cool	A
DWO 0830332	0-180 Adj. Angle ERA32	ERA32	1:1	3000		X	81
DWO 0830432	0-180 Adj. Angle ERA32 Cool Thru*	ERA32	1:1	3000	X	X	81
DWO 0830140	0-180 Adj. Angle ER40	ER40	1:1	3000		X	108.66
DWO 0830240	0-180 Adj. Angle ER40 Cool Thru*	ER40	1:1	3000	X	X	108.66

\* Coolant Thru tools are designed for 1000 psi.  
They require 5 Micron Filtration and **CANNOT** be run dry.

**Note :**

Wrenches are provided with the purchase of Specialty Toolholders

#### REINFORCED GEAR HOBBER

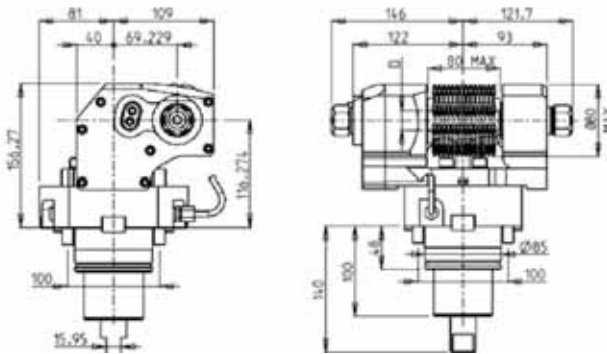

Part Number	Description	I	RPM	Ext. Cool	D mm	D Inch
DWO 0181100	Driven Gear Hobber 1:1	1:1	3000	X	16-22-27-32	3/4"-1"-1 1/4"
DWO 0182100	Driven Gear Hobber 2:1	2:1	1500	X	16-22-27-32	3/4"-1"-1 1/4"

**Note :**

Wrenches are provided with the purchase of Specialty Toolholders

## VT950/1150

DRIVEN

### LARGE GEAR HOBBER

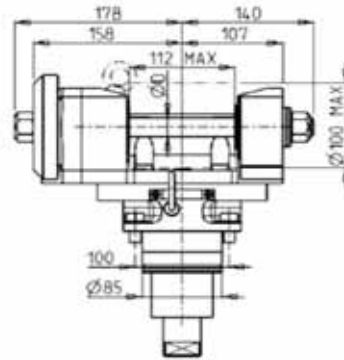
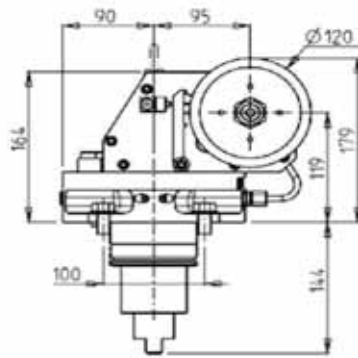

Part Number	Description	I	RPM	Ext. Cool	D (mm)
DWO 0851100	Large Gear Hobber I-1:1	1:1	3000	X	22-27-32
DWO 0852100	Large Gear Hobber I-2:1	2:1	1500	X	22-27-32

**Note :** Wrenches are provided with the purchase of Specialty Toolholders

## ACCESSORIES

### ACCESSORIES

#### MTSK-40 QUICK CHANGE TOOL HOLDER ER ADAPTORS



Cod. MT	Mandrina Spindle Spindel	A
MTSK40A02	ER32	35.6
MTSK40A03	ER25	32.6

Cod. MT	Mandrina Spindle Spindel	A
MTSK40B02	ERA25	16
MTSK40B03	ERA20	14

Part Number	Description	Spindle	A
MTSK40A02	MTSK-40 Adaptor ER32	ER32	35.6
MTSK40A03	MTSK-40 Adaptor ER25	ER32	32.6
MTSK40B02	MTSK-40 Adaptor ERA16	ERA16	16
MTSK40B03	MTSK-40 Adaptor ERA20	ERA20	14

#### MTSK-40 QUICK CHANGE TOOL HOLDER MILL ADAPTORS

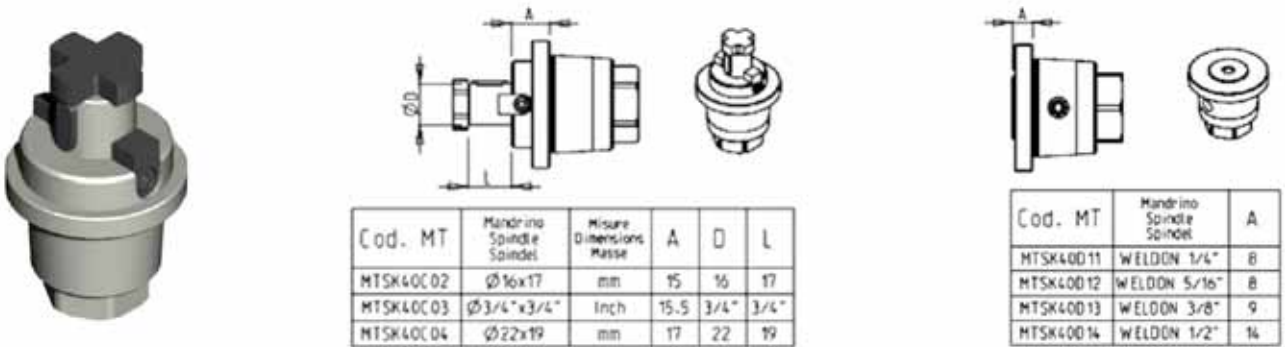

Cod. MT	Mandrina Spindle Spindel	Measure Dimensions Masse	A	D	L
MTSK40C02	Ø16x17	mm	15	16	17
MTSK40C03	Ø3/4"x3/4"	Inch	15.5	3/4"	3/4"
MTSK40C04	Ø22x19	mm	17	22	19

Cod. MT	Mandrina Spindle Spindel	A
MTSK40D11	WELDON 1/4"	8
MTSK40D12	WELDON 5/16"	8
MTSK40D13	WELDON 3/8"	9
MTSK40D14	WELDON 1/2"	14

Part Number	Description	Spindle	Dimension	A	D	L
MTSK40C02	MTSK-40 Adaptor Mill 16x17	16x17	mm	15	16	17
MTSK40C03	MTSK-40 Adaptor Mill 3/4"	3/4"x3/4"	Inch	15.5	3/4"	3/4"
MTSK40C04	MTSK-40 Adaptor Mill 22x19	22x19	mm	17	22	19
MTSK40C05	MTSK-40 Adaptor Mill 27x21	27x21	mm	22	27	21
MTSK40D11	MTSK-40 Adaptor Mill Weldon 1/4"	Weldon 1/4"		8		
MTSK40D12	MTSK-40 Adaptor Mill Weldon 5/16"	Weldon 5/16"		8		
MTSK40D13	MTSK-40 Adaptor Mill Weldon 3/8"	Weldon 3/8"		9		
MTSK40D14	MTSK-40 Adaptor Mill Weldon 1/2"	Weldon 1/2"		14		

## ACCESSORIES

### ACCESSORIES

#### MTSK-50 QUICK CHANGE TOOL HOLDER ER ADAPTORS

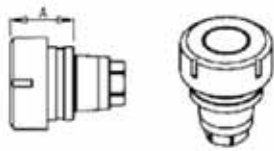

Cod. MT	Mandrina Spindle	A
MTSK50A01	ER40	46.6
MTSK50A02	ER32	35.6
MTSK50A03	ER25	32.6



Cod. MT	Mandrina Spindle	A
MTSK50B01	ERA32	19
MTSK50B02	ERA25	14
MTSK50B03	ERA20	9

Part Number	Description	Spindle	A
MTSK50A01	MTSK-50 Adaptor ER40	ER40	46.6
MTSK50A02	MTSK-50 Adaptor ER32	ER32	35.6
MTSK50A03	MTSK-50 Adaptor ER25	ER25	32.6
MTSK50B01	MTSK-50 Adaptor ERA32	ERA32	19
MTSK50B02	MTSK-50 Adaptor ERA25	ERA25	14
MTSK50B03	MTSK-50 Adaptor ERA20	ERA20	9

#### MTSK-50 QUICK CHANGE TOOL HOLDER MILL ADAPTORS



SHELL MILL

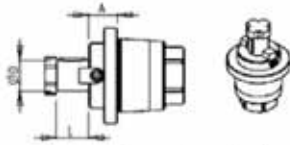

Cod. MT	Mandrina Spindle	Measure Dimensions Probe	A	D	L
MTSK50C02	Ø16x17	mm	15	16	17
MTSK50C03	Ø3/4"x3/4"	Inch	15.5	3/4"	3/4"
MTSK50C04	Ø22x19	mm	17	22	19
MTSK50C05	Ø1"x3/4"	Inch	19	1"	3/4"
MTSK50C06	Ø27x21	mm	19	27	21

END MILL

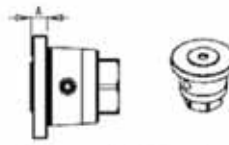

Cod. MT	Mandrina Spindle	A
MTSK50D11	WELDON 1/4"	8
MTSK50D12	WELDON 5/16"	8
MTSK50D13	WELDON 3/8"	8
MTSK50D14	WELDON 1/2"	9
MTSK50D15	WELDON 5/8"	12

POWERGRIP

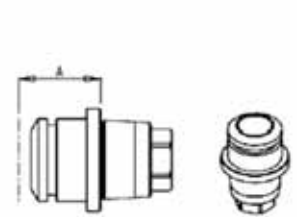

Cod. MT	Mandrina Spindle	A
MTSK50E01	POWRGRIP PG25	40

Part Number	Description	Spindle	Dimension	A	D	L
MTSK50C02	MTSK-50 Adaptor Mill 16x17	16x17	mm	15	16	17
MTSK50C03	MTSK-50 Adaptor Mill 3/4"	3/4"x3/4"	Inch	15.5	3/4"	3/4"
MTSK50C04	MTSK-50 Adaptor Mill 22x19	22x19	mm	17	22	19
MTSK50C05	MTSK-50 Adaptor Mill 1"x3/4"	1"x3/4"	Inch	19	1"	3/4"
MTSK50C06	MTSK-50 Adaptor Mill 27x21	27x21	mm	19	27	21
MTSK50D11	MTSK-50 Adaptor Mill Weldon 1/4"	Weldon 1/4"		8		
MTSK50D12	MTSK-50 Adaptor Mill Weldon 5/16"	Weldon 5/16"		8		
MTSK50D13	MTSK-50 Adaptor Mill Weldon 3/8"	Weldon 3/8"		8		
MTSK50D14	MTSK-50 Adaptor Mill Weldon 1/2"	Weldon 1/2"		9		
MTSK50D15	MTSK-50 Adaptor Mill Weldon 5/8"	Weldon 5/8"		12		
MTSK50E01	MTSK-50 Adaptor Mill POWRGRIP PG25	POWRGRIP PG25		40		

## ACCESSORIES

### ACCESSORIES

#### MTSK-63 QUICK CHANGE TOOL HOLDER ER ADAPTORS

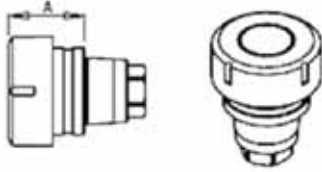

Cod. MT	Mandrina Spindle Spindel	A
MTSK63A01	ER50	53.9
MTSK63A02	ER40	39.6
MTSK63A03	ER32	36.6
MTSK63A04	ER25	33.6

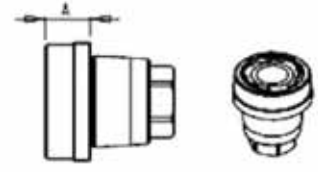

Cod. MT	Mandrina Spindle Spindel	A
MTSK63B01	ERA40	20
MTSK63B02	ERA32	18
MTSK63B03	ERA25	10

Part Number	Description	Spindle	A
MTSK63A01	MTSK-63 Adaptor ER50	ER50	53.9
MTSK63A02	MTSK-63 Adaptor ER40	ER40	39.6
MTSK63A03	MTSK-63 Adaptor ER32	ER32	36.6
MTSK63A04	MTSK-63 Adaptor ER25	ER25	33.6
MTSK63B01	MTSK-63 Adaptor ERA40	ERA40	20
MTSK63B02	MTSK-63 Adaptor ERA32	ERA32	18
MTSK63B03	MTSK-63 Adaptor ERA25	ERA25	10

#### MTSK-63 QUICK CHANGE TOOL HOLDER MILL ADAPTORS

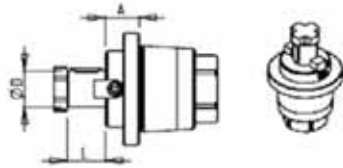

Cod. MT	Mandrina Spindle Spindel	Misure Dimensioni Misure	A	D	L
MTSK63C02	∅16x17	mm	16	16	17
MTSK63C03	∅3/4"x3/4"	Inch	16.5	3/4"	3/4"
MTSK63C04	∅22x19	mm	18	22	19
MTSK63C05	∅1"x3/4"	Inch	20	1"	3/4"
MTSK63C06	∅27x21	mm	20	27	21

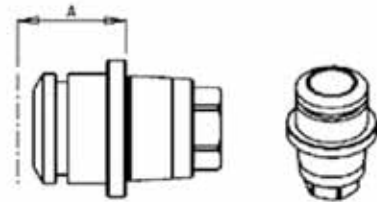

Cod. MT	Mandrina Spindle Spindel	A
MTSK63E01	POWRGRIP PG32	53

Part Number	Description	Spindle	Dimension	A	D	L
MTSK63C02	MTSK-63 Adaptor Mill 16x17	16x17	mm	16	16	17
MTSK63C03	MTSK-63 Adaptor Mill 3/4"	3/4"x3/4"	Inch	16.5	3/4"	3/4"
MTSK63C04	MTSK-63 Adaptor Mill 22x19	22x19	mm	18	22	19
MTSK63C05	MTSK-63 Adaptor Mill 1"x3/4"	1"x3/4"	Inch	20	1"	3/4"
MTSK63C06	MTSK-63 Adaptor Mill 27x21	27x21	mm	20	27	21
MTSK63E01	MTSK-63 Adaptor Mill POWRGRIP PG32	POWRGRIP PG32		53		